

OWNER:
MAINE MEDICAL CENTER

22 Bramhall Street, Portland, ME, 04102

ARCHITECT:
Lavallee Brensinger Architects
305 Commercial Street
Portland, ME 04101
207.558.7200
www.LBPA.com

CONSTRUCTION MANAGER:
Langford & Low
284 Warren Avenue
Portland, ME 04103
207.797.5141
www.langfordandlow.com

MECHANICAL / PLUMBING ENGINEER:
(DESIGN/BUILD)
JOHNSON AND JORDAN
18 Mussey Road
Scarborough, ME 04074
207.883.8345
www.johnsonandjordan.net

ELECTRICAL ENGINEER:
(DESIGN/BUILD)
E.S. BOULOS
45 Bradley Drive
Westbrook, ME 04092
207.464.3706
www.esboulos.com

FIRE PROTECTION ENGINEER:
(DESIGN/BUILD)
DEAN & ALLYN, INC.
116 US Route 100
Gray, ME 04039
207.657.5646
www.deanandallyn.net

FOR ADDITIONAL INFORMATION, REFER TO PROJECT MANUAL.

DRAWING LIST - SCU2

Sheet #	Sheet Name
0-Demo	
AD.1s	GROUND FLOOR DEMOLITION PLAN
1-New Construction	
A0.1s	LEGENDS, SYMBOLS, NOTES, PARTITION TYPES, DOOR AND FRAM TYPES, WINDOW TYPES
A0.2s	CODE ANALYSIS TEXT, SYMBOLS AND RATINGS
A1.1s	GROUND FLOOR PLAN
A1.4s	GROUND FLOOR REFLECTED CEILING PLAN
A6.1s	INTERIOR ELEVATIONS
A7.1s	MILLWORK DETAILS
A11.1s	INTERIOR DESIGN PLANS, FINISH LEGEND, & FINISH SCHEDULE
EQ1.1s	SCU2 EQUIPMENT PLAN

MAINE MEDICAL CENTER

22 Bramhall Street, Portland, ME, 04102

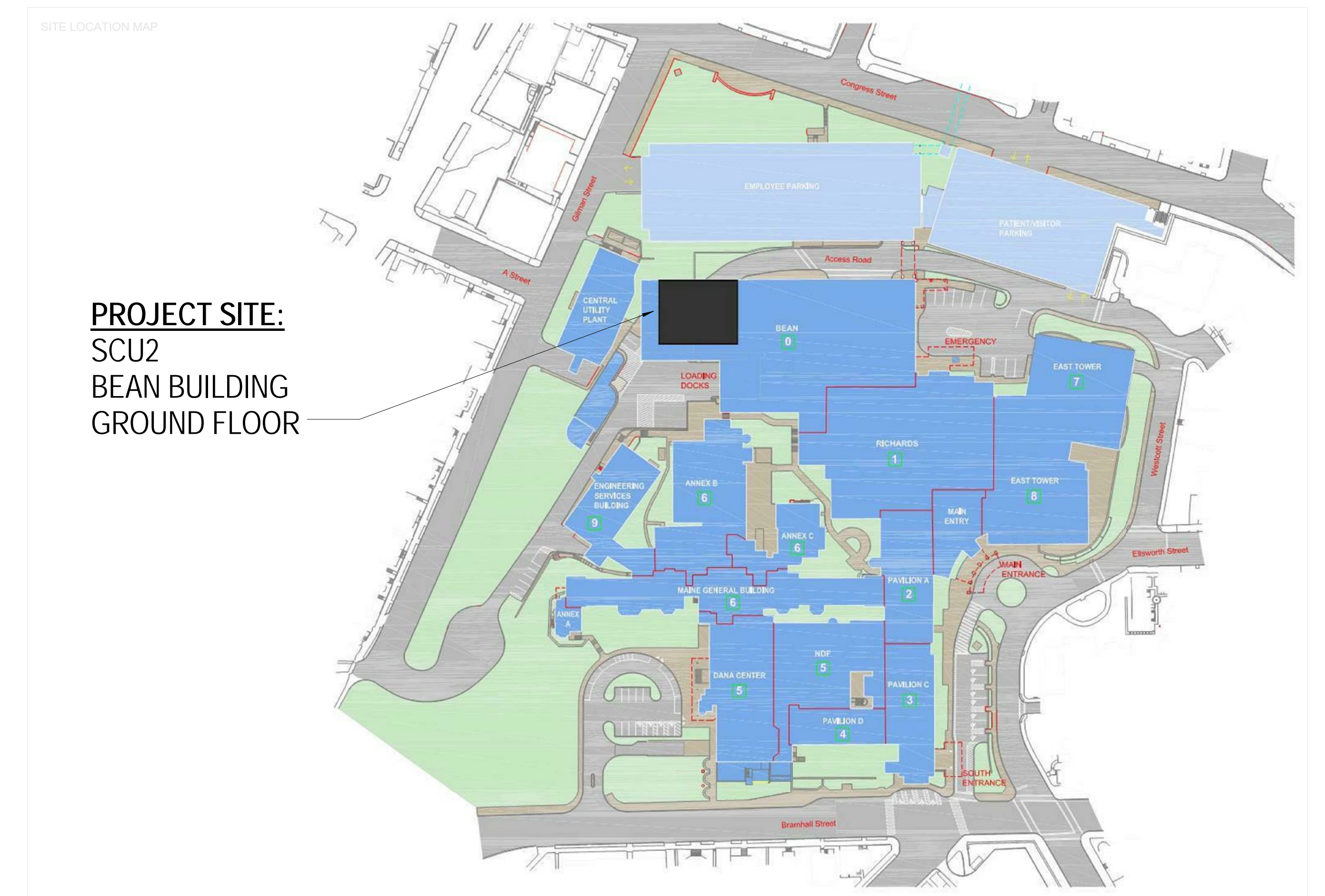
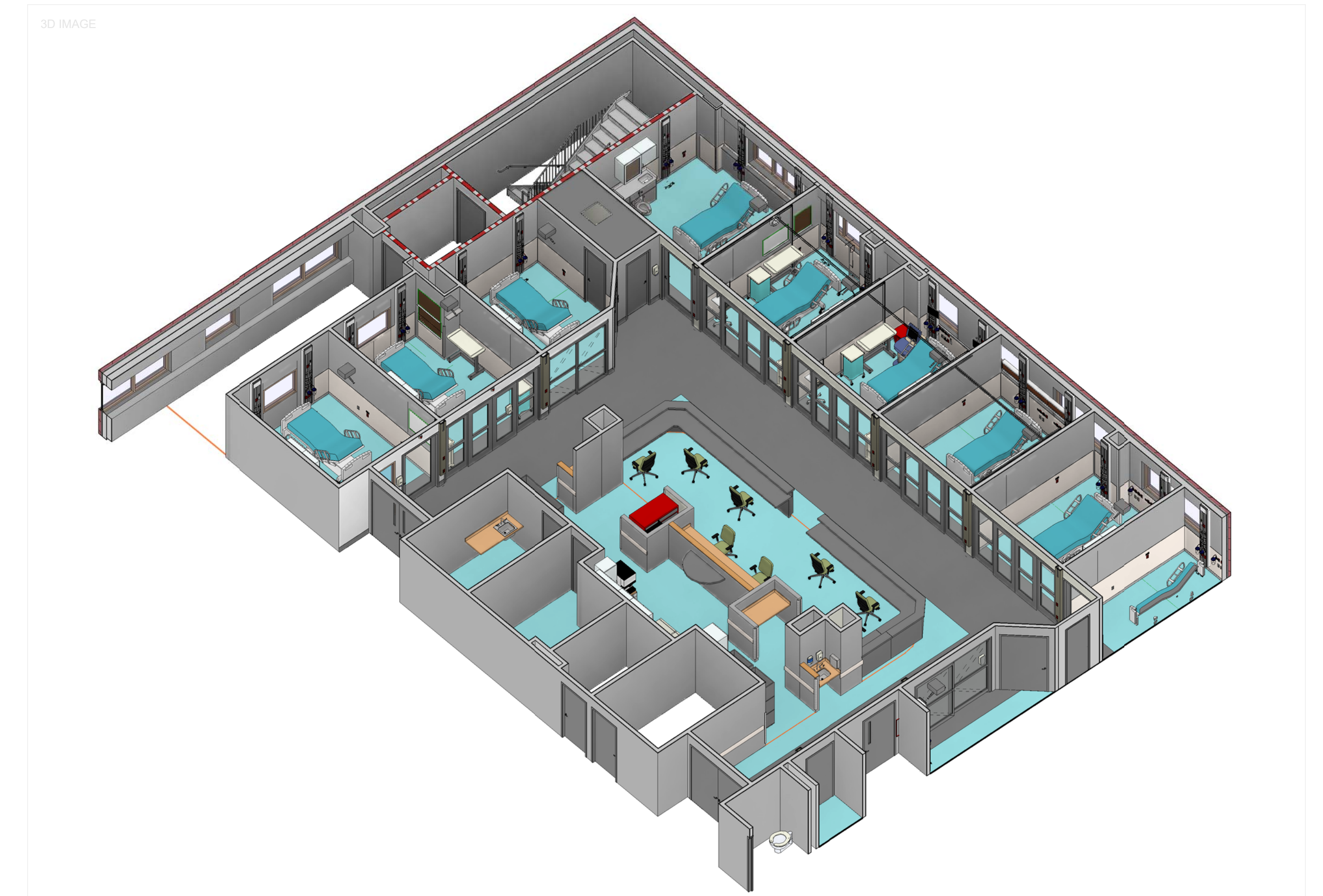

PROJECT SITE:
SCU2
BEAN BUILDING
GROUND FLOOR