

DRAWING NOTES:

1. REFER TO DRAWING E00-01 FOR LEGEND, SYMBOLS, ABBREVIATIONS, AND ADDITIONAL GENERAL NOTES.

**PERKINS
+ WILL**

225 Franklin St., Suite 1100
Boston, MA 02110
617.478.0300
617.478.0321
www.perkinswill.com

**Maine Medical Center
MaineHealth**

**HYBRID OR &
OR #6**
22 Bramhall Street, Portland,
Maine 04102

MEP ENGINEER
AKF GROUP, LLC

99 Bedford Street, 2nd Floor
Boston, MA 02111
617.737.1111
617.737.4311

STRUCTURAL ENGINEER

SIMPSON GUMPERTZ &
HEGER
41 Seyon Street, Building 1, Suite 500
Waltham, MA 02453
781.907.9000
781.907.9039

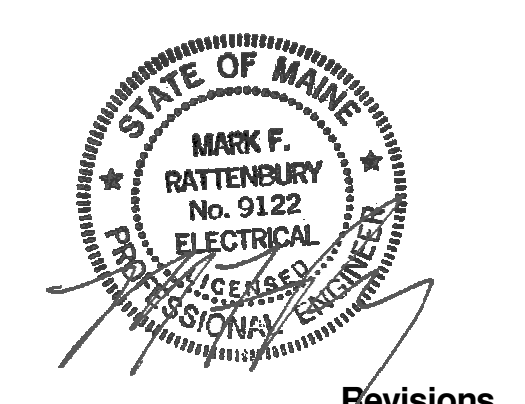
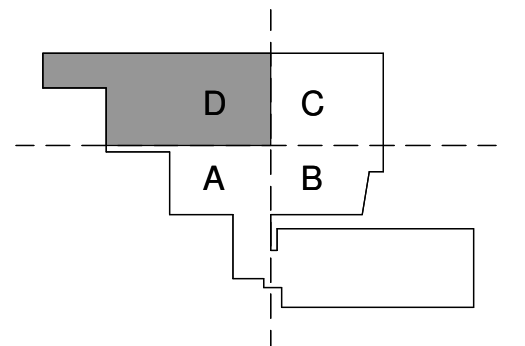
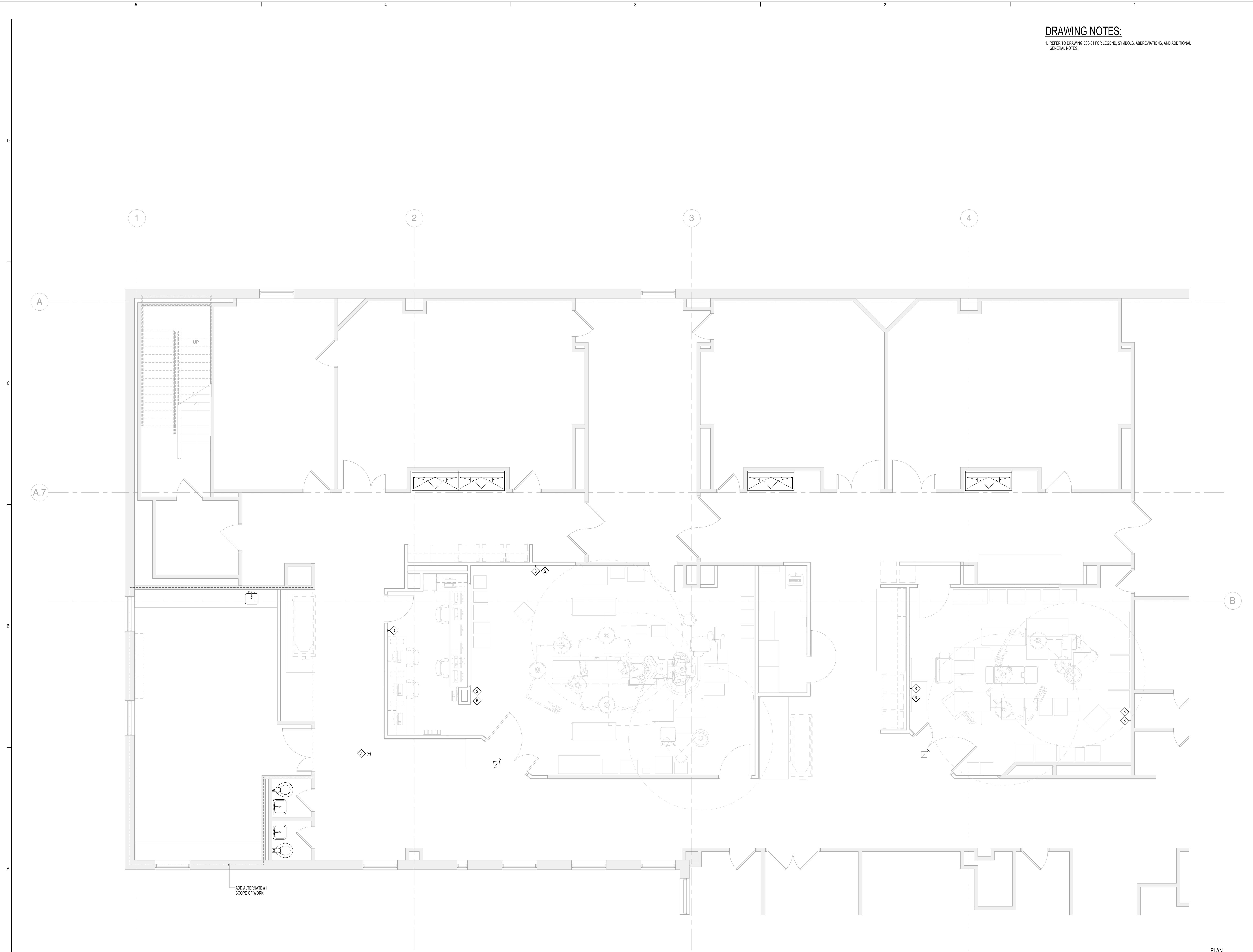

Revisions

ISSUED FOR PERMIT	08.21.2015
ISSUED FOR BID	07.31.2015
NO.	ISSUE DATE
Sheet Information	
Date	JULY 31, 2015
Job #	B150155-000
Drawn	GN
Checked	MR
Approved	MR
Title	

**ELECTRICAL
BASEMENT NURSE
CALL PLAN**

Sheet

E06-0B

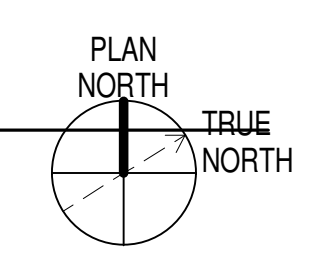

1 NURSE CALL BASEMENT PLAN
SCALE: 1/4" = 1'-0"