

ADDITIONAL ELECTRICAL REQUIREMENTS ARE SHOWN ON SITE SPECIFIC GE EQUIPMENT VENDOR INSTALLATION DRAWINGS. CONTRACTOR SHALL PROVIDE AND INSTALL ITEMS INCLUDING ALL WIRING, RACEWAYS, LIGHTS, INTERLOCKS, CABLING, CABLE TRAY, ETC. AS INDICATED ON THE EQUIPMENT VENDORS DRAWINGS. WORK ON VENDOR DRAWINGS SHALL BE COORDINATED BY THE ELECTRICAL CONTRACTOR AND INCLUDED IN ADDITION TO WORK, DEVICES, WIRING, ETC. AS SHOWN ON THESE DRAWINGS.

ADD ALTERNATE NOTE:
REFER TO PRICING NARRATIVE FOR ADDITIONAL INFORMATION AND REQUIREMENTS FOR ALL ALTERNATES.

OR CIRCUIT LEGEND:
A = CIRCUIT FROM DEDICATED ROOM O.R. ISOLATED POWER PANEL "A"
B = CIRCUIT FROM DEDICATED ROOM O.R. ISOLATED POWER PANEL "B"
- REFER TO EACH O.R. LAYOUT FOR EXACT PANEL NAMES. ALL RECEPTACLES SHALL BE RED IN COLOR.

HYBRID OR POWER KEY NOTES:

- 1 PROVIDE 3#10 & 1#10G IN 1-1/2" CONDUIT TO ATLAS CABINET "C1F". COORDINATE EXACT LOCATION WITH EQUIPMENT VENDOR DRAWINGS. REFER TO RISER DIAGRAM 2 ON DRAWING E07-01 FOR ADDITIONAL INFORMATION.
- 2 PROVIDE 2#10 & 1#10G IN 3/4" CONDUIT TO ATLAS CABINET "C1F". COORDINATE EXACT LOCATION WITH EQUIPMENT VENDOR DRAWINGS. REFER TO RISER DIAGRAM 2 ON DRAWING E07-01 FOR ADDITIONAL INFORMATION.
- 3 PROVIDE 3#8 & 1#8G IN 1" CONDUIT TO ATLAS CABINET "C2". COORDINATE EXACT LOCATION WITH EQUIPMENT VENDOR DRAWINGS. REFER TO RISER DIAGRAM 2 ON DRAWING E07-01 FOR ADDITIONAL INFORMATION.
- 4 PROVIDE 3#10 & 1#10G IN 1" CONDUIT TO CHILLER. COORDINATE EXACT LOCATION WITH EQUIPMENT VENDOR DRAWINGS. REFER TO RISER DIAGRAM 2 ON DRAWING E07-01 FOR ADDITIONAL INFORMATION.
- 5 PROVIDE 6#6, 1#6V & 2#6G IN 1-1/2" CONDUIT TO UPS CABINET. COORDINATE EXACT LOCATION WITH EQUIPMENT VENDOR DRAWINGS. REFER TO RISER DIAGRAM 2 ON DRAWING E07-01 FOR ADDITIONAL INFORMATION.
- 6 PROVIDE 2#12, 2#12G & 1#12G IN 3/4" CONDUIT FROM EPO TO SHUNT TRIP DEVICE AT ENCLOSED CIRCUIT BREAKER WITHIN EQUIPMENT ROOM. COORDINATE REQUIREMENTS AND EXACT LOCATION WITH VENDOR DRAWINGS. REFER TO RISER DIAGRAM 2 ON DRAWING E07-01 FOR ADDITIONAL INFORMATION.
- 7 RUN 3/4" CONDUIT IN THE CEILING OF THE FLOOR BELOW FOR POWER WIRING TO NEW FLOOR BOX. COORDINATE EXACT LOCATION WITH EQUIPMENT VENDOR DRAWINGS.
- 8 RUN 1-1/2" CONDUIT IN THE CEILING OF THE FLOOR BELOW FOR LOW VOLTAGE WIRING TO NEW FLOOR BOX. COORDINATE EXACT LOCATION WITH EQUIPMENT VENDOR DRAWINGS.
- 9 PROVIDE NEW 200A TRIP UNIT FOR EXISTING SPARE POWER BREAKER. COORDINATE ALL REQUIREMENTS WITH EQUIPMENT VENDOR DRAWINGS AND FIELD CONDITIONS. REFER TO RISER DIAGRAM 3 ON DRAWING E07-01 FOR ADDITIONAL INFORMATION.

GENERAL DRAWING NOTES:

- 1 REFER TO DRAWING E00-01 FOR LEGEND, SYMBOLS, ABBREVIATIONS, AND ADDITIONAL GENERAL NOTES.
- 2 BRANCH CIRCUIT CONDUCTOR SHALL BE DESIGNED TO UTILIZE THE ADVANTAGE OF MULTI-WIRE DISTRIBUTION, EXCEPT IN PATIENT CARE; HOWEVER, NO MORE THAN (6) CURRENT CARRYING CONDUCTORS (3-PHASE, 3-NEUTRAL) SHALL BE INSTALLED IN A COMMON CONDUIT. ALL BRANCH CIRCUITS (NORMAL AND EMERGENCY) SHALL BE PROVIDED WITH INDIVIDUAL NEUTRALS.
- 3 ISOLATED POWER PANEL BRANCH CIRCUITS SHALL BE LOW LEAKAGE / HIGH DIELECTRIC TYPE INSULATION. THE USE OF FULFILLING COMPOUNDS IS PROHIBITED.
- 4 ALL RECEPTACLES SHALL BE HOSPITAL GRADE.
- 5 ALL EMERGENCY SYSTEM WIRING SHALL BE IN CONDUIT.

GENERAL POWER KEY NOTES:

- 1 CEILING MOUNTED JUNCTION BOX FOR CONNECTION TO BOOM POWER EQUIPMENT. COORDINATE ALL REQUIREMENTS WITH BOOM MANUFACTURER.
- 2 CEILING MOUNTED JUNCTION BOX FOR CONNECTION TO TEL/DATA EQUIPMENT. COORDINATE ALL REQUIREMENTS WITH BOOM MANUFACTURER.
- 3 COORDINATE MOUNTING OF DEVICES AND WIRING WITH STRUCTURAL SUPPORT ABOVE CEILING.
- 4 A PERMANENT, ENGRAVED PLACARD SHALL BE PROVIDED DIRECTLY ADJACENT TO EACH RECEPTACLE INDICATING THE FOLLOWING: NON-ISOLATED POWER FOR NON-PATIENT USE. DO NOT PLUG PATIENT EQUIPMENT INTO DEVICE. EACH DEVICE SHALL BE PROVIDED WITH A BLUE COVER PLATE.
- 5 FOR BDV EQUIPMENT COORDINATE EXACT EQUIPMENT LOCATIONS IN ROOMS. COORDINATE ADDITIONAL REQUIREMENTS WITH EQUIPMENT MANUFACTURER.
- 6 PROVIDE 2" CONDUIT RUN IN WALL TO ABOVE ACCESSIBLE CEILING FOR BDV EQUIPMENT INTEGRATION.

PERKINS + WILL

225 Franklin St., Suite 1100
Boston, MA 02110
1 617 476 0350
1 617 476 0321
www.perkinswill.com

Maine Medical Center
MaineHealth

HYBRID OR #
22 Bramhall Street, Portland, Maine 04102

MEP ENGINEER
AKF GROUP, LLC
99 Bedford Street, 2nd Floor
Boston, MA 02111
1 617 737 1111
1 617 737 4311

STRUCTURAL ENGINEER
SIMPSON GUMPERTZ & HECGER
41 Seyon Street, Building 1, Suite 500
Watnam, MA 02453
1 781 907 9000
1 781 907 9039

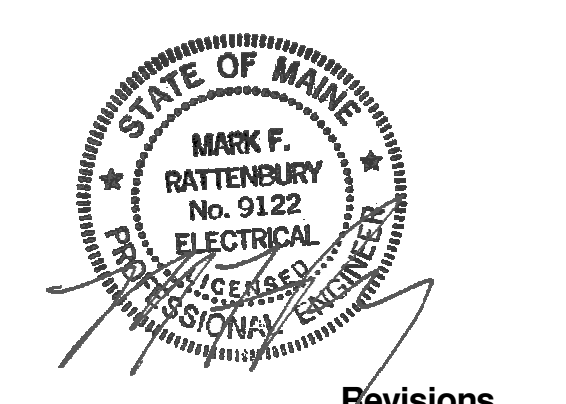
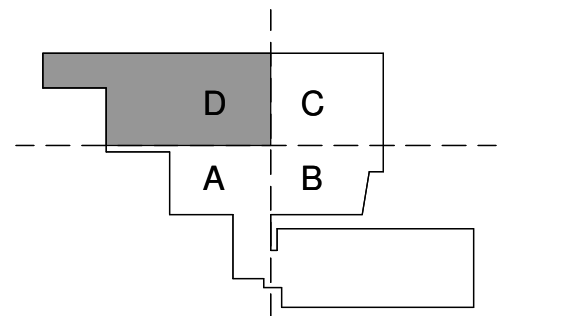

Revisions

NO.	ISSUE	DATE
1	ISSUED FOR PERMIT	08.21.2015
1	ADDENDUM 1	08.21.2015
	ISSUED FOR BID	07.31.2015
NO.	ISSUE	DATE

Sheet Information
Date: JULY 31, 2015
Job #: B150155-000
Drawn: GN
Checked: MR
Approved: MR
Title:

ELECTRICAL BASEMENT POWER PLAN

Sheet
E04-0B

1 ELECTRICAL BASEMENT POWER PLAN
SCALE: 1/4" = 1'-0"

