

OR #6 EQUIPMENT SCHEDULE						
ID	Equipment Name	Dimensions	Plumbing	Emergency Power	Normal Power	Comments
EX-B00	BED (EXISTING)	34" x 25" x 88"H				
EX-B00	BED (EXISTING)	34" x 25" x 88"H				
HOR-250	SUPPLY CART					
HOR-250	SUPPLY CART					
OR6-101	CELL SAVER	16" x 28" x 35"H				
OR6-102	BALLON PUMP	23" x 16" x 31"H				
OR6-103	SET OF NESTING TABLES	24" x 20" x 37"H				
OR6-103	SET OF NESTING TABLES	24" x 20" x 37"H				
OR6-104	TEE MACHINE	22" x 42" x 39"H				
OR6-105	IV POLES	30" x 30" x 56"H				
OR6-105	IV POLES	30" x 30" x 56"H				
OR6-105	IV POLES	30" x 30" x 56"H				
OR6-105	IV POLES	30" x 30" x 56"H				
OR6-106	DEFIBRILLATOR ON WHEELS	20" x 16" x 36"H				
OR6-107	HEAD LIGHT	14" x 12" x 47"H				
OR6-108	ANESTHESIA MACHINE	50" x 25" x 74"H				
OR6-109	ANESTHESIA RED CART	27" x 18" x 32"H				
OR6-110	ANESTHESIA DECK/COMP	26" x 33"				
OR6-111	SLUSH MACHINE	16" x 16" x 37"H				
OR6-112	BLANKET WARMER	16" x 18" x 38"H				
OR6-113	TOWER	24" x 26" x 80"H				

OR #6 EQUIPMENT SCHEDULE						
ID	Equipment Name	Dimensions	Plumbing	Emergency Power	Normal Power	Comments
OR6-114	COMPUTER ON WHEELS	24" x 30" x 66"H				
OR6-114	COMPUTER ON WHEELS	24" x 30" x 66"H				
OR6-115	SUCTION CANISTER	20" x 20" x 37"H				
OR6-116	STANDING STEPS	19" x 13" x 6"H				
OR6-117	PERFUSION HEAT/COOL	22" x 20" x 33"H				
OR6-120	BOVIE	19" x 26" x 30"H				
OR6-120	BOVIE	19" x 26" x 30"H				
OR6-121	SHARPS BUCKET	13" x 18" x 28"H				
OR6-122	SITTING STOOL	18" x 18" x 26"H				
OR6-123	BACK TABLE	52" x 24" x 39"H				
OR6-124	KICK BUCKET	30" x 24"				
OR6-124	KICK BUCKET	30" x 24"				
OR6-125	PERFUSION CHAIR	27" x 21" x 34"H				
OR6-125	PERFUSION CHAIR	27" x 21" x 34"H				
OR6-126	METAL TABLE	36" x 20" x 35"H				
OR6-127	CVAT TABLE	22" x 20" x 33"H				
OR6-128	ACT TABLE	20" x 16" x 34"H				
OR6-130						
OR6-131	PERFUSION PUMP	58" x 25" x 69"H				
OR6-132	PERFUSION SHELF	48" x 20" x 30"H				

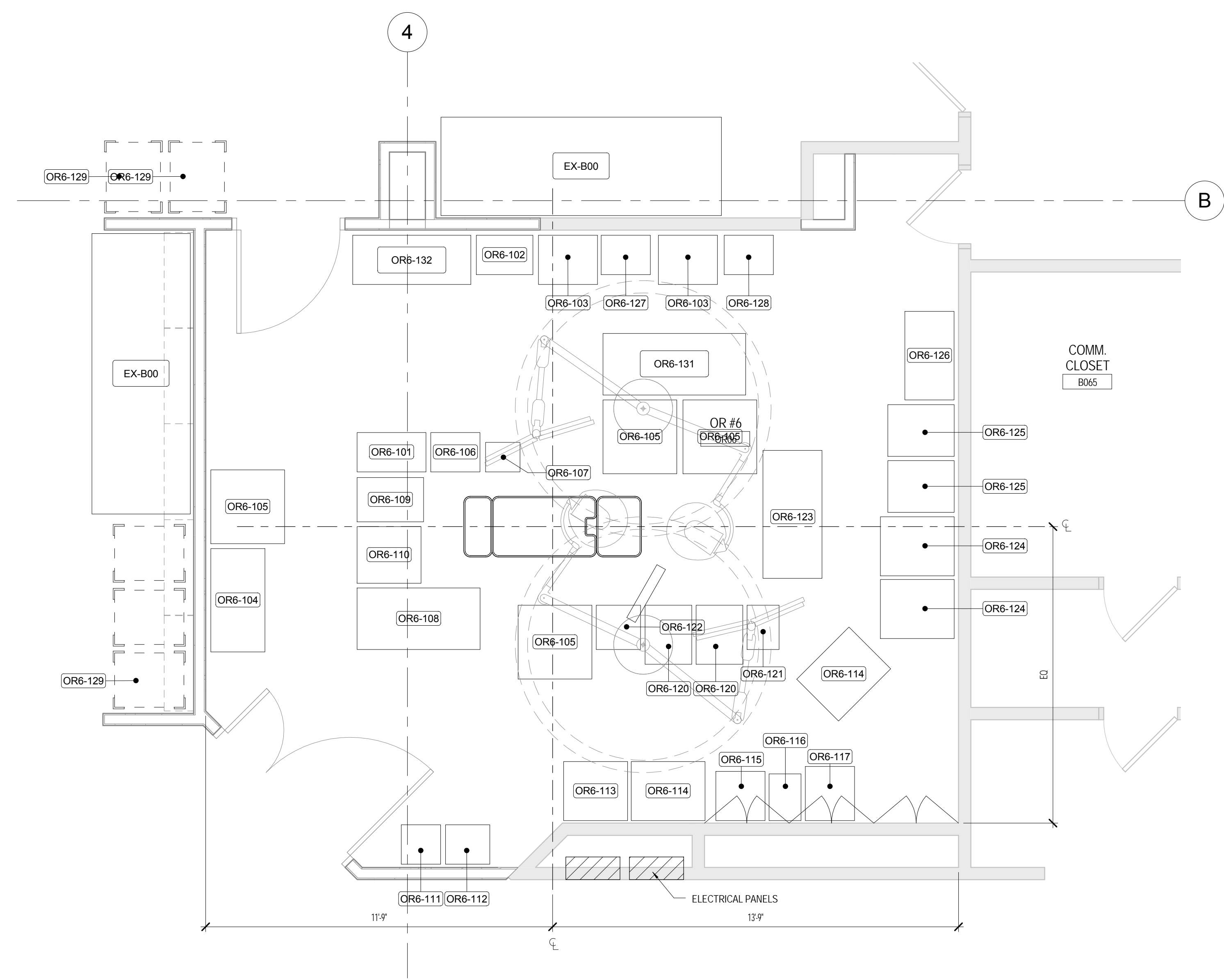

**PERKINS  
+ WILL**

225 Franklin St., Suite 1100  
Boston, MA 02110  
1.617.438.0300  
1.617.438.0521  
www.perkinswill.com



**HYBRID OR #6**  
22 Bramhall Street, Portland, Maine 04102

MEP ENGINEER  
AKF ENGINEERS

41 Farnsworth Street, 3rd Floor  
Boston, MA 02210  
1.617.737.1111  
1.617.737.4311

STRUCTURAL ENGINEER

SIMPSON GUMPERTZ &  
HEGER  
41 Sejon Street, Building 1, Suite 500  
Waltham, MA 02453  
1.781.907.9000  
1.781.907.9099

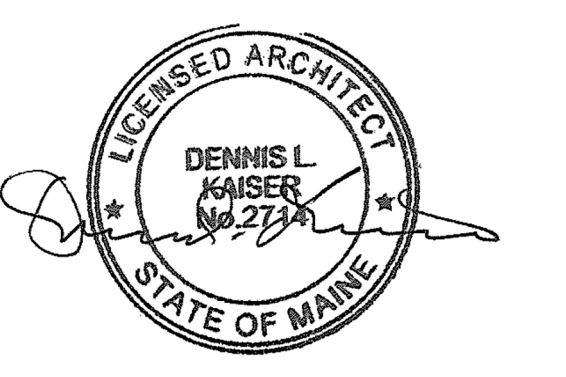
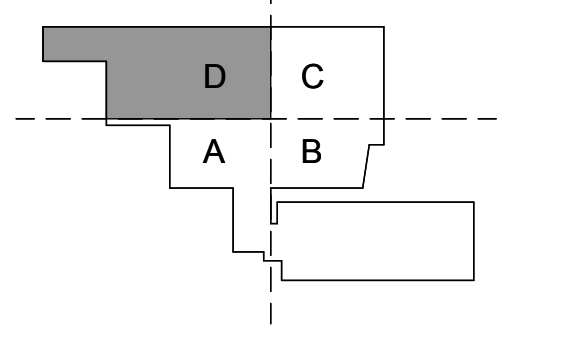

Revisions

Sheet Information	
ISSUED FOR PERMIT	08.21.2015
ISSUED FOR BID	07.31.2015
NO ISSUE	DATE
Date	AUGUST 21, 2015
Job #	152168.023
Drawn	Author
Checked	Checker
Approved	Approver
Title	

**OR #6 EQUIPMENT PLAN**

Sheet  
**A07-0B2**

NOTE:  
PLAN PROVIDED FOR  
COORDINATION ONLY