

**HYBRID OR &
OR #6**
22 Bramhall Street, Portland,
Maine 04102

MEP ENGINEER
AKF ENGINEERS

41 Farnsworth Street, 3rd Floor
Boston, MA 02210
617.737.1111
617.737.4211

STRUCTURAL ENGINEER

SIMPSON GUMPERTZ &
HEGER
41 Seign Street, Building 1, Suite 500
Waltham, MA 02453
781.907.9000
781.907.9099

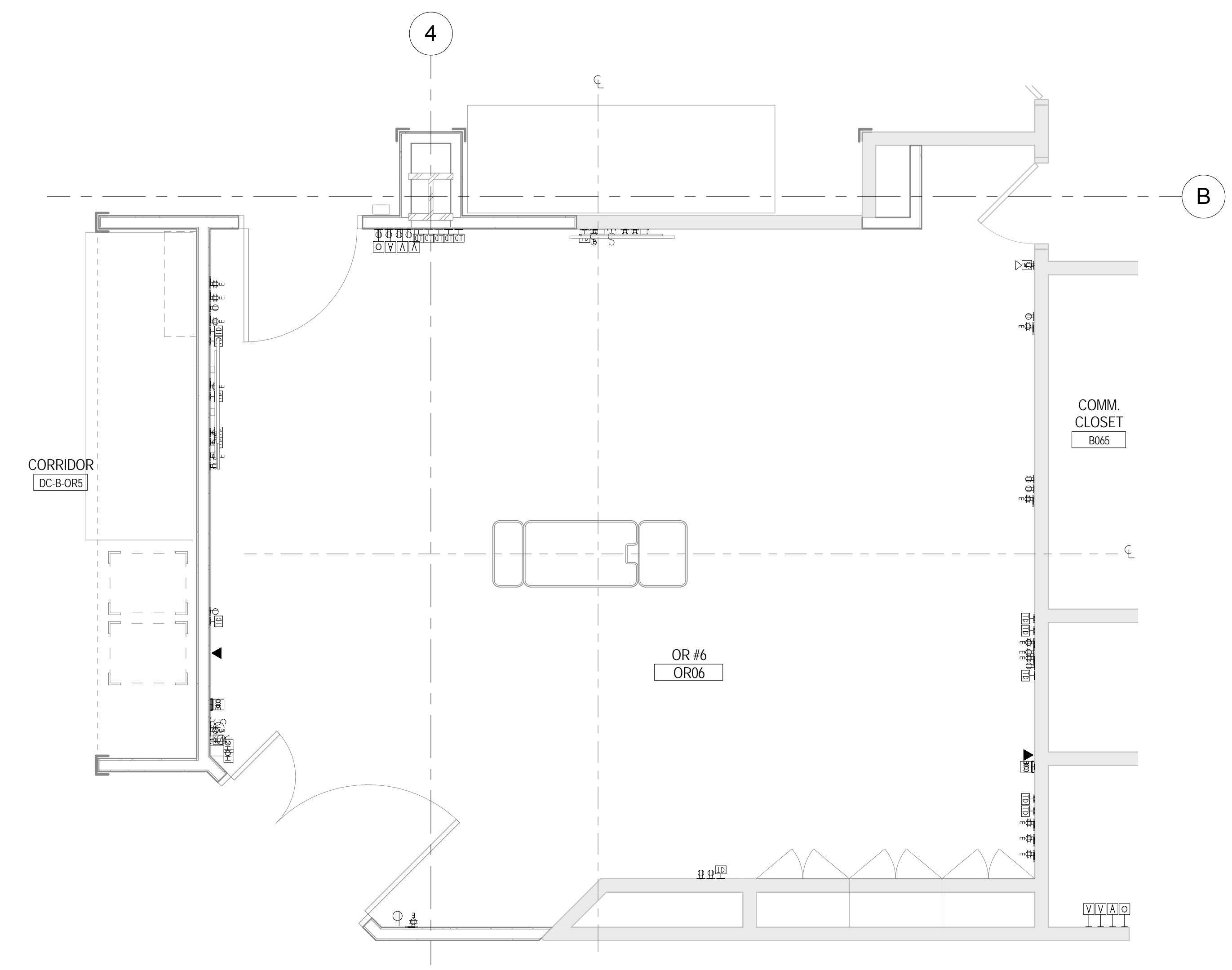

2 OR 6
3/8" = 1'-0"

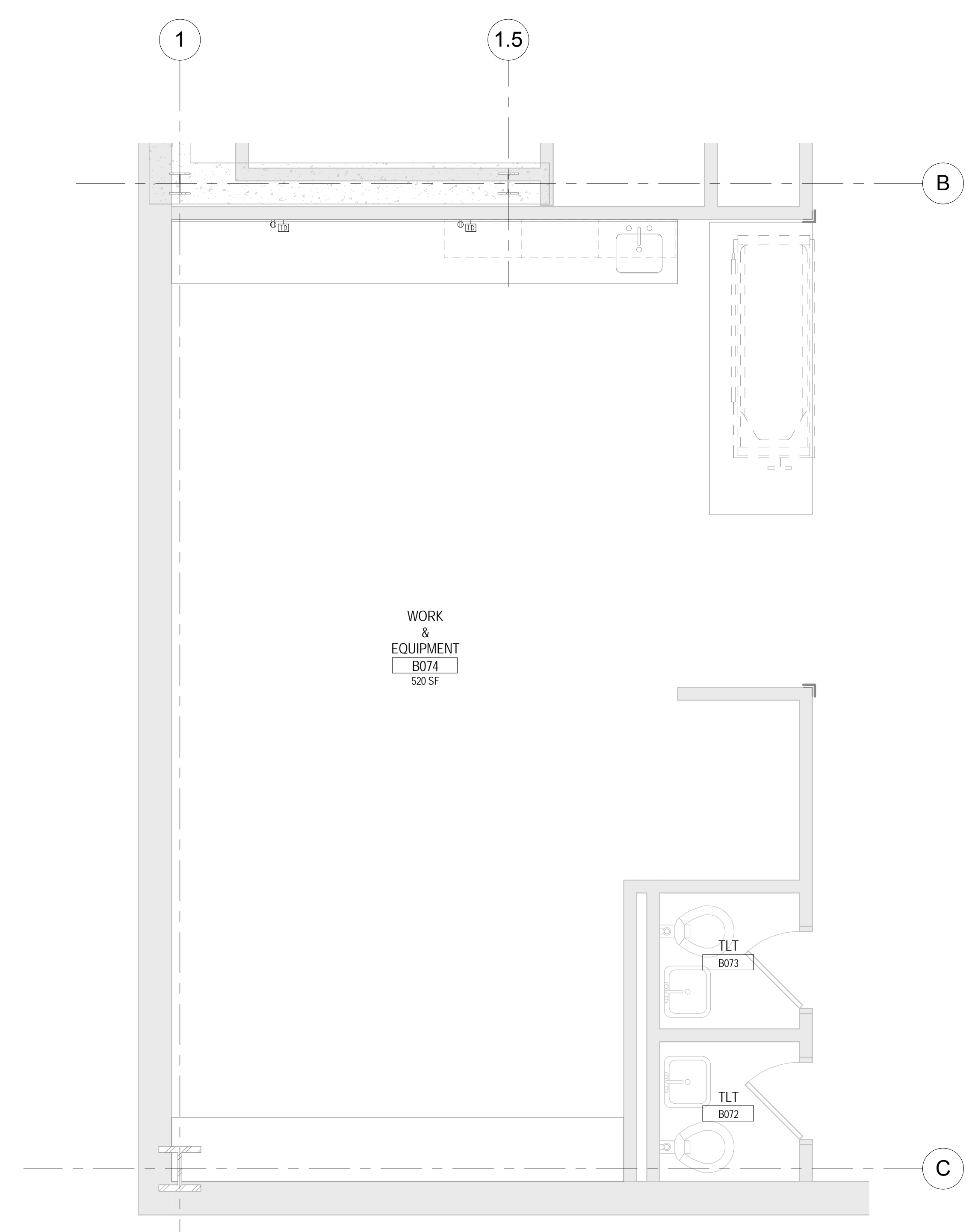

3 ALTERNATE #1 WORK & EQUIPMENT
3/8" = 1'-0"

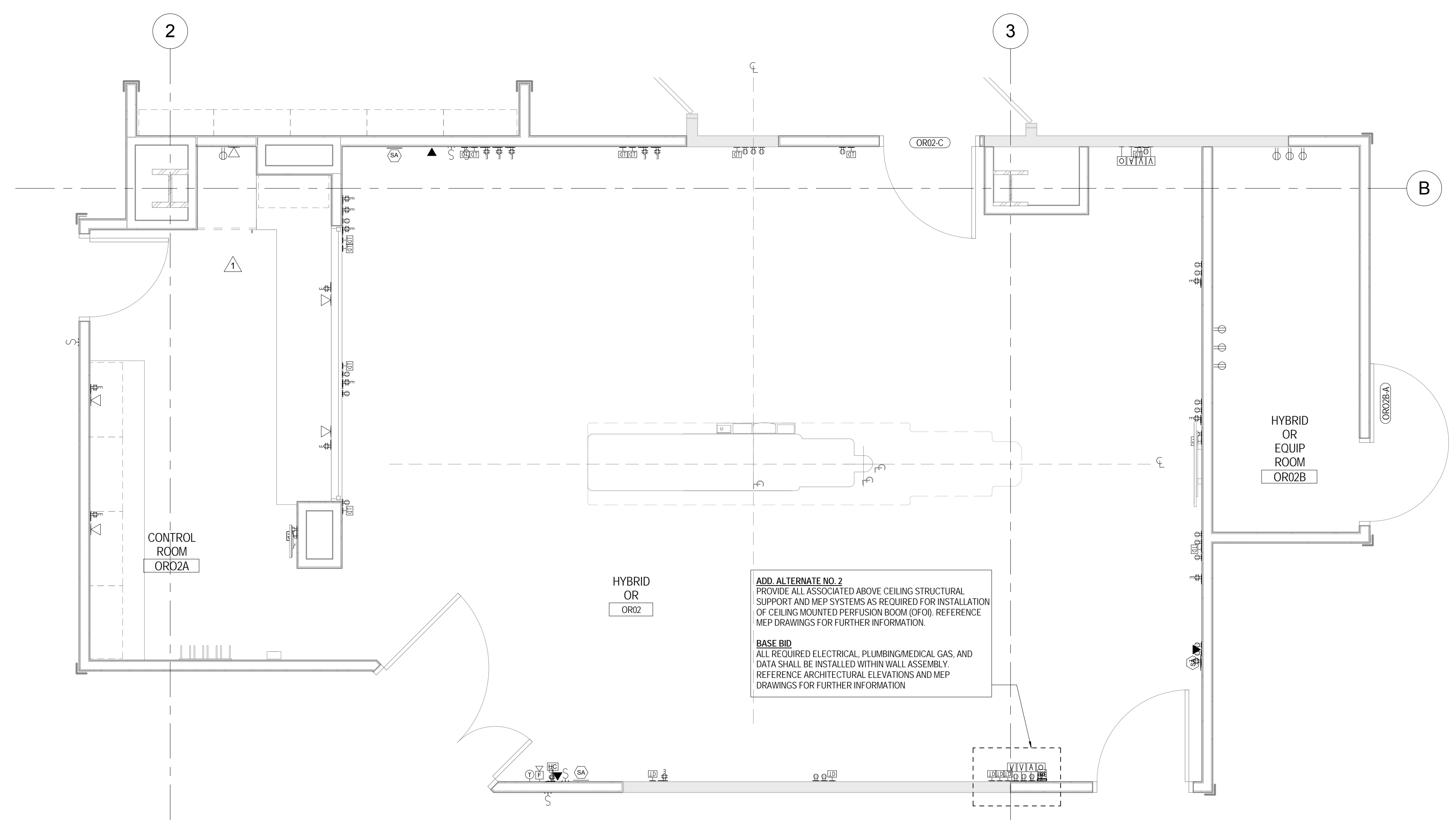

1 HYBRID OR
3/8" = 1'-0"

ADD. ALTERNATE NO. 2
PROVIDE ALL ASSOCIATED ABOVE CEILING STRUCTURAL SUPPORT AND MEP SYSTEMS AS REQUIRED FOR INSTALLATION OF CEILING MOUNTED PERUSION ROOM (OR02). REFERENCE MEP DRAWINGS FOR FURTHER INFORMATION.

BASE BID
ALL REQUIRED ELECTRICAL, PLUMBING, MEDICAL GAS, AND DATA SHALL BE INSTALLED WITHIN WALL ASSEMBLY. REFERENCE ARCHITECTURAL ELEVATIONS AND MEP DRAWINGS FOR FURTHER INFORMATION.

NOTE:
PLAN PROVIDED FOR
COORDINATION ONLY

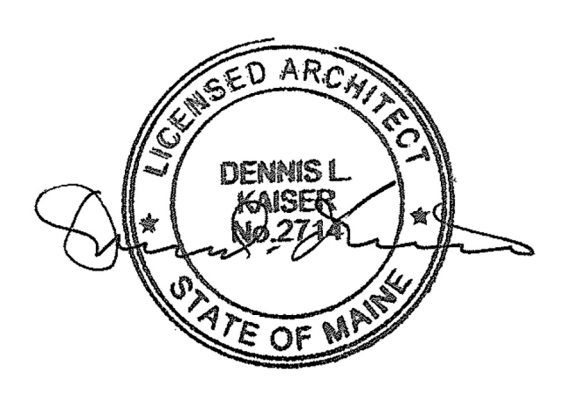

Revisions

ISSUED FOR PERMIT	08.21.2015
1 Addendum 1	08.21.2015
ISSUED FOR BID	07.31.2015
NO ISSUE	DATE

Sheet Information

Date	AUGUST 21, 2015
Job #	152168.023
Drawn	Author
Checked	Checker
Approved	Approver
	Title

**BASEMENT
POWER & DATA
PLAN**

Sheet
A06-0B2