

BOOM SCHEDULE		
ROOM NO.	TAG	BOOM CONFIGURATION
HYBRID OR	1	Tandem Mount Plate with (2) Boom Arms: Equipment Boom Arm with (4) Shelves, Boom Arm with (4) monitors, stacked (2) over (2)
HYBRID OR	2	Spindle Mount with (3) Arms: (1) Surgical Light, (1) Arm with (2) monitors for integration by BDV, and (1) Arm with Lead Shield.
HYBRID OR	3	Add Alternate #2: Equipment Boom: (1) Motor Driven Perfusion Power Boom with all required medical gases, electrical, and data.
HYBRID OR	4	Spindle Mount with (3) Arms: (1) Surgical Light, (1) Arm with (2) monitors for GE Live & Reference, and (1) Arm with Lead Shield.
OR06	5	Spindle Mount with (3) Arms: (2) Surgical Lights and (1) Arm with (2) monitors
OR06	6	Spindle Mount with (3) Arms: (2) Surgical Lights and (1) Arm with (2) monitors

NOTE: SCHEDULE PROVIDED FOR COORDINATION ONLY. ALL BOOMS ARE TO BE OPCI

**REFLECTED CEILING PLAN LEGEND**

- L13 LINEAR SURFACE MOUNTED TL UNDERCABINET TASK LIGHT
- R11 RECESSED CEILING FLOURESCENT TL, ANTI-MICROBIAL
- R12 RECESSED CEILING FLOURESCENT 2 X 2, ANTI-MICROBIAL
- R13 RECESSED CEILING FLOURESCENT 2 X 2
- E EXISTING 2 X 2 TO BE RELOCATED
- ACT-1 2x2 SUSPENDED ACOUSTICAL CEILING
- ACT-2 2x2 SUSPENDED ACOUSTICAL CEILING, WASHABLE, CLIP-DOWN
- EXISTING
- GWB CEILING
- EXPANSION JOINT
- ACCESS PANEL
- ANESTHESIOLOGY PANEL
- SERVICE PANEL
- 2x2 SUPPLY
- 2x4 SUPPLY
- 2x2 RETURN

- FIRE ALARM SPEAKER
- SMOKE DETECTOR
- SPRINKLER
- EXIT SIGN
- NURSE CALLCODE BLUE - CEILING
- NURSE CALLCODE BLUE - WALL
- SECURITY CAMERA (NC)
- BOOM
- OCCUPANCY SENSOR
- PUBLIC ADDRESS SPEAKER
- NURSE CALL LAMP
- PHOTO CELL
- WIRELESS OUTLET
- IV TRACK

**RCP GENERAL NOTES**

- COORDINATE TEES AND HANGER LOCATIONS WITH LINEAR DIFFUSER GRILLE BOOTS
- SPRINKLER HEAD AND COVER TO BE CUSTOM COLORED BY MANUFACTURER TO MATCH ADJ. CEILING FINISH - COLOR TO BE DETERMINED BY ARCHITECT.
- DIFFUSER GRILLE TO BE CUSTOM COLORED TO MATCH ADJACENT CEILING FINISH. COLOR TO BE DETERMINED BY ARCHITECT.
- UNLESS OTHERWISE NOTED, CENTER ALL SUSPENDED CEILING GRIDS WITHIN ROOM.
- CENTER ALL LIGHT FIXTURES, SPRINKLER HEADS, ETC. IN CEILING TILE UNLESS OTHERWISE NOTED.
- SEE ENGINEERING DRAWINGS FOR ADDITIONAL INFORMATION, I.E. LIGHT FIXTURES, DIFFUSERS AND OTHER CEILING MOUNTED DEVICES.
- COORDINATE CEILING MOUNTED EQUIPMENT FINAL LAYOUT WITH OWNER AND VENDOR INSTALLATION DRAWINGS.

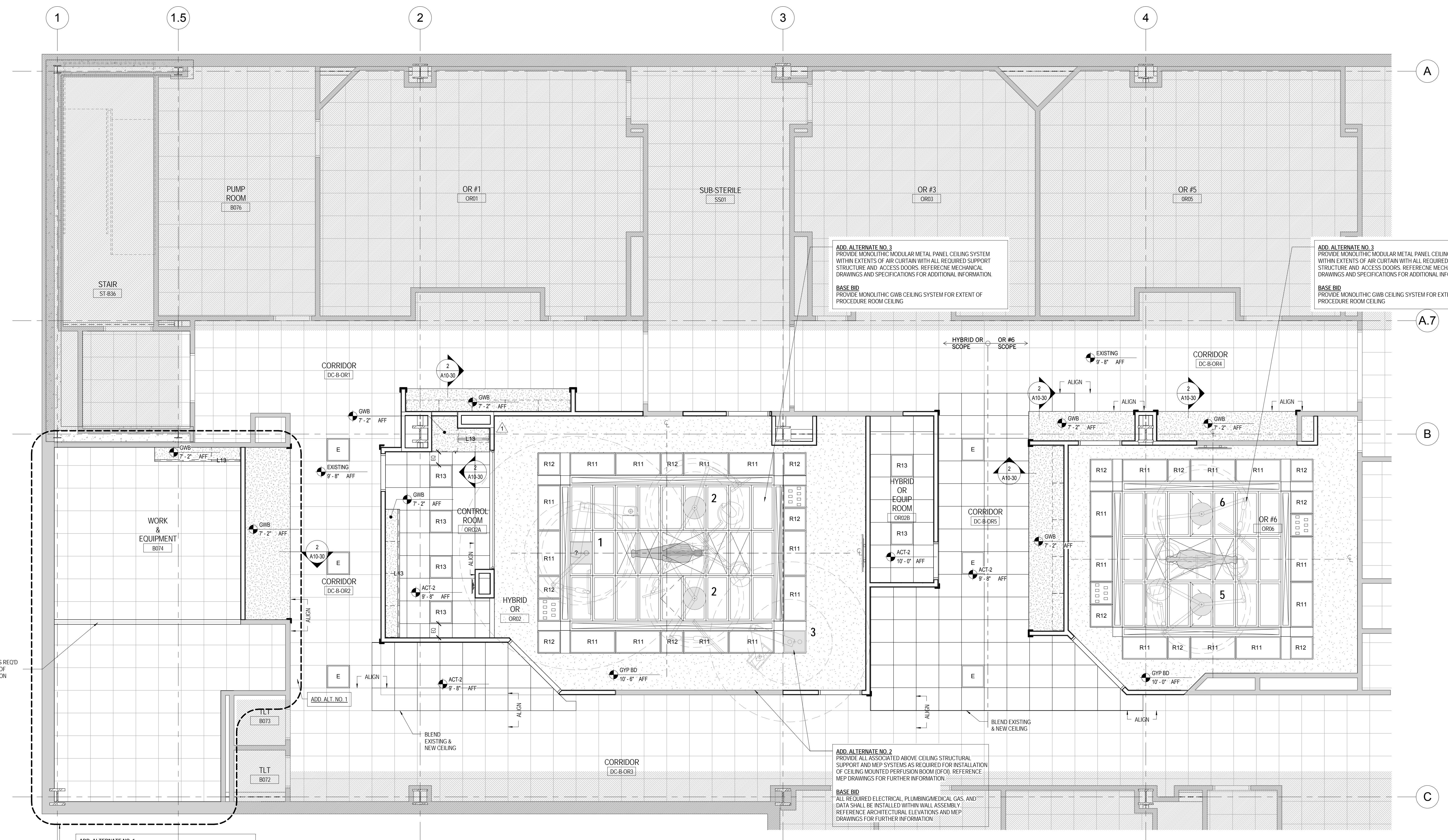

**ADD ALTERNATE NO. 1**  
RENOVATE EXISTING WORK ROOM #B075 AND EQUIPMENT ROOM #B074 TO COMBINE INTO (1) ROOM AS INDICATED WITHIN BOUNDARY. WORK INCLUDES BUT IS NOT LIMITED TO DEMOLITION, NEW PARTITIONS, MODIFICATIONS TO EXISTING FINISHES, AND NEW MILLWORK. REFERENCE MEP DRAWINGS FOR ADDITIONAL INFORMATION.  
**BASE BID**  
EXISTING TO REMAIN. ALL SCOPE OF WORK WITHIN IDENTIFIED BOUNDARY IS TO BE ELIMINATED

**ADD ALTERNATE NO. 3**  
PROVIDE MONOLITHIC MODULAR METAL PANEL CEILING SYSTEM WITHIN EXTENTS OF AIR CURTAIN WITH ALL REQUIRED SUPPORT STRUCTURE AND ACCESS DOORS. REFERENCE MECHANICAL DRAWINGS AND SPECIFICATIONS FOR ADDITIONAL INFORMATION.  
**BASE BID**  
PROVIDE MONOLITHIC GWB CEILING SYSTEM FOR EXTENT OF PROCEDURE ROOM CEILING

**ADD ALTERNATE NO. 3**  
PROVIDE MONOLITHIC MODULAR METAL PANEL CEILING SYSTEM WITHIN EXTENTS OF AIR CURTAIN WITH ALL REQUIRED SUPPORT STRUCTURE AND ACCESS DOORS. REFERENCE MECHANICAL DRAWINGS AND SPECIFICATIONS FOR ADDITIONAL INFORMATION.  
**BASE BID**  
PROVIDE MONOLITHIC GWB CEILING SYSTEM FOR EXTENT OF PROCEDURE ROOM CEILING

**ADD ALTERNATE NO. 2**  
PROVIDE ALL ASSOCIATED ABOVE CEILING STRUCTURAL SUPPORT AND MEP SYSTEMS AS REQUIRED FOR INSTALLATION OF CEILING MOUNTED PERFUSION BOOM (OPCI). REFERENCE MEP DRAWINGS FOR FURTHER INFORMATION.  
**BASE BID**  
ALL REQUIRED ELECTRICAL, PLUMBING/MEDICAL GAS, AND DATA SHALL BE INSTALLED WITHIN WALL ASSEMBLY. REFERENCE ARCHITECTURAL ELEVATIONS AND MEP DRAWINGS FOR FURTHER INFORMATION.

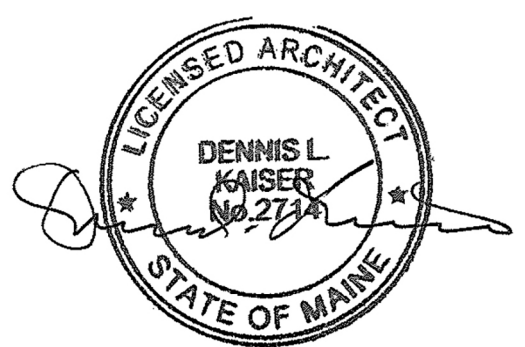
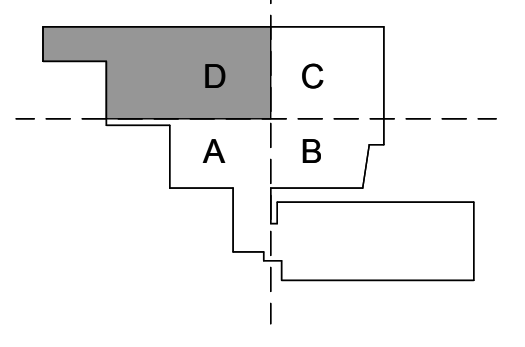

**Revisions**

NO.	ISSUE	DATE
1	ISSUED FOR PERMIT	08.21.2015
1	Addendum 1	08.21.2015
1	ISSUED FOR BID	07.31.2015
NO	ISSUE	DATE

Sheet Information	
Date	AUGUST 21, 2015
Job #	152168.023
Drawn	Author
Checked	Checker
Approved	Approver

**BASEMENT REFLECTED  
CEILING PLAN -  
HYBRID OR & OR 6**

Sheet  
**A05-0B**

**1 BASEMENT REFLECTED CEILING PLAN**  
1/4" = 1'-0"