

**HYBRID OR &
OR #6**
22 Bramhall Street, Portland,
Maine 04102

MEP ENGINEER
AKF ENGINEERS

41 Farnsworth Street, 3rd Floor
Boston, MA 02210
617.737.1111
617.737.4311

STRUCTURAL ENGINEER

SIMPSON GUMPERTZ &
HEGER
41 Seign Street, Building 1, Suite 500
Waltham, MA 02453
781.907.9000
781.907.9099

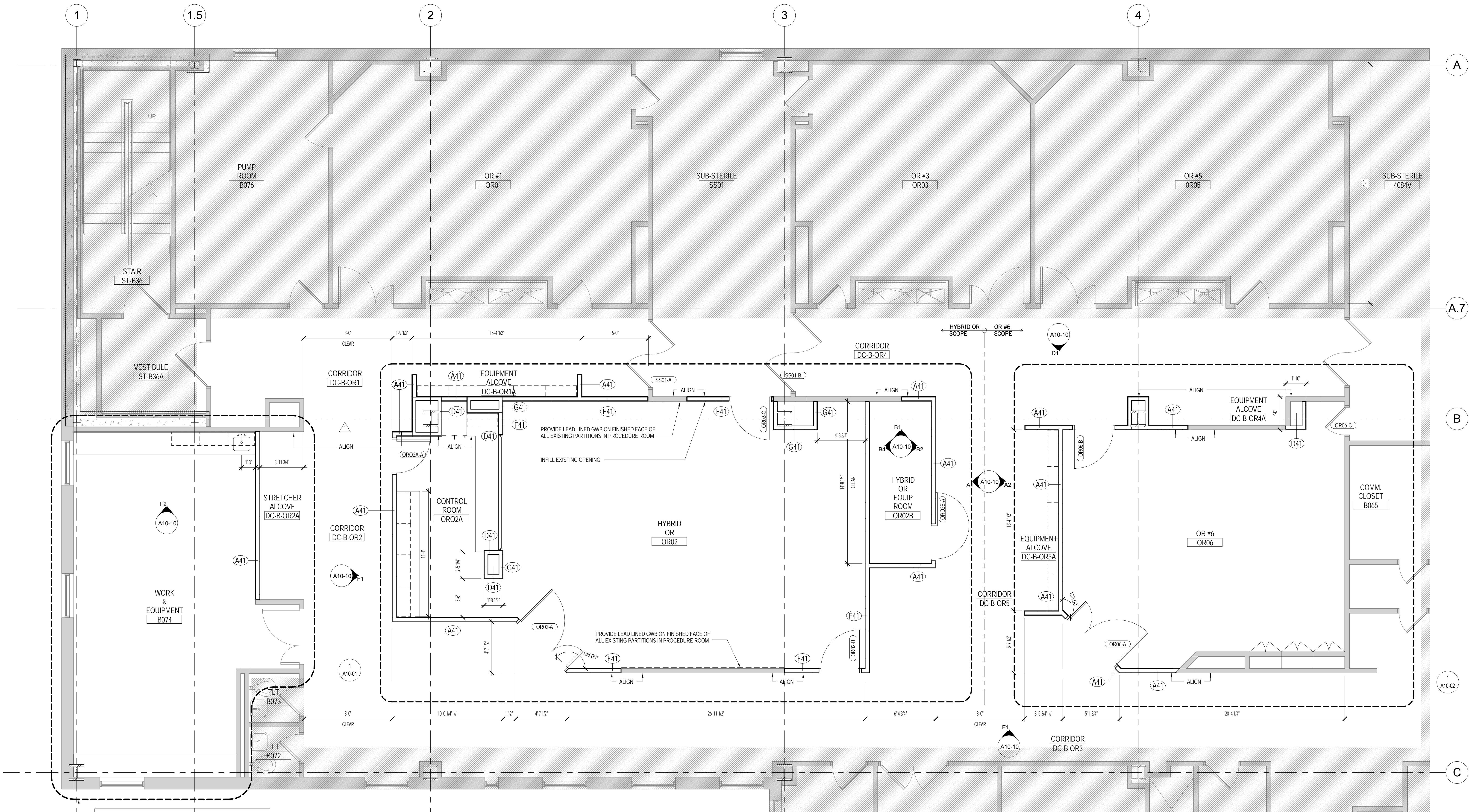

ADD. ALTERNATE NO. 1
RENOVATE EXISTING WORK ROOM #B074 AND EQUIPMENT ROOM #B074 TO COMBINE INTO (1) ROOM AS INDICATED WITHIN BOUNDARY. WORK INCLUDES BUT IS NOT LIMITED TO DEMOLITION, NEW PARTITIONS, MODIFICATIONS TO EXISTING FINISHES, AND NEW MILLWORK. REFERENCE MEP DRAWINGS FOR ADDITIONAL INFORMATION.
BASE BID
EXISTING TO REMAIN. ALL SCOPE OF WORK WITHIN IDENTIFIED BOUNDARY IS TO BE ELIMINATED.

1 BASEMENT PLAN - NEW WORK
1/4" = 1'-0"

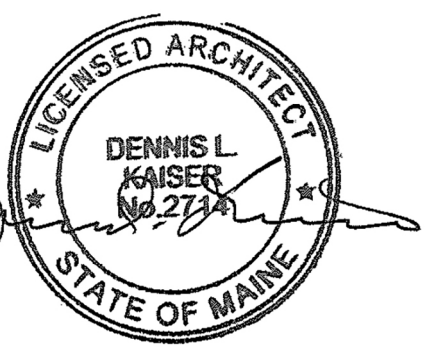
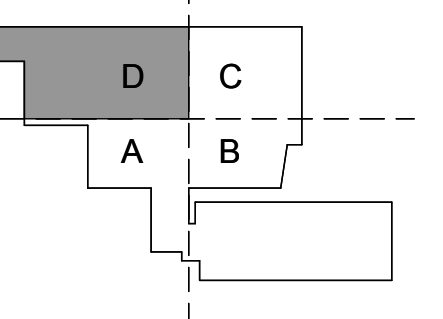

Revisions

Sheet Information	
ISSUED FOR PERMIT	08.21.2015
1 Addendum 1	08.21.2015
ISSUED FOR BID	07.31.2015
NO ISSUE	DATE
Date	AUGUST 21, 2015
Job #	152168.023
Drawn	Author
Checked	Checker
Approved	Approver
Title	

**BASEMENT NEW
WORK PLAN -
HYBRID OR & OR 6**

Sheet
A04-0B