



GENERAL DEMOLITION NOTES

1. THE EXTENT OF THE DEMOLITION WORK INDICATED IN DRAWINGS AND NOTES DESCRIBE THE GENERAL SCOPE OF WORK ONLY AND ARE NOT INTENDED TO BE INCLUSIVE OF ALL THE DEMOLITION WORK WHICH MAY BE REQUIRED TO COMPLETE THE FULL SCOPE OF WORK. VERIFY ALL CONDITIONS IN THE FIELD.
2. EXISTING BUILDING ELEMENTS AND FIXTURES NOT INDICATED FOR REMOVAL ARE TO BE PROTECTED DURING DEMOLITION AND CONSTRUCTION AS REQUIRED. THE CONDITION OF ALL BUILDING FINISHES NOT TO BE ALTERED OR REMOVED ARE TO BE RECORDED PRIOR TO THE START OF DEMOLITION AND CONSTRUCTION.
3. SCHEDULE AND OBTAIN APPROVAL OF THE OWNER, UTILITIES AND LOCAL AGENCIES HAVING AUTHORITY PRIOR TO BEGINNING DEMOLITION WORK.
4. ALL DEMOLITION DEBRIS IS TO BE PLACED IN DUMPSTERS, COVERED, WETTED AND SECURED AS REQUIRED BY MUNICIPAL ORDINANCES PRIOR TO DISPOSAL. COORDINATE AND OBTAIN OWNER'S APPROVAL FOR THE LOCATION OF DUMPSTERS.
5. EXISTING MECHANICAL, ELECTRICAL AND PLUMBING SERVICES NOTED FOR REMOVAL ARE TO BE REMOVED IN THEIR ENTIRETY. PATCH FLOOR OR WALL PENETRATIONS SMOOTH AND FLASH TO FORM A SOUND STRUCTURAL PATCH. NOTIFY THE ARCHITECT IN WRITING OF ANY PENETRATION GREAT THAN 1/2" IN ANY DIRECTION.
6. ALL PARTITIONS INDICATED TO BE REMOVED ARE TO BE COMPLETELY REMOVED FROM FLOOR DECK TO UNDERSIDE OF STRUCTURE.
7. FIRE PROTECTION SYSTEM ON FLOOR TO REMAIN ACTIVE DURING CONSTRUCTION.
8. THE EXISTING STRUCTURE INCLUDING BUT NOT LIMITED TO COLUMNS, BEAMS AND FLOORS ARE NOT TO BE ALTERED OR DAMAGED DURING DEMOLITION OR CONSTRUCTION EXCEPT WHERE INDICATED IN THE DRAWINGS. ANY STRUCTURAL ELEMENTS DAMAGED DURING DEMOLITION OR CONSTRUCTION ARE TO BE REPAIRED TO FULL STRUCTURAL INTEGRITY AND RE-RATED TO MEET THE RESISTIVE RATING BY THE CONTRACTOR AT HIS/HER EXPENSE.
9. ALL EXISTING BUILDING FINISHES, INDICATED TO REMAIN, WHICH ARE DISTURBED BY THE REQUIRED DEMOLITION ARE TO BE PATCHED AND REFINISHED TO MATCH ADJACENT CONDITIONS OR AS INDICATED IN THE FINISH SCHEDULE. PAINT PATCH AND MATCH INDICATES THE FINISH SHALL BE REPAIRED TO MATCH ADJACENT FINISH.
10. AT THE CONCLUSION OF THE DEMOLITION WORK, REMOVE ALL DEBRIS AND SURPLUS MATERIALS AND LEAVE WORK AREA READY TO RECEIVE NEW WORK FINISHES.
11. PROVIDE DUST PROTECTION DURING CONSTRUCTION.
12. COORDINATE ITEMS FOR SALVAGE WITH OWNER.

DEMOLITION KEYNOTES

- 1 REMOVE EXISTING PARTITIONS IN THEIR ENTIRETY, INCLUDING ALL WALL MOUNTED FIXTURES AND ANCHORS.
- 2 REMOVE FINISH OF EXISTING PARTITION FOR INDICATED SIZE TO FACILITATE INSTALLATION OF NEW SYSTEMS IN PARTITION INCLUDING GMB.
- 3 REMOVE DOOR FRAME, GLAZING, AND ALL ASSOCIATED MATERIAL, INCLUDING THRESHHOLD, CORNER GUARDS, CADG READERS, TYPICAL AS DESIGNATED, SALVAGE AS DIRECTED BY OWNER.
- 4 REMOVE EXISTING CASEWORK, MILLWORK, SHELVING, HARDWARE AND/OR ACCESSORIES.
- 5 REMOVE AND DISPOSE OF FLOORING AND ALL ASSOCIATED MATERIALS SUCH AS MATRICS, GELIES, AND OTHER ADHESIVES. REMOVE AND DISPOSE OF PARTITION AND ALL WALL TILE, FLOOR TILE, COVE BASE, TYPICAL AS DESIGNATED, OR TO COORDINATE THE PREPARATION OF EXISTING SLAB TO INCLUDE SANDING, GRINDING, AND LEVELING AS REQUIRED FOR PROPER INSTALLATION OF NEW FLOOR FINISHES.
- 6 REMOVE AND DISPOSE OF ALL CEILING SYSTEMS AND ASSOCIATED PARTS INCLUDING BUT NOT LIMITED TO AC, FRAMING, CLIPS, FASTENERS, GMB, INSULATION, LIGHTING FIXTURES, ETC. TYPICAL AS DESIGNATED, COORDINATE WITH OWNER FOR SALVAGE OF THESE ITEMS. REFERENCE PLUMBING DRAWINGS FOR FURTHER INFORMATION.
- 7 REMOVE EXISTING PLUMBING FIXTURES, SALVAGE FOR OWNER.
- 8 REMOVE AND DISPOSE OF EXISTING WINDOW.
- 9 REMOVE AND SALVAGE EXISTING CEILING MOUNTED GAS AND ELECTRICAL PANELS FOR OWNER.

DEMOLITION LEGEND

- LIMIT OF WORK
- NOT IN SCOPE OF WORK
- - - - - DEMO
- EXISTING TO REMAIN

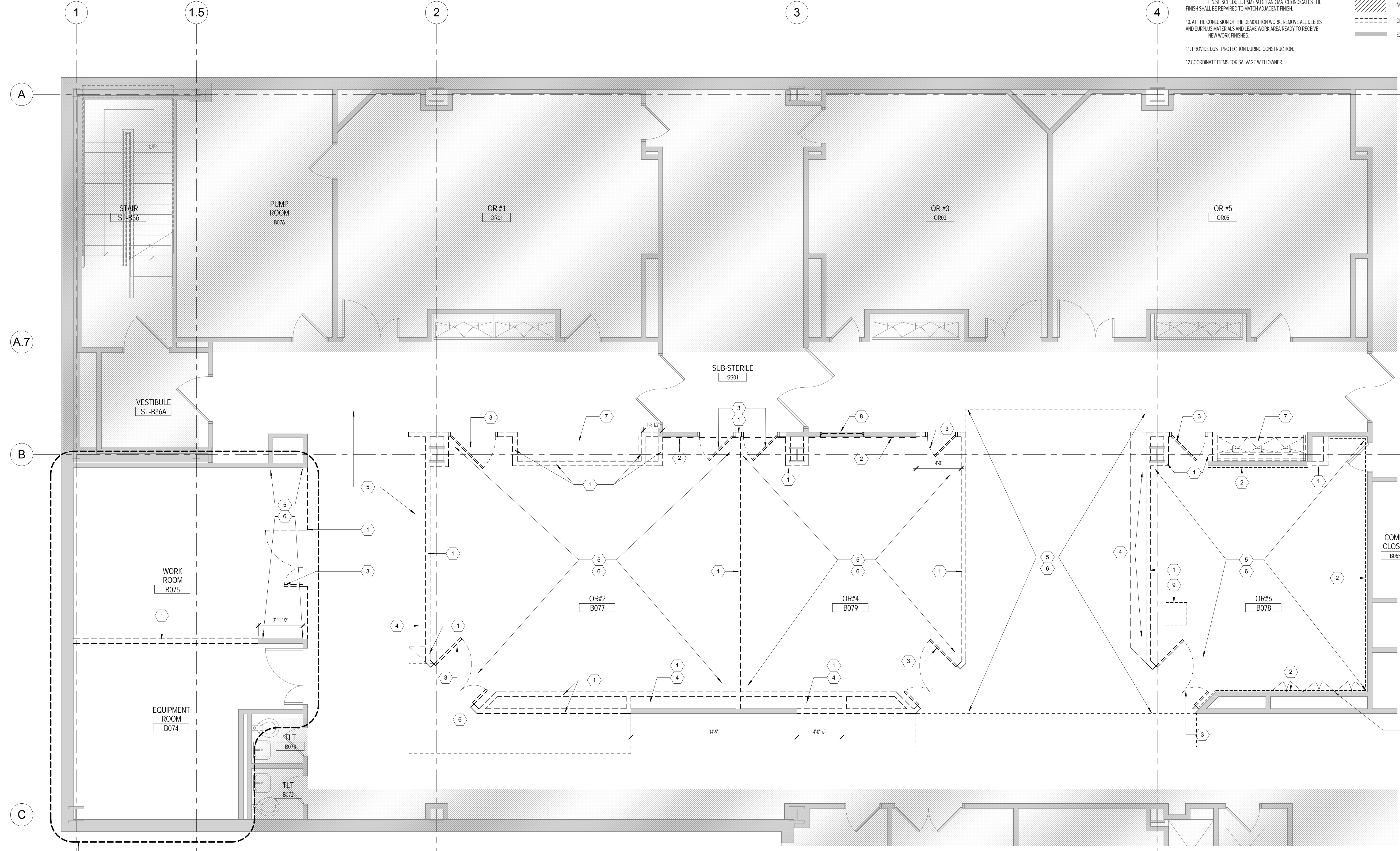

ADD ALTERNATE NO. 1
 RENOVATE EXISTING WORK ROOM #B075 AND EQUIPMENT ROOM #B074 TO COMBINE INTO (1) ROOM AS INDICATED WITHIN BOUNDARY. WORK INCLUDES BUT IS NOT LIMITED TO DEMOLITION, NEW PARTITIONS, MODIFICATIONS TO EXISTING FINISHES, AND NEW MILLWORK. REFERENCE MEP DRAWINGS FOR ADDITIONAL INFORMATION.

BASE BID
 EXISTING TO REMAIN. ALL SCOPE OF WORK WITHIN IDENTIFIED BOUNDARY IS TO BE ELIMINATED.

1 DEMOLITION PLAN
 1/4" = 1'-0"

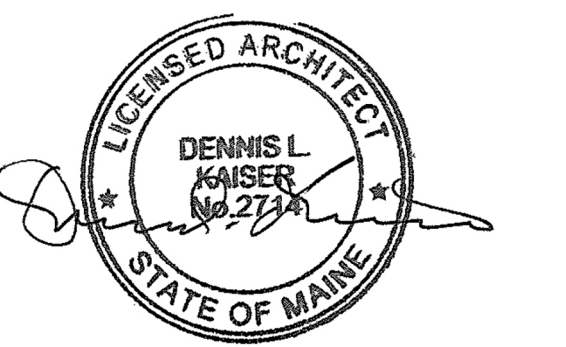
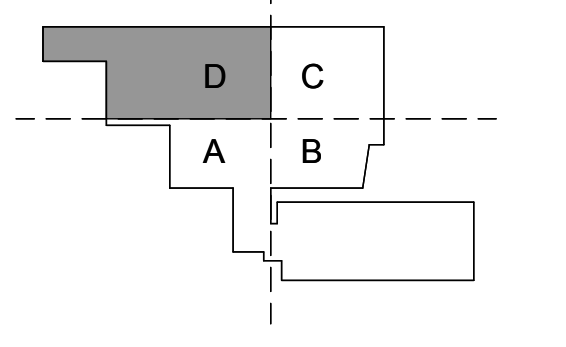

Revisions

ISSUED FOR PERMIT	08.21.2015
ISSUED FOR BID	07.31.2015
NO ISSUE	DATE
Sheet Information	
Date	AUGUST 21, 2015
Job #	152168.023
Drawn	Author
Checked	Checker
Approved	Approver

BASEMENT DEMOLITION PLAN - HYBRID OR & OR #6

Sheet A03-0B