



Winton Scott Architects
5 Milk Street
Portland, Maine 04101
207 774 4811
www.wintonsscott.com

Architecture / Planning
Preservation Architecture
Interior Architecture



Allied Engineering
Structural Mechanical Electrical Consulting

160 Veranda Street
Portland, Maine 04103
T: 207 231 2500
F: 207 231 2506
Web: www.allied-eng.com

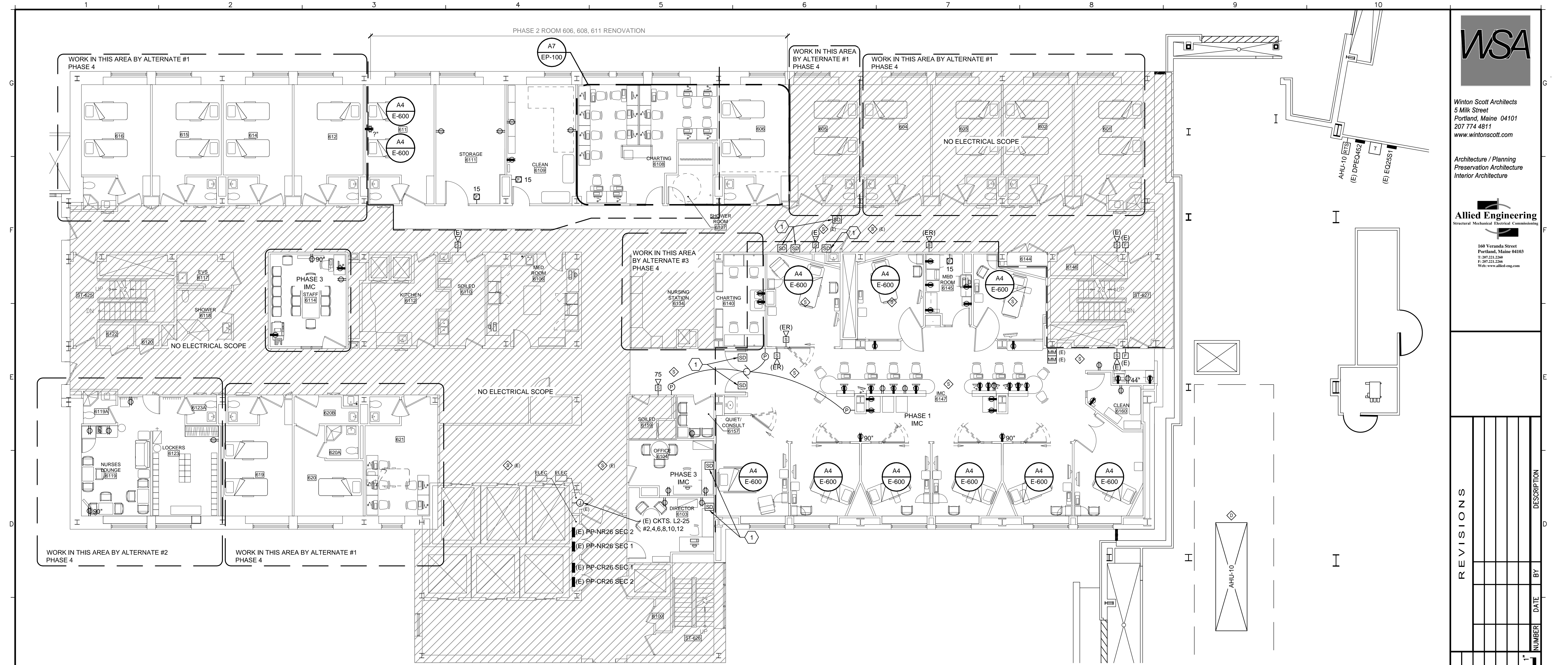

B1		POWER & SYSTEMS PLAN	
SCALE: 1/8"=1'-0"			
A5		KEY NOTES	
NOT TO SCALE		<p>1 SMOKE DAMPER TO BE EXTENDED AND CONNECTED TO EXISTING FIRE ALARM SYSTEM. PROVIDE CONTROL MODULES AND CONNECTION TO AIR HANDLER UNIT CONTROLLER FOR UNIT SHUT DOWN. PROVIDE 120V CRITICAL BRANCH CIRCUIT FOR ACTUATOR OPERATION.</p>	
A7		DETAIL	
SCALE: 1/8"=1'-0"			

REVISIONS	NUMBER	DATE	BY	DESCRIPTION

Date: _____
 Drawn By: GMC
 Checked By: SRM
 Project Mgr: _____
 Project No: _____
 Cad File: 14014_E.dwg
 Graphic Scale: 0' = 1"
 Scale: _____

ELECTRICAL POWER & FIRE ALARM PLAN

R6 Intermediate Care Unit
 Richards Wing Sixth Floor
 PORTLAND, MAINE

EP-100

PERMIT SET ~ 03 APRIL 2015 - NOT FOR CONSTRUCTION

N:\Projects\2014\14014 - MMC R6 2014 Intermediate Care Unit\00 Drawing Files\14014_E.dwg Apr 03, 2015 - 12:22pm