

GE EQUIPMENT LISTING

ITEM NO.	QUANTITY ORDERED	REFER TO SHEET "D"	ITEM DESCRIPTION (* = EXISTING/REINSTALL)	WEIGHT	HEAT OUTPUT (PER HOUR)	DETAIL NO.	EQUIPMENT CROSS REFERENCE CHART	
							STRC PLAN	ELEC PLAN
1			REAR CABLE COVER			B8141		
2			INJECTOR HEAD ON PEDESTAL	44 lbs		B8007A		IH
3			INJECTOR CONTROL AND ELECTRONICS	22 lbs	320 btu	E8007N		IE S
4			UPS SYSTEM	619 lbs	5122 btu	B7864PZ		
5			OPTIMA DESK	125 lbs		B7818G		DC S
6			CONSOLE CABINET & LCD MONITORS	216 lbs	3201 btu	B8105		S
7			OPERATOR'S CHAIR					
8			POWER DISTRIBUTION UNIT	798 lbs	1706 btu	B7858D		PM S
9			STORAGE CABINET (EMPTY CABINET WEIGHT)	99 lbs		M33005		
10			REVOLUTION DISCOVERY CT/ DISCOVERY CT GANTRY (BTU'S INCLUDE GANTRY & TABLE)	3884 lbs	33297 btu	B7864D B7864E B7864F B7864J B7864K	B78 67	CTT C
11			VT2000(X) PATIENT TABLE W/EXTENDED TABLE TOP (W/D PATIENT)	1113 lbs		B7920		

THE FOLLOWING ITEMS, WHICH HAVE BEEN ORDERED FROM GE HEALTHCARE, ARE TO BE INSTALLED BY THE CUSTOMER OR HIS CONTRACTOR.

1			MAIN DISCONNECT CONTROL CAT NO. E4502AB (IF A UPS IS NOT ORDERED, THE E4502AD CAN BE USED.)	132 lbs		E4502AE		A1	C
---	--	--	---------------------------------------------------------------------------------------------------	---------	--	---------	--	----	---

SCALE: 1/4" = 1'-0"

EQUIPMENT LAYOUT

RECOMMENDED CEILING HEIGHT = 9'-0"

This equipment layout indicates the placement and interconnection of the indicated equipment components. There may be federal, state, and/or local requirements that could impact the placement of these components. It remains the Customer's responsibility for ensuring the site and final equipment placement complies with all applicable federal, state, and/or local requirements.

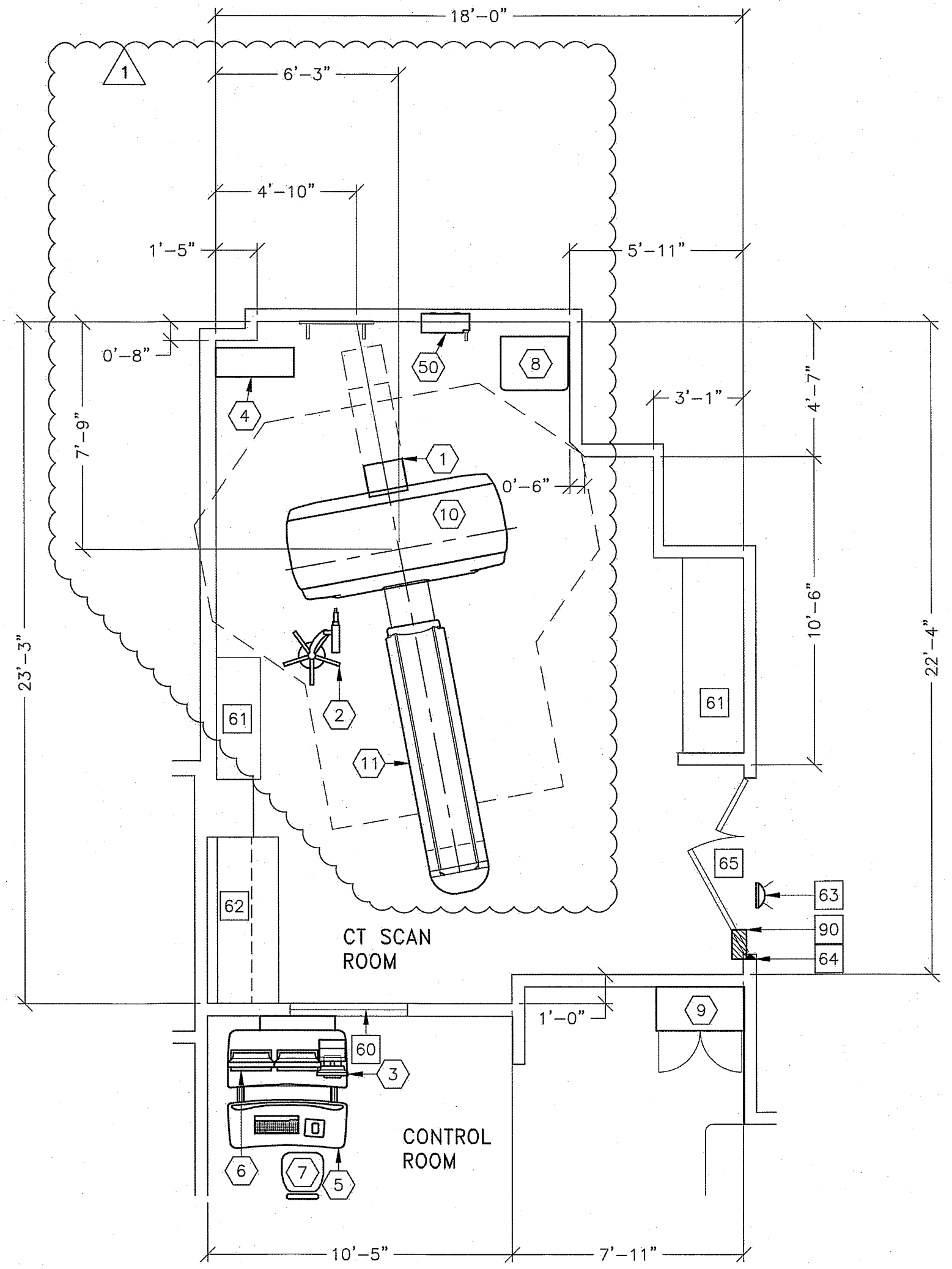

ANCILLARY ITEMS

CUSTOMER/CONTRACTOR SUPPLIED AND INSTALLED ITEMS

ITEM NO.	ITEM DESCRIPTION (* INDICATES EXISTING)
60	LEAD GLASS WINDOW
61	COUNTER TOP WITH BASE CABINETS
62	COUNTER TOP WITH BASE AND WALL CABINETS
63	X-RAY ON WARNING LIGHT - AVAILABLE FROM GE SUPPLY CALL: 800-200-9760 GE CAT. NO. WX1ABWV-DF-XIU
64	DOOR LIMIT SWITCH (REQUIRED IN SOUTH CAROLINA, OTHERWISE NEEDED ONLY IF REQUIRED BY STATE/LOCAL CODES)
65	MINIMUM DOOR OPENING FOR EQUIPMENT DELIVERY IS 44 IN. W X 89 IN. H (1118mm X 2108mm), CONTINGENT ON A 96 IN. (2438mm) CORRIDOR WIDTH
66	X-RAY ROOM WARNING LIGHT CONTROL PANEL REFERENCE JUNCTION POINT 'VLC' ON SHEET 'E1' FOR DETAILED DESCRIPTION -E4502RL FOR WARNING LIGHT CONTROL ONLY.

THE FOLLOWING ITEMS ARE AVAILABLE FROM GE HEALTHCARE TECHNOLOGIES. CONTACT YOUR LOCAL GE HEALTHCARE SERVICE REPRESENTATIVE FOR PRICING AND AVAILABILITY.

GENERAL SPECIFICATIONS

- THE REQUIRED CEILING HEIGHT INDICATED ON THESE PLANS IS TO ENSURE EQUIPMENT FUNCTION IS NOT INHIBITED. CONSULT WITH YOUR LOCAL GEHC SPECIALIST REGARDING ACCEPTABILITY OF OTHER CEILING HEIGHTS.
- CHECK ALL DOOR OPENINGS AND HALLWAYS FROM DELIVERY LOCATION TO WHERE EQUIPMENT IS TO BE INSTALLED TO ENSURE THE ROUTE PHYSICALLY AND STRUCTURALLY WILL ACCOMMODATE THE EQUIPMENT AS SHIPPED.
- RADIATION PROTECTION REQUIREMENTS ARE NOT INDICATED ON THIS PLAN. WHERE NEEDED PER NATIONAL OR LOCAL CODE THEY SHALL BE SPECIFIED BY A QUALIFIED RADIOLOGICAL PHYSICIST.
- THE DEVELOPMENT OF THE EQUIPMENT LAYOUT, ROOM DIMENSIONS, MECHANICAL AND ELECTRICAL SUGGESTIONS IS PREDICATED UPON THE BEST INFORMATION OBTAINABLE FROM THE SITE, COUPLED WITH THE CUSTOMER'S KNOWN DESIRES. ARCHITECTURAL OR ELECTRICAL CHANGES INCLUDING RELOCATION OF EQUIPMENT ILLUSTRATED ON THIS DRAWING IS ALLOWED ONLY WITH NOTIFICATION, IN WRITING, AND REVIEW BY GEHC SERVICE DEPARTMENT. EQUIPMENT OPERATION, SERVICEABILITY, AND RESTRICTING CABLE LENGTHS, ETC., MAKE THIS ESSENTIAL FOR A PROPER IS. GEHC RESERVES THE RIGHT TO MAKE ON THE JOB CHANGES BECAUSE OF CUSTOMER REQUIREMENTS AND/OR OBSTACLES IN CONSTRUCTION, ETC..
- ALL WORK TO BE IN COMPLIANCE WITH NATIONAL AND LOCAL BUILDING SAFETY CODES.
- DIMENSIONS ARE TO FINISHED SURFACES OF ROOM

SITE ENVIRONMENT SPECIFICATIONS

- AMBIENT OPERATING TEMPERATURE:  
SCAN ROOM: TEMPERATURE RANGE 64°-79° F (18°-26° C)  
CONTROL ROOM: MAINTAIN TEMPERATURE AT 64°-79° F (18°-26° C)  
EQUIPMENT ROOM (IF SEPARATE): TEMPERATURE RANGE 64°-79° F (18°-26° C)
- HUMIDITY: 30 TO 60 PERCENT NON-CONDENSING DURING OPERATION (ALL AREAS)
- MAXIMUM TEMPERATURE RATE OF CHANGE OF 5° F (3° C)/HOUR.
- MAXIMUM RELATIVE HUMIDITY RATE OF CHANGE IS 5 PER CENT RH/HOUR.
- ALTITUDE: NOT TO EXCEED 7,875 FT. (2400M) ABOVE SEA LEVEL.
- THE ENVIRONMENT FOR THE ELECTRONICS CABINET MUST BE CONTROLLED SO THE ABOVE RESTRICTIONS ARE NOT EXCEEDED.
- DO NOT RESTRICT THE AIR INTAKE OR AIR EXHAUST OF THE SYSTEM COMPONENTS.
- ENVIRONMENTAL CONDITIONS LISTED ABOVE MUST BE MAINTAINED AT ALL TIMES INCLUDING FOR EXAMPLE OVERNIGHT, WEEKENDS, AND HOLIDAYS.

MAGNETIC INTERFERENCE SPECIFICATIONS

- CT GANTRY MUST BE LOCATED IN AMBIENT STATIC MAGNETIC FIELDS OF LESS THAN 1 GAUSS TO GUARANTEE SPECIFIED IMAGING PERFORMANCE. AMBIENT AC MAGNETIC FIELDS MUST BE BELOW 0.01 GAUSS PEAK.
- CT COMPUTER EQUIPMENT MUST BE LOCATED IN AMBIENT STATIC MAGNETIC FIELDS OF LESS THAN TEN GAUSS TO GUARANTEE DATA INTEGRITY.
- CT CONTROL EQUIPMENT MUST BE LOCATED IN AMBIENT STATIC MAGNETIC FIELDS OF LESS THAN LISTED BELOW TO OBTAIN SPECIFIED GEOMETRIC LINEARITY.  
CONSOLE/COMPUTER 10 GAUSS

**GE Healthcare**  
Healthcare Project Implementation - Design Center  
Milwaukee, Wisconsin

SHEET TITLE: EQUIPMENT LAYOUT  
MODALITY TYPE: REVOLUTION GSI  
THIS PLAN IS SUBMITTED TO SUGGEST LOCATION OF GE HEALTHCARE EQUIPMENT. AN ASSURANCE OF PROPER INSTALLATION AND PERFORMANCE IS NOT GUARANTEED. THE COMPANY CANNOT BE HELD RESPONSIBLE FOR ANY DAMAGES RESULTING THEREFROM.

PROJECT TITLE:  
**MAINE MEDICAL CENTER**  
PORTLAND, MAINE

PROJECT	REVISION
144013	01

DATE: 08.Dec.14  
DRAWN BY: ECW  
CHECKED BY: JGA  
CON NO: 4264840  
CON DT: 30.Dec.14

REVISION HISTORY:  
1 ECW - 02.Jan.15  
CHECKED BY: JGA

SHEET  
**A1**

GE Project Manager: JIM DOMBROSKI  
Telephone: 603-934-3739  
THE GE HPI TECHNICAL SUPPORT GROUP IS AN ADDITIONAL RESOURCE THAT CAN PROVIDE ANSWERS FOR GENERAL GE PRODUCT SITING QUESTIONS AND CAN BE REACHED AT (877)-305-9477 OR MAIL TO:GEHPI@GE.COM

THIS SHEET IS PART OF THE DOCUMENT SET LISTED ON SHEET C1 AND SHOULD NOT BE SEPARATED