

4/24/2014 4:28:45 PM
c:\temp\15216504_MMC_CSD_careys.rvt

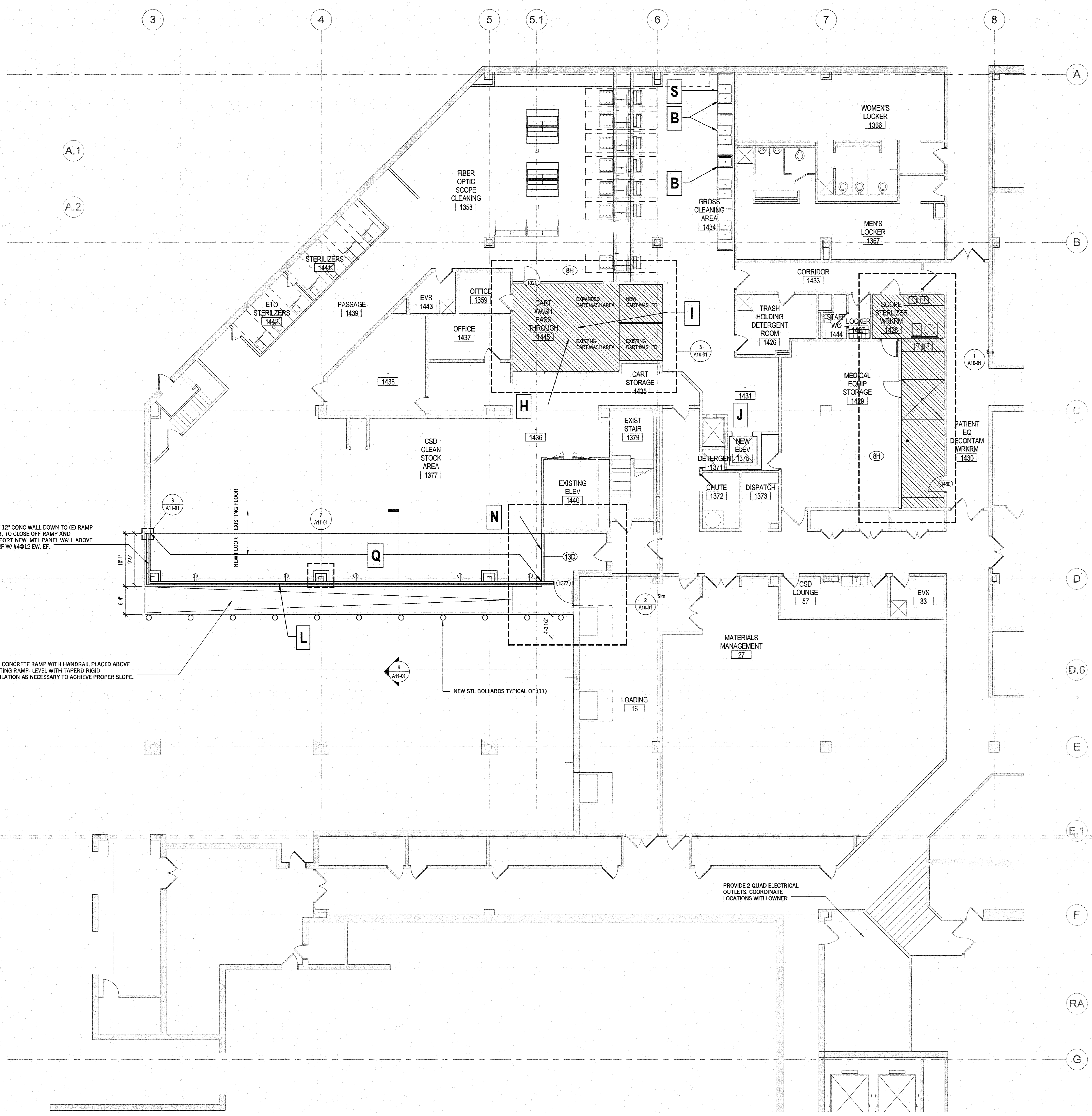

NEW 12" CONC WALL DOWN TO (E) RAMP SLAB, TO CLOSE OFF RAMP AND SUPPORT NEW MTL PANEL WALL ABOVE REINF W/ #4@12 EW, EF.

NEW CONCRETE RAMP WITH HANDRAIL PLACED ABOVE EXISTING RAMP- LEVEL WITH TAPERED RIGID INSULATION AS NECESSARY TO ACHIEVE PROPER SLOPE.

NEW STL BOLLARDS TYPICAL OF (11)

PROVIDE 2 QUAD ELECTRICAL OUTLETS, COORDINATE LOCATIONS WITH OWNER

- GENERAL NOTES**
- NEW CONSTRUCTION PLAN**
- A. RELOCATE SCOPE STERILIZER.
 - B. INSTALL NEW SS DECONTAMINATION SINK- DIMENSIONS TO BE PER OWNER DIRECTION- PATCH FLOOR AND WALL AS NECESSARY TO MATCH EXISTING SURROUNDING FINISHES
 - C. NEW WALL AND BASE- PAINT TBD.
 - D. NEW DOOR- TYPE TBD
 - E. RELOCATED SS COUNTERTOP AND SS SINK AND SS FAUCET
 - F. NEW SLOPED WATERPROOF FLOOR AND SIGOT (SIMILAR TO EXISTING REMOVED)
 - G. NEW WATERPROOF FLOORING- PREPARE SLAB IN SHADED AREA INDICATED ON PLAN
 - H. PROVIDE NEW WATERPROOF FLOORING FOR AREA INDICATED- PREPARE SLAB FOR NEW FLOORING AS REQUIRED.
 - I. INSTALL NEW CART WASHER AND ASSOCIATED PLUMBING AND ELEC SERVICE DEPRESS (E) SLAB UNDER NEW CART WASH STATION APPROX 8" DOWN. SHAV OUT AND DEMO (E) SLAB. DICHONATE DOWN AND RECAST 8" SLAB- ON-GRADE WITH #3@ 15 O.C. EACH WAY. DRILL AND DOVEL REBAR INTO PERIMETER SLAB EDGE
 - J. NEW MATERIAL LIFT AND SHAFT NOT IN SCOPE- REFER TO P-W BEAN 2 ROOF ADDITION PROJECT
 - K. NEW GWB PARTITION
 - L. NEW EXTERIOR INSL. METAL PANEL WALL
 - M. NEW SEALED CONC SLAB
 - N. RELOCATE AND CONNECT DATA SYSTEM
 - O. LEVEL EXISTING CONC SLAB AS NECESSARY
 - P. NEW SHEET FLOORING TO MATCH EXISTING
 - Q. NEW SHEET FLOORING TO MATCH EXISTING
 - R. NEW EXTERIOR DOOR
 - S. RELOCATE EXISTING SINK TO INDICATED LOCATION ADJACENT TO NEWLY INSTALLED SINK

PERKINS + WILL

55 Court St., 2nd Floor
Boston, MA 02108
1917.478.0330
1617.478.0321
www.perkinswill.com

Maine Medical Center
MaineHealth

CSD RENOVATION
22 Bramhall Street, Portland, Maine 04102

MEP ENGINEER
AKF ENGINEERS
41 Farnsworth Street, 3rd Floor
Boston, MA 02210
1617.737.1111
1617.737.4311

STRUCTURAL ENGINEER
SIMPSON GUMPERTZ & HEGER
41 Seyon Street, Building 1, Suite 500
Waltham, MA 02453
1781.507.5000
1781.507.8000

CIVIL ENGINEER / LANDSCAPE ARCHITECT
SEBAGO TECHNICS
1 Chubot Street, PO Box 1339
Westbrook, ME 04098
1207.856.0277
1207.856.2206

COST ESTIMATOR
DG JONES & PARTNERS
3 Baldwin Green Common, Suite 202
Woburn, MA 01801
1781.532.3151
1781.532.3199

CODE CONSULTANT
R.W. SULLIVAN ENGINEERING
529 Main Street, Suite 203
Boston, MA 02129
1617.523.5227
1617.523.8016

ISSUED FOR PRICING

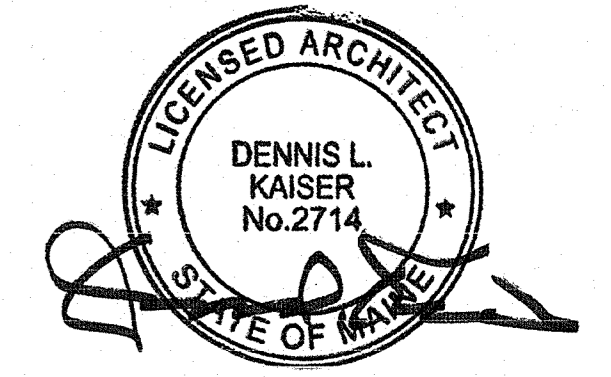

Revisions

NO	ISSUE	DATE
1	ISSUED FOR PERMIT	04.24.14

Sheet Information

Date: MARCH 07, 2014
Job Number: 152168.002
Drawn: Author
Checked: Checker
Approved: Approver

TITLE
SUB BASEMENT BEAN NEW WORK PLAN

Sheet
A04-01

1 CSD NEW CONSTRUCTION
1/8" = 1'-0"

