

Revisions

NO	ISSUE	DATE
1	ISSUED FOR PERMIT	04.24.14

Sheet Information

Date: MARCH 07, 2014
 Job Number: 152168.002
 Drawn: Author
 Checked: Checker
 Approved: Approver
 Title:

**SUB BASEMENT
DEMOLITION PLAN**

GENERAL NOTES

- DEMOLITION:**
- A. DISCONNECT AND RELOCATE SCOPE STERILIZER
 - B. REMOVE CMU WALLS TO UNDERSIDE OF DECK. PATCH CEILING WITH AXION TRIM AND NEW TILE AS NECESSARY. REMOVE QUARRY TILE AND REDUCE FLOOR SLAB TO ACHIEVE NECESSARY SLOPE FOR NEW CART WASHER.
 - C. REMOVE DOOR AND FRAME / SALVAGE AND COORD WITH OWNER
 - D. REMOVE WALL FOR NEW DOOR OPENING
 - E. REMOVE SS COUNTER AND SS SINK-SALVAGE FOR REUSE. REMOVE ASSOC PLUMBING
 - F. REMOVE EXISTING TILE FLOOR, DRAIN & TRAP TO ENABLE NEW INSTALLATION OF NEW FLOORING
 - F2. REMOVE EXISTING FLOORING AND REDUCE FLOOR SLAB TO ACHIEVE NECESSARY SLOPE FOR NEW CART HAND WASH AREA
 - G. MATERIAL LEFT DEMOLITION SCOPE NOT IN PROJECT- REFER TO P+W BEAN 2 ROOF ADDITION PROJECT
 - H. REMOVE EXISTING EXTERIOR BRICK WALL AND WINDOWS AND MASONRY BACKUP
 - I. REMOVE GRANITE CURB AND CONC WALK; RAMP TO REMAIN
 - J. SALVAGE AND RELOCATE DATA SYSTEM COORD WITH OWNER
 - K. SALVAGE AND RELOCATE EXISTING OVERHEAD LIGHT FIXTURES. COORD WITH OWNER.
 - L. REMOVE PLASTER CEILING IN AREA OF NEW CONSTRUCTION
 - M. REMOVE AND SALVAGE LOADING DOCK ROOT AND BUMPER STOPS
 - N. REMOVE AND RELOCATE EXISTING COUNTER TO PATIENT EQUIPMENT DECONTAMINATION WORKROOM
 - O. REMOVE AND SALVAGE EXISTING WIRE MOLDING FOR INSTALLATION IN CSD STORAGE ROOM #1389

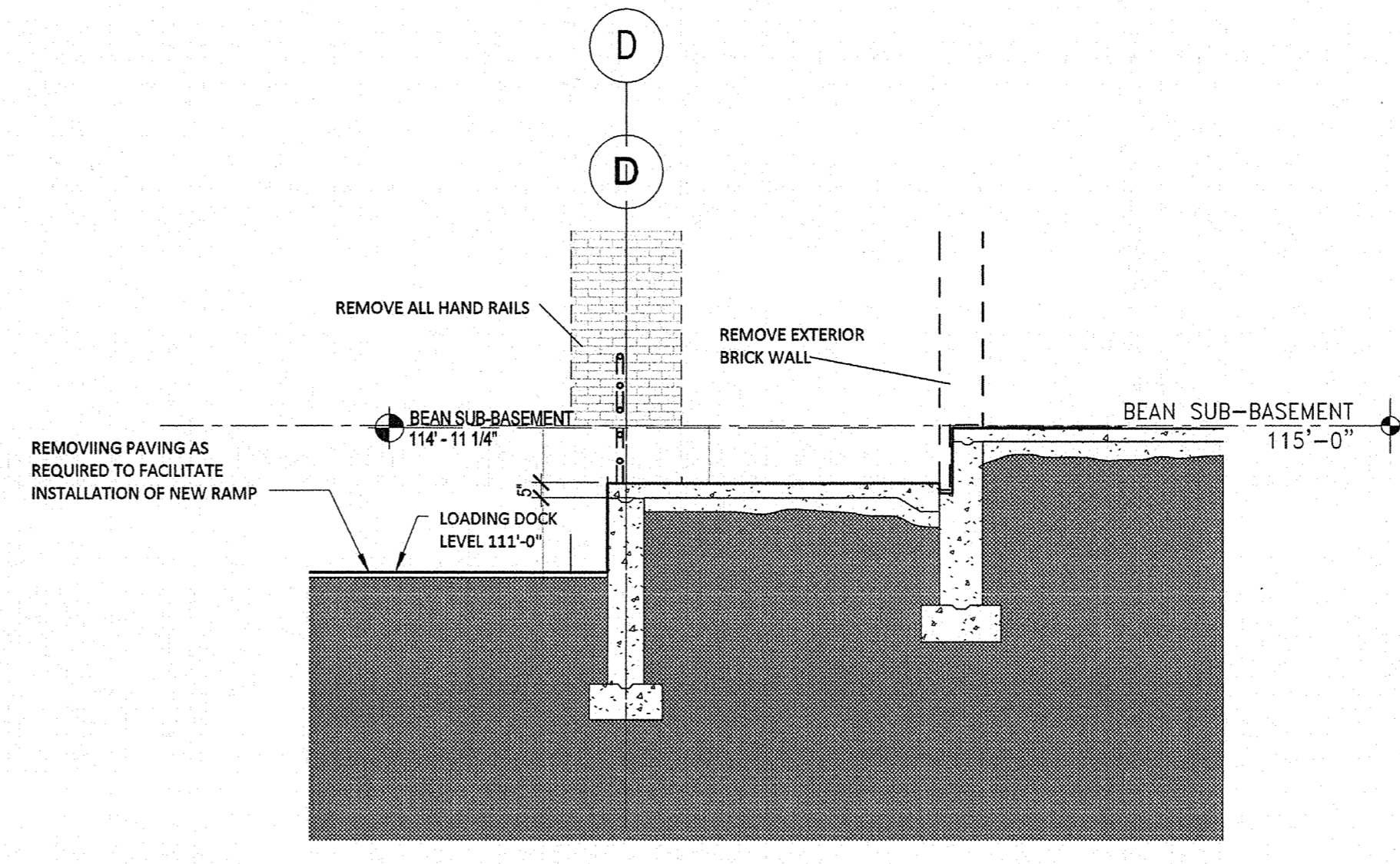

**SECTION THRU EXISTING RAMP -
DEMOLITION**

3
1/4" = 1'-0"

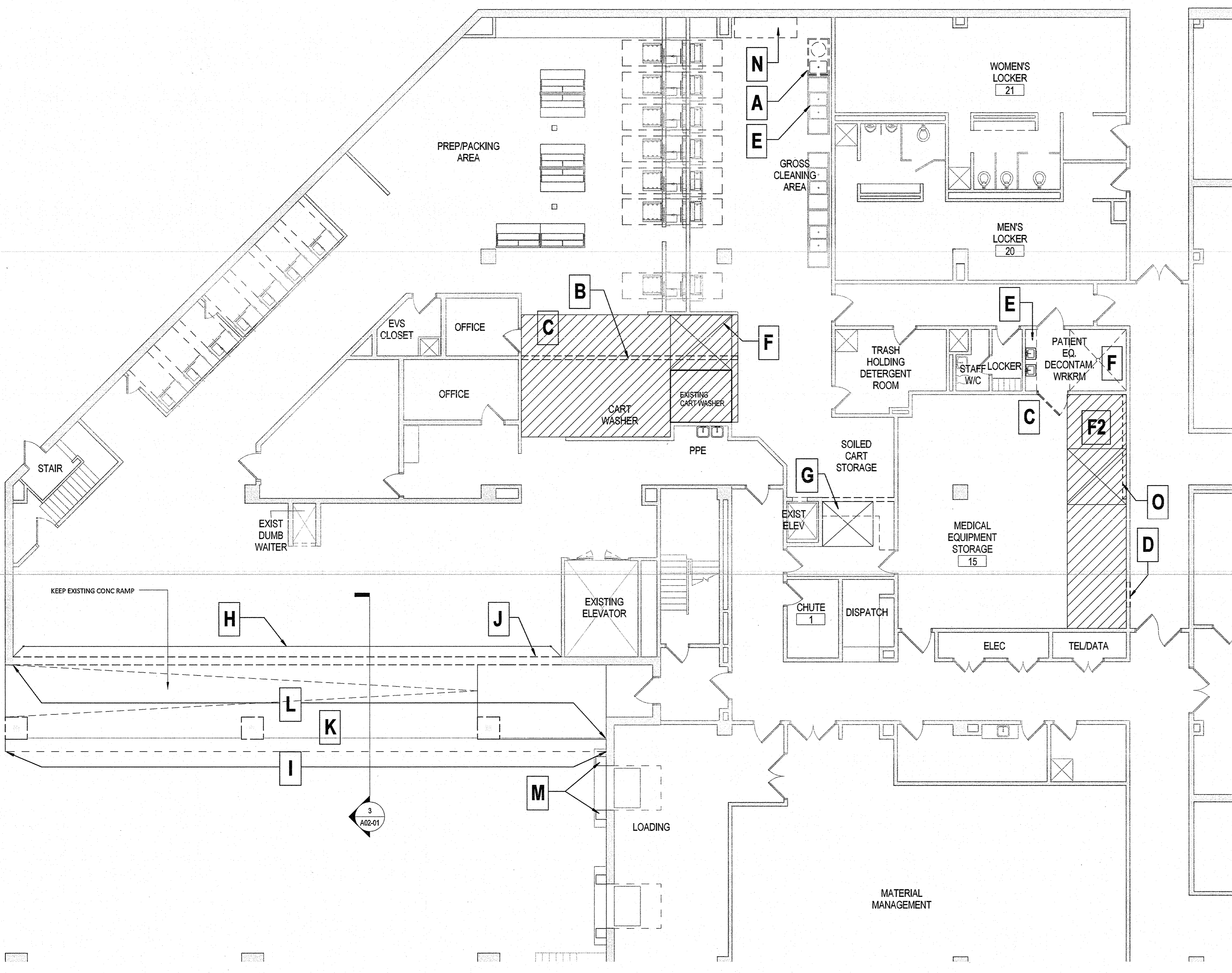

2 **DEMOLITION PLAN - BEAN CSD**
1/8" = 1'-0"

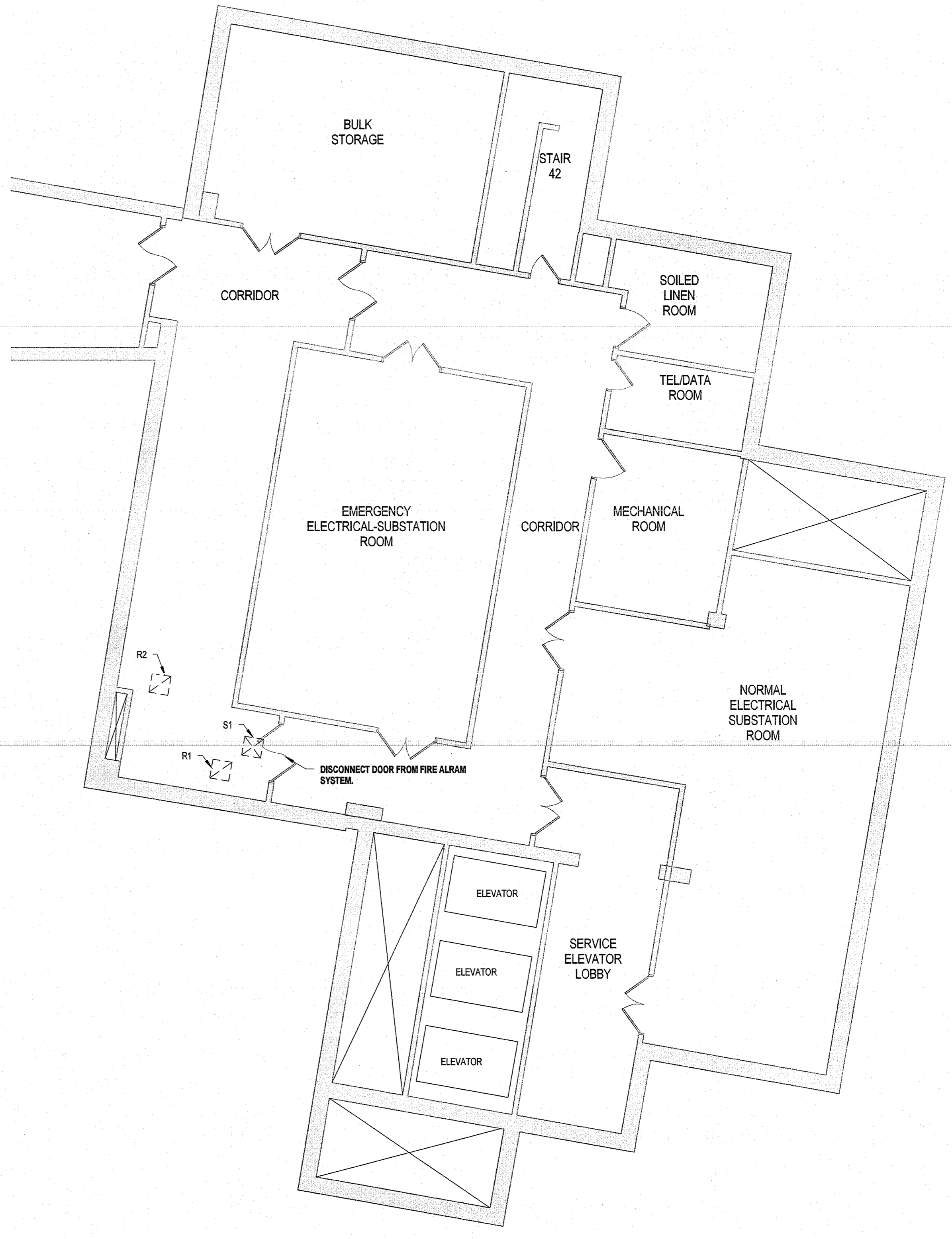

1 **DEMOLITION PLAN - EAST TOWER**
1/8" = 1'-0"

