

REFER TO DRAWING E05-04B FOR LIGHTING INFORMATION IN THIS AREA

SECTOR C (E05-05)
SECTOR B (E05-06)

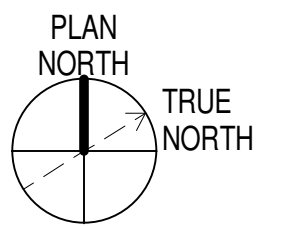

Bean 2 Roof Addition
22 Bramhall Street, Portland, Maine 04102

MEP ENGINEER
AKF ENGINEERS

41 Farnsworth Street, 3rd Floor
Boston, MA 02210
1 617 737 1111
1 617 737 4311

STRUCTURAL ENGINEER
SIMPSON GUMPERTZ & HIEGER

41 Seyon Street, Building 1, Suite 500
Waltham, MA 02453
1 781 907 9000
1 781 907 9009

MEDICAL EQUIPMENT PLANNERS
RTL ASSOCIATES INC.

1717 PACIFIC AVENUE
DALLAS, TX 75201
1 214 468 7600
1 214 468 7601

COST ESTIMATOR
DG JONES & PARTNERS

3 Baldwin Green Common, Suite 202
Woburn, MA 01801
1 781 932 3131
1 781 932 3199

CONSTRUCTION DOCUMENTS

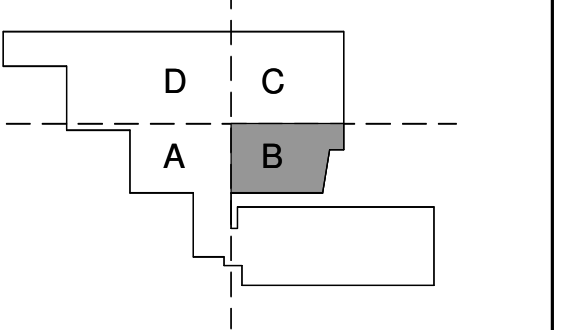

Revisions

NO	DATE	ISSUE
2	03-28-14	AS1 #2
1	02-07-14	Issued for Permit
1	04-11-14	DATE

Sheet Information

Date: JUNE 14, 2013
Job #: C140135461(MMC)/152168.000
Drawn: GN
Checked: RAC
Approved: RAC

ELECTRICAL MEZZANINE LIGHTING PLAN - SECTOR B

Sheet E05-05B

3/27/2014 9:52:29 AM
C:\Revit Local Files\B120229-MMC_Bean2-MEP12\B120229-MMC_Bean2-MEP12_Splines.rvt