

**Bean 2 Roof
Addition**
22 Bramhall Street, Portland,
Maine 04102

MEP ENGINEER
AKF ENGINEERS

41 Farnsworth Street, 3rd Floor
Boston, MA 02210
1617.737.1111
1617.737.4311

STRUCTURAL ENGINEER
**SIMPSON GUMPERTZ &
HEICER**

41 Seyon Street, Building 1, Suite 550
Waltham, MA 02453
1781.907.9000
1781.907.9009

MEDICAL EQUIPMENT PLANNERS
RTKL ASSOCIATES INC.

1717 PACIFIC AVENUE
DALLAS, TX 75201
1214.468.7600
1214.468.7601

COST ESTIMATOR
DG JONES & PARTNERS

3 Baldwin Green Common, Suite 202
Woburn, MA 01801
1781.932.3131
1781.932.3199

**CONSTRUCTION
DOCUMENTS**

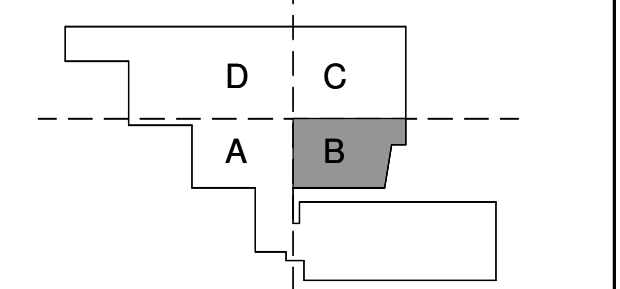

Revisions

3	AS1 #2	03-28-14
2	Issued for Permit	02-07-14
1	Addendum #3	01-17-14
NO	DATE	
NO	ISSUE	

Sheet Information

Date	JUNE 14, 2013
Drawn	C140135461(MMC)/152168.000
Drawn	GN
Checked	RAC
Approved	RAC

**Electrical
LEVEL 02
LIGHTING PLAN -
SECTOR B**

Sheet

E05-02B

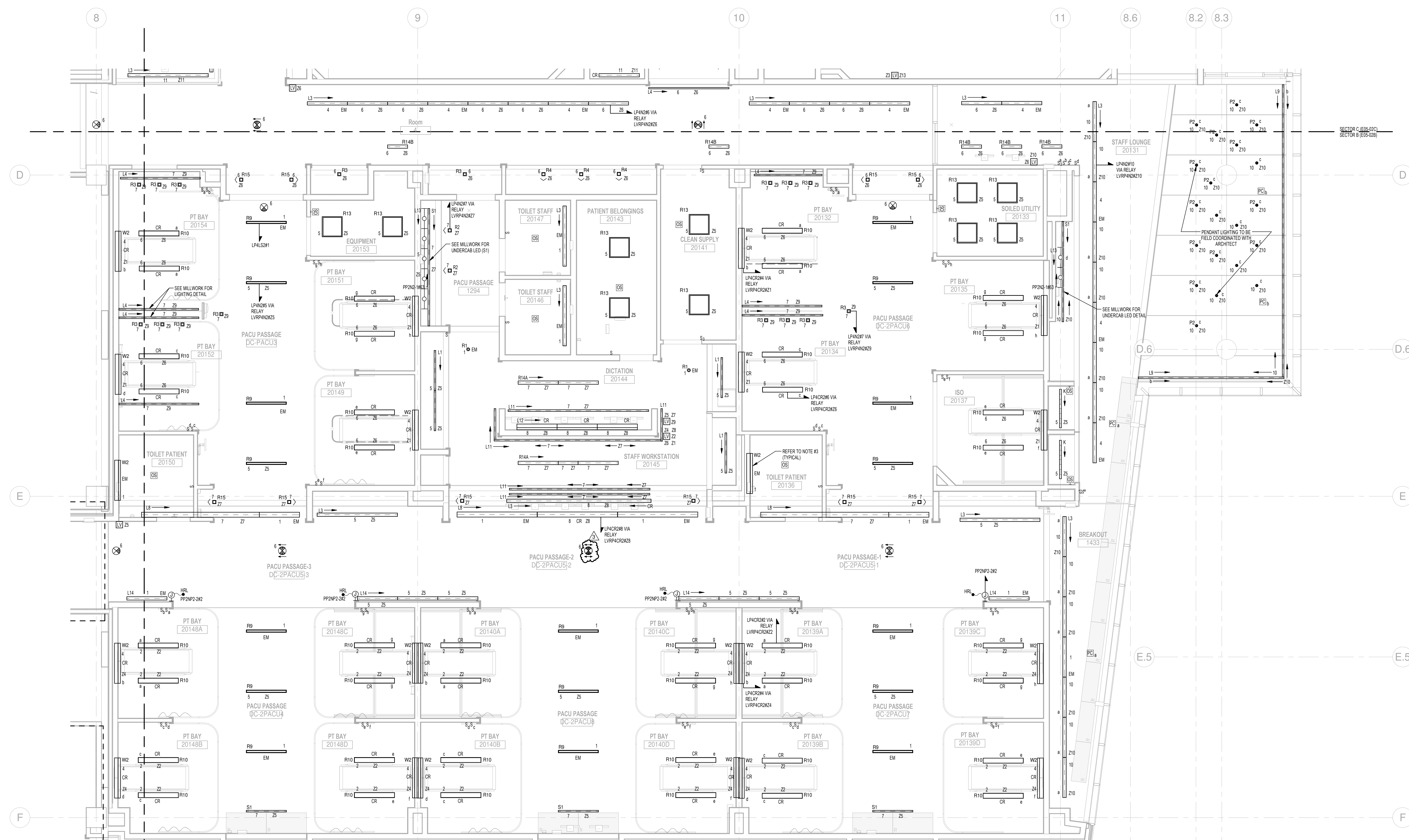

ELECTRICAL LIGHTING GENERAL NOTES

1. SWITCH CONTROL WILL BE PROVIDED FOR EACH ROOM. TWO LEVELS PROVIDED WHERE INDICATED.
2. EXIT SIGNS SHALL BE CIRCUITED TO THE LIFE SAFETY BRANCH OF THE EMERGENCY SYSTEM.
3. EMERGENCY EGRESS LIGHTING SHALL BE PROVIDED THROUGHOUT THE RENOVATION TO ILLUMINATE ALL EGRESS CORRIDORS, STAIRWELLS, LOBBIES, ETC. EGRESS LIGHTING BRANCH CIRCUITS SHALL ORIGINATE FROM THE LIFE SAFETY PANELS AND SHALL BE CONSTANT 'ON' WITH NO TOGGLE SWITCH CONTROL. AREAS REQUIRING SWITCH CONTROL OF EGRESS LIGHTING SHALL BE PROVIDED WITH UL APPROVED BYPASS RELAYS (BOINC, OT100, OR APPROVED EQUAL).

LIGHTING LAYOUT NOTE:

REFER TO ARCHITECTURAL REFLECTED CEILING PLANS FOR LIGHTING LAYOUT, FIXTURE QUANTITIES AND FIXTURE TYPES

