

**BASEMENT FRAMING PLAN – SECTOR C**  
 1/4" = 1'-0"

**BASEMENT FLOOR PLAN NOTES:**  
 1. STRENGTHEN COLUMN, SEE STRENGTHENING PLANS, S02-OB.  
 2. NEW CONCRETE GRADE BEAM WITH BASE PLATE AND GUSSET PLATE FOR UNIVERSAL PIN CONNECTION BY CAST CONNEX INC. (WWW.CASTCONNEX.COM) SEE DETAILS FOR MORE INFORMATION.

**LEGEND: GRID LINES**

- F.5** EXISTING ED EXPANSION (1997)
- R#** EXISTING RICHARDS BUILDING (1966)
- 11** EXISTING BEAN BUILDING (1983 + 1996)
- 8.2** EXISTING CORRIDOR PROJECT (2004)

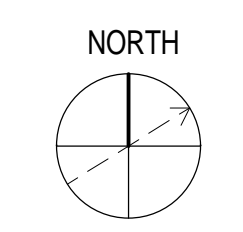

**PERKINS + WILL**  
 225 Franklin St., Suite 1100  
 Boston, MA 02110  
 1 617 478 0300  
 1 617 478 0321  
 www.perkinswill.com



**Bean 2 Roof Addition**  
 22 Bramhall Street, Portland, Maine 04102

- MEP ENGINEER**  
**AKF ENGINEERS**  
 41 Farnsworth Street, 3rd Floor  
 Boston, MA 02210  
 1 617 737 1111  
 1 617 737 4311
- STRUCTURAL ENGINEER**  
**SIMPSON GUMPERTZ & HEGER**  
 41 Seyon Street, Building 1, Suite 500  
 Waltham, MA 02453  
 1 781 907 9000  
 SGH Project No. 100439.09
- MEDICAL EQUIPMENT PLANNERS**  
**RTKL ASSOCIATES INC.**  
 1717 PACIFIC AVENUE  
 DALLAS, TX 75201  
 1 214 468 7000  
 1 214 468 7601
- COST ESTIMATOR**  
**DG JONES & PARTNERS**  
 3 Baldwin Green Common, Suite 202  
 Woburn, MA 01801  
 1 781 932 3131  
 1 781 932 3199

**CONSTRUCTION DOCUMENTS**  
 06.14.2013

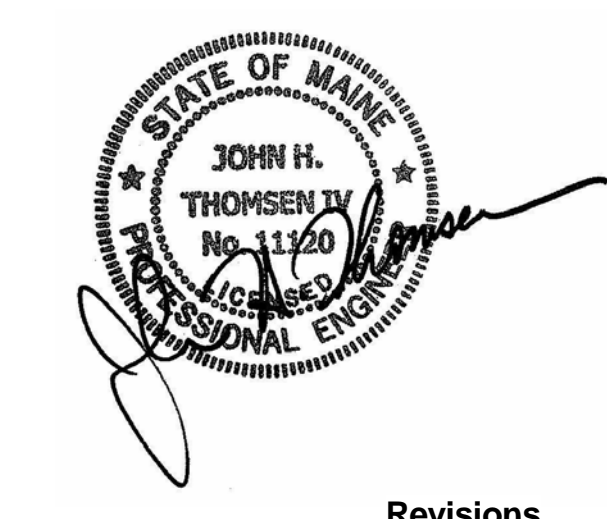
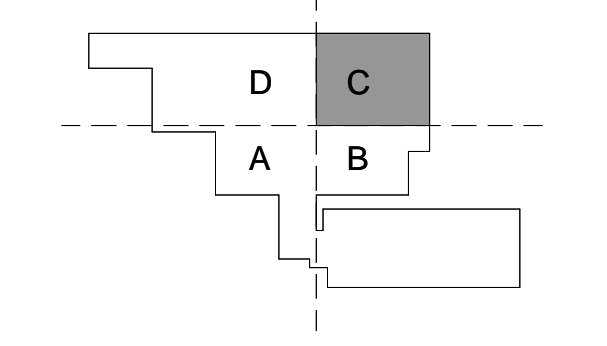

NO.	ISSUED FOR PERMIT	DATE
	02/07/14	

**Sheet Information**

Date: 12 APRIL 2013  
 Job #: C140135461(MMC)152168.000  
 Drawn: BMT/SWW  
 Checked: MJB  
 Approved: JHT

**BASEMENT FRAMING PLAN - SECTOR C**

**Sheet S04-0BC**

2/7/2014 3:43:00 PM  
 I:\BOS\Projects\20101004809-09-2008\Drawings\Working\_Seri\_U\_Revit\LOCAL\_USERS\MLB\4646\MAC\_BEAN2\_NEW\_STRUC\_A\MBB.dwg