



**Bean 2 Roof Addition**  
22 Bramhall Street, Portland, Maine 04102

MEP ENGINEER  
AKF ENGINEERS  
41 Farnsworth Street, 3rd Floor  
Boston, MA 02210  
1617.737.1111  
1617.737.4311

STRUCTURAL ENGINEER  
SIMPSON GUMPERTZ & HEGGER  
41 Seyon Street, Building 1, Suite 500  
Waltham, MA 02453  
1781.907.9000  
1781.907.9009

MEDICAL EQUIPMENT PLANNERS  
RTKL ASSOCIATES INC.  
1717 PACIFIC AVENUE  
DALLAS, TX 75201  
1214.468.7800  
1214.468.7801

COST ESTIMATOR  
DG JONES & PARTNERS  
3 Baldwin Green Common, Suite 202  
Woburn, MA 01897  
1781.932.3131  
1781.932.3199

**CONSTRUCTION DOCUMENTS**

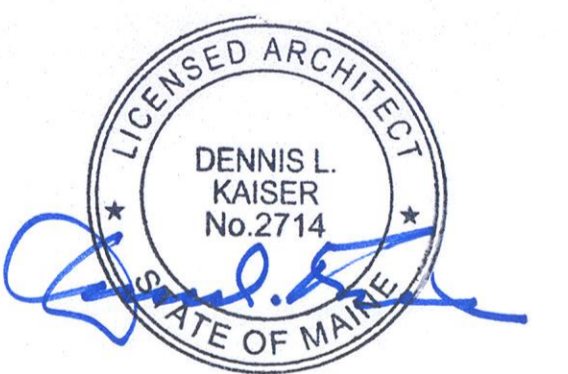

**Revisions**

NO.	ISSUE	DATE
1	Addendum #3	01/17/2014

**Sheet Information**  
Date: SEPTEMBER 10, 2013  
Job #: C140135461 (MMC) / 152168.000  
Drawn: Author  
Checked: Checker  
Approved: Approver  
Title

**STAIR PLANS & SECTIONS**

Sheet  
**A12-01**

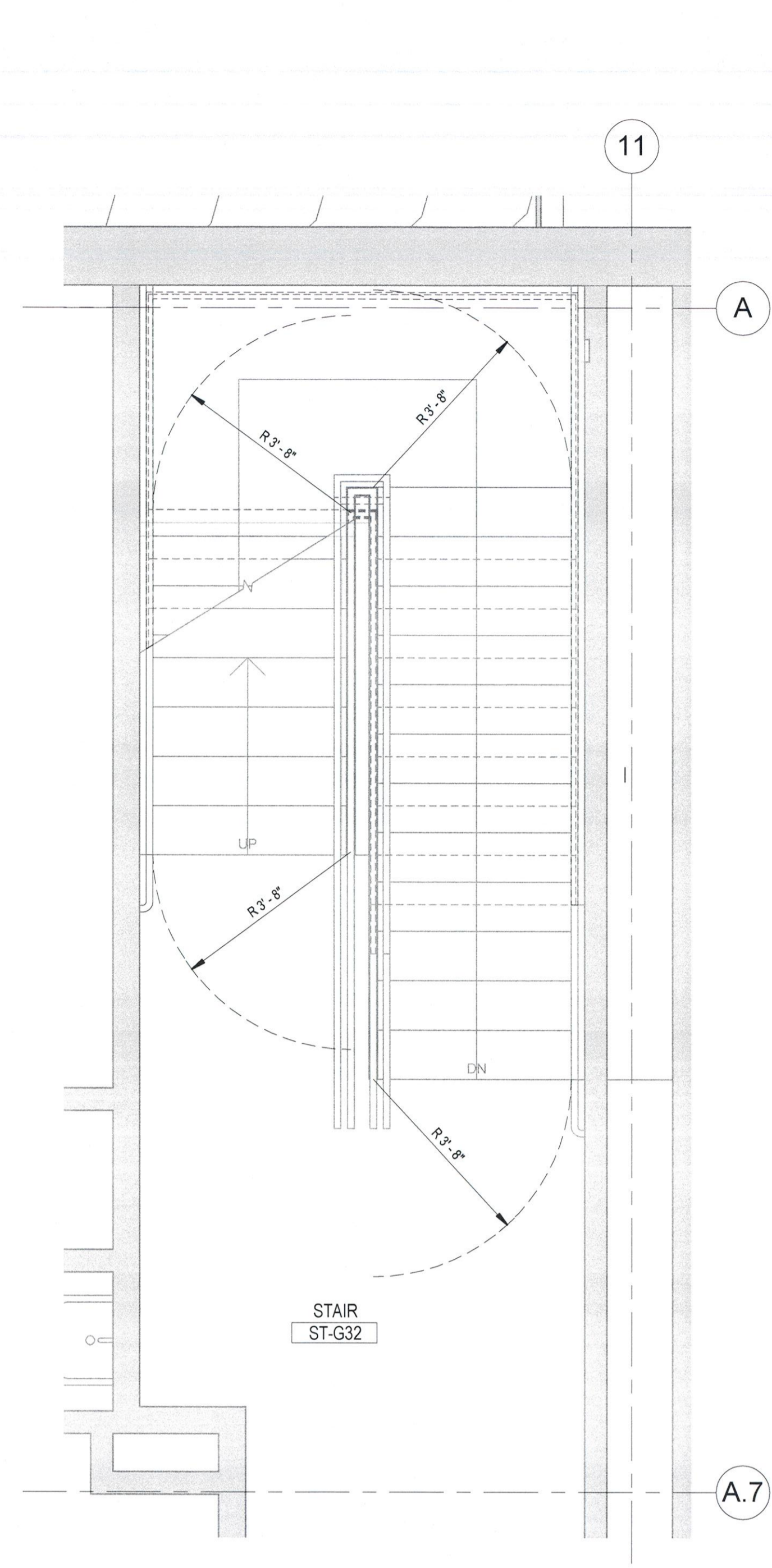

**B5** ENLARGED STAIR - EXISTING GROUND FLOOR  
1/2" = 1'-0"

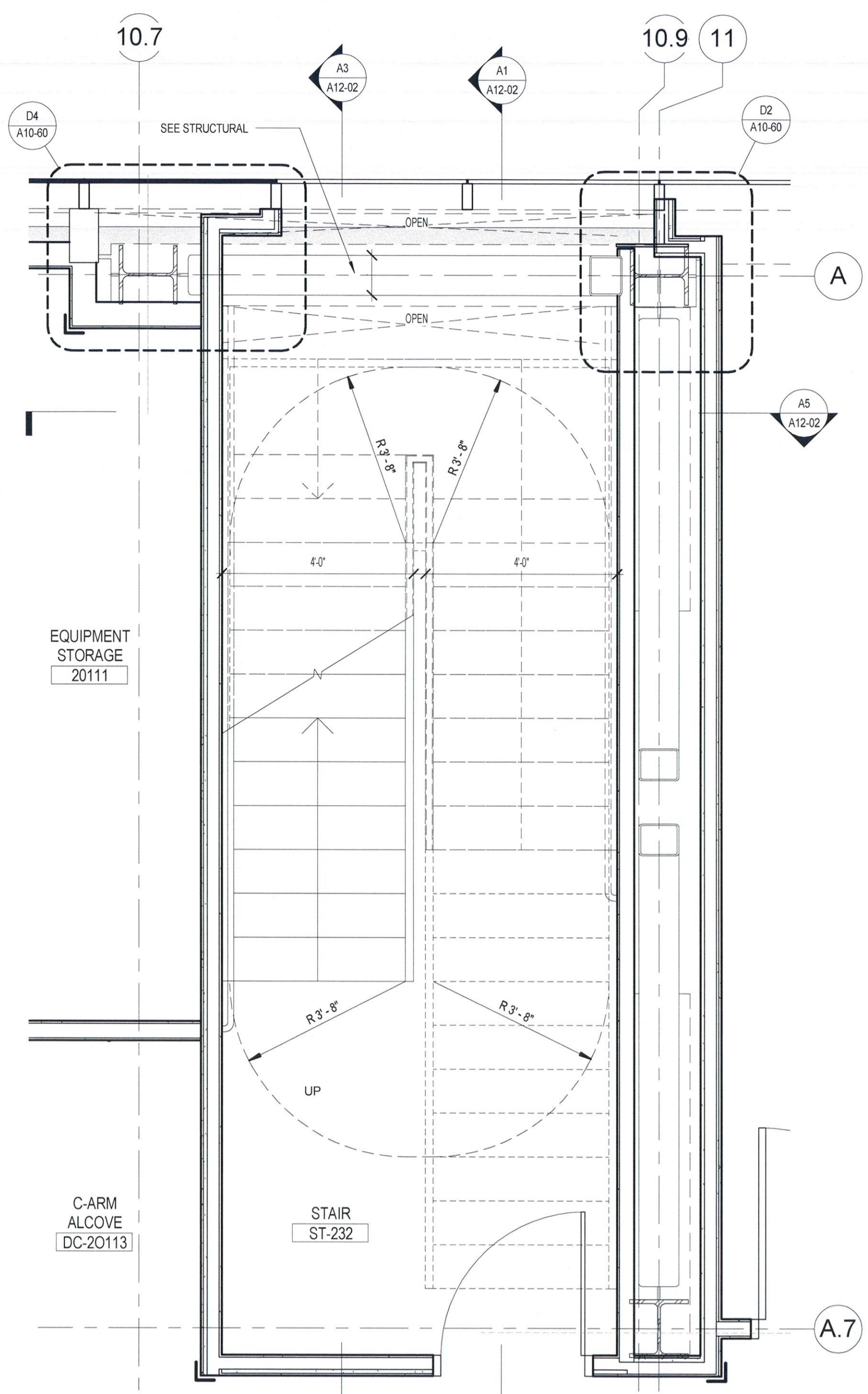

**B4** ENLARGED STAIR - LEVEL 2  
1/2" = 1'-0"

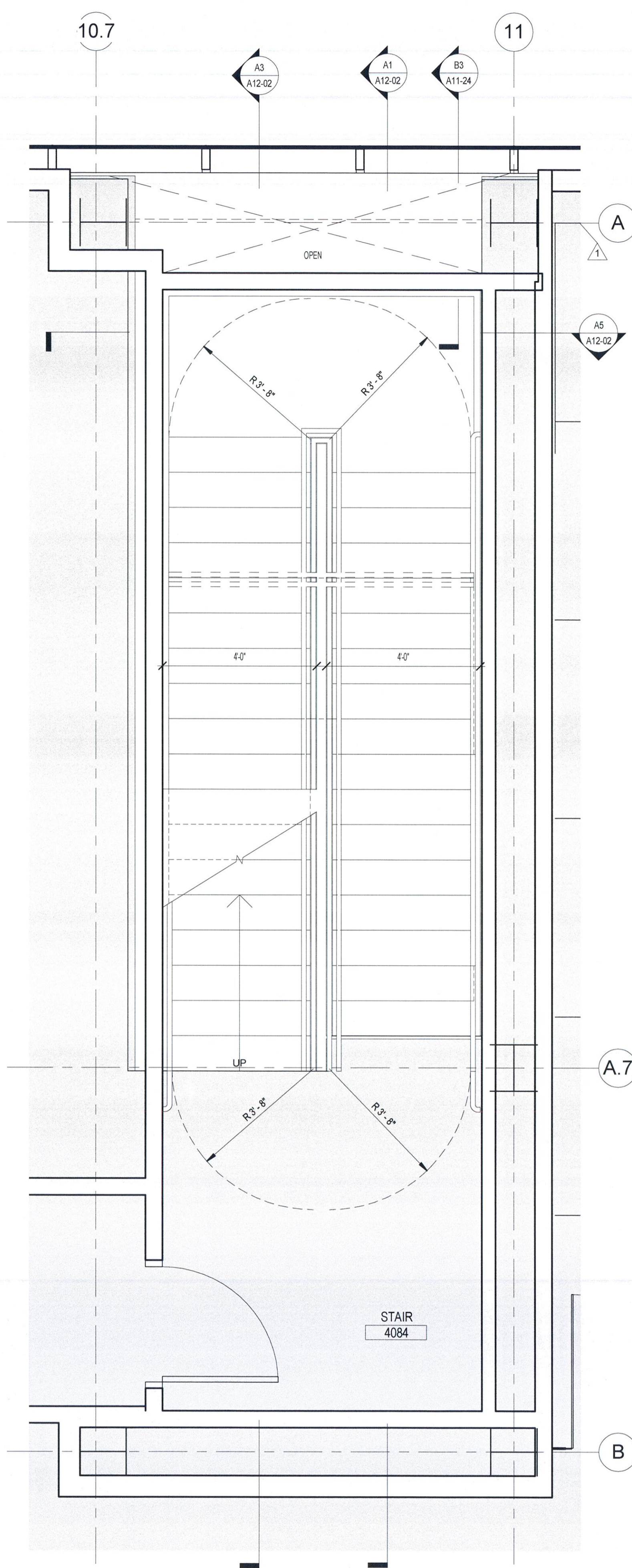

**B2** ENLARGED STAIR - 4 MECHANICAL  
1/2" = 1'-0"

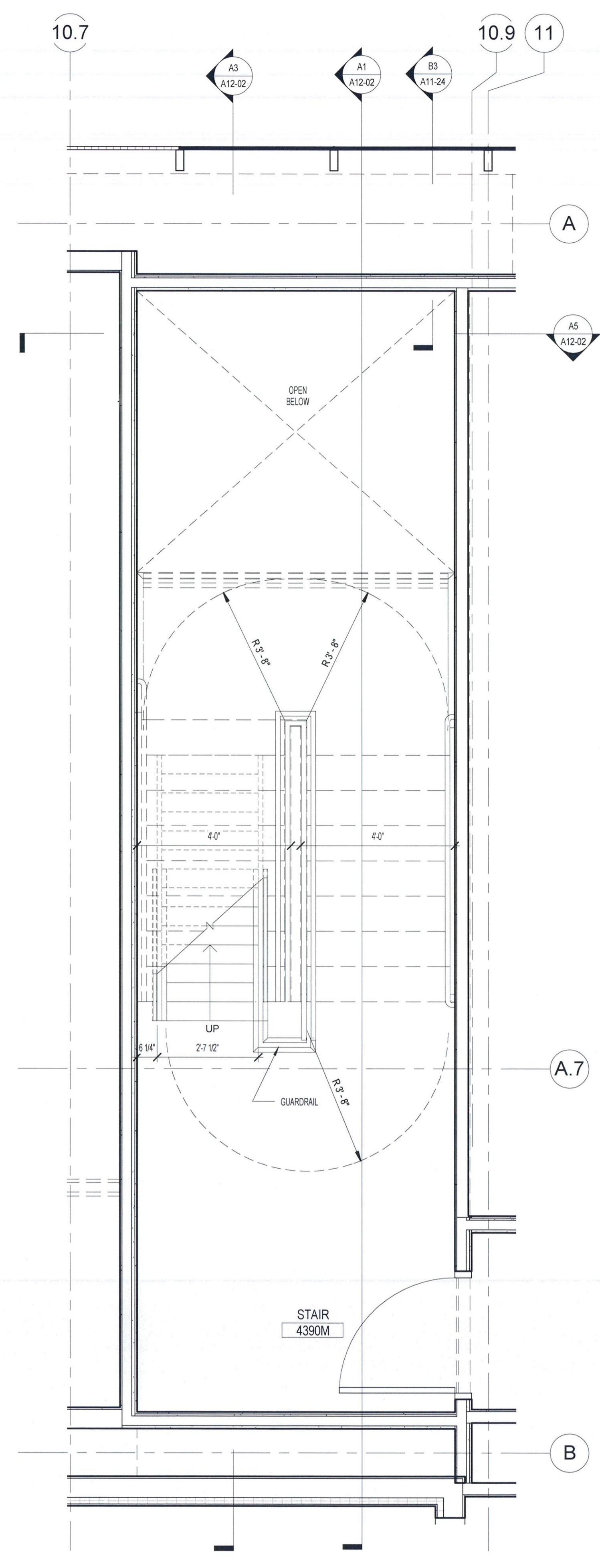

**B1** ENLARGED STAIR - 4 MEZZ  
1/2" = 1'-0"

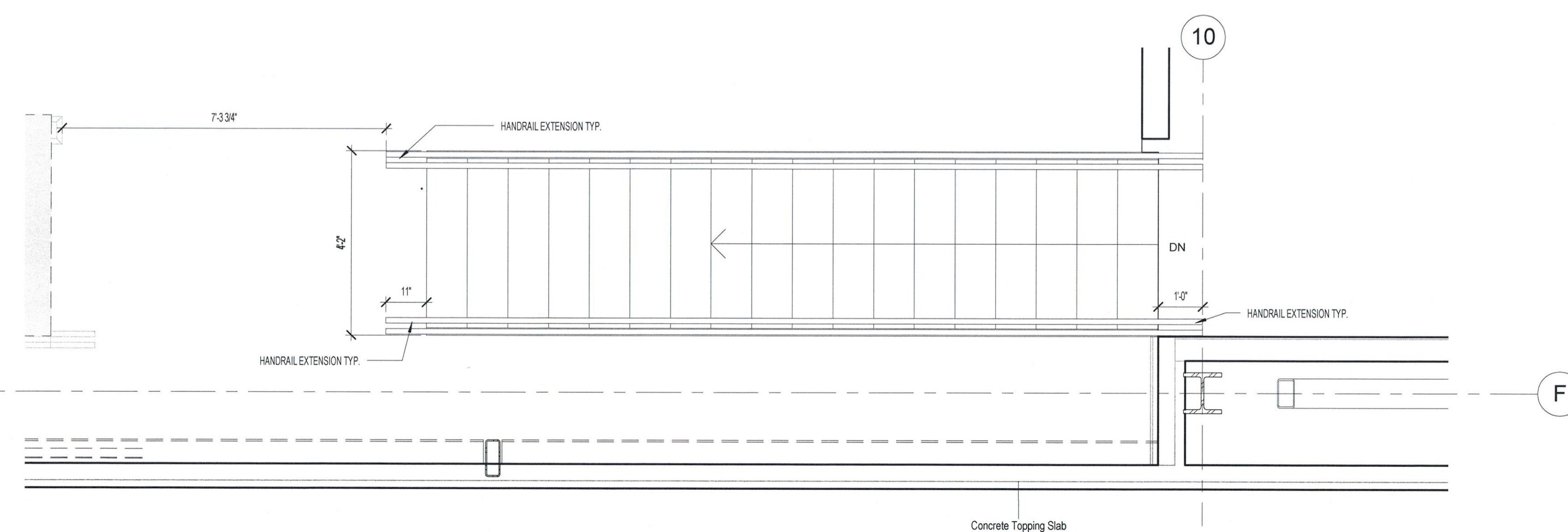

**A5** ENLARGED STAIR 2 - MEZZ  
1/2" = 1'-0"