

2/20/14 7:03:02 PM
c:\bpm\m\c_new\bean2_arch\kshah\prt

LEVEL 02 ENLARGED FLOOR PATTERN PLAN - SECTOR D
 (A1) 1/4" = 1'-0"

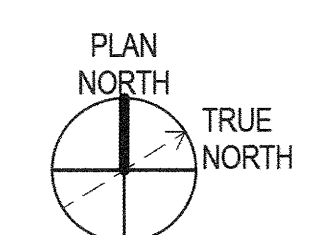

PERKINS + WILL

225 Franklin St., Suite 1100
 Boston, MA 02110
 (617) 476-0300
 (617) 476-0321
 www.perkinswill.com



Bean 2 Roof Addition
 22 Bramhall Street, Portland, Maine 04102

MEP ENGINEER
 AKF ENGINEERS
 41 Farnsworth Street, 3rd Floor
 Boston, MA 02210
 (617) 737-1111
 (617) 737-4311

STRUCTURAL ENGINEER
 SIMPSON GUMPERTZ & HEGER
 41 Seyon Street, Building 1, Suite 500
 Waltham, MA 02453
 (781) 807-9000
 (781) 807-9009

MEDICAL EQUIPMENT PLANNERS
 RTKL ASSOCIATES INC.
 1717 PACIFIC AVENUE
 DALLAS, TX 75201
 (214) 468-7600
 (214) 468-7601

COST ESTIMATOR
 DG JONES & PARTNERS
 3 Baldwin Green Common, Suite 202
 Woburn, MA 01897
 (781) 932-3131
 (781) 932-3199

CONSTRUCTION DOCUMENTS

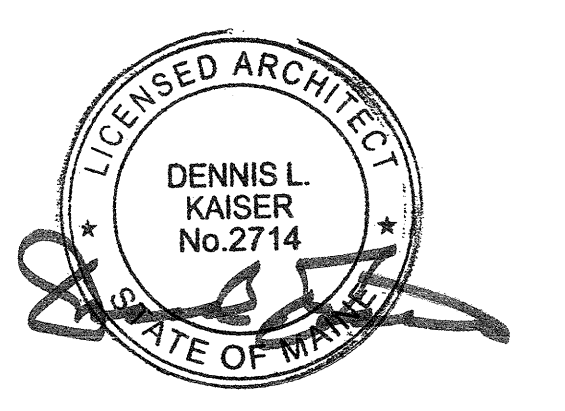
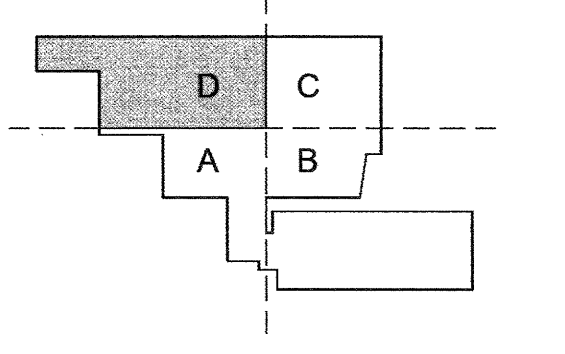

Revisions

NO.	ISSUE	DATE
1	Issued for Permit	02/07/2014
1	Addendum #3	01/17/2014

Sheet Information
 Date: SEPTEMBER 10, 2013
 Job #: C140135461 (MMC) 152168.000
 Drawn: Author
 Checked: Checker
 Approved: Approver
 Title:

LEVEL 02 FLOOR PATTERN PLAN - SECTOR D

Sheet
A06-02D