

**Bean 2 Roof
Addition**
22 Bramhall Street, Portland,
Maine 04102

MEP ENGINEER
AKF ENGINEERS

41 Farnsworth Street, 3rd Floor
Boston, MA 02210
617.737.1111
617.737.4311

STRUCTURAL ENGINEER
SIMPSON GUMPERTZ &
HEGER
41 Seyon Street, Building 1, Suite 500
Waltham, MA 02453
781.907.9000
781.907.9009

MEDICAL EQUIPMENT PLANNERS
RTL ASSOCIATES INC.

1717 PACIFIC AVENUE
DALLAS, TX 75201
214.468.7800
214.468.7801

COST ESTIMATOR
DG JONES & PARTNERS

3 Baldwin Green Common, Suite 202
Woburn, MA 01801
781.932.3131
781.932.3199

**CONSTRUCTION
DOCUMENTS**

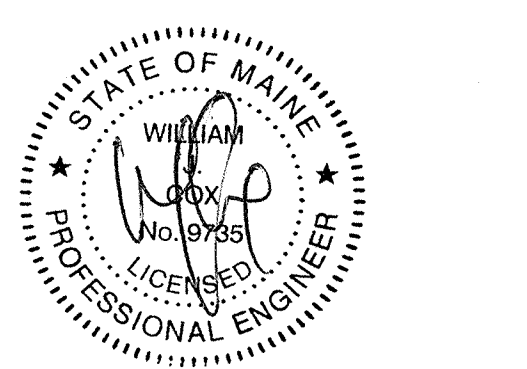
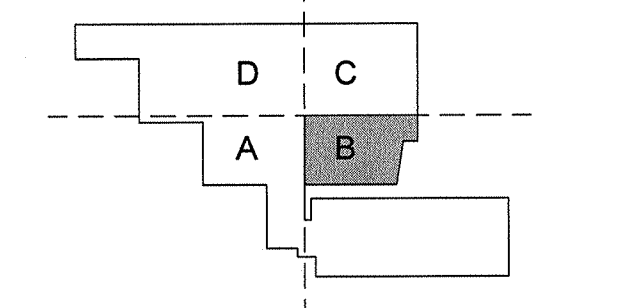

Revisions

NO	ISSUE	DATE
3	Issued for Permit	02-07-14
2	Addendum #4	02-04-14
1	Addendum #3	01-17-14

Sheet Information

Date	JUNE 14, 2013
Job #	C140135481(MMC)152168.000
Drawn	GN
Checked	RAC
Approved	RAC

Title
**ELECTRICAL
LEVEL 02 NURSE
CALL PLAN -
SECTOR B**

Sheet

E07-02B

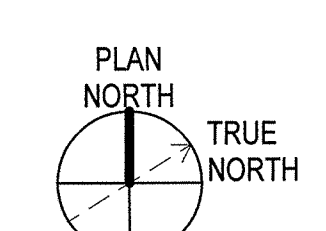
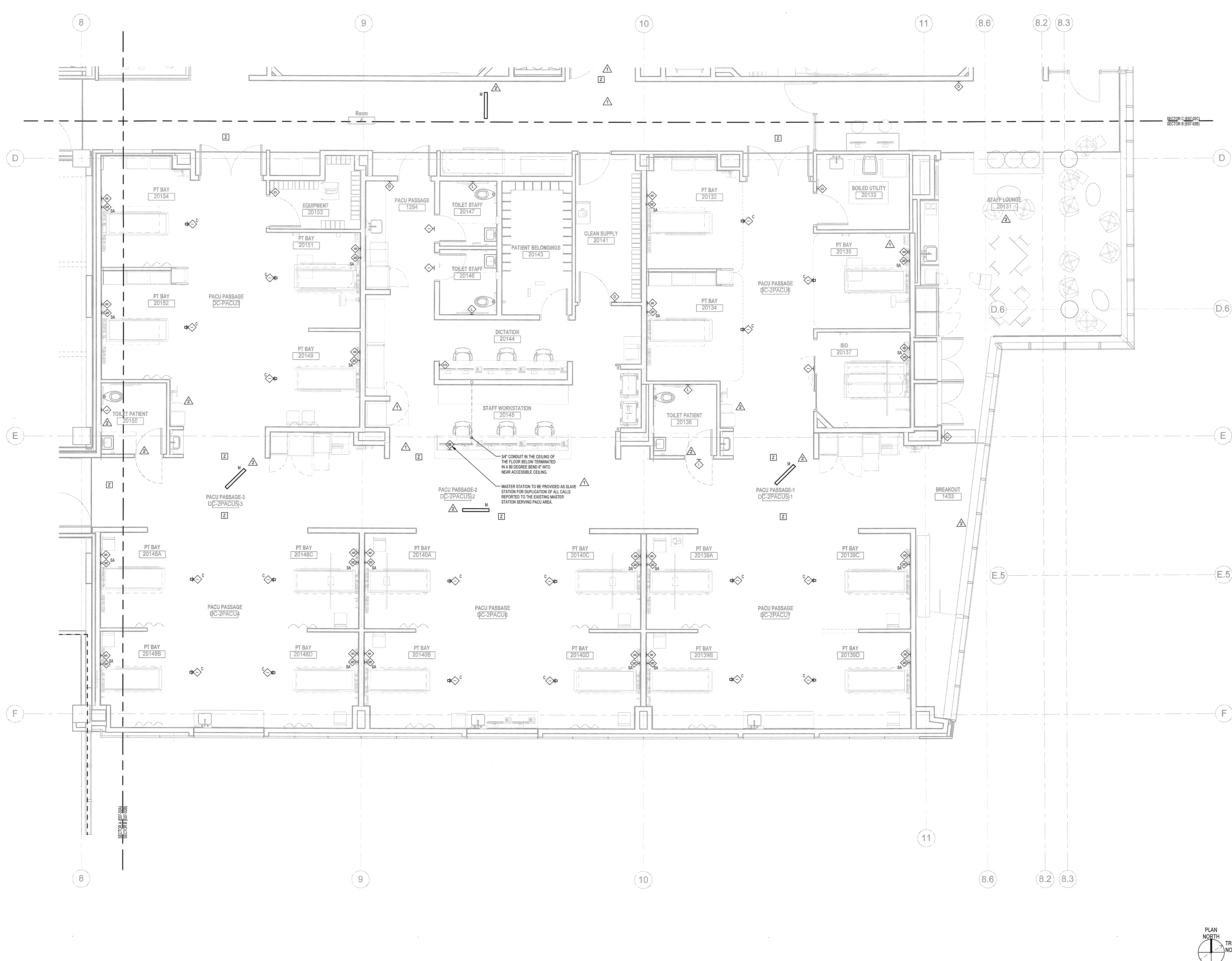

C:\Bentley\Local Files\B120228\MMC Bean2\MEP\20120228-MMC Bean2-MEP-C_Chelmsford