

**Bean 2 Roof
Addition**
22 Bramhall Street, Portland,
Maine 04102

MEP ENGINEER
AKF ENGINEERS

41 Farnsworth Street, 3rd Floor
Boston, MA 02210
1 617 737 3111
1 617 737 4311

STRUCTURAL ENGINEER
SIMPSON GUMPERTZ &
HEGER
41 Seyon Street, Building 1, Suite 500
Waltham, MA 02453
1 781 907 9000
1 781 907 9009

MEDICAL EQUIPMENT PLANNERS
RTKL ASSOCIATES INC.

1717 PACIFIC AVENUE
DALLAS, TX 75201
1 214 468 7600
1 214 468 7601

COST ESTIMATOR
DG JONES & PARTNERS

3 Baldwin Green Common, Suite 202
Woburn, MA 01801
1 781 932 3151
1 781 932 3199

**CONSTRUCTION
DOCUMENTS**

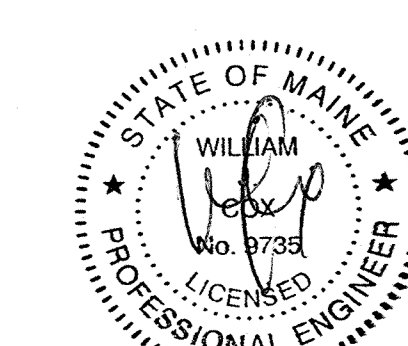
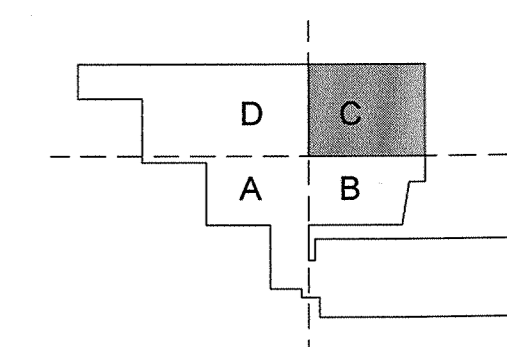

Revisions

NO	ISSUE	DATE
2	Issued for Permit	02-07-14
1	Addendum #3	01-17-14

Sheet Information

Date: JUNE 14, 2013
Job #: C140135461(MMC)/152168.000
Drawn: GN
Checked: RAC
Approved: RAC

**Electrical
PENTHOUSE
LIGHTING PLAN -
SECTOR C**

Sheet

E05-04C

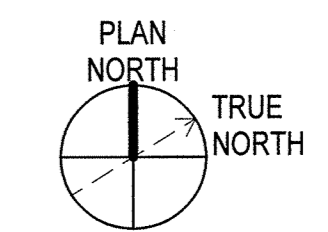
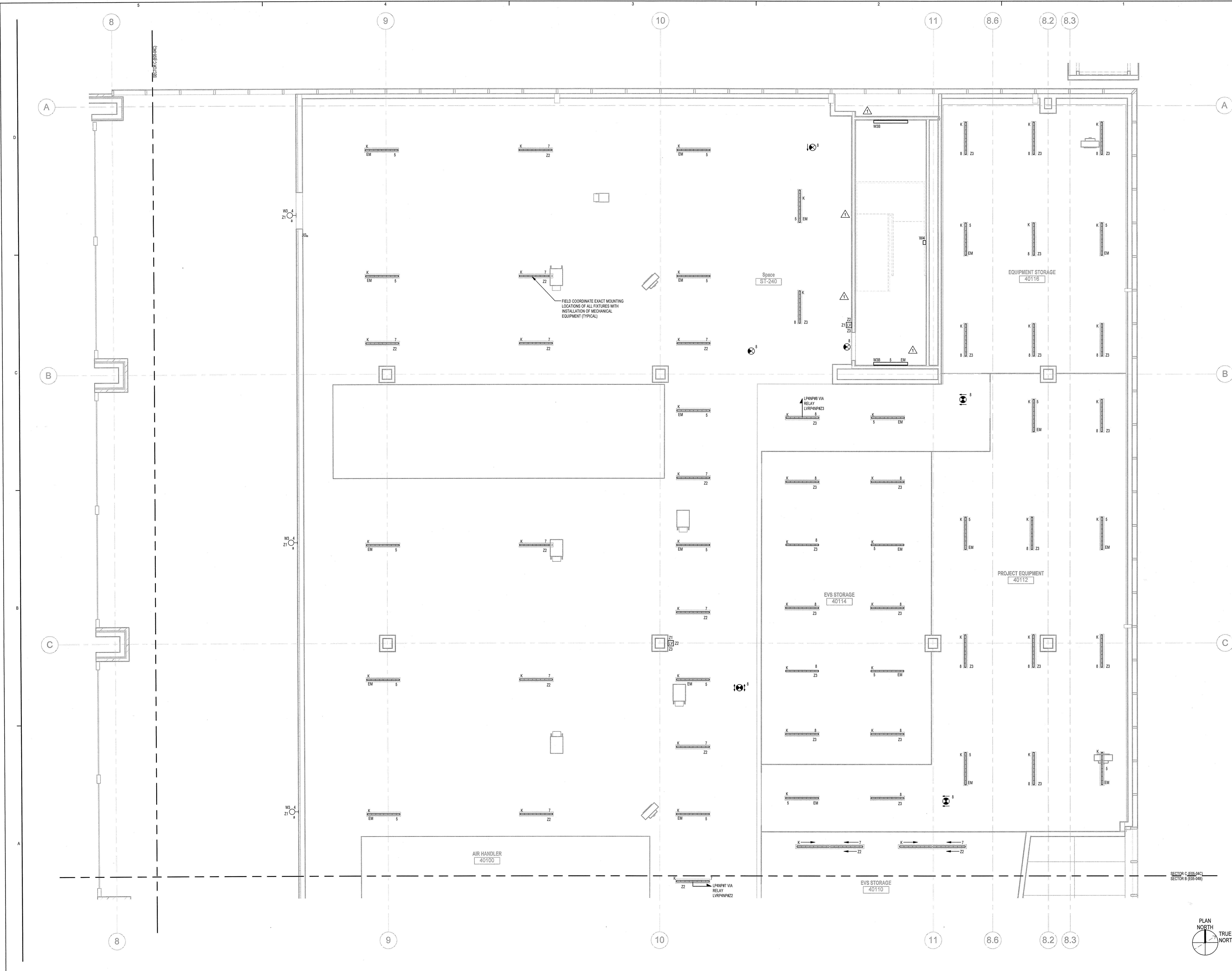

C:\Revit Local Files\B120229-MMC\Bean2-MEP\10B 120229-MMC\Bean2-MEP\12_GNelson.rvt