

**ALTERNATE #3 SCOPE OF WORK**

**ALTERNATE SCOPE DEMOLITION NOTE:**

ALL EXISTING ELECTRICAL DEVICES (LIGHT FIXTURES, SWITCHES, RECEPTACLES, TEL/DATA DEVICES, WIRING, FEEDERS, BRANCH CIRCUITS, FIRE ALARM DEVICES, ETC.) WITHIN THE ALTERNATE SCOPE OF WORK ARE TO BE DISCONNECTED AND REMOVED TO ACCOMMODATE THE NEW WORK REQUIRED FOR THE ALTERNATE WORK. ALL SERVICES AND DEVICES SHALL BE TRACED OUT AND IDENTIFIED WITH WHAT AREAS THEY FEED OUTSIDE OF THE ALTERNATE SCOPES PRIOR TO THE START OF DEMOLITION.

**LIGHTING LAYOUT NOTE:**

REFER TO ARCHITECTURAL REFLECTED CEILING PLANS FOR LIGHTING LAYOUT, FIXTURE QUANTITIES AND FIXTURE TYPES

**ALTERNATE #4 SCOPE OF WORK**

**ELECTRICAL LIGHTING GENERAL NOTES**

1. SWITCH CONTROL WILL BE PROVIDED FOR EACH ROOM. TWO LEVELS PROVIDED WHERE INDICATED.
2. EXIT SIGNS SHALL BE CIRCUITED TO THE LIFE SAFETY BRANCH OF THE EMERGENCY SYSTEM.
3. EMERGENCY EGRESS LIGHTING SHALL BE PROVIDED THROUGHOUT THE RENOVATION TO ILLUMINATE ALL EGRESS CORRIDORS, STAIRWELLS, LOBBIES, ETC. EGRESS LIGHTING BRANCH CIRCUITS SHALL ORIGINATE FROM THE LIFE SAFETY PANELS AND SHALL BE CONSTANT "ON" WITH NO TOGGLE SWITCH CONTROL. AREAS REQUIRING SWITCH CONTROL OF EGRESS LIGHTING SHALL BE PROVIDED WITH UL APPROVED BYPASS RELAYS (BOONE GTD20 OR APPROVED EQUAL).

**CONSTRUCTION DOCUMENTS**

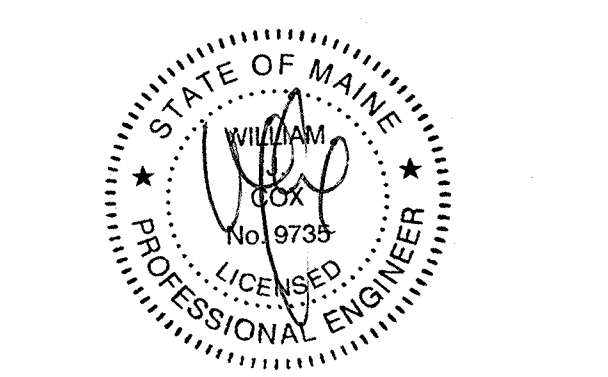
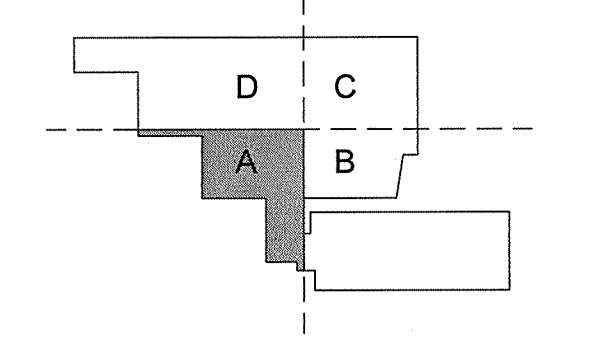

**Revisions**

NO	ISSUE	DATE
2	Issued for Permit	02-07-14
1	Addendum #3	01-17-14
NO	ISSUE	DATE

**Sheet Information**

Date: JUNE 14, 2013  
Job #: C140135461(MMC)/152168.000  
Drawn: GN  
Checked: RAC  
Approved: RAC

**ELECTRICAL LEVEL 02 LIGHTING PLAN - SECTOR A**

C:\Perk Local Files\120223-MMC Bean2-MEP12-02023-MMC Bean2-MEP12-02023-MEP12\_GMelson.rvt