

**ELECTRICAL POWER KEYED NOTES**

- 1 DEVICES MOUNTED ON MANUFACTURED CEILING PANEL ELECTRICAL CONTRACTOR SHALL PROVIDE (4) WIRING EXTENDERS PER LOCATION. EACH WIRING EXTENDER SHALL CONSIST OF A HUBBELL LOCK PLUG (HBL23014H08) HOSPITAL GRADE RECEPTACLE (HRL819C) AND 3" OF SOOM CORD BETWEEN PLUG/RECEPTACLE.
- 2 DEVICES MOUNTED ON MANUFACTURED CEILING PANEL ELECTRICAL CONTRACTOR SHALL PROVIDE (4) WIRING EXTENDERS PER LOCATION. EACH WIRING EXTENDER SHALL CONSIST OF A HUBBELL LOCK PLUG (HBL23014H08) HOSPITAL GRADE RECEPTACLE (HRL819C) AND 42" OF SOOM CORD BETWEEN PLUG/RECEPTACLE.
- 3 A PERMANENT, ENGRAVED PLACARD SHALL BE PROVIDED DIRECTLY ADJACENT TO EACH RECEPTACLE INDICATING THE FOLLOWING NON-ISOLATED POWER FOR NON-PATIENT USE. DO NOT PLUG PATIENT EQUIPMENT INTO DEVICES. EACH DEVICE SHALL BE PROVIDED WITH A BLUE COVER PLATE.
- 4 ELECTRICAL CONTRACTOR SHALL CARRY A COST TO PROVIDE A 120V/20A CIRCUIT FOR A PNEUMATIC TUBE TRANSFER STATION.
- 5 COORDINATE MOUNTING OF DEVICES AND WIRING WITH STRUCTURAL SUPPORT ABOVE CEILING.

**OR CIRCUIT LEGEND:**

- A = CIRCUIT FROM DEDICATED ROOM O.R. ISOLATED POWER PANEL "A"
- B = CIRCUIT FROM DEDICATED ROOM O.R. ISOLATED POWER PANEL "B"
- C = CIRCUIT FROM DEDICATED ROOM O.R. ISOLATED POWER PANEL "C"

\* REFER TO EACH O.R. LAYOUT FOR EXACT PANEL NAMES. ALL RECEPTACLES SHALL BE RED IN COLOR.

**BRANCH CIRCUIT NOTE:**

20A BRANCH CIRCUITS FROM EACH PANELBOARD TO FINAL DEVICE SHALL BE SIZED AS FOLLOWS:

BRANCH CIRCUIT LENGTH UNDER 1'-0"	20A & 15A/20A IN 3/4"
BRANCH CIRCUIT LENGTH BETWEEN 1'-0" & 2'-0"	20A & 15A/20A IN 3/4"
BRANCH CIRCUIT LENGTH BETWEEN 2'-0" & 3'-0"	20A & 15A/20A IN 3/4"

NOTE: NOTIFY ENGINEER IF ANY BRANCH CIRCUIT LENGTHS EXCEED 200'-0" PRIOR TO ROUGH-IN. FIELD COORDINATE ROUTING OF ALL BRANCH CIRCUITS.

**EXPANSION JOINT NOTE:**

ALL ELECTRICAL WIRING FEEDERS, BRANCH CIRCUITS, FIRE ALARM WIRING, ETC) THAT PASSES THROUGH THE NEW RENOVATED AREA INTO THE EXISTING BEAN BUILDING SHALL BE PROVIDED WITH EXPANSION FITTINGS AND CONNECTIONS TO ACCOMMODATE THE REQUIRED EXPANSION DEFLECTION.

**COMMON BRANCH CIRCUIT NOTE:**

ALL BRANCH CIRCUIT CONDUCTORS SERVING PATIENT BED LOCATIONS SHALL NOT BE INSTALLED AS PART OF A MULTI-WIRE BRANCH CIRCUIT PER NEC-2011 ARTICLE 71.19.

**TEL/DATA NOTE:**

REFER TO THE TEL/DATA DRAWINGS FOR COORDINATION, QUANTITIES AND LOCATIONS OF DEVICES, RACEWAYS, CONDUIT PATHWAYS AND POWER CRITERIA.

**ALTERNATE NOTE:**

REFER TO PRICING NARRATIVE FOR ADDITIONAL INFORMATION AND REQUIREMENTS FOR ALL ALTERNATES.

**ELECTRICAL POWER GENERAL NOTES**

1. BRANCH CIRCUIT CONDUCTOR SHALL BE DESIGNED TO UTILIZE THE ADVANTAGE OF MULTI-WIRE DISTRIBUTION, EXCEPT PATIENT CARES HOWEVER, NO MORE THAN (8) CURRENT CARRYING CONDUCTORS (3-PHASE, 3-NEUTRAL) SHALL BE INSTALLED IN A COMMON CONDUIT. ALL BRANCH CIRCUITS (NORMAL AND EMERGENCY) SHALL BE PROVIDED WITH INDIVIDUAL NEUTRALS.
2. PATIENT CARE AREA RECEPTACLES WILL BE LIMITED TO A MAXIMUM OF FOUR (4) DUPLEX RECEPTACLES PER 20A SINGLE-PHASE CIRCUIT. IT SHOULD BE ASSUMED THAT 50% OF THE RECEPTACLES IN THESE AREAS WILL BE EMERGENCY RECEPTACLES AND 10% OF THE RECEPTACLES IN THE OR SUITE.
3. ALL DUPLEX AND SPECIAL PURPOSE RECEPTACLES INDICATED FOR SPECIFIC EQUIPMENT WILL BE ON A DEDICATED CIRCUIT, CARRY 20% OF OVERALL RECEPTACLE COUNT AS DEDICATED CIRCUITS.
4. ISOLATED POWER PANEL BRANCH CIRCUITS SHALL BE PROVIDED WITH LOW LEAKAGE HIGH-DIELECTRIC TYPE INSULATION. THE USE OF PULLING COMPOUNDS IS PROHIBITED.
5. ALL MOTORS 18 HP AND UNDER SHALL BE 120V AND WIRED NO MORE THAN (3) PER 20A, 1-PHASE CIRCUIT. ALL MOTORS LARGER THAN 18 HP AND SMALLER THAN 120 HP SHALL BE 200V AND HAVE INDIVIDUAL CIRCUITS REQUIRED. REFER TO HVAC AND PLUMBING DOCUMENTS FOR LOCATION AND RATINGS OF ALL MOTORS. ALL MOTORS 12 HP AND ABOVE SHALL BE 480V, 3-PHASE AND BE ON INDIVIDUAL CIRCUITS.
6. ALL EMERGENCY SYSTEM WIRING SHALL BE IN CONDUIT.
7. ALL RECEPTACLES SHALL BE HOSPITAL GRADE.

**AUDIO/VISUAL NOTE:**

REFER TO THE AUDIO/VISUAL DRAWINGS FOR COORDINATION, QUANTITIES AND LOCATIONS OF DEVICES, RACEWAYS, CONDUIT PATHWAYS AND POWER CRITERIA.

**PERKINS + WILL**

225 Franklin St., Suite 1100  
Boston, MA 02110  
1817.478.0300  
1817.478.0321  
www.perkinswill.com

**Maine Medical Center**  
MaineHealth

**Bean 2 Roof Addition**  
22 Bramhall Street, Portland, Maine 04102

MEP ENGINEER  
**AKF ENGINEERS**  
41 Fenworth Street, 3rd Floor  
Boston, MA 02210  
1817.737.1111  
1817.737.4311

STRUCTURAL ENGINEER  
**SIMPSON GUMPERTZ & HEGER**  
41 Sevon Street, Building 1, Suite 500  
Waltham, MA 02453  
1.781.907.9000  
1.781.907.9009

MEDICAL EQUIPMENT PLANNERS  
**RTL ASSOCIATES INC.**  
1717 PACIFIC AVENUE  
DALLAS, TX 75201  
1.214.488.7600  
1.214.488.7601

COST ESTIMATOR  
**DG JONES & PARTNERS**  
3 Baldwin Green Common, Suite 202  
Woburn, MA 01801  
1.781.932.3131  
1.781.932.3199

**CONSTRUCTION DOCUMENTS**

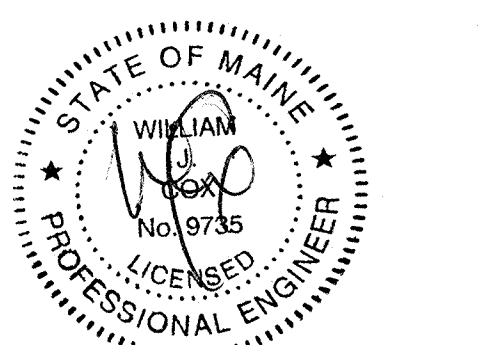
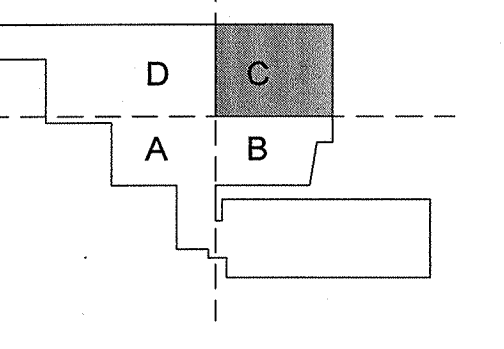

**Revisions**

NO.	ISSUE	DATE
2	Issued for Permit	02-07-14
1	Addendum #3	01-17-14
NO.	ISSUE	DATE

**Sheet Information**

Date: JUNE 14, 2013  
Job #: C140135481(MMC)152168.000  
Drawn: GN  
Checked: RAC  
Approved: RAC

**ELECTRICAL LEVEL 02 POWER PLAN - SECTOR C**

**Sheet E04-02C**

C:\Revit Local Files\2012\2012-MMC-Bean2-MEP-2\_G-Velozin.rvt