

2/20/14 7:02:07 PM
c:\bpm\mnc_new\bean2_arc4_kalmajp.rvt

NOTE
NO CEILINGS IN MECHANICAL AREA

NOTE
REFER TO ELECTRICAL PLANS FOR LIGHTING LAYOUT COORDINATION

NOTE
DIMENSIONS PROVIDED ARE FOR COORDINATING OVERHEAD LIGHTING PURPOSES ONLY

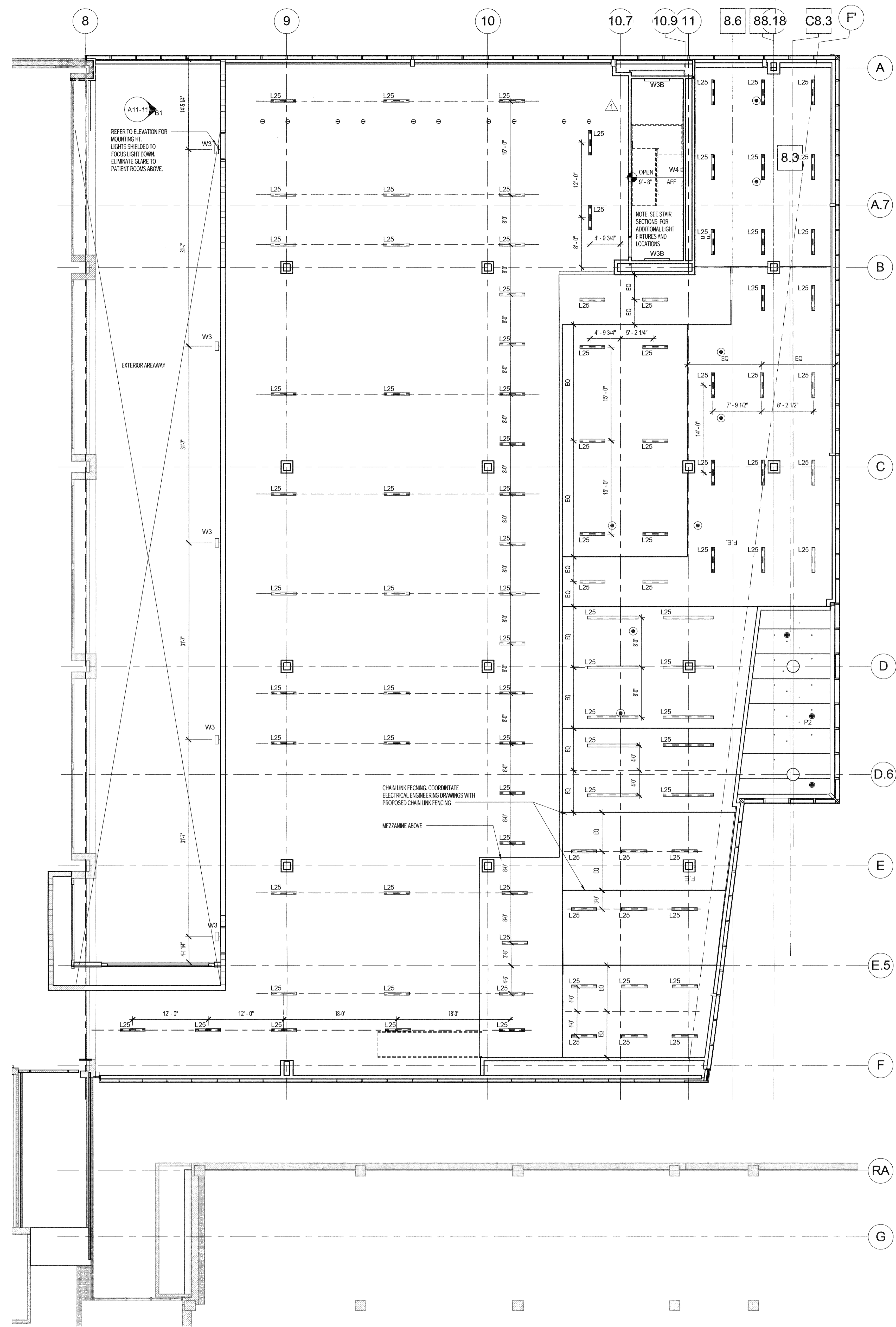

REFLECTED CEILING PLAN LEGEND

- L1 LINEAR SURFACE MOUNTED TR SMALL PROFILE
- L2 LINEAR RECESSED TO DOWNLIGHT, 4" APERTURE, DIMMING BALLAST
- L3 LINEAR RECESSED TO DOWNLIGHT, 4" APERTURE
- L4 LINEAR SURFACE MOUNTED TR SMALL PROFILE
- L5 LINEAR RECESSED TO DOWNLIGHT, 4" APERTURE
- L6 LINEAR SURFACE MOUNTED TR SMALL PROFILE
- L7 LINEAR CEILING RIG LED
- L8 LINEAR SURFACE MOUNTED TO COVE, ASYMMETRIC OPTICS
- L9 LINEAR MOUNTED TO SHRO, 2' X 3' HOUSING
- L10 LINEAR SURFACE MOUNTED LED STRIP
- L11 LINEAR WALL MOUNTED TO 8' X 8' PROFILE
- L12 LINEAR SURFACE MOUNTED TO UNDER-CABINET TASK LIGHT
- L13 LINEAR SURFACE MOUNTED WARM LED, 1.5' X 2'
- L14 LINEAR SURFACE MOUNTED WARM LED, 1.5' X 2'
- P2 PENDANT, 4" DIA, CABLE SUSPENDED
- R1 RECESSED CEILING LED OPEN DOWNLIGHT
- R2 RECESSED CEILING LED OPEN DOWNLIGHT
- R3 RECESSED CEILING LED OPEN DOWNLIGHT
- R4 RECESSED CEILING LED OPEN DOWNLIGHT, DIMMABLE
- R5 RECESSED CEILING LED OPEN DOWNLIGHT, 4" SQUARE
- R6 RECESSED CEILING LED OPEN DOWNLIGHT, DIMMABLE, 4" SQUARE
- R7 RECESSED CEILING 1' X 1' FLUORESCENT T 8
- R8 SEMI RECESSED CEILING FLUORESCENT T 4, 15' X 48"
- R9 SEMI RECESSED CEILING FLUORESCENT T 8, ASYMMETRIC, ANTI-MICROBIAL
- R10 RECESSED CEILING FLUORESCENT T 8, ANTI-MICROBIAL
- R11 RECESSED CEILING FLUORESCENT 2' X 2', ANTI-MICROBIAL
- R12 RECESSED CEILING FLUORESCENT 2' X 2'
- R13 RECESSED CEILING FLUORESCENT TSHO, 48", ASYMMETRIC
- R14 RECESSED CEILING FLUORESCENT TSHO, 24" ASYMMETRIC
- R15 RECESSED CEILING LED, 2' SQUARE
- R16 RECESSED CEILING LED, 2' SQUARE
- R17 RECESSED CEILING LED, 2.5' ROUND
- S1 STEM MOUNTED LINEAR TR 2" DIA
- S2 FLOOR MOUNTED LED
- W2 WALL SURFACE MOUNTED LINEAR TR FLUORESCENT UPLIGHT
- W3 WALL SURFACE MOUNTED, FROSTED LENS DOWNLIGHT
- W4 WALL SURFACE MOUNTED, FROSTED LENS UP & DOWNLIGHT
- W5 CEILING SURFACE MOUNTED, FROSTED LENS
- W6 LINEAR SURFACE MOUNTED, DUAL Sidelight LENS
- ACT 1 2x2 SUSPENDED ACOUSTICAL CEILING
- ACT 2 2x2 SUSPENDED ACOUSTICAL CEILING, WASHABLE, CLIP-DOWN
- ACT 3 2x4 SUSPENDED ACOUSTICAL CEILING
- ACT 4 2x4 SUSPENDED ACOUSTICAL CEILING, WASHABLE, CLIP-DOWN
- CMB CEILING
- EXPANSION JOINT
- ACCESS PANEL
- ANESTHESIOLOGY PANEL
- SERVICE PANEL
- RADIANT PANEL
- 2x2 SUPPLY
- 5'x8" SUPPLY
- 2x2 RETURN
- 2x4 RETURN
- 5'x8" RETURN
- FIRE ALARM SPEAKER
- SMOKE DETECTOR
- SPRINKLER
- EXIT SIGN
- NURSE CALL CODE BLUE - CEILING
- NURSE CALL CODE BLUE - WALL
- SECURITY CAMERA (N/C)
- FIRE SHUTTER
- BOOM
- OCCUPANCY SENSOR
- PUBLIC ADDRESS SPEAKER
- NURSE CALL LAMP
- PHOTO CELL
- WIRELESS OUTLET
- CRIBBLE PRIVACY CURTAIN TRACK
- TV TRACK
- MECHO SHADE

RCP GENERAL NOTES

- SEE ELEVATIONS FOR LOCATION OF LED LIGHTING AT RECEPTION AND COMMUNICATION STATION DESKS.
- SEE TYPICAL MOUNTING HEIGHT FOR MOUNTING HEIGHT OF WALL SCONCES.
- COORDINATE TEES AND HANGER LOCATIONS WITH LINEAR DIFFUSER/GRILLE BOOTS.
- SPRINKLER HEAD AND COVER TO BE CUSTOM COLORED BY MANUFACTURER TO MATCH ALL CEILING FINISH - COLOR TO BE DETERMINED BY ARCHITECT.
- DIFFUSER GRILLE TO BE CUSTOM COLORED TO MATCH ADJACENT CEILING FINISH. COLOR TO BE DETERMINED BY ARCHITECT.
- UNLESS OTHERWISE NOTED, CENTER ALL SUSPENDED CEILING GRIDS WITHIN ROOM.
- CENTER ALL LIGHT FIXTURES, SPRINKLER HEADS, ETC. IN CEILING TIE UNLESS OTHERWISE NOTED.
- SEE ENGINEERING DRAWINGS FOR ADDITIONAL INFORMATION, I.E. LIGHT FIXTURES, DIFFUSERS AND OTHER CEILING MOUNTED DEVICES.
- COORDINATE CEILING MOUNTED EQUIPMENT FINAL LAYOUT WITH OWNER AND VENDOR INSTALLATION DRAWINGS.
- PROVIDE UNDER-CABINET LIGHT AT ALL LOCATIONS WITH UPPER CABINETS.
- PROVIDE LENSED FLUORESCENT STRIP LIGHTING AS REQUIRED WITHIN LEVEL 4 PENTHOUSE. - REFER TO ELECTRICAL.

A1 LEVEL 04 MECHANICAL RCP PLAN
1/8" = 1'-0"

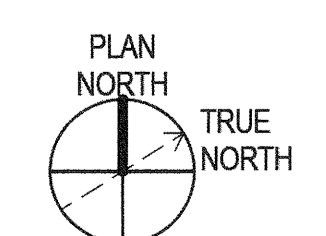

PERKINS + WILL

225 Franklin St., Suite 1100
Boston, MA 02110
1 617 439 0300
1 617 478 0321
www.perkinswill.com



Bean 2 Roof Addition

22 Bramhall Street, Portland, Maine 04102

MEP ENGINEER
AKF ENGINEERS

41 Farnsworth Street, 3rd Floor
Boston, MA 02210
1 617 237 3111
1 781 307 5000
1 781 307 9009

STRUCTURAL ENGINEER
SIMPSON GUMPERTZ & HEGGER

41 Seay Street, Building 1, Suite 500
Waltham, MA 02453
1 781 907 5000
1 781 907 9009

MEDICAL EQUIPMENT PLANNERS
RTL ASSOCIATES INC.

1717 PACIFIC AVENUE
DALLAS, TX 75201
1 214 468 7600
1 214 468 7801

COST ESTIMATOR
DG JONES & PARTNERS

3 Baldwin Green Common, Suite 202
Woburn, MA 01801
1 781 932 3131
1 781 932 3199

CONSTRUCTION DOCUMENTS

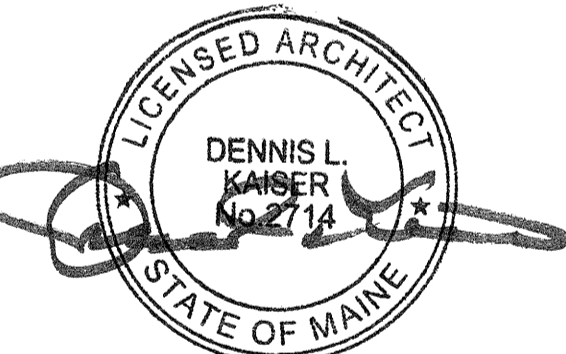
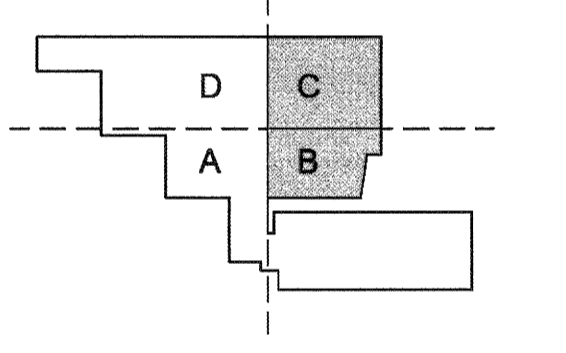

Revisions

NO	ISSUE	DATE
1	Issued for Permit	02/07/2014
1	Addendum #3	01/17/2014

Sheet Information
Date: SEPTEMBER 10, 2013
Job #: C140135461 (M/M/C) 152168.000
Drawn: TH
Checked: DG
Approved: Approver

LEVEL 04 MECHANICAL OVERALL RCP

Sheet
A05-03