

**Bean 2 Roof  
Addition**  
22 Bramhall Street, Portland,  
Maine 04102

MEP ENGINEER  
**AKF ENGINEERS**  
41 Farnsworth Street, 3rd Floor  
Boston, MA 02210  
617.337.1111  
617.337.4311

STRUCTURAL ENGINEER  
**SIMPSON GUMPERTZ &  
HEGER**  
41 Seyon Street, Building 1, Suite 500  
Waltham, MA 02453  
781.907.9000  
781.907.9009

MEDICAL EQUIPMENT PLANNERS  
**RTKL ASSOCIATES INC.**  
1717 PACIFIC AVENUE  
DALLAS, TX 75201  
214.468.7600  
214.468.7601

COST ESTIMATOR  
**DG JONES & PARTNERS**  
3 Baldwin Green Common, Suite 202  
Woburn, MA 01897  
781.932.3131  
781.932.3199

**CONSTRUCTION  
DOCUMENTS**

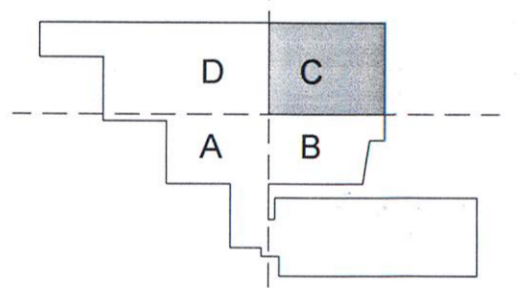

**Revisions**

NO	ISSUE	DATE
1	Issued for Permit	02/07/2014
1	Addendum #3	01/17/2014
NO	ISSUE	DATE

**Sheet Information**  
Date: SEPTEMBER 10, 2013  
Job #: C140135461 (MMC) 152168.000  
Drawn: AB  
Checked: DG  
Approved: Approver  
Title

**LEVEL 02  
ENLARGED PLAN -  
SECTOR C**

**Sheet  
A04-02C**

3/18/2014 12:43:05 PM  
c:\pmp\mmc\_NEW\_BEAN2\_ARCH\beamduct.rvt