

DIRECTORY	KVA LOAD			CKT NO.	BKRS AMPS	A	B	C	BKRS AMPS	CKT NO.	KVA LOAD			DIRECTORY
	A	B	C								A	B	C	
(1) UNKNOWN CIRCUIT				1	20					20				UNKNOWN CIRCUIT (1)
(1) UNKNOWN CIRCUIT				3	20					20				UNKNOWN CIRCUIT (1)
(1) UNKNOWN CIRCUIT				5	20					20				UNKNOWN CIRCUIT (1)
(1) UNKNOWN CIRCUIT				7	20					20				UNKNOWN CIRCUIT (1)
FIRE DAMPER END STOPS		0.6		9	20					20		0.8		RECEPTS NEURO READING 2
MRI #1 MAGNET RUN DOWN		1.0		11	20					20		0.8		RECEPTS NEURO READING 1
(1) UNKNOWN CIRCUIT				13	20					20				(1)
(1) UNKNOWN CIRCUIT				15	20					20				(1)
RECEPTS MSK READING B581		0.8		17	20					20				(1)
(1) UNKNOWN CIRCUIT				19	20					20				(1)
(1) UNKNOWN CIRCUIT				21	20					20				(1)
(1) UNKNOWN CIRCUIT				23	20					20				(1)
RECEPTS MSK READING B580	0.8			25	20					20	0.6			RECEPTS NEURO READING B589
(1) UNKNOWN CIRCUIT				27	20					20	0.8			RECEPTS NEURO READING B589
RECEPTS MSK READING B579		0.8		29	20					20	0.6			RECEPTS NEURO READING B589/CONF
RECEPTS READING ROOM B578	0.8			31	20					20	1.0			COMPRESSOR WATER BYPASS
QUAD RECEPT MRI CLOSET		0.4		33	20					20				SPARE
FERROGRAD METAL DETECTORS				35	20					20				SPARE
SPARE				37	20					20				SPARE
SPARE				39	20					20				SPARE
SPARE				41	20					20				SPARE
SUB-TOTAL														SUB-TOTAL
VOLTAGE: 208Y/120V 3 PHASE 4 WIRE				100 AMP BUS				TOTAL KVA	A			PANEL NO.		
MAIN LUGS ONLY				100 AMP LUGS				TOTAL KVA	B					P2
MOUNTING: RECESSED								TOTAL KVA	C			LOCATION		
SC RATING: 10,000 AIC								TOTAL KVA						MRI #CONTROL
NOTES:														

NOTE:

- SEE SHEET E-001 FOR LEGEND AND GENERAL NOTES.

KEYED NOTES:

- FURNISH & INSTALL A TWO GANG WEATHERPROOF JUNCTION BOX AT DIMPLEX CHILLER AND RUN AN EMPTY 3/4" CONDUIT FROM JUNCTION BOX AT CHILLER TO JUNCTION BOX FOR CHILLER REMOTE MONITOR IN THE MRI CONTROL ROOM. SEE SHEET EP401 FOR LOCATION OF REMOTE MONITOR. CONDUIT RUN TO BE AS SHORT AS POSSIBLE AND MUST BE LESS THAN 140'. COORDINATE ALL WORK WITH EQUIPMENT SUPPLIER.
- PROVIDE POWER FOR REPLACEMENT EXHAUST FAN EF-M-3. UTILIZE EXISTING COMBINATION DISCONNECT/MOTOR STARTER AND EXISTING WIRING BETWEEN FAN AND COMBINATION STARTER TO THE EXTENT POSSIBLE TO FEED NEW FAN.
- FURNISH & INSTALL A NEW WEATHERPROOF GFCI SERVICE RECEPTACLE AND FEED FROM SAME BRANCH CIRCUIT THAT FEEDS RECEPTACLES IN MECHANICAL ROOM OR THE CIRCUIT THAT FEEDS THE EXISTING EXTERIOR RECEPTACLE NEAR THE NEW CHILLER. FIELD LOCATE EXACT PLACE TO CONNECT TO EXISTING 120V CIRCUIT.
- PROVIDE POWER FOR NEW FIRE DAMPER END SWITCHES. COORDINATE WITH MECHANICAL CONTRACTOR FOR EXACT LOCATION OF ELECTRICAL CONNECTIONS.
- DISCONNECT POWER FOR EXISTING SMOKE DAMPER AND RECONNECT TO NEW LARGER DAMPER THAT IS BEING INSTALLED. FROM THE SAME CIRCUIT THAT FEEDS THE EXISTING SMOKE DAMPER RUN POWER TO NEW ADDITIONAL SMOKE DAMPER BEING INSTALLED. REMOVE EXISTING DUCT SMOKE DETECTOR AND REINSTALL IN NEW LARGER DUCT. UPON ACTIVATION DUCT SMOKE DETECTOR TO CLOSE BOTH SMOKE DAMPERS.

144 Fore Street/P.O. Box 618
Portland, Maine 04104
Tel. (207) 772-3946
Fax. (207) 772-1070
www.smriinc.com

ARCHITECTURE
ENGINEERING
PLANNING
INTERIOR DESIGN
COMMISSIONING

SMRI

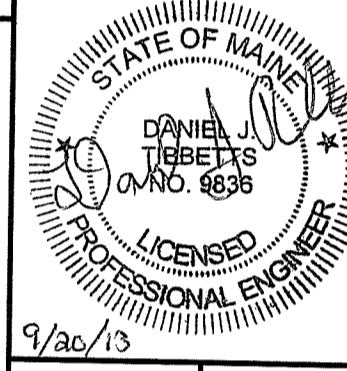
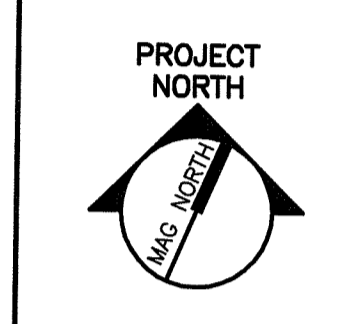

MAINE MEDICAL CENTER
MRI #1 AND READING ROOM RENOVATION
PORTLAND, MAINE

ISSUED FOR CONSTRUCTION
9-20-13

CURRENT ISSUE STATUS:

REV	DESCRIPTION	DATE
0	ISSUED FOR CONSTRUCTION	9-20-13

GRAPHIC SCALE:
0" = 1"

SCALE: 1/8"=1'-0"

PROJECT MANAGER: DJV
JC/DRAWN BY: CDS
A/E OF RECORD: DJT
CAD FILE: EP120-12118
PROJECT NO: 12118
DATE: 9-20-13

SHEET TITLE:
ROOF AND MECHANICAL ROOM POWER PLAN

SHEET No.
EP120
© COPYRIGHT 2013 SMRI INC.

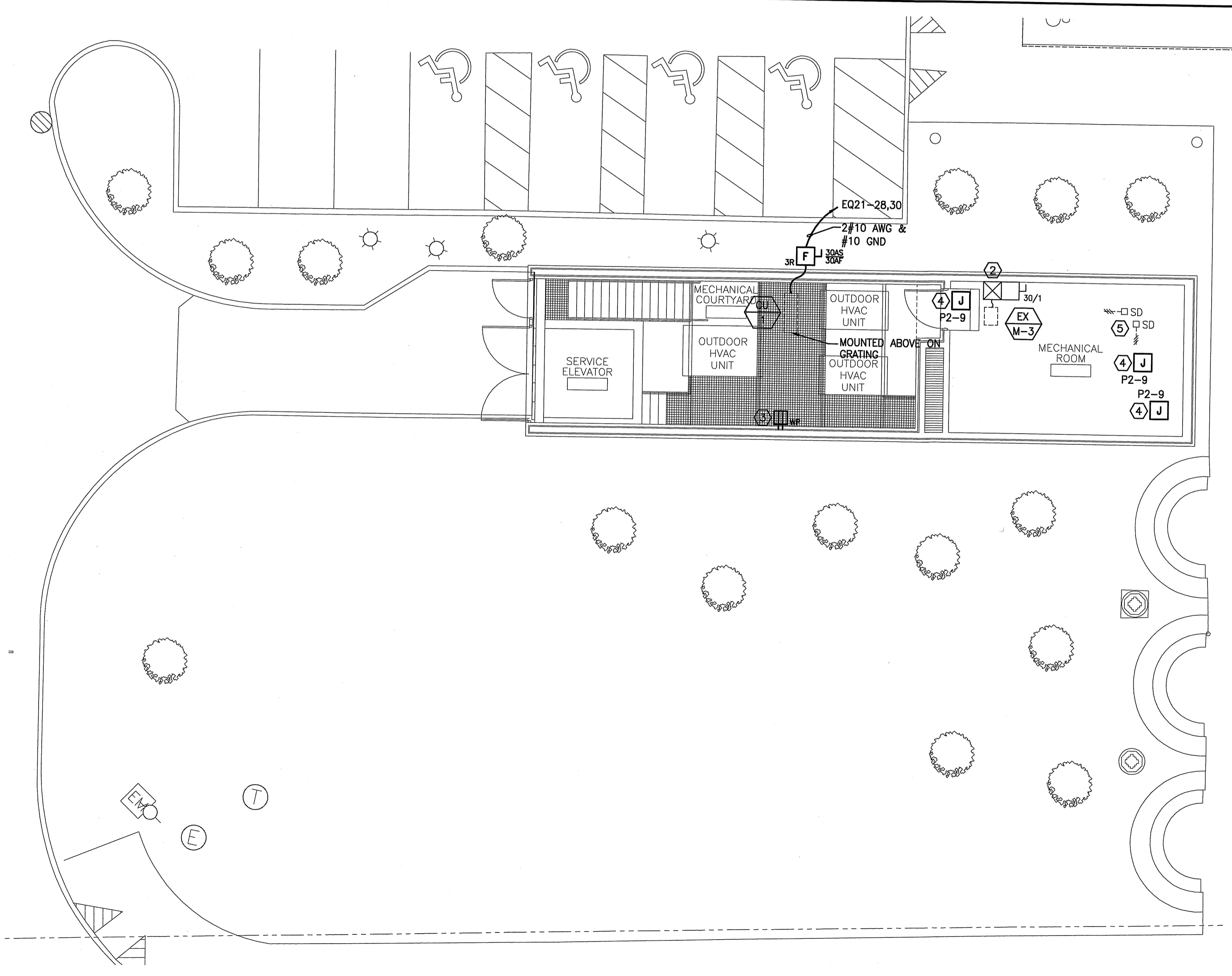

A1 MECHANICAL ROOM POWER PLAN
1/8"=1'-0"

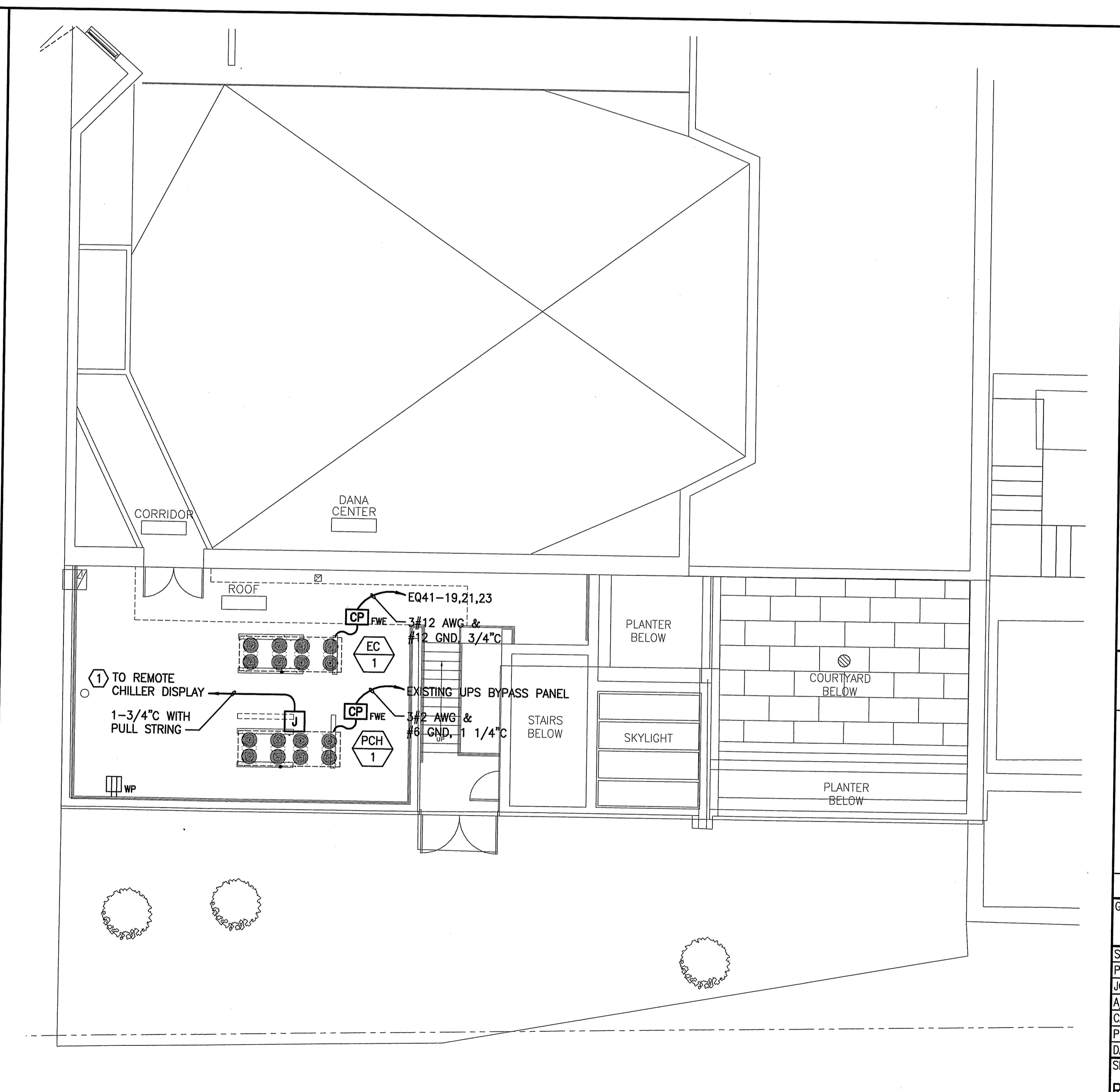

A10 ROOF POWER PLAN
1/8"=1'-0"