

1 BASEMENT FLOOR PLAN
1/4" = 1'-0"

GENERAL DEMOLITION NOTES:

1. COORDINATE EXTENT OF DEMOLITION WITH LOCATIONS OF PARTITIONS DESCRIBED ON PLANS AND WITH LOCATIONS OF FINISHES NOTED AS EXISTING TO REMAIN.
2. ANY WALL, PARTITION, OR SURFACE DISTURBED BECAUSE OF NEW WORK OR DEMOLITION SHALL BE PATCHED AND FINISHED CONTINUOUSLY TO THE NEAREST CORNER UNLESS NOTED OTHERWISE. MATCH EXISTING ADJACENT CONSTRUCTION FINISHES, CONTINUITY, AND FIRE RATINGS UNLESS NOTED OTHERWISE.
3. PROTECT ALL FINISHES, MATERIALS AND EQUIPMENT BECAUSE OF NEW WORK OR DEMOLITION SHALL BE PATCHED AND FINISHED CONTINUOUSLY TO THE NEAREST CORNER UNLESS NOTED OTHERWISE. MATCH EXISTING ADJACENT CONSTRUCTION FINISHES, CONTINUITY, AND FIRE RATINGS UNLESS NOTED OTHERWISE.
4. DIMENSIONS INDICATED +/- ARE EXISTING CONDITION DIMENSIONS TO BE VERIFIED IN FIELD.
5. CONTRACTOR TO HOLD PRE-DEMOLITION MEETING WITH OWNER, CONSTRUCTION MANAGER, SUB-CONTRACTORS, ETC. PRIOR TO BEGINNING DEMOLITION WORK TO REVIEW HOSPITALS POLICIES, NOISE CONTROL MEASURES, ETC.
6. CLEARLY IDENTIFY AND TAG MECHANICAL, PLUMBING AND ELECTRICAL FIXTURES OR EQUIPMENT THAT ARE STILL IN USE PRIOR TO DEMOLITION TO AVOID ACCIDENTAL REMOVAL.
7. WALLS INDICATED WITH A DASHED LINE ARE TO BE REMOVED COMPLETE. IF WALL IS BEARING PRIOR TO REMOVAL, IF SO, CONTACT ARCHITECT/ENGINEER IMMEDIATELY.
8. SEE M.E.P. DRAWINGS FOR THE SCOPE OF DEMOLITION IN THOSE DISCIPLINES.

DEMOLITION PLAN KEY NOTES:

- 1 REMOVE DOOR, FRAME AND HARDWARE. COORDINATE WITH OWNER THOSE ITEMS TO BE SALVAGED PRIOR TO REMOVAL.
- 2 REMOVE WALL OR PORTION OF WALL INDICATED BY DASHED LINE. PRIOR TO REMOVAL, IDENTIFY IF WALL IS LOAD BEARING. IF FOUND TO BE A BEARING WALL NOTIFY ARCHITECT IMMEDIATELY.
- 3 REMOVE FINISH FLOOR MATERIAL (IF ANY) AND BASE. PREPARE SURFACE FOR NEW FINISHES AS REQUIRED BY SCHEDULE AND SPECIFICATIONS.
- 4 REMOVE CEILING SYSTEM COMPLETE. I.E. FRAMING MEMBERS, TRACKS, WIRES, LIGHTING, UNISTRUT ETC. COORDINATE EXTENTS WITH SCOPE OF NEW WORK.
- 5 REMOVE CASEWORK AND COUNTER TOP. COORDINATE WITH OWNER THOSE ITEMS TO BE SALVAGED PRIOR TO REMOVAL.
- 6 REMOVE PORTION OF FLOOR/SLAB FOR ELECTRICAL TRENCH/CONDUIT. SEE ELECTRICAL AND VENDOR DRAWINGS FOR LOCATIONS. COORDINATE WITH ELEC./MECH. FOR POWER, CONDUIT & MEDGAS.
- 7 REMOVE STORAGE CABINET COMPLETE. SEE NEW WORK AND EQUIPMENT SCHEDULE FOR CABINETS TO BE REUSED. COORDINATE SALVAGE/RE-USE OF EXISTING EQUIPMENT WITH THE OWNER.
- 8 REMOVE PORTION OF FLOOR/SLAB FOR ELECTRICAL TRENCH/CONDUIT. SEE ELECTRICAL AND VENDOR DRAWINGS FOR LOCATIONS.

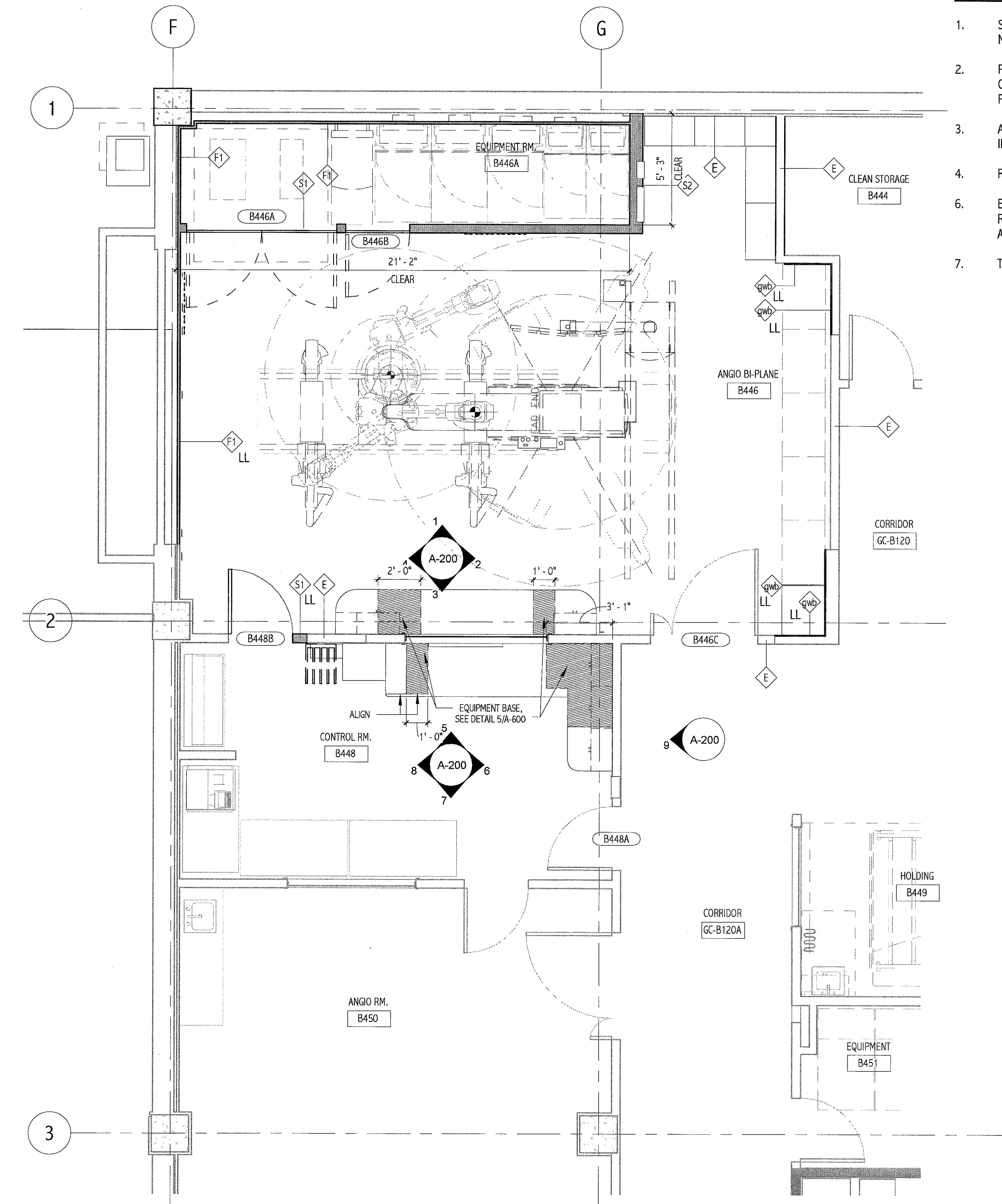

2 BASEMENT FLOOR PLAN
1/4" = 1'-0"

GENERAL NOTES:

1. SEE SHEET G-001 FOR LEGEND, ABBREVIATIONS AND GENERAL NOTES.
2. FURNITURE/EQUIPMENT DASHED IN BY OTHERS IS INDICATED FOR COORDINATION. PROVIDE BLOCKING FOR ALL MOUNTED CASEWORK, FURNITURE, EQUIPMENT AND ANY OTHER NIC ITEMS.
3. ALL OWNER PROVIDED KEYBOARD TRAYS AND CPU HOLDERS INSTALLED BY OTHERS.
4. REFER TO FINISH SCHEDULES FOR WALL PROTECTION LOCATIONS.
5. EXISTING INTERIOR PARTITIONS TO REMAIN EXCEPT WHERE WORK REQUIRES CUTTING, PATCHING AND FINISHING OF WALL TO ACCOMMODATE UTILITY LOCATION.
6. TYPICAL WALL TYPE S1 U.N.Q.

PARTITION LEGEND:

F1	FURRING PARTITION -7/8" METAL HAT SECTION 24" O.C. TO DECK (1) LAYER 5/8" GMB, TO DECK	
F2	FURRING PARTITION -3 5/8" 25 GA. STEEL STUDS @ 24" O.C. TO DECK (1) LAYER 5/8" INTERIOR GYPSUM BOARD TO DECK, TAGGED SIDE	
S1	SOUND ATTENUATED PARTITION: STC 45 -(1) LAYER 5/8" INTERIOR GYPSUM BOARD TO DECK -3 5/8" 25 GA. STEEL STUDS @ 24" O.C. TO DECK; U.N.Q. -FULL BATT INSULATION -(1) LAYER 5/8" INTERIOR GYPSUM BOARD TO DECK -SEAL ALL PENETRATIONS FOR SOUND.	
S2	-(1) LAYER 5/8" INTERIOR GYPSUM BOARD TO DECK -6" 25 GA. STEEL STUDS @ 24" O.C. TO DECK; U.N.Q. -FULL BATT INSULATION -(1) LAYER 5/8" INTERIOR GYPSUM BOARD TO DECK -SEAL ALL PENETRATIONS FOR SOUND.	
GMB	PROVIDE 1 LAYER OF LEAD LINED GMB OVER EXISTING METAL STUD. PROVIDE BLOCKING WHERE REQUIRED. TAGGED SIDE	
LL	SUBSTITUTE TAGGED SIDE GMB FOR 1/16" LEAD LINED GMB TO 7'-0" AFF	

144 Free Street, P.O. Box 618
Portland, Maine 04104
Tel: (207) 773-3846
Fax: (207) 773-1070
www.smrtinc.com

ARCHITECTURE
ENGINEERING
PLANNING
INTERIOR DESIGN
COMMISSIONING

SMRT

LICENSED ARCHITECT
DEREK J. VEILLEUX
No. 81815
STATE OF MAINE
6.14.11

PROJECT NORTH

Bramhall Radiology
ANGIO BI-PLANE RENOVATIONS
PORTLAND, ME

ISSUED FOR CONSTRUCTION
06.14.11

CURRENT ISSUE STATUS

NO.	DESCRIPTION	DATE
06.14.11	DATE	
06.14.11	DATE	

GRAPHIC SCALE:
0" 1"

SCALE: As indicated

PROJECT MANAGER: DN
IC/DRAWN BY: ART
A/E OF RECORD: DN
PROJECT NO.: 11011
DATE: 06.14.11

SHEET TITLE:
**BASEMENT
DEMOLITION AND
FLOOR PLANS**

SHEET No. **A-100**