

1 EXISTING PUMPHOUSE - DEMO PLAN
SCALE: 1/8" = 1'-0"

- DEMOLITION NOTES:**
1. ALL CONDENSER WATER SYSTEM DEMOLITION SHALL OCCUR AFTER NEW CHILLED WATER SYSTEM IS INSTALLED AND OPERATIONAL.
 2. ALL EXISTING CONDENSER WATER SYSTEMS SHALL BE DEMOLISHED AND REMOVED FROM THE SITE.
 3. ALL EXISTING CONDENSER WATER SYSTEMS SHALL BE DEMOLISHED AND REMOVED FROM THE SITE.
 4. REMOVE ALL OILS AND OILS SPRING TO PAVE ROOM WALL, CAP REMOVED APPROXIMATELY.
 5. REMOVE 2" RIGID POLYURETHANE INSULATION FROM ALL FLOOR WALLS.
 6. REMOVE 2" RIGID POLYURETHANE INSULATION FROM ALL FLOOR WALLS.
 7. REMOVE (2) EXISTING FUEL OIL PUMPS, CONCRETE PAD, AND APPURTENANCES.
 8. EXISTING ROOM DEMOLITION FOR DAMPERS AND LOGS TO REMAIN.
 9. REMOVE EXISTING CONCRETE AND LEFT FROM REMOVED DEMOLITION OF FUEL OIL PUMPS.
 10. REMOVE EXISTING CONDENSER WATER TREATMENT SYSTEM AND ALL APPURTENANCES.
 11. REMOVE EXISTING COOLING TOWER WAREHOUSE FREESTANDING SPACES.
 12. REMOVE (2) EXISTING CONDENSER WATER PUMPS AND ALL APPURTENANCES.
 13. EXISTING WALL LAGERS AND ATTACHED DAMPERS TO REMAIN.
 14. REMOVE EXISTING APPROXIMATE STEAM TRUNK, CAP WAS REMOVED AT WALL.
 15. EXISTING STEAM PIPING STATION TO REMAIN.
 16. EXISTING STEAM LINE DETAIL, STEAM PIPING, AND APPURTENANCES TO REMAIN.
 17. REMOVE EXISTING COOLING TOWER, PIPING, CONTROLS, AND ALL APPURTENANCES.

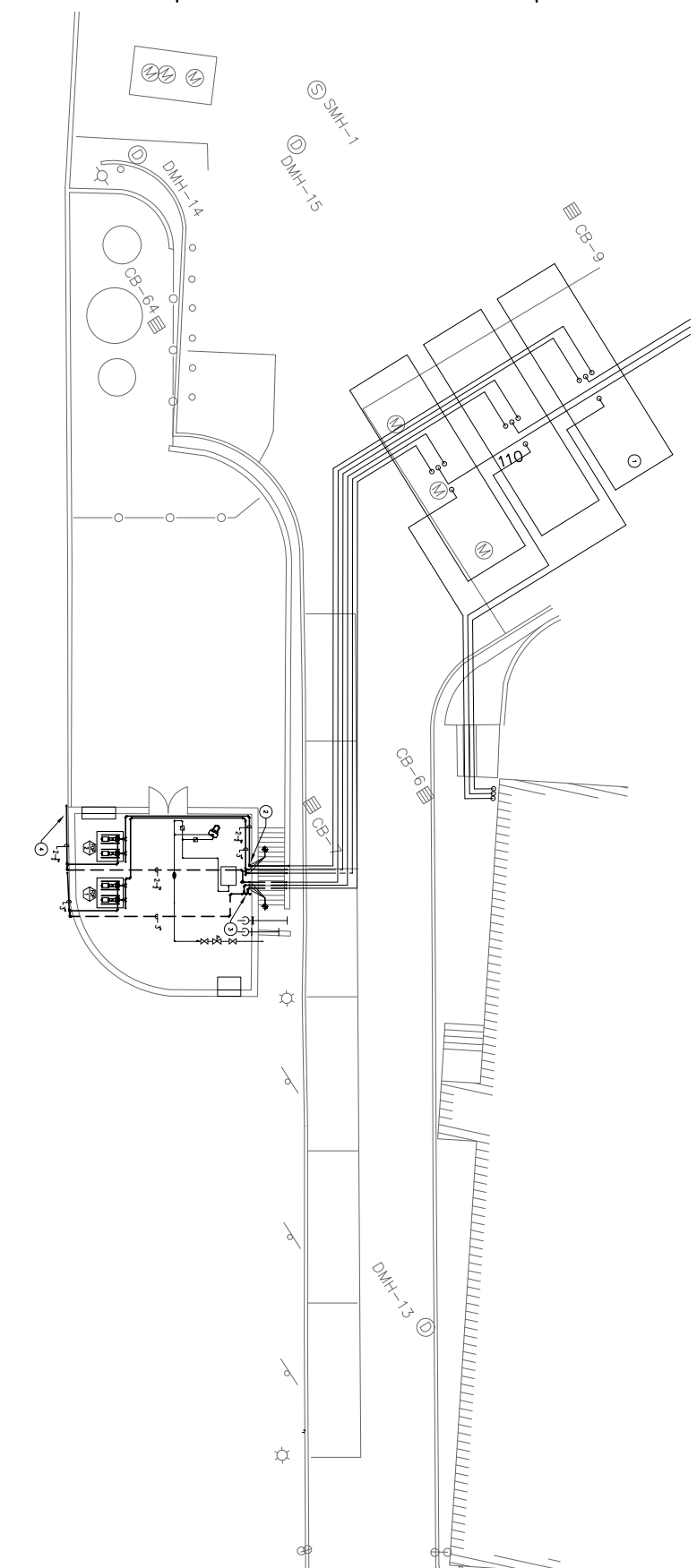

2 EXISTING PUMPHOUSE - NEW WORK PLAN
SCALE: 1/8" = 1'-0"

- NEW WORK NOTES:**
1. REMOVE ALL EXISTING 2" FUEL OIL FROM THE EXISTING STEAM COILS. MAKE THE STEAMERS SHALL BE REMOVED, REJECTED, AND REMOVED FROM THE SITE.
 2. CONNECT TO THE EXISTING 2" FUEL LINE WITH NEW 2" FUEL FOR CONDENSER PIPING FROM SET (CON-2).
 3. CONNECT (2) EXISTING 2" FUEL LINES FROM FUEL OIL PUMPS INTO NEW 2" FUEL LINE FROM FUEL OIL PUMPS INTO EXISTING CONDENSER WATER SYSTEM FROM SET (CON-2).
 4. 2" FUEL OIL PIPING AND DETAIL STEAM PIPING, AND APPURTENANCES TO REMAIN. REMOVE EXISTING CONDENSER WATER SYSTEM FROM SET (CON-2).

ISSUE DATE: 09/24/14
FOR PERMIT ONLY - NOT FOR CONSTRUCTION

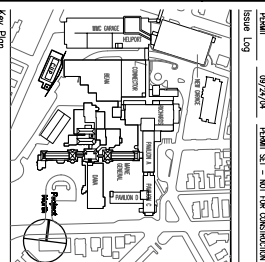

TRO
 A ARCHITECTURE
 PLANNING
 ENGINEERING
 INTERIORS
 THE MAINE MEDICAL CENTER
 PORTLAND, MAINE
 1000 BOSTON STREET
 PORTLAND, ME 04103
 TEL: 603.763.1234
 WWW.TROARCHITECTS.COM

Maine Medical Center
 Central Utility Plant
 Portland, Maine

MECHANICAL - PUMP HOUSE FLOOR PLANS

Project No. 4377
 Scale: 1/8" = 1'-0"
 Date: 09/24/14
 Designer: TRO ARCHITECTS
 Checker: TRO ARCHITECTS
 Title: **M406**