

General Notes:

LIFE SAFETY LEGEND

- RATED PARTITIONS ARE INDICATED AS FOLLOWS:
 - 1HR FIRE RATED PARTITION
 - 2HR FIRE RATED PARTITION
 - NON-RATED SMOKE RESISTANT PARTITION
 - 1HR SMOKE BARRIER
 - 2HR RATED FIRE AND SMOKE BARRIER
 - PATH OF EXIT TRAVEL
 - 122' DISTANCE TO EXIT FROM REMOTE POINT ON FLOOR OR WITHIN SUITE OF ROOMS
 - EXIT INDICATES EXIT LOCATION
 - SUITE (UNRATED)
 - EXISTING EGRESS STAR

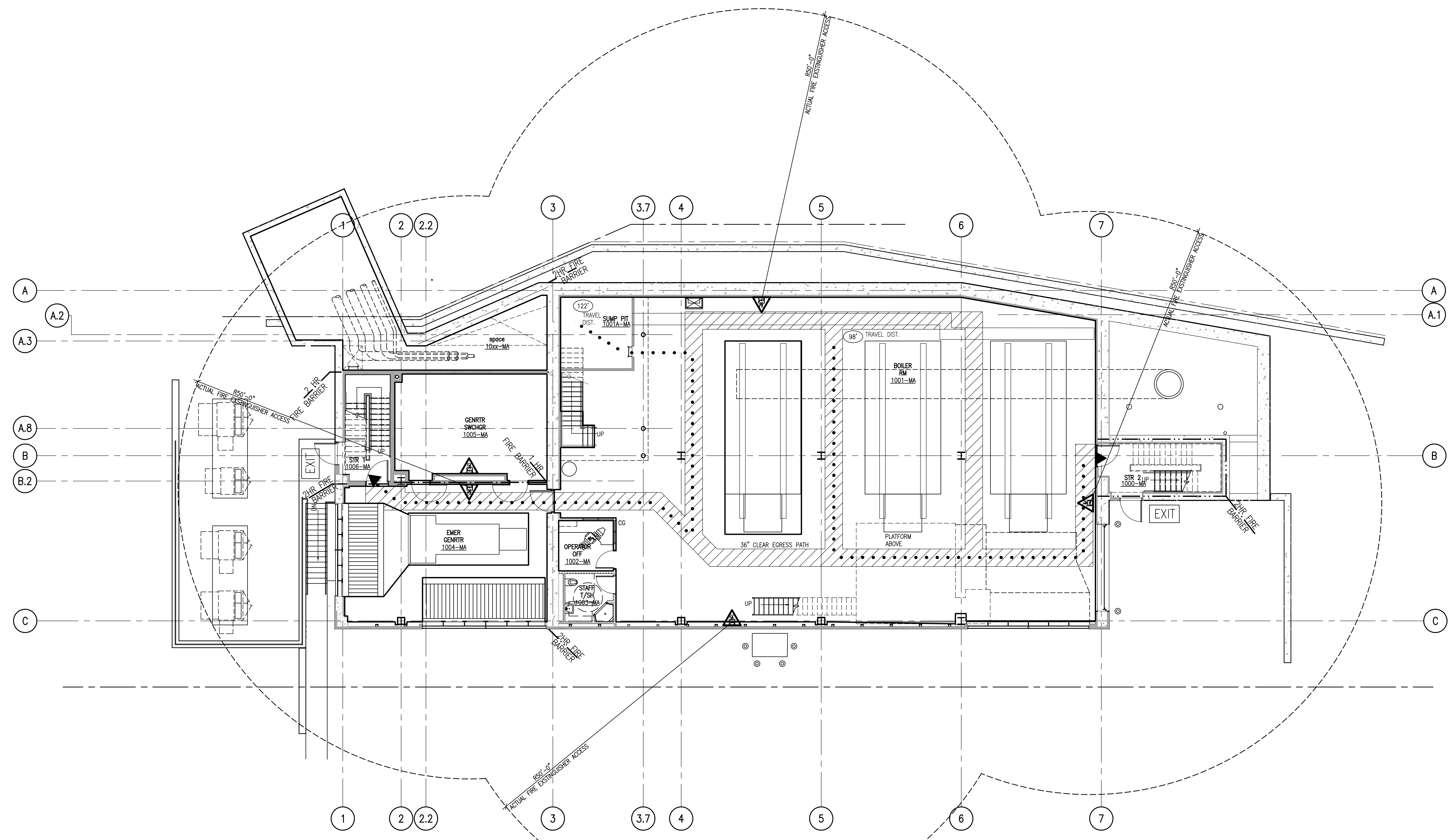

**FOR PERMIT ONLY
NOT FOR CONSTRUCTION**

PERMIT 09/24/04 PERMIT SET - NOT FOR CONSTRUCTION
Issue Log

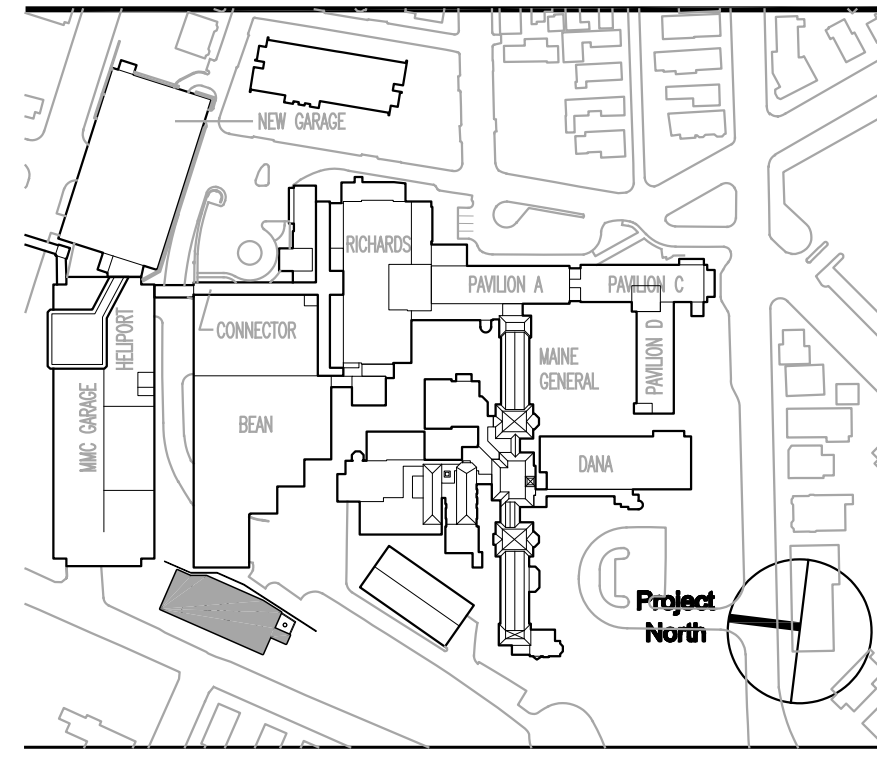

Key Plan

TRO
ARCHITECTURE
PLANNING
ENGINEERING
INTERIOR DESIGN
The Flexible Organization
80 Bridge Street
Newton, MA 02458-1134
617-559-0400

FIRST LEVEL
LIFE SAFETY PLAN
SCALE: 1/8" = 1'-0"

**CENTRAL UTILITY PLANT
CODE ANALYSIS - LIFE SAFETY**

SECTION	SECTION DESCRIPTION	REQUIREMENT	COMMENTS
A6.1.12.1(7)	CLASSIFICATION OF OCCUPANCY	CHAPTER 40	INDUSTRIAL (SPECIAL PURPOSE INDUSTRIAL OCCUPANCY)
40.1.4.1(b)	CLASSIFICATION OF HAZARD CONTENTS	COMPLY WITH SECTION 40.2.2.3	ORDINARY HAZARD
40.1.6	MINIMUM CONSTRUCTION REQUIREMENTS	NONE	FULLY SPRINKLERED
40.1.7	OCCUPANT LOAD (89 PEOPLE PER LEVEL BASED ON BOCA '99)	THE OCCUPANT LOAD SHALL BE DETERMINED ON THE BASIS OF THE MAXIMUM PROBABLE POPULATION OF THE SPACE	REFER TO THE BUILDING CODE OCCUPANCY SECTION
40.2	MEANS OF EGRESS REQUIREMENTS	DOOR OPENINGS IN MEANS OF EGRESS SHALL NOT BE LESS THAN 32 CLEAR WIDTH	FULLY SPRINKLERED

**CENTRAL UTILITY PLANT
FIRE RATINGS - LIFE SAFETY**

ITEM DESCRIPTION	FIRE RATING	COMMENTS
EXTERIOR BEARING WALLS	3_HRS.	
INTERIOR BEARING WALLS	3_HRS.	
MULTI SUPPORT	2_HRS.	
SINGLE SUPPORT ONLY	2_HRS.	
ROOF SUPPORT ONLY	2_HRS.	
COLUMNS	3_HRS.	
MULTI SUPPORT	3_HRS.	
SINGLE SUPPORT ONLY	2_HRS.	
ROOF SUPPORT ONLY	2_HRS.	
BEAMS, GIRDERS, TRUSSES, AND ARCHES	3_HRS.	
MULTI SUPPORT	3_HRS.	
SINGLE SUPPORT ONLY	2_HRS.	
ROOF SUPPORT ONLY	2_HRS.	
FLOOR CONSTRUCTION	2_HRS.	
ROOF CONSTRUCTION	1 1/2_HRS.	NO HEIGHT EXCEPTIONS ALLOWED
EXTERIOR NONBEARING WALLS	0_HRS.	

**CENTRAL UTILITY PLANT
FIRE RATINGS - BUILDING CODE**

ITEM DESCRIPTION	FIRE RATING	COMMENTS
EXTERIOR WALLS (FIRE SEPARATION 0-5')	2_HRS.	
EXTERIOR WALLS (FIRE SEPARATION GREATER THAN 10')	1_HRS.	
FIRE ENCLOSURE OF EXITS	2_HRS.	
SHAFTS (OTHER THAN EXITS AND ELEVATOR HOISTWAYS)	2_HRS.	
OTHER NONBEARING PARTITIONS	0_HRS.	
INTERIOR COLUMNS & FRAMING	3_HRS.	
WALTS SUPPORT	2_HRS.	
SINGLE AND ROOF SUPPORT	2_HRS.	
STRUCTURAL MEMBERS SUPPORTING WALL	2_HRS.	
FLOOR CONSTRUCTION INCLUDING BEAM	2_HRS.	
ROOF CONSTRUCTION INCLUDING BEAMS, TRUSSES AND FRAMING ARCHES AND ROOF DECK	1 1/2_HRS.	SUPERCEDED BY NFPA 101 REQUIRING 1 1/2 HOUR WITH NO EXCEPTIONS.

**CENTRAL UTILITY PLANT
CODE ANALYSIS - BUILDING CODE**

SECTION	SECTION DESCRIPTION	REQUIREMENT	COMMENTS
302.1, 306.2	USE GROUP	F-1 INDUSTRIAL	BOILER PLANT - ELECTRICAL GENERATION
TABLE 503	HEIGHT & AREA LIMITATIONS	NOT LIMITED	
SECTION 603/TABLE 602	CONSTRUCTION CLASSIFICATION	1B	NEW CONSTRUCTION
TABLE 1006.5	EXIT ACCESS TRAVEL - ALLOWABLE MAX - ACTUAL PROJECT TRAVEL DIST.	250' FT. (MAX) 122' FT. (GREATEST DIST.)	REF. TO PLANS
TABLE 1008.1.2	MINIMUM FLOOR AREA ALLOWANCES PER OCCUPANT	100 SQ/FT PER OCCUPANT	5,053 SF FIRST FLOOR; 5,053 DIVIDED BY 100 = 50.53 = 51 OCCUPANTS AT FIRST FLOOR
TABLE 1009.2	EGRESS WIDTH PER OCCUPANT	SPRINKLERED, USE GROUP F-1 STAIRWAYS ARE ALLOWED 2" PER PERSON, DOORS 15" PER PERSON	STAIR: 51 X 27" = 10.2" REQ. 3"-10" PROVIDED DOOR: 51 X 15" = 7.65" REQ. 2"-10" MIN. PROVIDED
TABLE 1010.2	MINIMUM NUMBER OF EXITS FOR OCCUPANT LOAD	2 EXITS FOR 500 OR LESS PEOPLE	51 OCCUPANTS / 2 EXITS = 26 OCCUPANTS PER EXIT
TABLE 1010.2	NUMBER OF EXITS REQUIRED FOR MAX OF 500 OCCUPANTS	REQUIRED: 2 PROVIDED: 2	
MEZZANINES	AREA LIMITATIONS (TYPE 1 CONSTRUCTION, SPECIAL INDUSTRY OCCUPANCY USE)	AREA NOT TO EXCEED 1/3 OF ROOM AREA	
2805.2.2	EQUIPMENT PLATFORMS	AREA LIMITATIONS	COMBINED WITH MEZZANINE AREA, NOT TO EXCEED 1/3 OF ROOM AREA BELOW
2805.2.3	EQUIPMENT PLATFORMS	PLATFORM ACCESS	ACCESS TO PLATFORM IN ACCORDANCE WITH SECTION 1027.1.1
2805.2.4	EQUIPMENT PLATFORMS	FIRE SUPPRESSION	EQUIPMENT PLATFORMS SHALL BE FULLY PROTECTED BY AN AUTOMATIC SPRINKLER SYSTEM ABOVE AND BELOW THE EQUIPMENT PLATFORM

TRAVEL DISTANCES

TABLE 402.6 TABLE 402.6	ALLOWED MAX.	PROVIDED	COMMENTS
400' NFPA*	400'	REFER TO PLANS	DOES NOT EXCEED MAX COMMON PATH OF TRAVEL DISTANCE OF 100'-0"
REMNITNESS 7.5.1.3.2 OVERALL DIM.	>4" MAX DIAG.	REFER TO PLANS	

* SUPERCEDED BY LIMIT EXPRESSED IN BOCA 1999

* INFORMATION TAKEN FROM 1999 NFPA 220 TABLE 3-1 TYPE I(332) CONSTRUCTION

TRAVEL DISTANCES

ALLOWED MAX.	PROVIDED	COMMENTS
250' BOCA	BOCA 1999, EXIT TRAVEL; TABLE 1006.5 REMOTE POINT TO NEAREST EXIT	
250' BOCA	REFER TO PLANS	BOCA, EXIT ACCESS TRAVEL; TABLE 1006.5 REMOTE POINT TO NEAREST EXIT
>4" MAX DIAG. OVERALL DIM.	REFER TO PLANS	BOCA, 1006.4.1 REMITNESS; EXITS OR EXIT ACCESS DOORS

Maine Medical Center
Central Utility Plant
Portland, Maine

**FIRST LEVEL
LIFE SAFETY PLAN**

Commission No. 4677 Date Issued
Scale 1/8" = 1'-0" Sheet Number
Drawn By LR/MC
Approved By TML
Filename 4677G101.dwg
Copyright © 2004 The Flexible Organization

G101