

WALL SECTION - NORTH WALL
TAKEN BETWEEN GRIDLINES C AND B.2
SCALE: 3/8" = 1'-0"

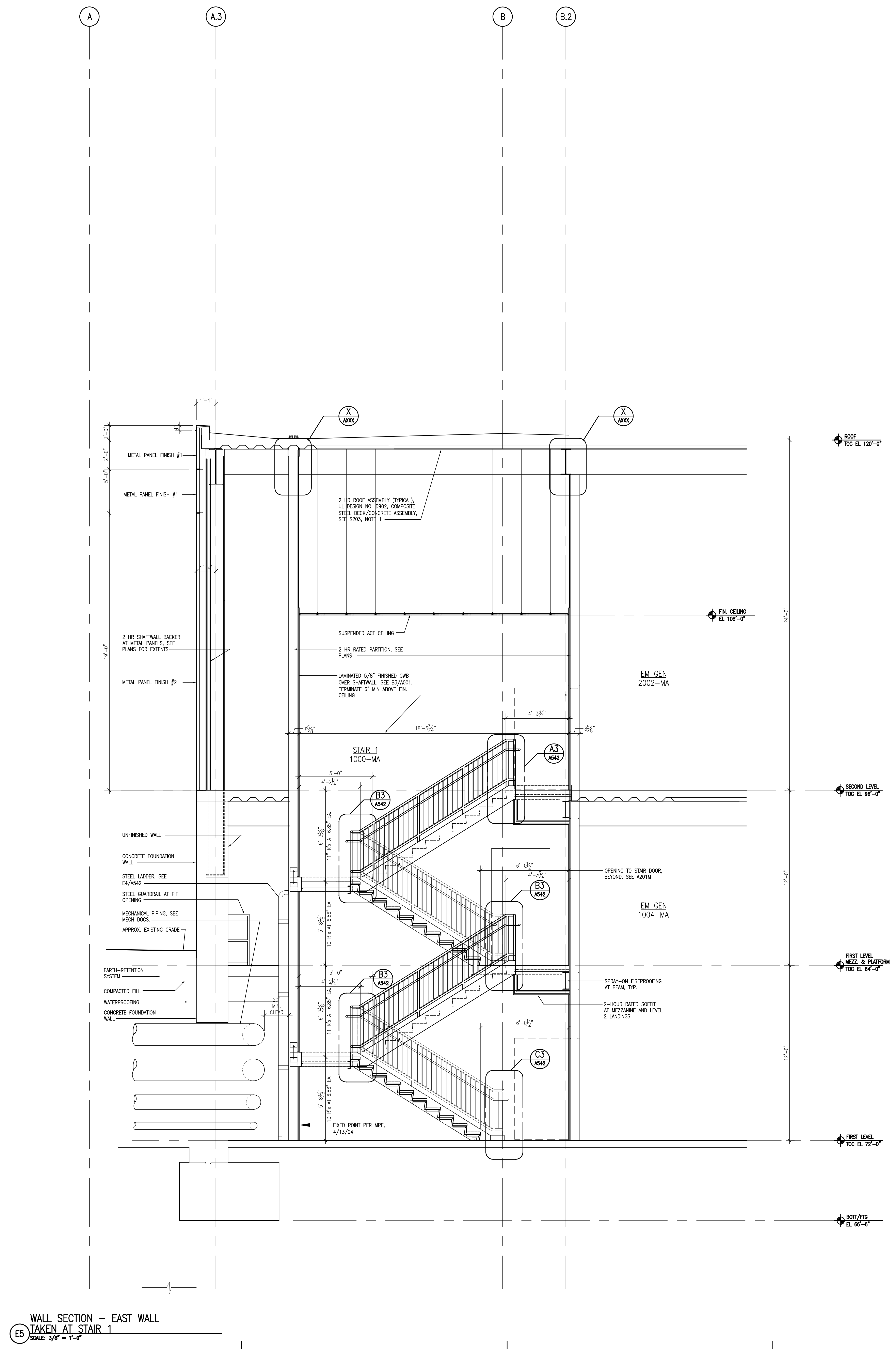

WALL SECTION - EAST WALL
TAKEN AT STAIR 1
SCALE: 3/8" = 1'-0"

FOR PERMIT ONLY
NOT FOR CONSTRUCTION

PERMIT 08/24/04 PERMIT SET - NOT FOR CONSTRUCTION
Issue Log

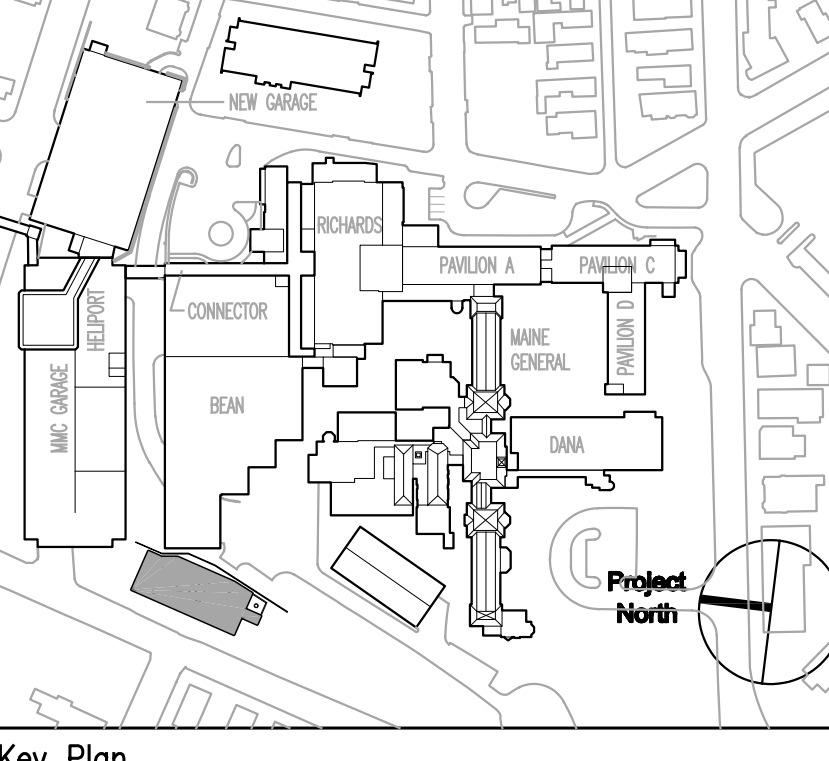

TRO
ARCHITECTURE
PLANNING
ENGINEERING
INTERIOR DESIGN
The Ritchie Organization
80 Bridge Street
Newton, MA 02459-1154
617-550-0400

Maine Medical Center
Central Utility Plant
Portland, Maine

Drawing Title
**WALL SECTIONS
NO. 1**

Commission No.	4677	Date Issued	
Scale	AS NOTED	Sheet Number	
Drawn By	BS		
Approved By	TML		
Filename	4677R500.dwg		
Copyright	© 2004 The Ritchie Organization		

A500