

- General Notes:
1. ALL CEILING HEIGHTS SHALL BE 9'-0" UNLESS OTHERWISE NOTED
  2. ALL SOFFIT HEIGHTS SHALL BE 7'-2" UNLESS OTHERWISE NOTED.
  3. ALL CEILING GRIDS ARE CENTERED IN ROOMS UNLESS NOTED OTHERWISE.
  4. ABBREVIATION  $\frac{1}{2}$  FT.  $\perp$  DEFINES THE USE OF A FULL TILE

**REFLECTED CEILING LEGEND**

-SEE REFLECTED CEILING PLAN FOR CEILING HEIGHTS.

	RECESSED 2'x4' FLUORESCENT LIGHT		EXIT SIGN
	RECESSED 2'x2' FLUORESCENT LIGHT		SPEAKER
	RECESSED PROCEDURE LIGHT FIXTURE		NURSE CALL
	RECESSED 1'x4' FLUORESCENT LIGHT		FIRE ALARM/HORN
	DOWN LIGHT		SMOKE DETECTOR
	SURFACE MOUNTED STRIP LIGHT		HEAT DETECTOR
	DOWN LIGHT (WALL WASHER)		EMERGENCY LIGHTING
	PENDANT LIGHT FIXTURE		SPRINKLER
	PENDANT LIGHT FIXTURE		CEILING MOUNTED PROCEDURE/SURGICAL FIXTURE
	SURFACE MOUNTED FIXTURE		WALL SCONCE
	WALL SCONCE		WALL VALANCE
	TRACK LIGHTING		SURFACE MOUNTED 2'x4' FLUORESCENT LIGHT
	COVE LIGHT FIXTURE		SURFACE MOUNTED 2'x2' FLUORESCENT LIGHT
	PERIMETER SLOT LIGHT		SURFACE MOUNTED 1'x4' FLUORESCENT LIGHT
	WALL SURFACE MOUNTED FIXTURE		
	CEILING HEIGHT SYMBOL		
	2'x2' ACOUSTIC TILE		2'x4' ACOUSTIC TILE
	GYPNUM WALLBOARD CEILING OR SOFFIT		
	2'x2' WOOD VENEER CEILING TILE		
	METAL PANEL (MP-1A)		
	METAL PANEL (MP-1B)		
	PERFORATED ACOUSTIC METAL CEILING		
	MECHANICAL SUPPLY DIFFUSER		
	MECHANICAL RETURN REGISTER		
	MECHANICAL EXHAUST		
	RADIANT HEAT PANEL		
	MECHANICAL LINEAR DIFFUSER/RETURN		
	ACCESS PANEL		
	CURTAIN TRACK		
	M TRACK		

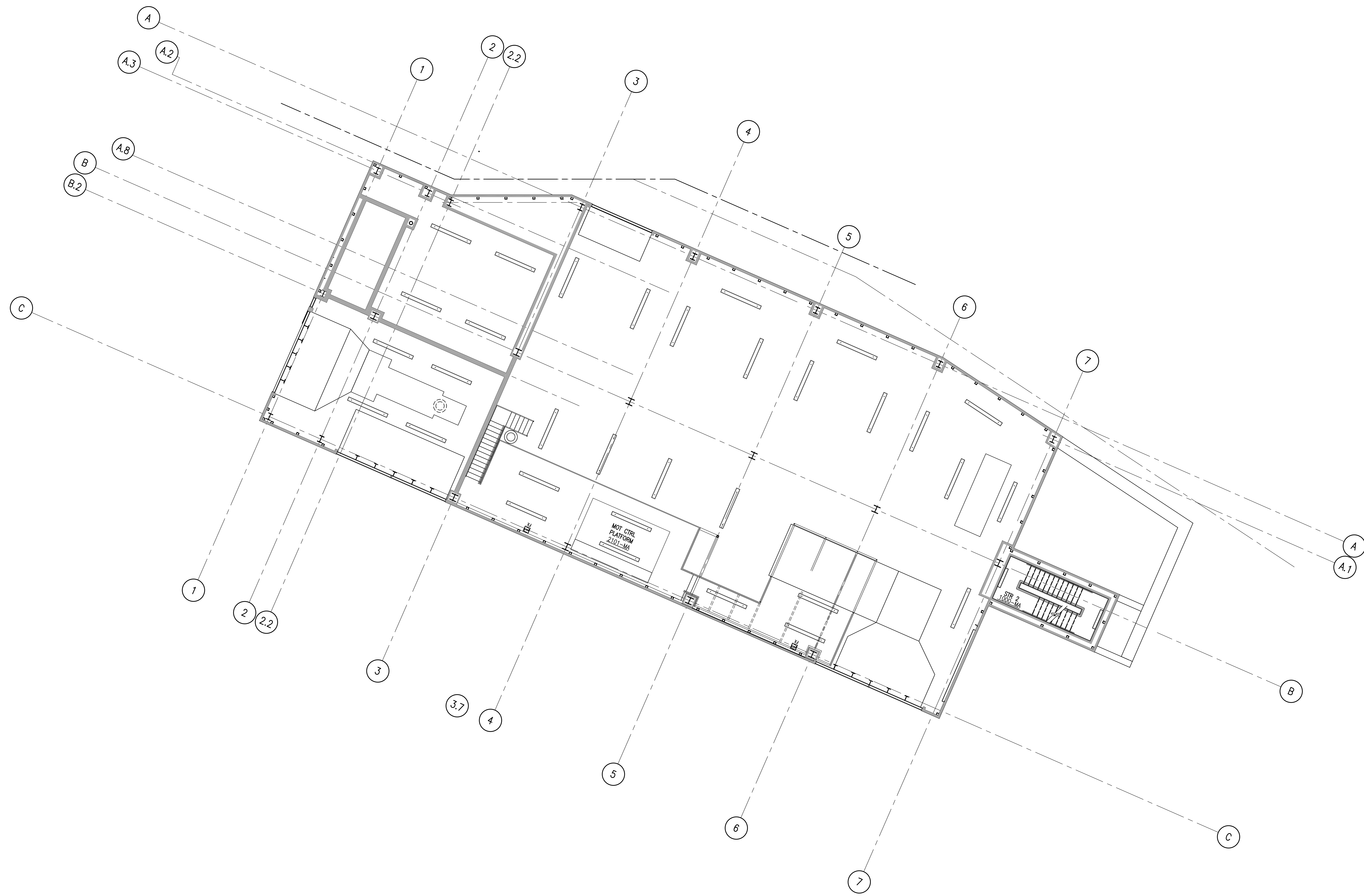

FOR PERMIT ONLY  
NOT FOR CONSTRUCTION

PERMIT 08/24/04 PERMIT SET - NOT FOR CONSTRUCTION  
Issue Log

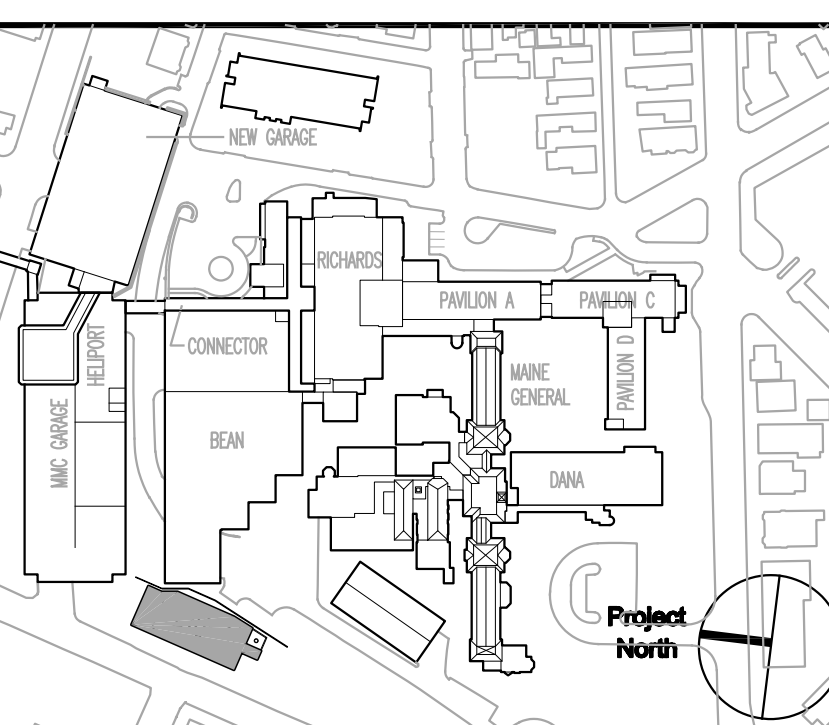

Key Plan

**TRO**  
ARCHITECTURE  
PLANNING  
ENGINEERING  
INTERIOR DESIGN

The Ritchie Organization  
80 Bridge Street  
Newton, MA 02459-1104  
617-552-0400

**Maine Medical Center**  
Central Utility Plant  
Portland, Maine

Drawing Title  
**SECOND LEVEL PLATFORM  
REFLECTED CEILING PLAN**

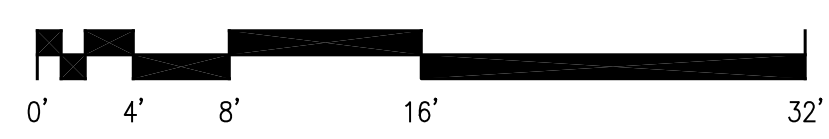

Commission No.	4677	Date Issued	
Scale	1/8" = 1'-0"	Sheet Number	
Drawn By		Approved By	
Checked By		File Name	4677A302-M.dwg
Copyright © 2004	The Ritchie Organization		

**A302.P**