

B4 ROOF PLAN
SCALE: 1/8" = 1'-0"

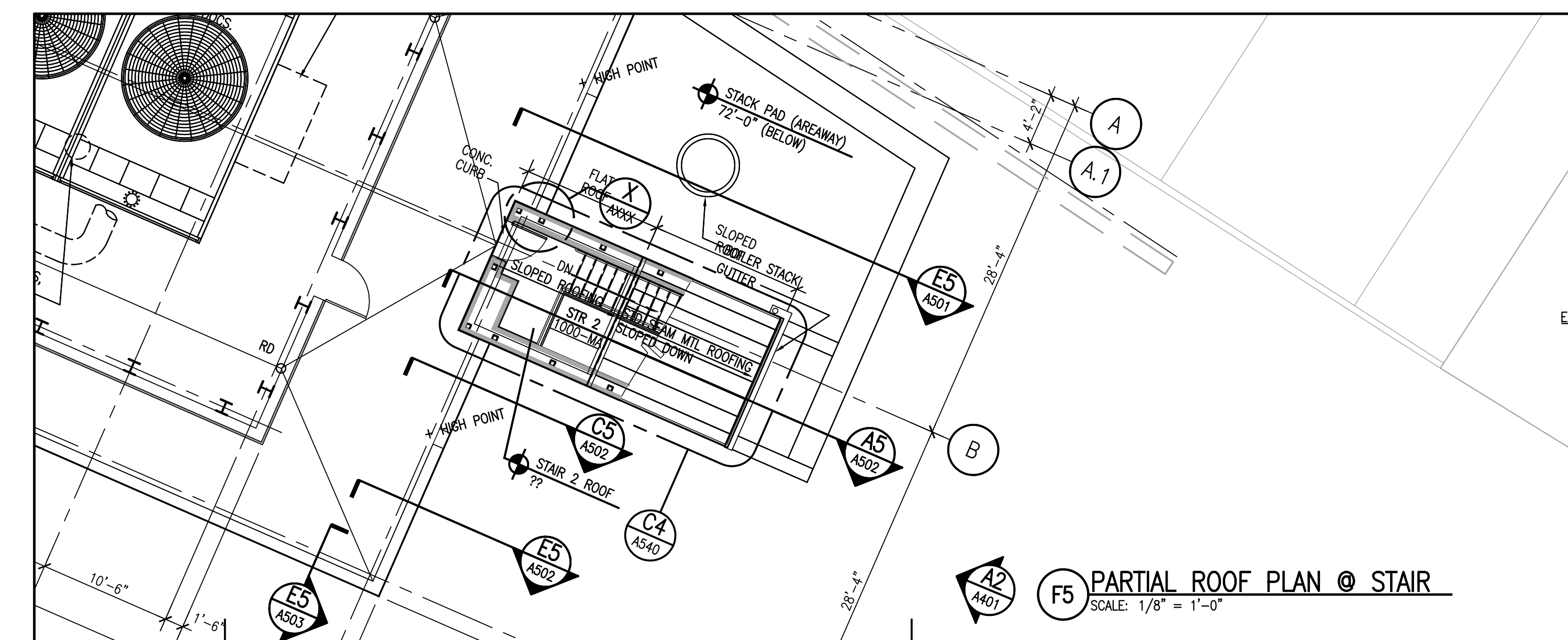

F5 PARTIAL ROOF PLAN @ STAIR
SCALE: 1/8" = 1'-0"

FOR PERMIT ONLY
NOT FOR CONSTRUCTION

PERMIT 08/24/04 PERMIT SET - NOT FOR CONSTRUCTION
Issue Log

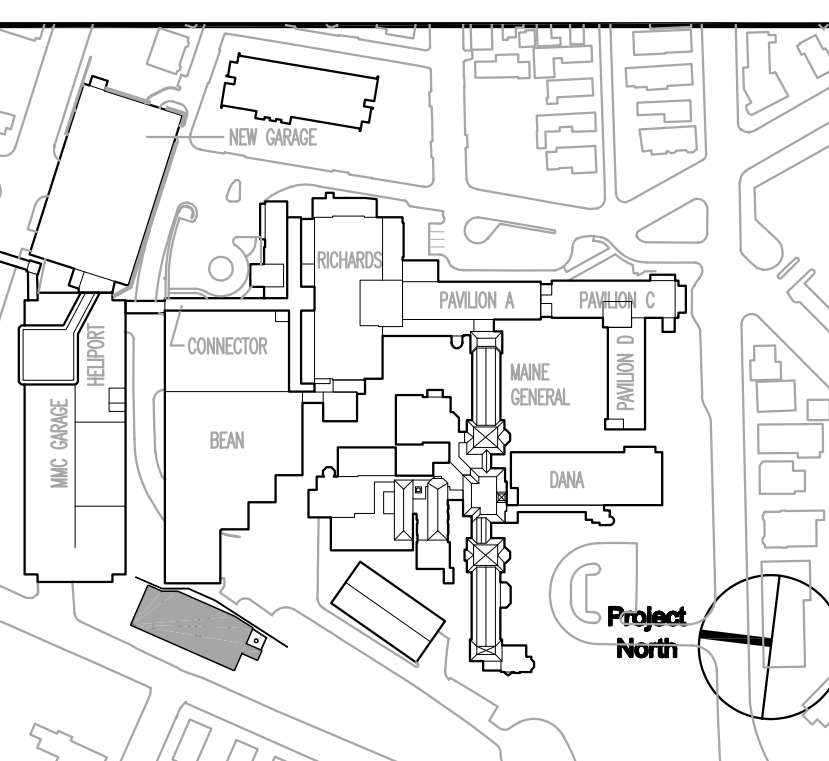

Key Plan

TRO
ARCHITECTURE
PLANNING
ENGINEERING
INTERIOR DESIGN

The Ritchie Organization
80 Bridge Street
Newton, MA 02459-1154
617-552-0400

Maine Medical Center
Central Utility Plant
Portland, Maine

Drawing Title
**ROOF PLAN AND
PARTIAL ROOF STAIR PLAN**

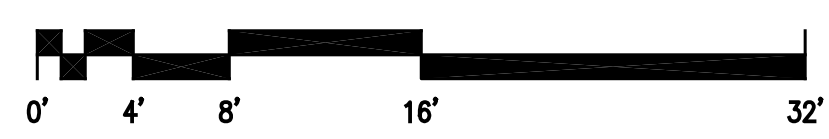

Commission No.	4677	Date Issued	
Scale	1/8" = 1'-0"	Sheet Number	
Drawn By	LR		
Approved By	JML		
Filename	4677A20R.dwg		
Copyright	© 2004 The Ritchie Organization		

A20R