

3 Tile Detail at Mop Basin
3" = 1'-0"

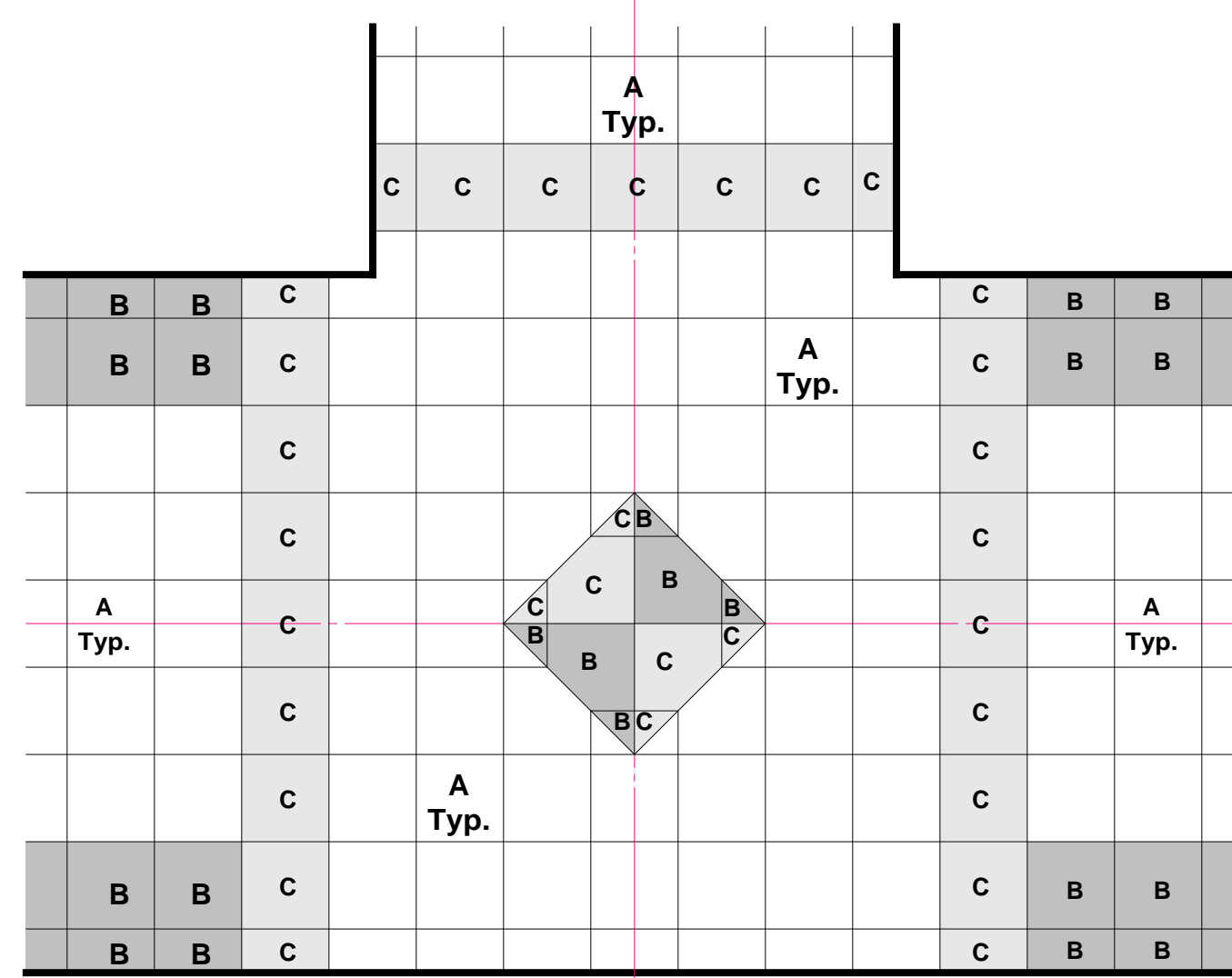

Feature Tile Group 1

1 Partial Flooring Plan
1/2" = 1'-0"

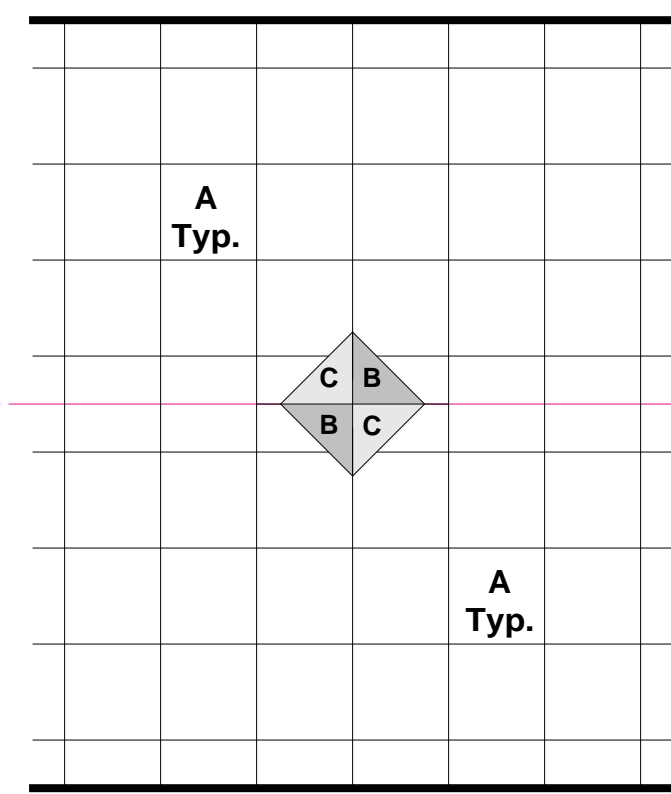

Feature Tile Group 2

2 Partial Flooring Work @ Rm. #5130
1/2" = 1'-0"

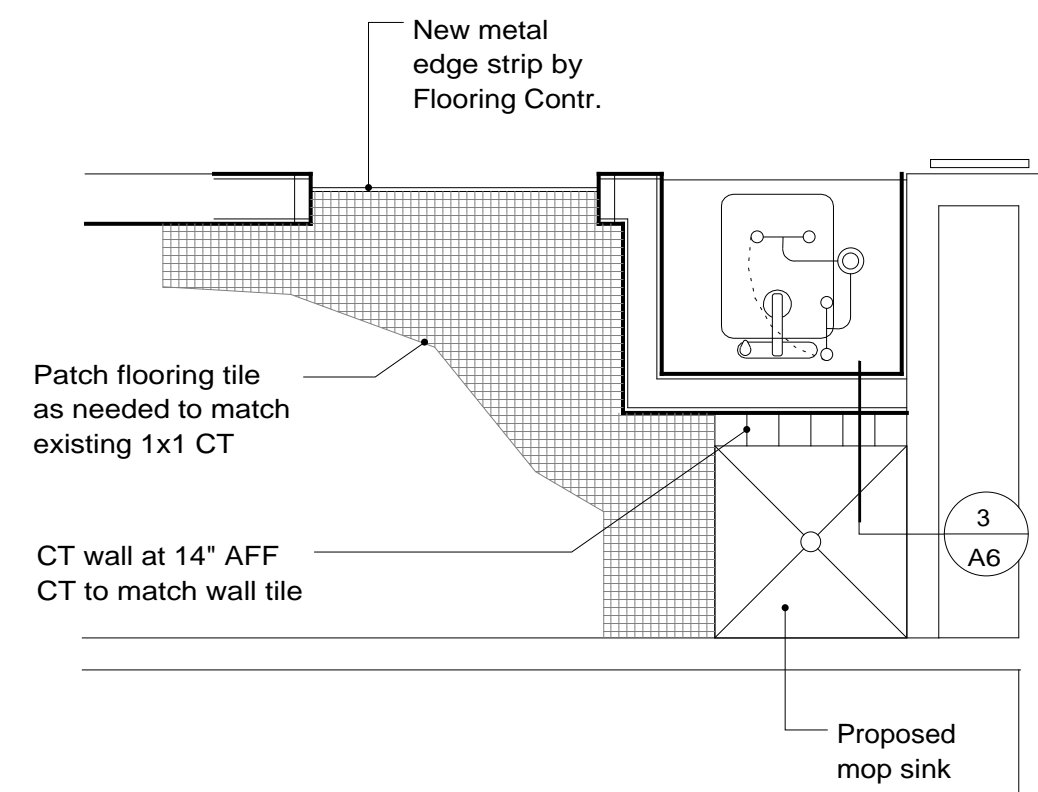

T1 VCT / CPT Transition Strip
6" = 1'-0"

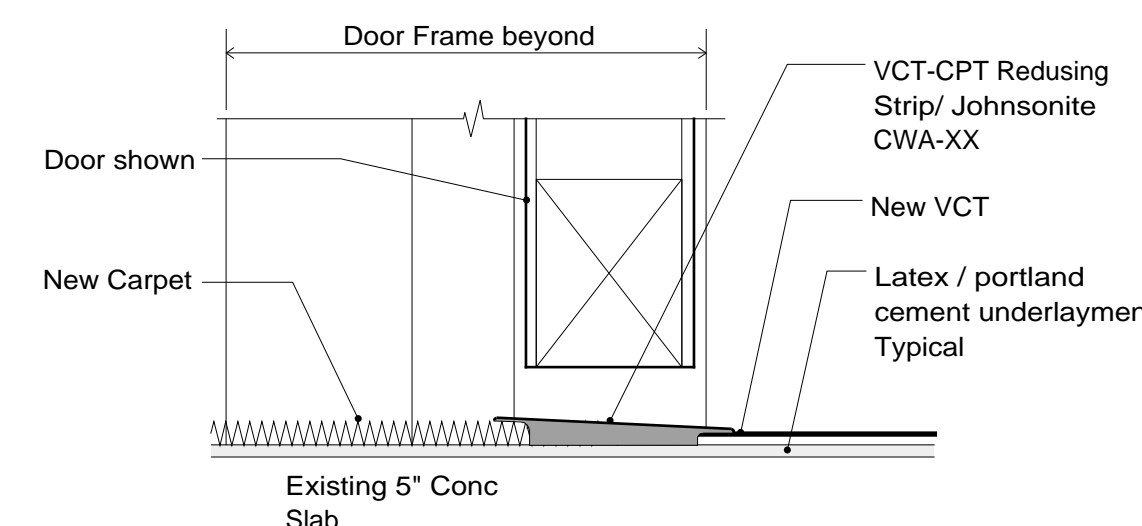

T2 VCT / CT Transition Strip
6" = 1'-0"

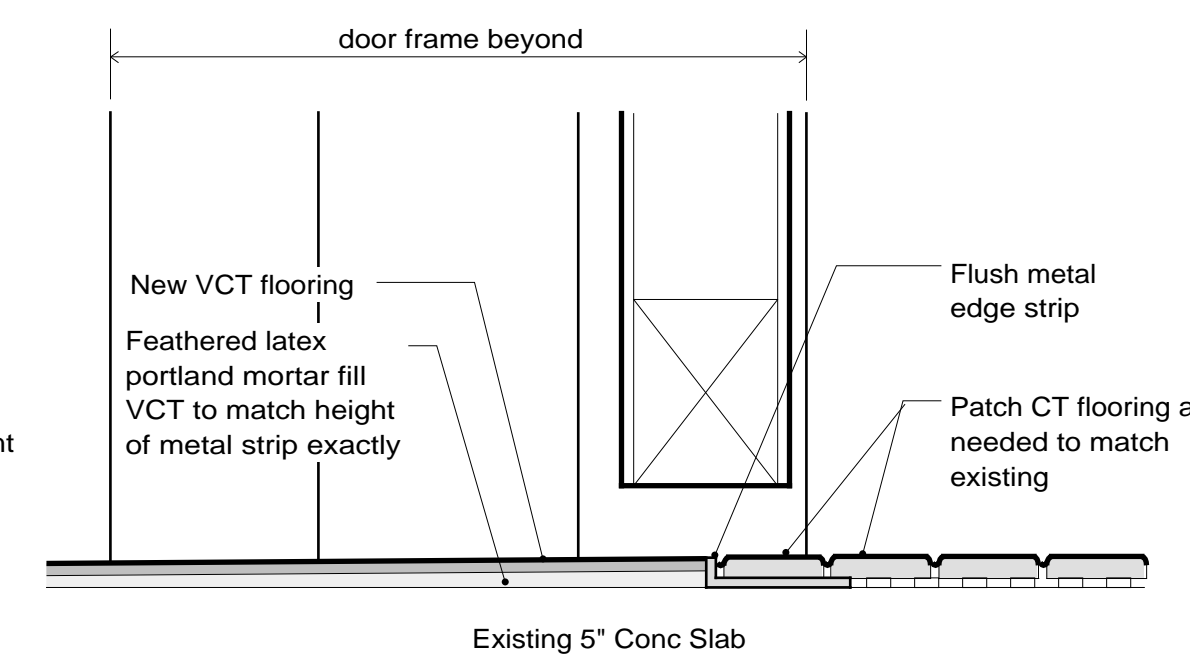

Note: Provide 1/8" thick latex modified portland cement underlayment at all areas to receive new flooring. Feather to 0" thickness as required for transitions.

Existing VAT and carpet will be removed under separate contract before start of construction. Grind floor as required to remove any remaining debris and wet vac clean before installing underlayment.

Flooring Key

- (A) Proposed VCT Field Color
- (B) Proposed VCT Accent Color
- (C) Proposed VCT Accent Color
- (D) Proposed Carpet
- ① Feature Tile Group 1
- ② Feature Tile Group 2

**Richards Wing
Fifth Floor**

Renovations

Maine Medical Center
Portland, Maine 04102

Architect
Winton Scott Architects, PA
Portland, Maine

Mechanical Engineering
Mechanical Systems
Engineers
Yarmouth, Maine

Electrical Engineering
Bartlett Design
Bath, Maine

**Flooring Plan
A 6**

Scale: 1/8" = 1' - 0"
April 10, 2002