

1 Locker Room # 5099
West Elevation
1/4" = 1'-0"

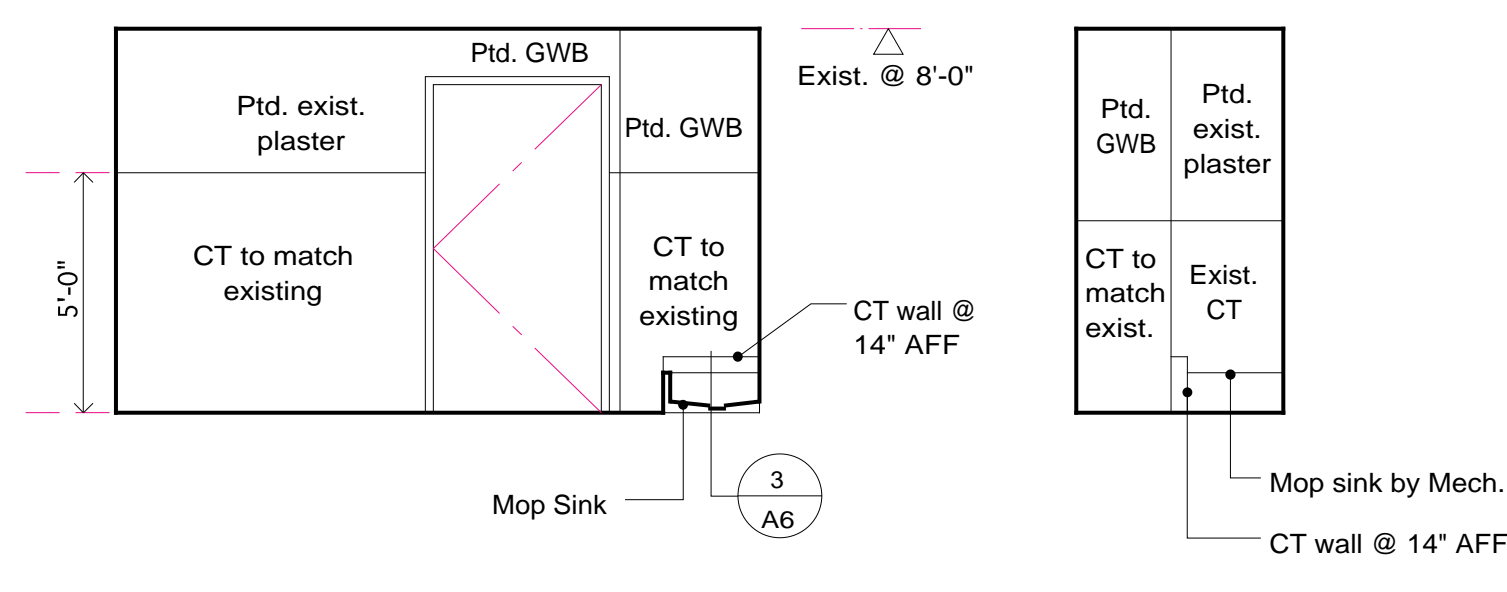

2 Envir. Services #5130
North Elevation
1/4" = 1'-0"

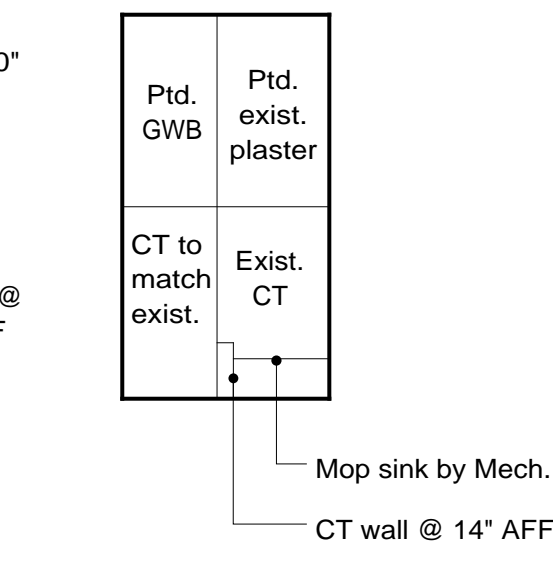

3 Rm. #5130
East Elevation
1/4" = 1'-0"

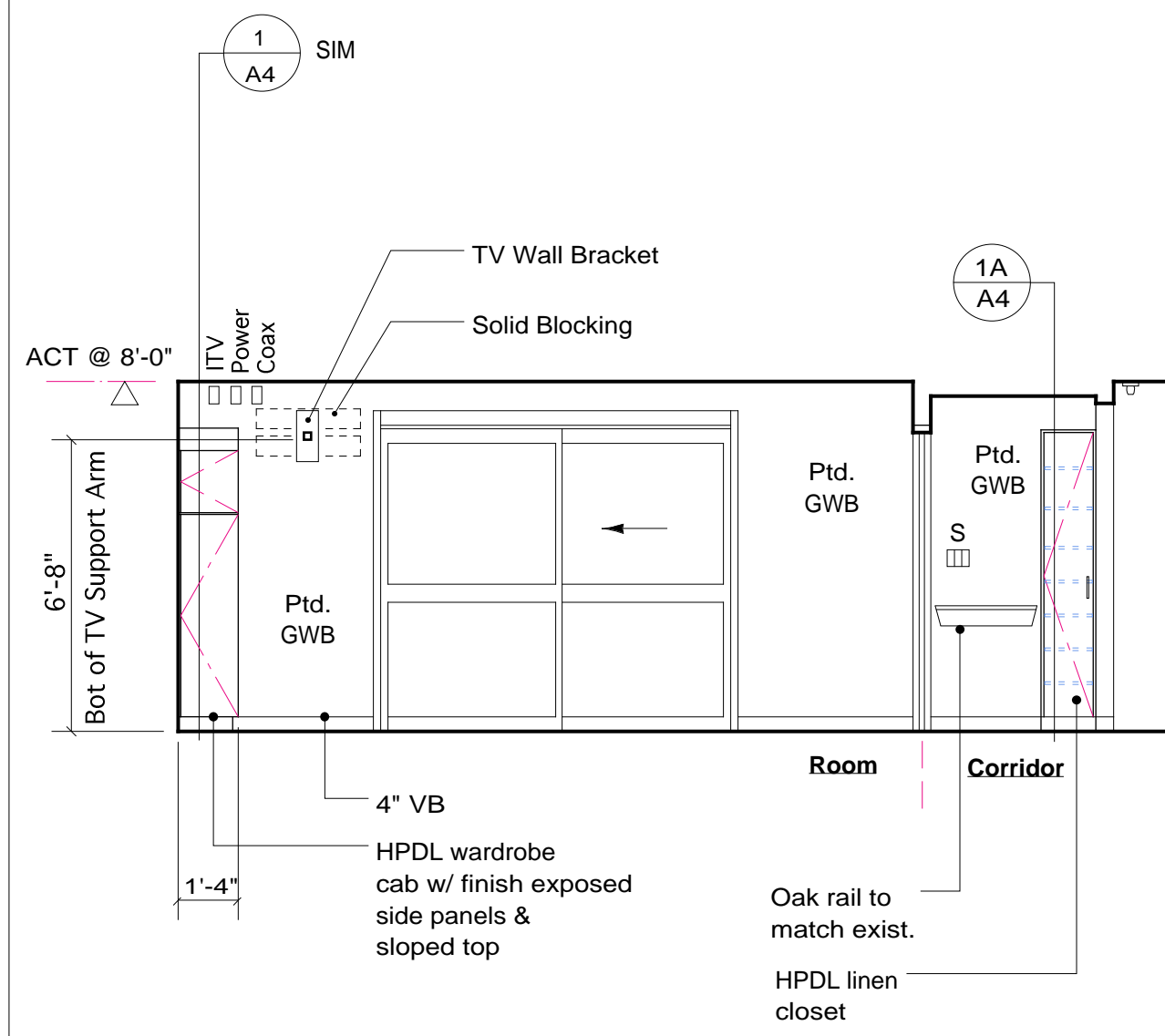

4 Intermed. Care #508
East Elevation
1/4" = 1'-0"

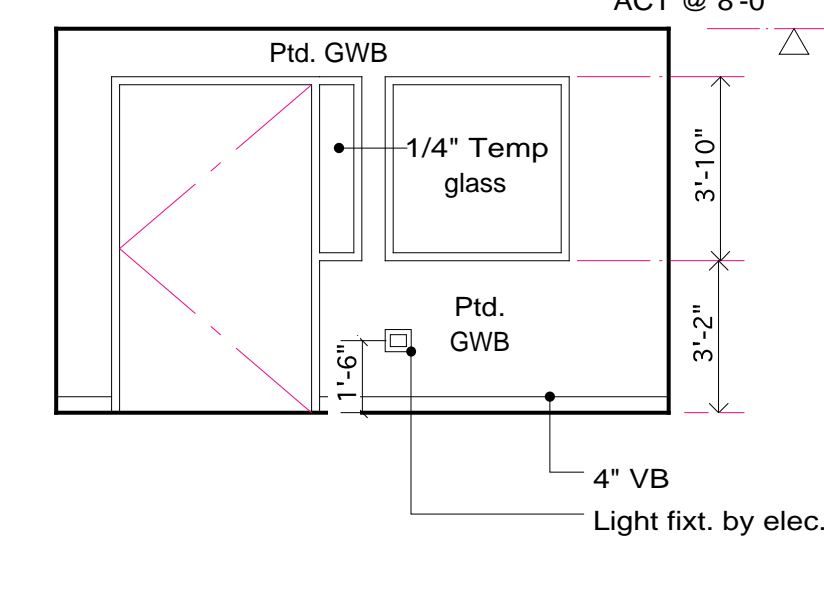

5 Intermed. Care #508
South Elevation
1/4" = 1'-0"

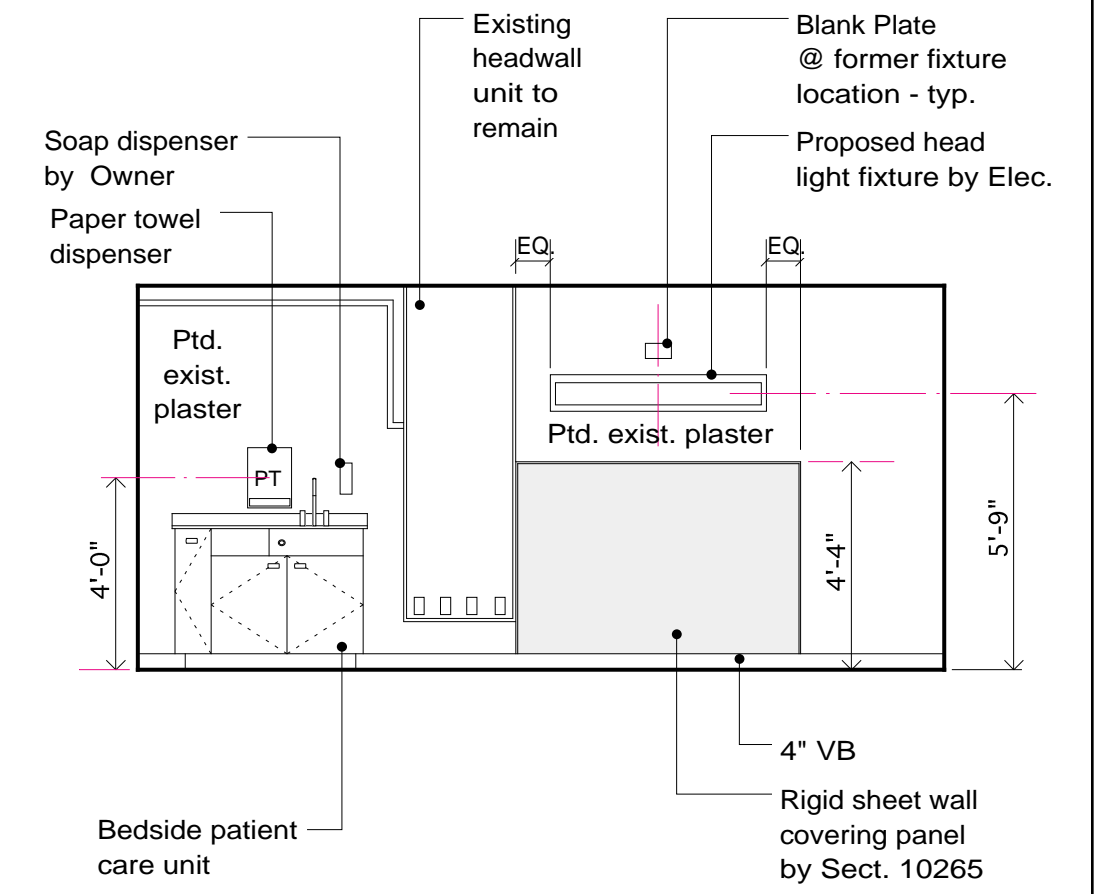

6 Intermed. Care #508
West Elevation
1/4" = 1'-0"

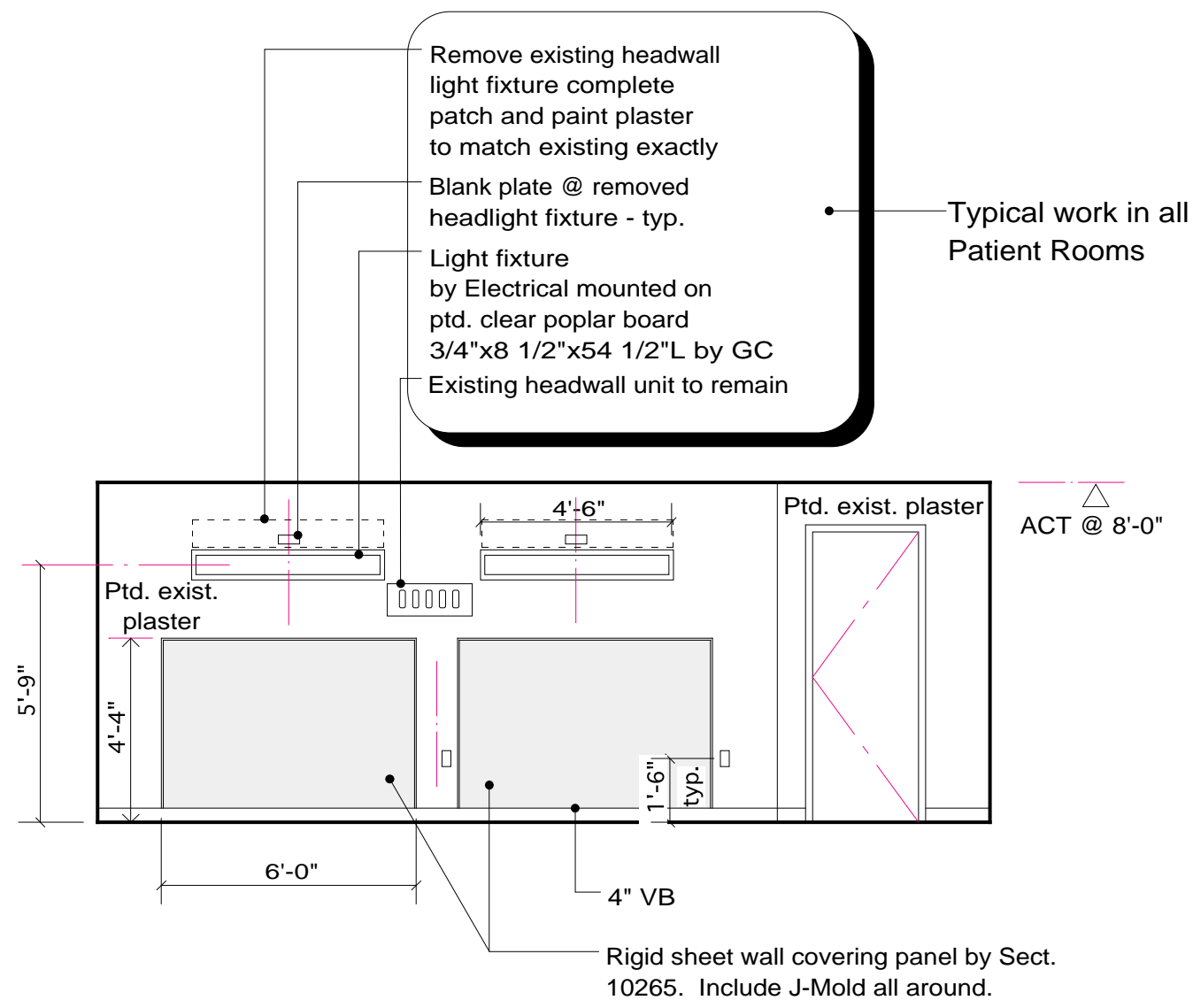

7 Proced. & Evaluation #507
East Elevation
1/4" = 1'-0"

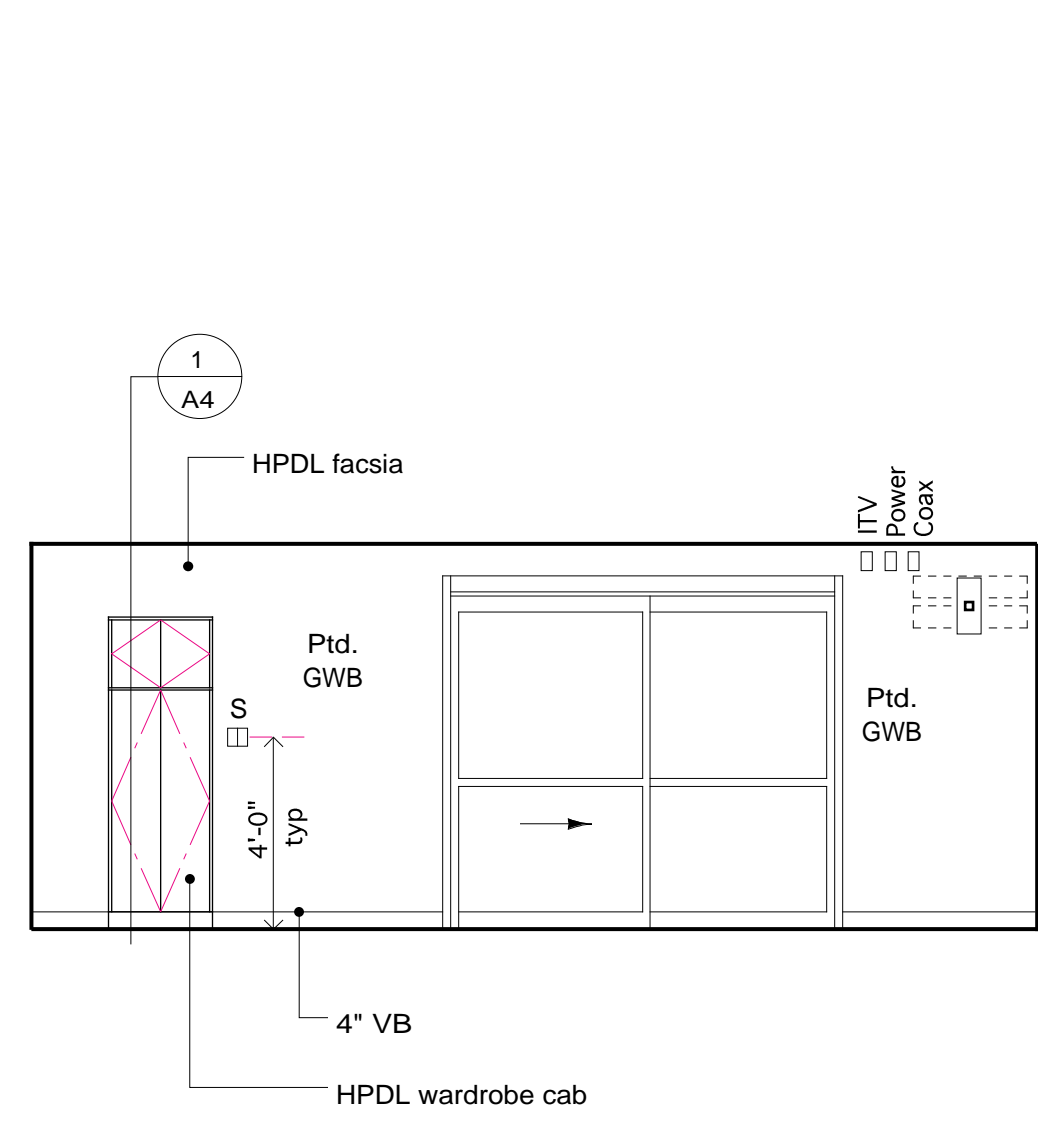

8 Proced. & Evaluation #507
West Elevation
1/4" = 1'-0"

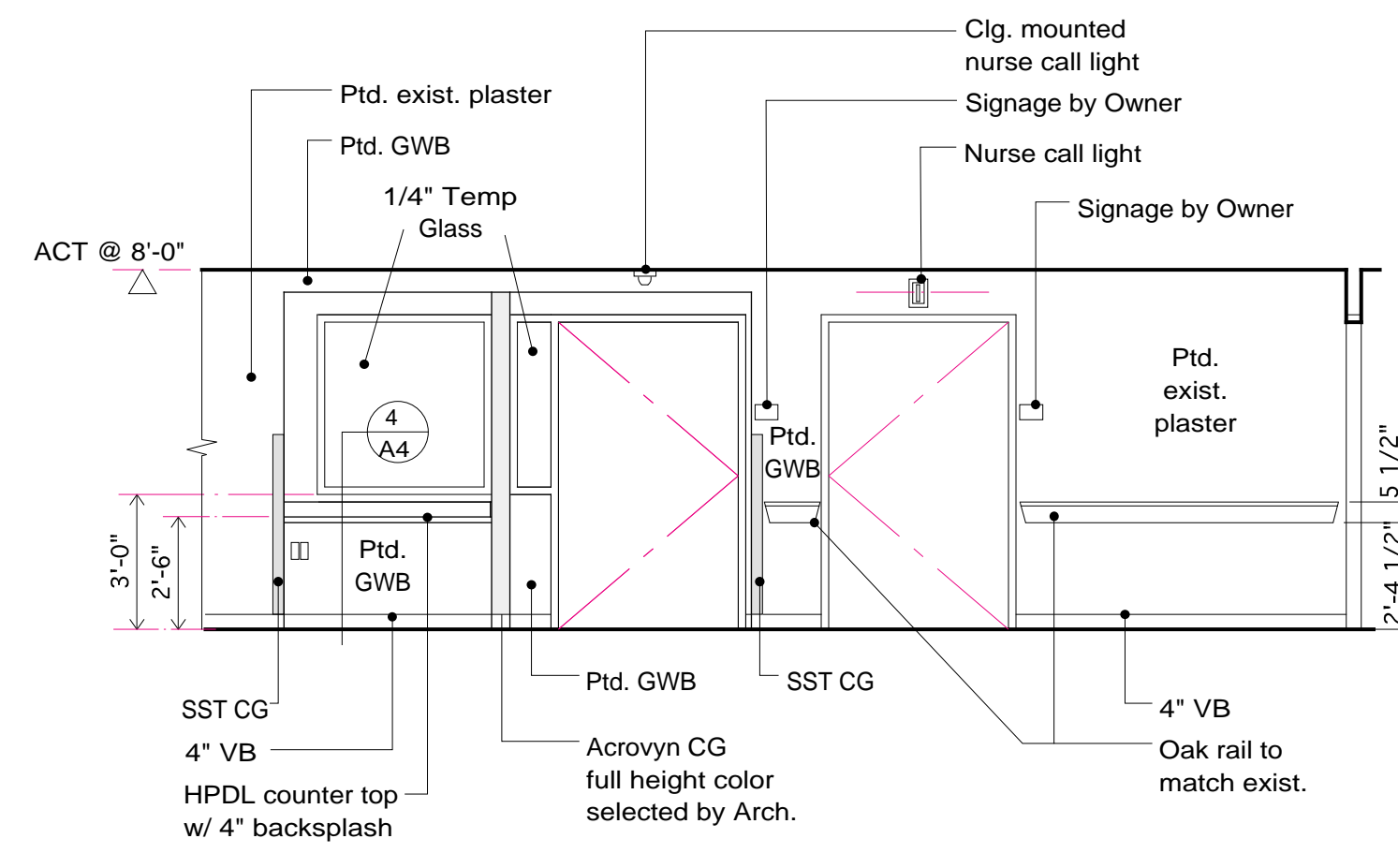

9 Corridor # DC-R503
North Partial Elevation
1/4" = 1'-0"

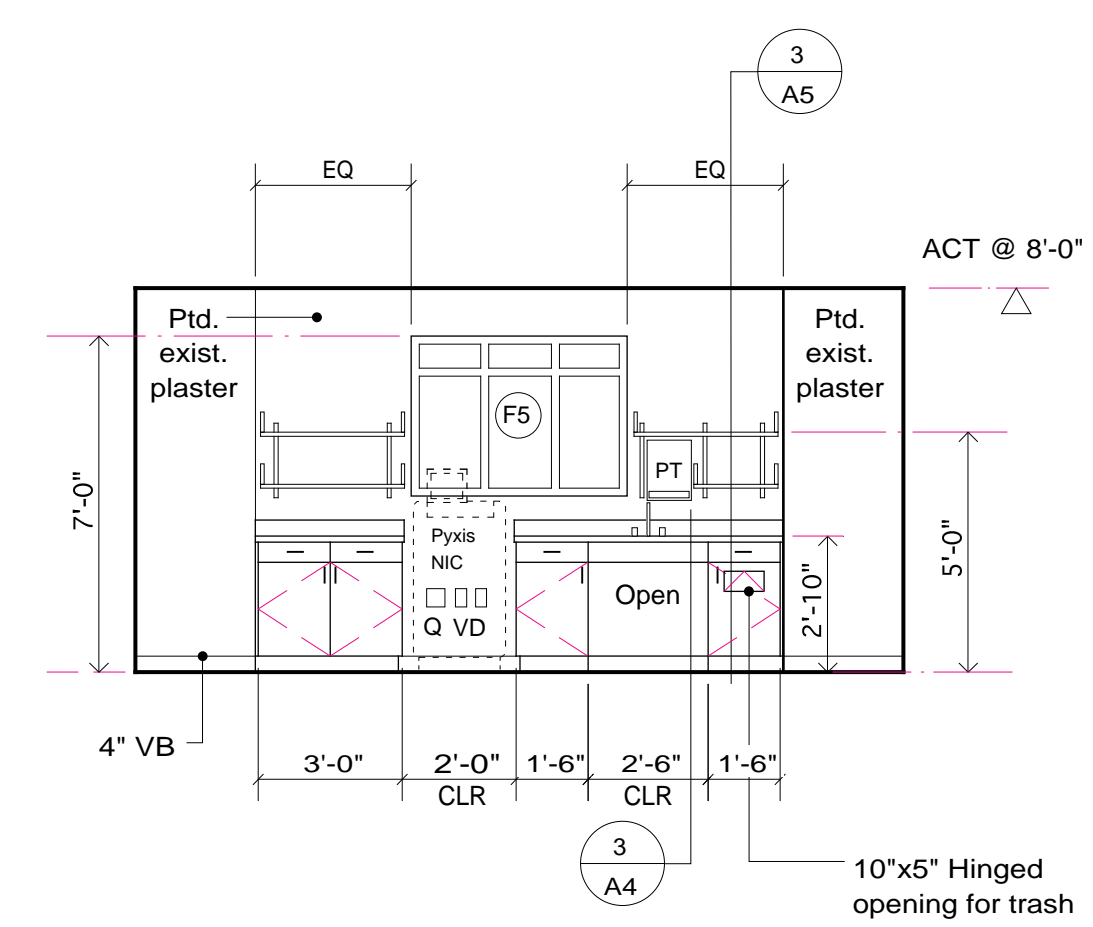

10 Medication Room #5108
East Elevation
1/4" = 1'-0"

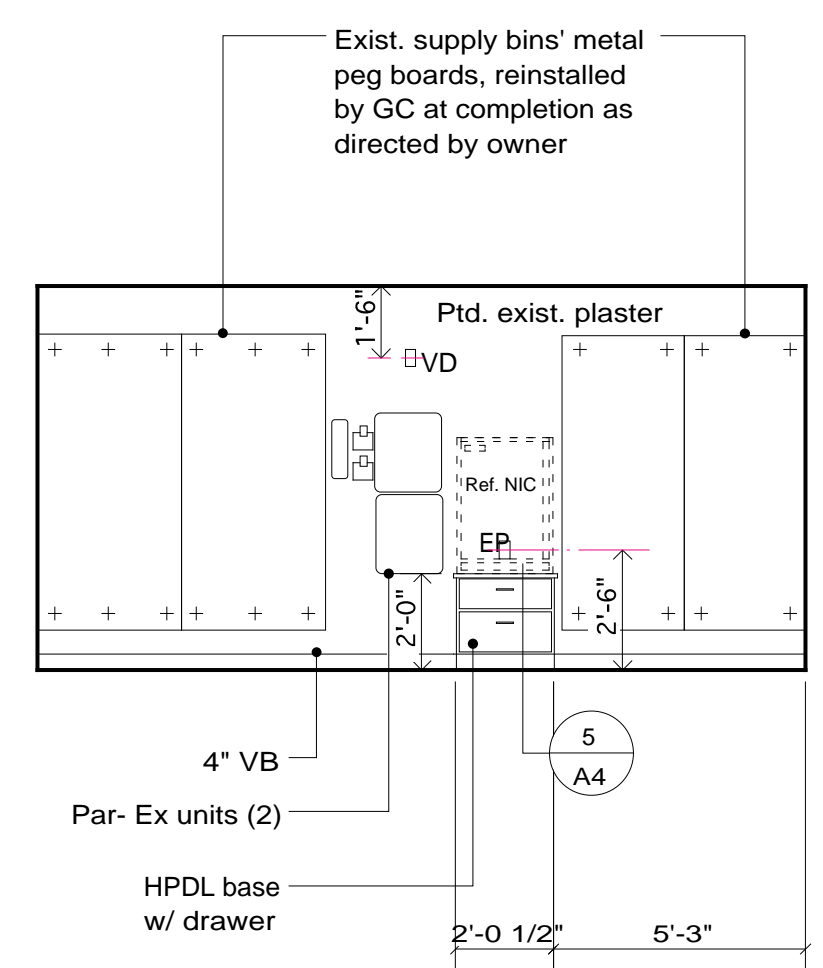

11 Medication Room #5108
West Elevation
1/4" = 1'-0"

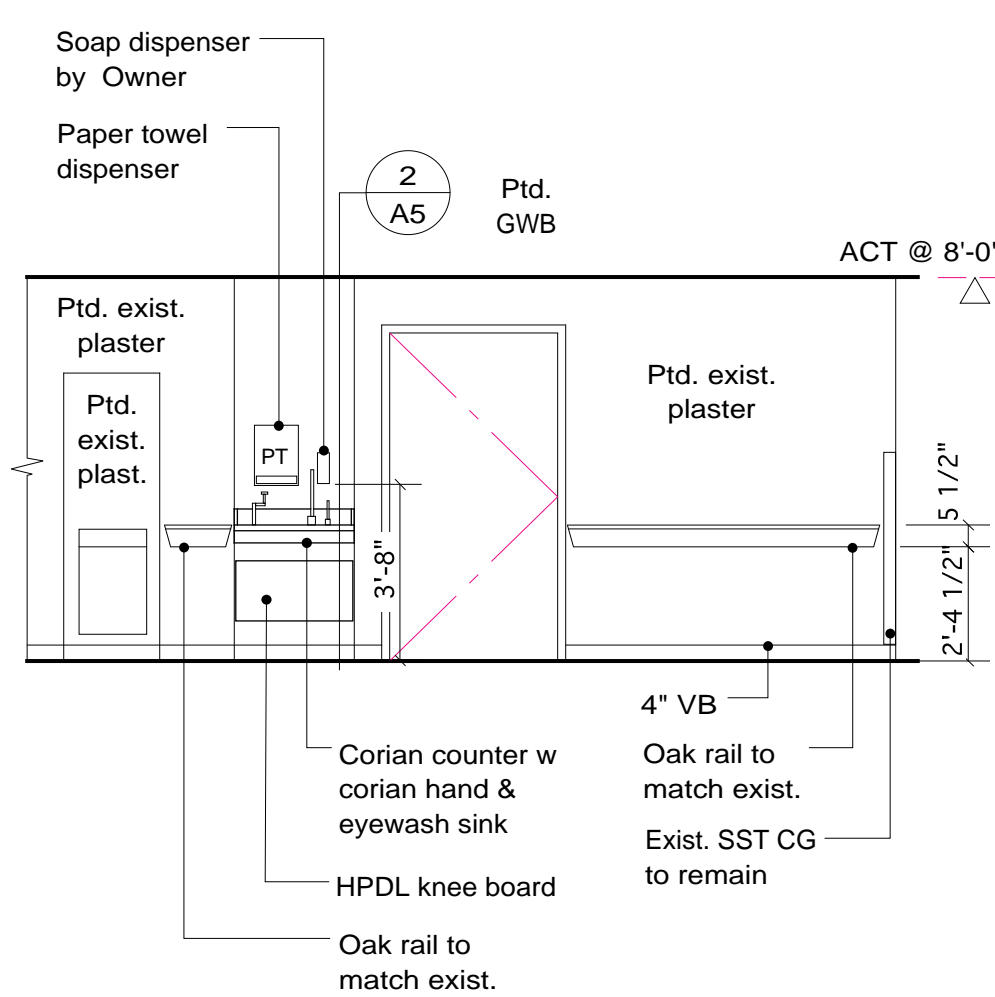

12 Corridor #DC-R503
South Partial Elevation
1/4" = 1'-0"

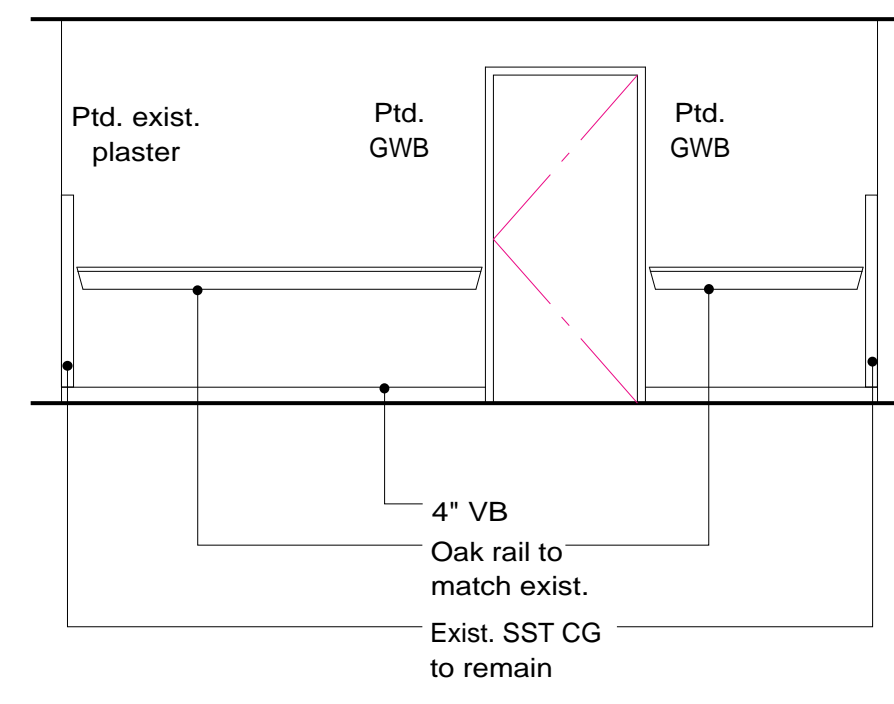

13 Corridor #DC-R505
West Elevation
1/4" = 1'-0"

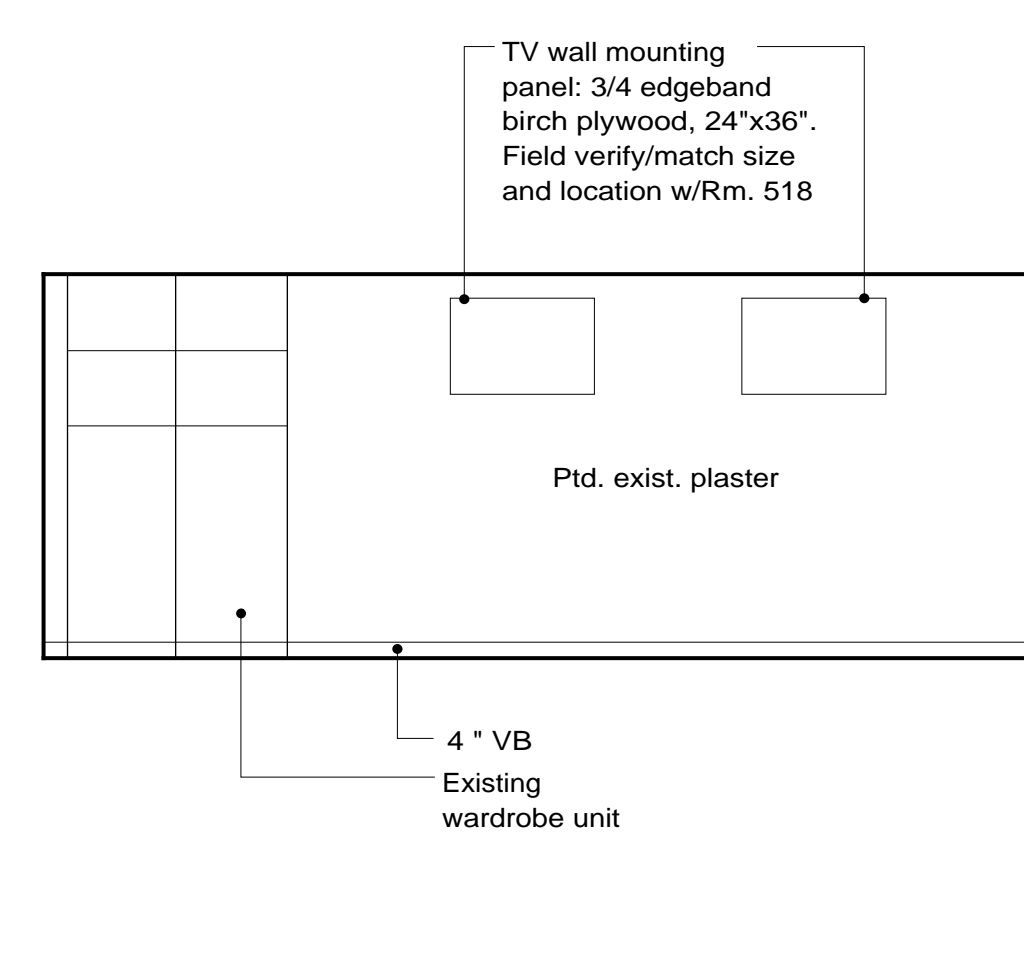

14 Patient Room #517
East Elevation
1/4" = 1'-0"

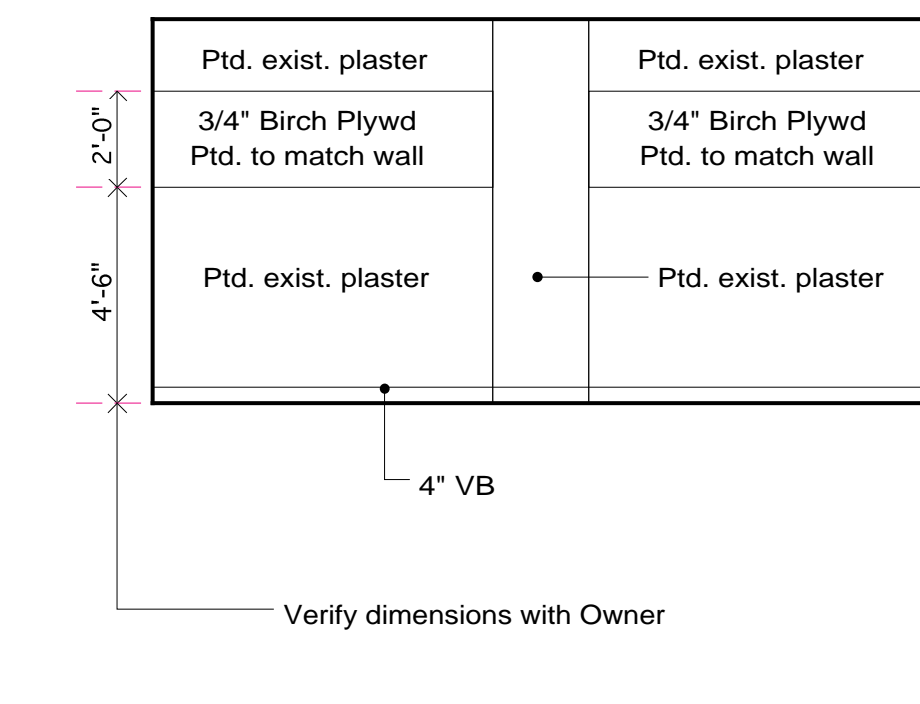

15 Charting Room #5137
East Elevation
1/4" = 1'-0"

Richards Wing
Fifth Floor
Renovations

Maine Medical Center
Portland, Maine 04102

Architect
Winton Scott Architects, PA
Portland, Maine

Mechanical Engineering
Mechanical Systems Engineers
Yarmouth, Maine

Electrical Engineering
Bartlett Design
Bath, Maine

Interior Elevations
A 3

Scale: 1/4" = 1'-0"
April 10, 2002