

A Alternate Reflected Ceiling Plan
1/8" = 1'-0"

Refer To Section 01230 - Alternates #3, 4 and 5

- Notes**
1. Provide ACT Type C at areas shown under Alternate #3. For other areas see Finish Schedule and Drawing A7 for base bid work.
 2. Provide light fixtures shown under Alternate #4. Provide supply air grilles shown under Alternate #5.
 3. Sprinkler heads shown shall be provided under separate contract to the Owner. Coordinate work with this contractor.

- Legend**
- Sprinkler Head (By Separate Contract)
 - ☒ Supply Air Grille
 - Ⓢ Smoke Detector - Remove and reinstall existing unit
 - Ⓟ Paging System Speaker - Remove and reinstall existing unit
 - Recessed Fluorescent Light Fixture
 - Ⓞ Wireless Network Access Device (Removal and Replacement by Owner)
 - ⊙ Exit Sign - Remove and reinstall existing unit
 - ⊕ Telemetry System Antenna - Remove and reinstall existing unit
 - ⊠ Temp Sensor - Remove and reinstall existing unit

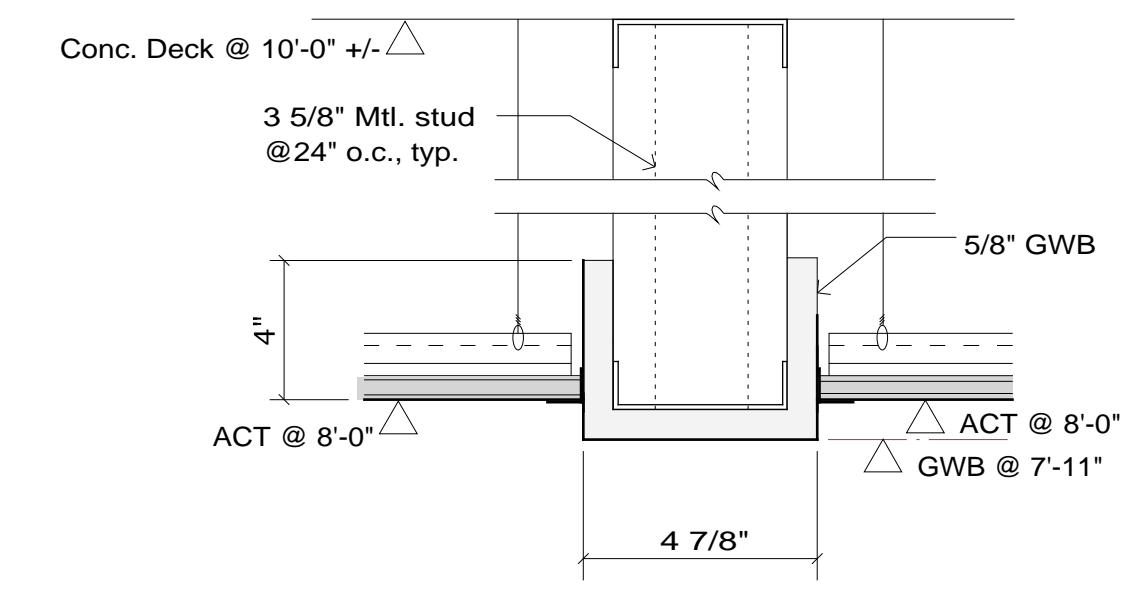

1 Soffit Detail
3" = 1'-0"

Richards Wing
Fifth Floor
Renovations

Maine Medical Center
Portland, Maine 04102

Architect
Winton Scott Architects
Portland, Maine

Mechanical Engineering
Mechanical Systems Engineers
Yarmouth, Maine

Electrical Engineering
Bartlett Design
Bath, Maine

Alternate
Reflected
Ceiling Plan

A 11

Scale: 1/8" = 1'-0"
April 10, 2002