

- GENERAL DEMOLITION NOTES:**
1. VERIFY SUBJECT ROOMS PER WPI. DIMENSIONS OF UNIDENTIFIED OBJECTS THAT WILL BE REMOVED.
  2. OBSERVANT EFFECT OF DEMOLITION AND LOCATIONS OF PARTITIONS DESCRIBED ON PLANS AND WITH LOCATIONS OF FINISHES NOTED AS EXISTING TO REMAIN.
  3. ANY WALL, PARTITION OR SURFACE DISTURBED BECAUSE OF NEW WORK OR DEMOLITION SHALL BE PATCHED AND FINISHED CONSISTENTLY TO EXISTING FINISHES UNLESS NOTED OTHERWISE. CONTINUITY AND FIRE RATINGS UNLESS NOTED OTHERWISE.
  4. PROTECT ALL FINISHES, MATERIALS AND EQUIPMENT NOTED AS EXISTING TO REMAIN. CONTRACTOR SHALL BE RESPONSIBLE TO REPLACE ALL FINISHES, MATERIALS AND EQUIPMENT DAMAGED DURING CONSTRUCTION.
  5. CLEARLY IDENTIFY & TAG MECHANICAL, PLUMBING/ELECTRICAL AND OTHER SYSTEMS TO BE REMOVED OR IN USE PRIOR TO DEMOLITION TO AVOID ACCIDENTAL REMOVAL.
  6. SEE M.E.P. DRAWINGS FOR THE SCOPE OF DEMOLITION IN THOSE DISCIPLINES.
  7. FOR FINISHES OF CEILING, CORE, REPAIRS AND ADJUSTMENTS REFER TO REFLECTED CEILING PLANS.
  8. DIMENSIONS AND MATERIALS ARE EXISTING CONDITION DIMENSIONS TO BE VERIFIED IN FIELD.
- DEMOLITION KEY NOTES:**
- 1) REMOVE PARTITION COMPLETE.
  - 2) REMOVE EXISTING CASEWORK/LOCKERS COMPLETE.
  - 3) REMOVE DOOR, FRAME & HARDWARE COMPLETE AND CO-ORDINATE WITH OWNER THOSE ITEMS TO BE SALVAGED PRIOR TO REMOVAL.
  - 4) REMOVE PLUMBING FIXTURE, CAP FLUSH WITH EXISTING WALL OR FLOOR, COORDINATE WITH OWNER THOSE ITEMS TO BE SALVAGED PRIOR TO REMOVAL.
  - 5) REMOVE EXISTING FLOORING SYSTEM COMPLETE. PREPARE FOR NEW FLOORING SYSTEM.
  - 6) REMOVE PORTION OF PARTITION (INTERIOR OR EXTERIOR) FOR INSTALLATION OF DOOR OR WINDOW. COORDINATE EXTENTS WITH FINISHES TO REMAIN. REFERENCE DOOR SCHEDULE OR WINDOW ELEVATION.
  - 7) REMOVE EXISTING FIXTURE, REFERENCE MECHANICAL/ELECTRICAL.
  - 8) EXISTING CEILING SYSTEM TO BE REMOVED & REPLACED TO ALLOW MECHANICAL WORK TO BE PERFORMED.
  - 9) REMOVE EXISTING WALL FURRING. REMOVE ALL FASTENERS, TRACKS Wires ETC.
  - 10) REMOVE EXISTING WINDOW COMPLETE. PREPARE FOR OMB WALL.
  - 11) REMOVE WOOD BUMPER GUARDS.
  - 12) REMOVE FINISH FLOOR MATERIAL (IF ANY) & BASE. PREPARE SURFACE FOR NEW FINISHES AS REQUIRED BY SCHEDULE & SPECS.
  - 13) REMOVE CEILING ASSEMBLY COMPLETE. COORDINATE EXTENTS OF REMOVAL WITH PARTITION LOCATIONS AND EXISTING FINISHES TO REMAIN.
  - 14) REMOVE CEILING MOUNTED CURTAIN TRACK & CURTAIN TRUCKS Wires ETC.
  - 15) PREPARE EXISTING WINDOW COMPLETE PREPARE FOR OMB INFILL.
  - 16) REMOVE EXISTING FURNITURE PARTITIONS.

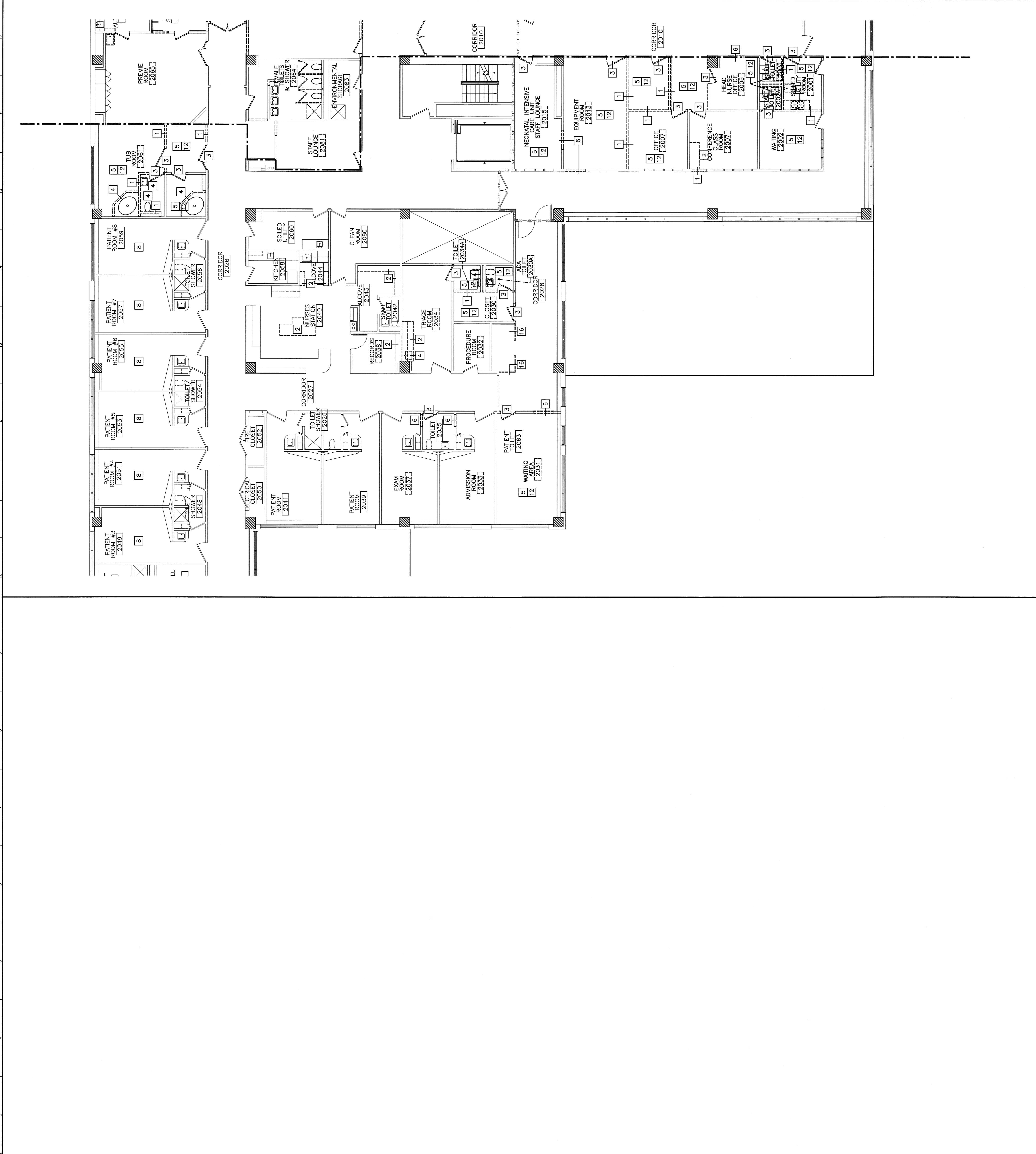

ISSUED FOR CONSTRUCTION	9-12-08
DESCRIPTION	DATE
REV.	DATE
0	9-12-08

CURRENT ISSUE STATUS:

**ISSUED FOR CONSTRUCTION**  
9-12-08

ARCHITECTURE  
ENGINEERING  
PLANNING  
INTERIOR DESIGN  
COMMISSIONING

**SMRT**  
MAINE MEDICAL CENTER - L.L. BEAN WING 2ND FLOOR  
INPATIENT SERVICES  
PORTLAND, MAINE

144 Fore Street, P.O. Box 618  
Portland, Maine 04104  
Tel: (207) 725-2886  
Fax: (207) 725-2887  
www.smrtinc.com

ARCHITECTURE  
ENGINEERING  
PLANNING  
INTERIOR DESIGN  
COMMISSIONING

CHRIS DAVID ARCHITECTS  
INC.  
100-2502  
144 FORE STREET  
PORTLAND, ME 04104

ARCHITECTURE  
ENGINEERING  
PLANNING  
INTERIOR DESIGN  
COMMISSIONING

144 Fore Street, P.O. Box 618  
Portland, Maine 04104  
Tel: (207) 725-2886  
Fax: (207) 725-2887  
www.smrtinc.com

DEMOLITION PLAN	
SHEET TITLE	DATE
SCALE	GRAPHIC SCALE
PROJECT NUMBER	CDP
DWG. CAPTION	MR
DATE OF RECORD	CDP
SMRT CAD FILE	AD101-08099
PROJECT No.	08099
SHEET No. AD101	

A1	*	DEMOLITION PLAN	1/8"=1'-0"
----	---	-----------------	------------