

NOTE:
1. SEE SHEET E-001 FOR LEGEND AND GENERAL NOTES.

KEYED NOTE:

- ① REMOVE FIRE ALARM SYSTEM ABOVE REMOVED ROOMS. REMOVE EXISTING FIRE ALARM SYSTEM WIRING AS REQUIRED FOR A COMPLETE AND OPERABLE SYSTEM.
- ② FURNISH AND INSTALL 4" SQUARE JUNCTION BOX WITH 3/4" CONDUIT STUB UP TO ABOVE ACCESSIBLE CEILING. PROVIDE PULLSTRINGS AND RUBBER GASKETS BETWEEN TELEPHONE AND SYSTEMS CONTRACTORS PRIOR TO INSTALLATION.
- ③ FURNISH AND INSTALL 4" SQUARE JUNCTION BOX WITH ONE 3/4" EMT STUBBED ROUTED TO ABOVE CEILING IN CORRIDOR. PROVIDE PULLSTRINGS AND RUBBER GASKETS BETWEEN TELEPHONE AND SYSTEMS CONTRACTORS WITH NURSE CALL SYSTEM INSTALLER PRIOR TO WORK.
- ④ REMOVE WALL CLOCK AND BLASE THE WALL CLOCK ARE REMOVED DURING DEMOLITION AND EXTEND EXISTING WIRING AS REQUIRED.
- ⑤ SECURITY CAMERA LOCATION. PROVIDE 4" SQUARE JUNCTION BOX W/ 3" CONDUIT STUBBED TO ABOVE CORRIDOR ACCESSIBLE CEILING. COORD. EXACT LOCATION AND MOUNTING HEIGHT W/ OWNER'S SECURITY CONTRACTOR.
- ⑥ FURNISH AND INSTALL NEW FIRE ALARM SYSTEM DEVICE TO REMOVED ROOMS. PROVIDE PULLSTRINGS AND RUBBER GASKETS BETWEEN TELEPHONE AND SYSTEMS CONTRACTORS AS REQUIRED FOR A COMPLETE AND OPERABLE SYSTEM.
- ⑦ PROVIDE DUCT SMOKE DETECTOR FOR SMOKE DAMPER LOCATION. REUSE EXISTING UNIT REMOVED DURING DEMOLITION AND/OR PROVIDE NEW UNITS TO PICK UP THE EXISTING SYSTEM WIRING AS REQUIRED FOR A COMPLETE AND OPERABLE SYSTEM AS REQUIRED.
- ⑧ COORDINATE MOUNTING HEIGHT WITH OWNER AND ARCHITECT.

REV.	ISSUED FOR CONSTRUCTION	DESCRIPTION	DATE
0			9-12-08

ISSUED FOR CONSTRUCTION
9-12-08

CURRENT ISSUE STATUS:

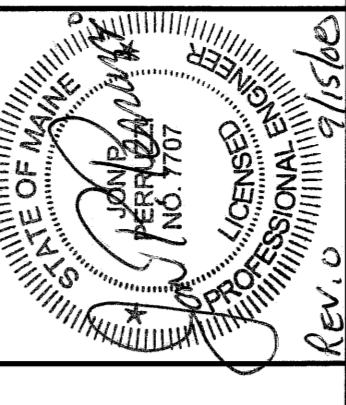

144 Elm Street, Box 614
Portland, Maine 04104
Tel: (207) 775-8846
Fax: (207) 775-1070
www.smrtco.com

SMRT
ARCHITECTURE
ENGINEERING
PLANNING
INTERIOR DESIGN
COMMISSIONING

MAINE MEDICAL CENTER - L.L. BEAN WING 2ND FLOOR
SURGICAL SERVICES
PORTLAND, MAINE

SYSTEMS
PARTIAL FLOOR PLAN SHEET 1

SCALE: 1/4" = 1'-0"
DATE: 9-12-08
GRAPHIC SCALE: 0' 1' 2'

PROJECT MANAGER: [Blank]
JOB APPROVAL: [Blank]
DATE OF RECORDS: [Blank]
SAFE COPY/FILE: EY101-08088
PROJECT No.: 08088

A1 PARTIAL FLOOR PLAN
1/4" = 1'-0"
EY101

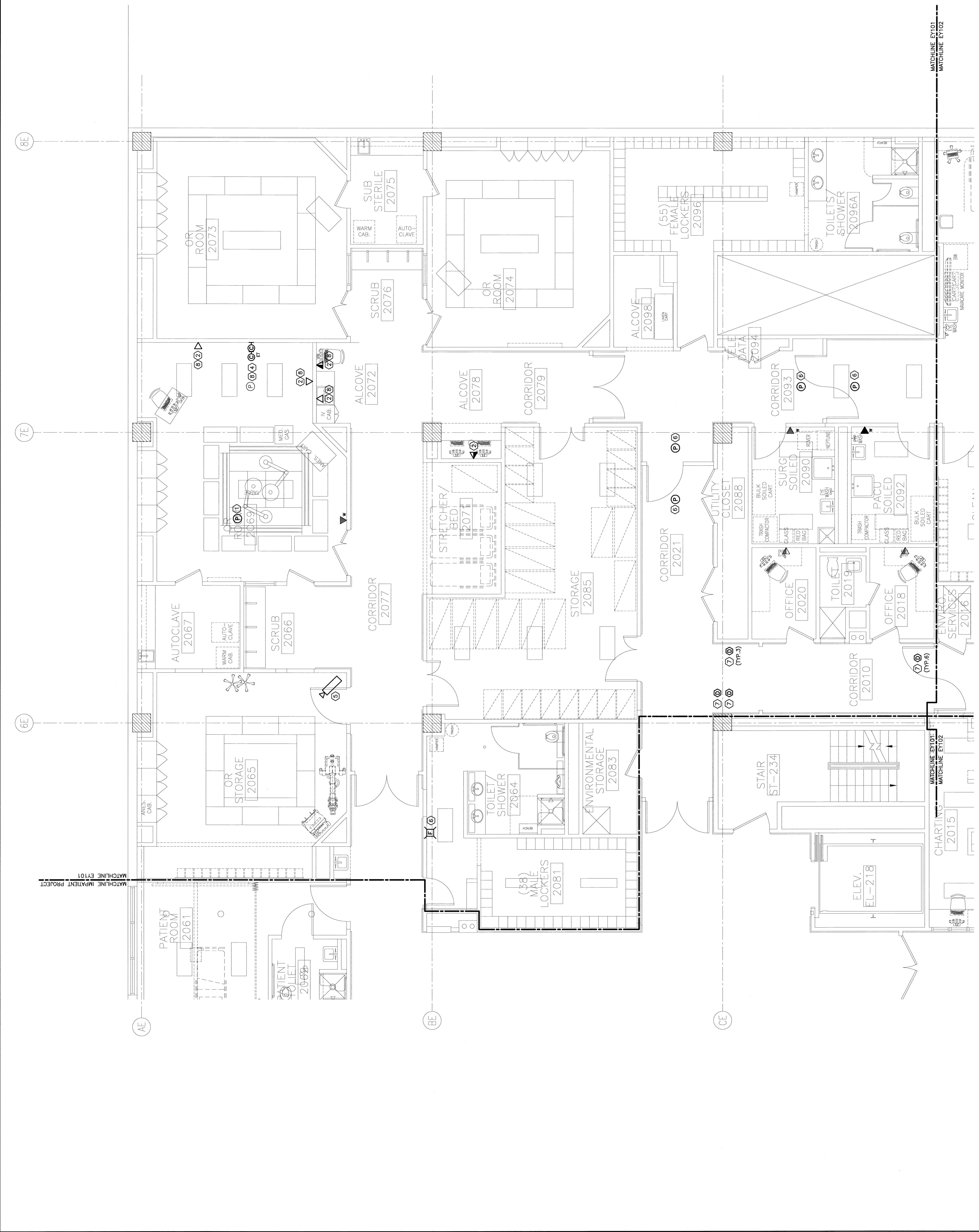

MATCHLINE EY100
MATCHLINE EY102

MATCHLINE EY100
MATCHLINE EY102