

DISPLAY THIS CARD ON PRINCIPAL FRONTAGE OF WORK

CITY OF PORTLAND

BUILDING DEPARTMENT

PERMIT

Permit Number: 090793

Please Read Application And Notes, If Any, Attached

This is to certify that Riley Margaret A /Dragon Construction Inc

has permission to Sill and foundation replacement

AT 30 Deering Ave City of Portland 053 C028001

provided that the person or persons, firm or corporation accepting this permit shall comply with all of the provisions of the Statutes of Maine and of the Ordinances of the City of Portland regulating the construction, maintenance and use of buildings and structures, and of the application on file in this department.

Apply to Public Works for street line and grade if nature of work requires such information.

Notification of inspection must be given and written permission procured before this building or part thereof is lath or other work is set-in. 24 HOUR NOTICE IS REQUIRED.

A certificate of occupancy must be procured by owner before this building or part thereof is occupied.

OTHER REQUIRED APPROVALS

Fire Dept. _____

Health Dept. _____

Appeal Board _____

Other _____
Department Name

Chris S. [Signature] 7/29/09
Director - Building & Inspection Services

PENALTY FOR REMOVING THIS CARD

City of Portland, Maine - Building or Use Permit Application

389 Congress Street, 04101 Tel: (207) 874-8703, Fax: (207) 874-8716

Permit No: 09-0793	Issue Date: 07/29/09	CBL: 053 C028001
-----------------------	-------------------------	---------------------

Location of Construction: 30 Deering Ave	Owner Name: Riley Margaret A	Owner Address: 30 Deering Ave	Phone:
Business Name:	Contractor Name: Dragon Construction Inc.	Contractor Address: 21 Marshall Valley Road Windham	Phone 2076504431
Lessee/Buyer's Name	Phone:	Permit Type: Alterations - Duplex	Zone:

Past Use: Duplex	Proposed Use: Duplex / Sill and foundation replacement.	Permit Fee: \$70.00	Cost of Work: \$5,000.00	CEO District: 2
Proposed Project Description: Sill and foundation replacement.		FIRE DEPT: <input type="checkbox"/> Approved <input type="checkbox"/> Denied	INSPECTION: Use Group: R-2 Type: SB IBC-2003	
		Signature:	Signature: <i>cl</i> 7/29/09	

PEDESTRIAN ACTIVITIES DISTRICT (P.A.D.)	
Action: <input type="checkbox"/> Approved <input type="checkbox"/> Approved w/Conditions <input type="checkbox"/> Denied	Signature: _____ Date: _____

Permit Taken By: gg	Date Applied For: 07/29/2009	Zoning Approval	
------------------------	---------------------------------	------------------------	--

<ol style="list-style-type: none"> This permit application does not preclude the Applicant(s) from meeting applicable State and Federal Rules. Building permits do not include plumbing, septic or electrical work. Building permits are void if work is not started within six (6) months of the date of issuance. False information may invalidate a building permit and stop all work.. 	Special Zone or Reviews <input type="checkbox"/> Shoreland <input type="checkbox"/> Wetland <input type="checkbox"/> Flood Zone <input type="checkbox"/> Subdivision <input type="checkbox"/> Site Plan Maj <input type="checkbox"/> Minor <input type="checkbox"/> MM <input type="checkbox"/> Date: 7/29/09 <i>cl</i>	Zoning Appeal <input type="checkbox"/> Variance <input type="checkbox"/> Miscellaneous <input type="checkbox"/> Conditional Use <input type="checkbox"/> Interpretation <input type="checkbox"/> Approved <input type="checkbox"/> Denied Date: _____	Historic Preservation <input type="checkbox"/> Not in District or Landmark <input checked="" type="checkbox"/> Does Not Require Review <input type="checkbox"/> Requires Review <input type="checkbox"/> Approved <input type="checkbox"/> Approved w/Conditions <input type="checkbox"/> Denied Date: <i>cl</i>
	<i>Still repair only O.K.</i>		

CERTIFICATION

I hereby certify that I am the owner of record of the named property, or that the proposed work is authorized by the owner of record and that I have been authorized by the owner to make this application as his authorized agent and I agree to conform to all applicable laws of this jurisdiction. In addition, if a permit for work described in the application is issued, I certify that the code official's authorized representative shall have the authority to enter all areas covered by such permit at any reasonable hour to enforce the provision of the code(s) applicable to such permit.

SIGNATURE OF APPLICANT	ADDRESS	DATE	PHONE
RESPONSIBLE PERSON IN CHARGE OF WORK, TITLE		DATE	PHONE



General Building Permit Application

If you or the property owner owes real estate or personal property taxes or user charges on any property within the City, payment arrangements must be made before permits of any kind are accepted.

Location/Address of Construction: <u>30 Deering Ave Portland</u>		
Total Square Footage of Proposed Structure/Area	Square Footage of Lot <u>40x90 = 3600</u>	Number of Stories
Tax Assessor's Chart, Block & Lot Chart# <u>053</u> Block# <u>C</u> Lot# <u>028</u>	Applicant * <u>must be owner, Lessee or Buyer*</u> Name <u>Ray Marshall</u> Address <u>21 Marshall Valley Rd</u> City, State & Zip <u>Windham Me, 04062</u>	Telephone: <u>207-650-4431</u>
Lessee/DBA (If Applicable)	Owner (if different from Applicant) Name <u>Joe Riley</u> Address <u>30 Deering Ave</u> City, State & Zip <u>Portland Me</u>	Cost Of Work: \$ <u>5,000</u> C of O Fee: \$ 50 Total Fee: \$ 50 <u>70.00</u>
Current legal use (i.e. single family) <u>Duplex</u> multi family Number of Residential Units <u>2</u> If vacant, what was the previous use? _____ Proposed Specific use: <u>multi Family</u> Is property part of a subdivision? <u>no</u> If yes, please name _____ Project description: <u>Sell & foundation replacement, also Sill</u>		
Contractor's name: <u>Deegan Construction Inc</u> Address: <u>21 Marshall Valley Rd</u> City, State & Zip <u>Windham Me 04062</u> Telephone: <u>207-650-4431</u> Who should we contact when the permit is ready: <u>Ray Marshall</u> Telephone: <u>207-650-4431</u> Mailing address: <u>same</u>		

Please submit all of the information outlined on the applicable Checklist. Failure to do so will result in the automatic denial of your permit.

In order to be sure the City fully understands the full scope of the project, the Planning and Development Department may request additional information prior to the issuance of a permit. For further information or to download copies of this form and other applications visit the Inspections Division on-line at www.portlandmaine.gov, or stop by the Inspections Division office, room 315 City Hall or call 874-8703.

I hereby certify that I am the Owner of record of the named property, or that the owner of record authorizes the proposed work and that I have been authorized by the owner to make this application as his/her authorized agent. I agree to conform to all applicable laws of this jurisdiction. In addition, if a permit for work described in this application is issued, I certify that the Code Official's authorized representative shall have the authority to enter all areas covered by this permit at any reasonable hour to enforce the provisions of the codes applicable to this permit.

Signature: [Signature] Date: July 27, 09

This is not a permit; you may not commence ANY work until the permit is issue

BUILDING PERMIT INSPECTION PROCEDURES

Please call 874-8703 or 874-8693 (ONLY)

to schedule your inspections as agreed upon

Permits expire in 6 months, if the project is not started or ceases for 6 months.

The Owner or their designee is required to notify the inspections office for the following inspections and provide adequate notice. Notice must be called in 48-72 hours in advance in order to schedule an inspection:

By initializing at each inspection time, you are agreeing that you understand the inspection procedure and additional fees from a "Stop Work Order" and "Stop Work Order Release" will be incurred if the procedure is not followed as stated below.

A Pre-construction Meeting will take place upon receipt of your building permit.

 X **Final inspection required at completion of work.**

Certificate of Occupancy is not required for certain projects. Your inspector can advise you if your project requires a Certificate of Occupancy. All projects DO require a final inspection.

If any of the inspections do not occur, the project cannot go on to the next phase, REGARDLESS OF THE NOTICE OR CIRCUMSTANCES.

CERIFICATE OF OCCUPANICES MUST BE ISSUED AND PAID FOR, BEFORE THE SPACE MAY BE OCCUPIED.

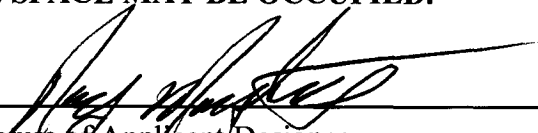

Signature of Applicant/Designee

Date

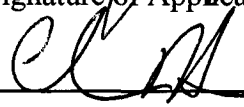

Signature of Inspections Official

 7/29/09
Date

City of Portland, Maine - Building or Use Permit

389 Congress Street, 04101 Tel: (207) 874-8703, Fax: (207) 874-8716

Permit No: 09-0793	Date Applied For: 07/29/2009	CBL: 053 C028001
------------------------------	--	----------------------------

Location of Construction: 30 Deering Ave	Owner Name: Riley Margaret A	Owner Address: 30 Deering Ave	Phone:
Business Name:	Contractor Name: Dragon Construction Inc.	Contractor Address: 21 Marshall Valley Road Windham	Phone: (207) 650-4431
Lessee/Buyer's Name	Phone:	Permit Type: Alterations - Duplex	

Proposed Use: Duplex / Sill and foundation replacement.	Proposed Project Description: Sill and foundation replacement.
---	--

Dept: Zoning	Status: Approved	Reviewer: Chris Hanson	Approval Date: 07/29/2009
Note:	Ok to Issue: <input checked="" type="checkbox"/>		
Dept: Building	Status: Approved with Conditions	Reviewer: Chris Hanson	Approval Date: 07/29/2009
Note:	Ok to Issue: <input checked="" type="checkbox"/>		
1) Permit approved based on the plans submitted and reviewed w/owner/contractor, with additional information as agreed on and as noted on plans.			
2) Application approval based upon information provided by applicant. Any deviation from approved plans requires separate review and approval prior to work.			



Same-Day Permitting

As part of Portland's city-wide effort to improve customer service and help streamline doing business within the City, the Inspections Division has developed a new permitting system for qualified properties and for specific construction projects.

This permitting program applies only to existing single family homes not located within a historic district or shoreland zone.

Eligible Projects

Please submit a complete application with the required plans

- Interior non structural projects (i.e. Adding closets, bathrooms, changing floor plans, kitchen remodels)
- Repairs to existing decks, porches and stairs that meet current zoning setbacks
- Adding or replacing windows and doors (not to include bay windows)
- Sheds less than 144 sq. ft.
- One story open entry/porch, 50 sq. ft. or less with maximum 6 ft. projection from the principal structure
- Chimney installation (NFPA 211 disclosure statement required)
- Propane tanks
- Heating Appliances (i.e. HVAC systems, gas inserts/monitors, wood/pellet stoves)
- Bulkheads 50 sq. ft. or less with maximum of 2 ft. in height (low profile)

Inspections are still required per City Code of Ordinance.

In order to be sure the City fully understands the full scope of the project, the Planning and Development Department may request additional information prior to the issuance of a permit. For further information visit us on-line at www.portlandmaine.gov, stop by the Building Inspections office, room 315 City Hall or call 874-8703.

I hereby certify that this project meets the above criteria and that the work performed will not go beyond these parameters.

Signature of applicant:

Date: 7/29/09

This is not a permit; you may not commence ANY work until the permit is issued.

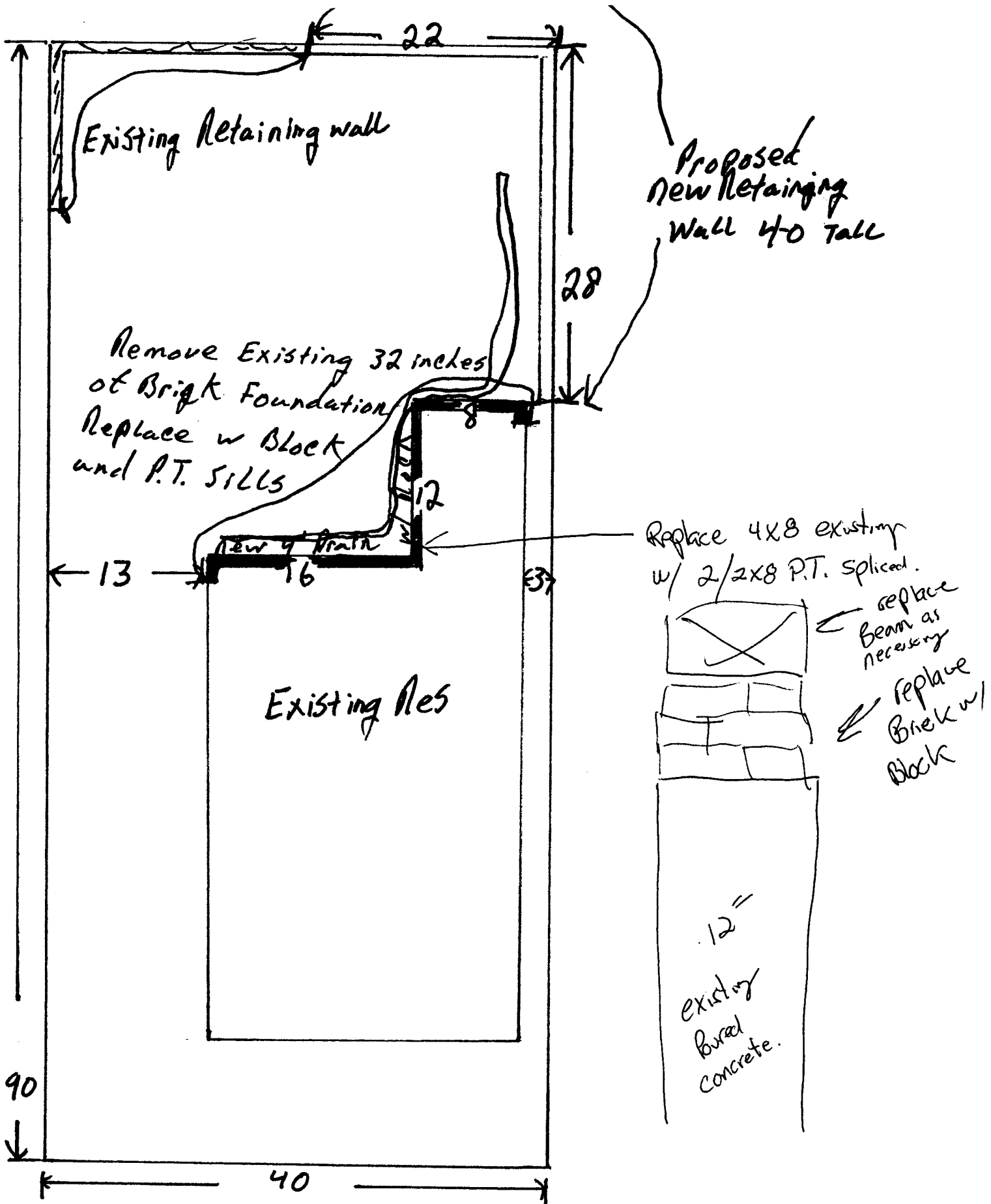

30 Deering AVE

1" = 10ft Plot Plan



CITY OF PORTLAND, MAINE
Department of Building Inspections

Original Receipt

July 29, 2004

Received from Draga Construction

Location of Work 30 Seaside Ave

Cost of Construction \$ _____ Building Fee: _____

Permit Fee \$ _____ Site Fee: _____

Certificate of Occupancy Fee: _____

Total: 70.00

Building (IL) Plumbing (I5) _____ Electrical (I2) _____ Site Plan (U2) _____

Other _____

CBL: 053 C024

Check #: 3125 Total Collected \$ 70.00

**No work is to be started until permit issued.
Please keep original receipt for your records.**

Taken by: [Signature]

WHITE - Applicant's Copy
YELLOW - Office Copy
PINK - Permit Copy