

**DISPLAY THIS CARD ON PRINCIPAL FRONTAGE OF WORK**  
**CITY OF PORTLAND**

Please Read  
Application And  
Notes, If Any,  
Attached

**BUILDING INSPECTION**

**PERMIT**

Permit Number: 070875

This is to certify that THE IRIS NETWORK /Bail Sign Co

has permission to new sign for Iris Network 48 Ft

AT 189 PARK AVE

052 C00300

AUG 8 2007

provided that the person or persons, firm or corporation accepting this permit shall comply with all of the provisions of the Statutes of Maine and of the Ordinances of the City of Portland regulating the construction, maintenance and use of buildings and structures, and of the application on file in this department.

Apply to Public Works for street line and grade if nature of work requires such information.

Notification of inspection must be given and written permission procured before this building or part thereof is altered or closed-in. **HEAR NOTICE IS REQUIRED.**

A certificate of occupancy must be procured by owner before this building or part thereof is occupied.

**OTHER REQUIRED APPROVALS**

Fire Dept. \_\_\_\_\_

Health Dept. \_\_\_\_\_

Appeal Board \_\_\_\_\_

Other \_\_\_\_\_

Department Name

Director - Building & Inspection Services

**PENALTY FOR REMOVING THIS CARD**

**PERMIT ISSUED**

CITY OF PORTLAND

*[Signature]* 7/31/07

**City of Portland, Maine - Building or Use Permit Application**

389 Congress Street, 04101 Tel: (207) 874-8703, Fax: (207) 874-8716

Permit No: 07-0875	Issue Date:	CBL: 052 C003001
-----------------------	-------------	---------------------

Location of Construction: 189 PARK AVE	Owner Name: THE IRIS NETWORK	Owner Address: 189 PARK AVE	Phone:
Business Name:	Contractor Name: Bailey Sign Company Inc.	Contractor Address: 9 Thomas Drive Westbrook	Phone 2077742843
Lessee/Buyer's Name	Phone:	Permit Type: Signs - Permanent	Zone: C37

Past Use: Commercial/ residential	Proposed Use: Commercial/ Residential - Iris Network new sign for Iris Network 48 Sq Ft	Permit Fee: \$126.00	Cost of Work: \$126.00	CEO District: 1	Zone: C37 (R-5 underlying)
Proposed Project Description: new sign for Iris Network 48 Sq Ft		FIRE DEPT: <input type="checkbox"/> Approved <input checked="" type="checkbox"/> Denied Signature: <i>N/A</i>	INSPECTION: Use Group: <i>U</i> Type: <i>Sign</i> <i>IBC 2003</i> Signature: <i>[Signature]</i>		
		PEDESTRIAN ACTIVITIES DISTRICT (P.A.D.) Action: <input type="checkbox"/> Approved <input type="checkbox"/> Approved w/Conditions <input type="checkbox"/> Denied Signature: _____ Date: _____			

Permit Taken By: Idobson	Date Applied For: 07/19/2007	<b>Zoning Approval</b>		
-----------------------------	---------------------------------	------------------------	--	--

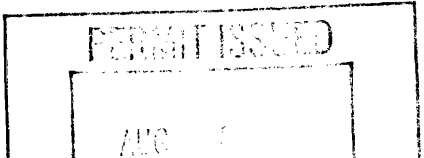
<ol style="list-style-type: none"> <li>This permit application does not preclude the Applicant(s) from meeting applicable State and Federal Rules.</li> <li>Building permits do not include plumbing, septic or electrical work.</li> <li>Building permits are void if work is not started within six (6) months of the date of issuance. False information may invalidate a building permit and stop all work..</li> </ol>	<b>Special Zone or Reviews</b> <input type="checkbox"/> Shoreland <input type="checkbox"/> Wetland <input type="checkbox"/> Flood Zone <input type="checkbox"/> Subdivision <input type="checkbox"/> Site Plan  Maj <input type="checkbox"/> Minor <input type="checkbox"/> MM <input type="checkbox"/> OK w/condition Date: 7/27/07 ARM	<b>Zoning Appeal</b> <input type="checkbox"/> Variance <input type="checkbox"/> Miscellaneous <input type="checkbox"/> Conditional Use <input type="checkbox"/> Interpretation <input type="checkbox"/> Approved <input type="checkbox"/> Denied Date:	<b>Historic Preservation</b> <input checked="" type="checkbox"/> Not in District or Landmark <input type="checkbox"/> Does Not Require Review <input type="checkbox"/> Requires Review <input type="checkbox"/> Approved <input type="checkbox"/> Approved w/Conditions <input type="checkbox"/> Denied ARM Date:
			

**CERTIFICATION**

I hereby certify that I am the owner of record of the named property, or that the proposed work is authorized by the owner of record and that I have been authorized by the owner to make this application as his authorized agent and I agree to conform to all applicable laws of this jurisdiction. In addition, if a permit for work described in the application is issued, I certify that the code official's authorized representative shall have the authority to enter all areas covered by such permit at any reasonable hour to enforce the provision of the code(s) applicable to such permit.

SIGNATURE OF APPLICANT	ADDRESS	DATE	PHONE
RESPONSIBLE PERSON IN CHARGE OF WORK, TITLE		DATE	PHONE

**City of Portland, Maine - Building or Use Permit**

389 Congress Street, 04101 Tel: (207) 874-8703, Fax: (207) 874-8716

<b>Permit No:</b> 07-0875	<b>Date Applied For:</b> 07/19/2007	<b>CBL:</b> 052 C003001
------------------------------	--	----------------------------

<b>Location of Construction:</b> 189 PARK AVE	<b>Owner Name:</b> THE IRIS NETWORK	<b>Owner Address:</b> 189 PARK AVE	<b>Phone:</b>
<b>Business Name:</b>	<b>Contractor Name:</b> Bailey Sign Company Inc.	<b>Contractor Address:</b> 9 Thomas Drive Westbrook	<b>Phone</b> (207) 774-2843
<b>Lessee/Buyer's Name</b>	<b>Phone:</b>	<b>Permit Type:</b> Signs - Permanent	

<b>Proposed Use:</b> Commercial/ Residential - Iris Network new sign for Iris Network 48 Sq Ft	<b>Proposed Project Description:</b> new sign for Iris Network 48 Sq Ft
--	--

**Dept:** Zoning      **Status:** Approved with Conditions      **Reviewer:** Ann Machado      **Approval Date:** 07/27/2007

**Note:** **Ok to Issue:**

- 1) This permit is being approved on the basis of plans submitted. Any deviations shall require a separate approval before starting that work.

**Dept:** Building      **Status:** Approved with Conditions      **Reviewer:** Tammy Munson      **Approval Date:** 07/31/2007

**Note:** **Ok to Issue:**

- 1) Signage Installation to comply with Chapter 31 of the IBC 2003 building code.

**Comments:**

7/26/2007-amachado: Left message for Carolyn Cuting at Bailey Signs. Sign is 8'10.5" from grade to top and the ordinance only allows the sign to be 8' high.

7/27/2007-amachado: Received revised sign proposal.



# Signage/Awning Permit Application

If you or the property owner owes real estate or personal property taxes or user charges on any property within the City, payment arrangements must be made before permits of any kind are accepted.

Location/Address of Construction: <u>189 Park Avenue</u>		
Tax Assessor's Chart, Block & Lot Chart#      Block#      Lot# <u>52</u> <u>C</u> <u>3</u>	Owner: <u>Iris Network</u> <u>(Adam Zayan, President)</u>	Telephone: <u>774-6273</u>
Lessee/Buyer's Name (If Applicable)	Applicant name, address & telephone: <u>Carolyn Cutting/Baily Sign</u> <u>9 Thomas Drive</u> <u>Westbrook, ME 04092</u> <u>774-2843</u>	Total s.f. of signage x \$2.00 Per s.f. plus \$30.00/\$65.00 For H.D. signage= Total Fee: <u>\$126.00</u> Awning Fee= cost of work <u>-</u> Total Fee: <u>\$126.00</u>
Who should we contact when the permit is ready: <u>Carolyn Cutting</u> phone: <u>774-2843 ext. 102</u>		
Tenant/allocated building space frontage (feet): Length: <u>200</u> Height: <u>40</u> Lot Frontage (feet) <u>300</u> Single Tenant or Multi Tenant Lot <u>Single</u>		
Current Specific use: <u>-</u> If vacant, what was prior use: <u>-</u> Proposed Use: <u>Iris Park Apartments</u>		
Information on proposed sign(s): Freestanding (e.g., pole) sign? Yes <input checked="" type="checkbox"/> No <input type="checkbox"/> Dimensions proposed: <u>48' x 8'</u> Bldg. wall sign? (attached to bldg) Yes <input type="checkbox"/> No <input type="checkbox"/> Dimensions proposed: <u>48' x 8'</u>		
Proposed awning? Yes <input type="checkbox"/> No <input type="checkbox"/> Is awning backlit? Yes <input type="checkbox"/> No <input type="checkbox"/> Height of awning: _____ Length of awning: _____ Depth: _____ Is there any communication, message, trademark or symbol on it? Yes <input type="checkbox"/> No <input type="checkbox"/> If yes, total s.f. of panels w/communications, message, trademark or symbol: _____ s.f.		
Information on existing and previously permitted sign(s): Freestanding (e.g., pole) sign? Yes <input checked="" type="checkbox"/> No <input type="checkbox"/> Dimensions proposed: <u>48 sff (Existing is 6'x8')</u> Bldg. wall sign? (attached to bldg) Yes <input type="checkbox"/> No <input type="checkbox"/> Dimensions proposed: _____ Awning? Yes <input type="checkbox"/> No <input type="checkbox"/> Sq. ft. area of awning w/communication: _____		
A site sketch and building sketch showing exactly where existing and new signage is located must be provided. Sketches and/or pictures of proposed signage and existing building are also required.		

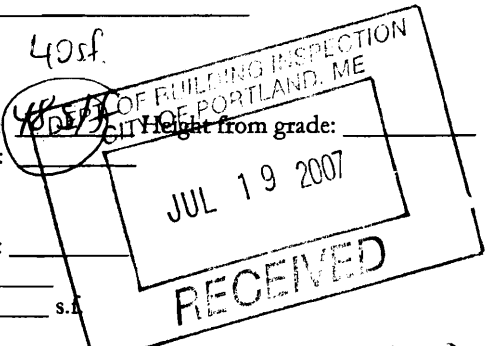

Please submit all of the information outlined in the Sign/Awning Application Checklist. Failure to do so may result in the automatic denial of your permit.

In order to be sure the City fully understands the full scope of the project, the Planning and Development Department may request additional information prior to the issuance of a permit. For further information visit us on-line at [www.portlandmaine.gov](http://www.portlandmaine.gov), stop by the Building Inspections office, room 315 City Hall or call 874-8703.

I hereby certify that I am the Owner of record of the named property, or that the owner of record authorizes the proposed work and that I have been authorized by the owner to make this application as his/her authorized agent. I agree to conform to all applicable laws of this jurisdiction. In addition, if a permit for work described in this application is issued, I certify that the Code Official's authorized representative shall have the authority to enter all areas covered by this permit at any reasonable hour to enforce the provisions of the codes applicable to this permit.

Signature of applicant: Carol Cutting Date: July 19, 2007

This is not a permit; you may not commence ANY work until the permit is issued.

inst. hand in R-5 - street frontage 2250  
50' x  
8' max

6' x 8' = 48' <sup>revised</sup> 5' x 8' = 40' x  
5' max h/ht ok.  
max height = 8'.

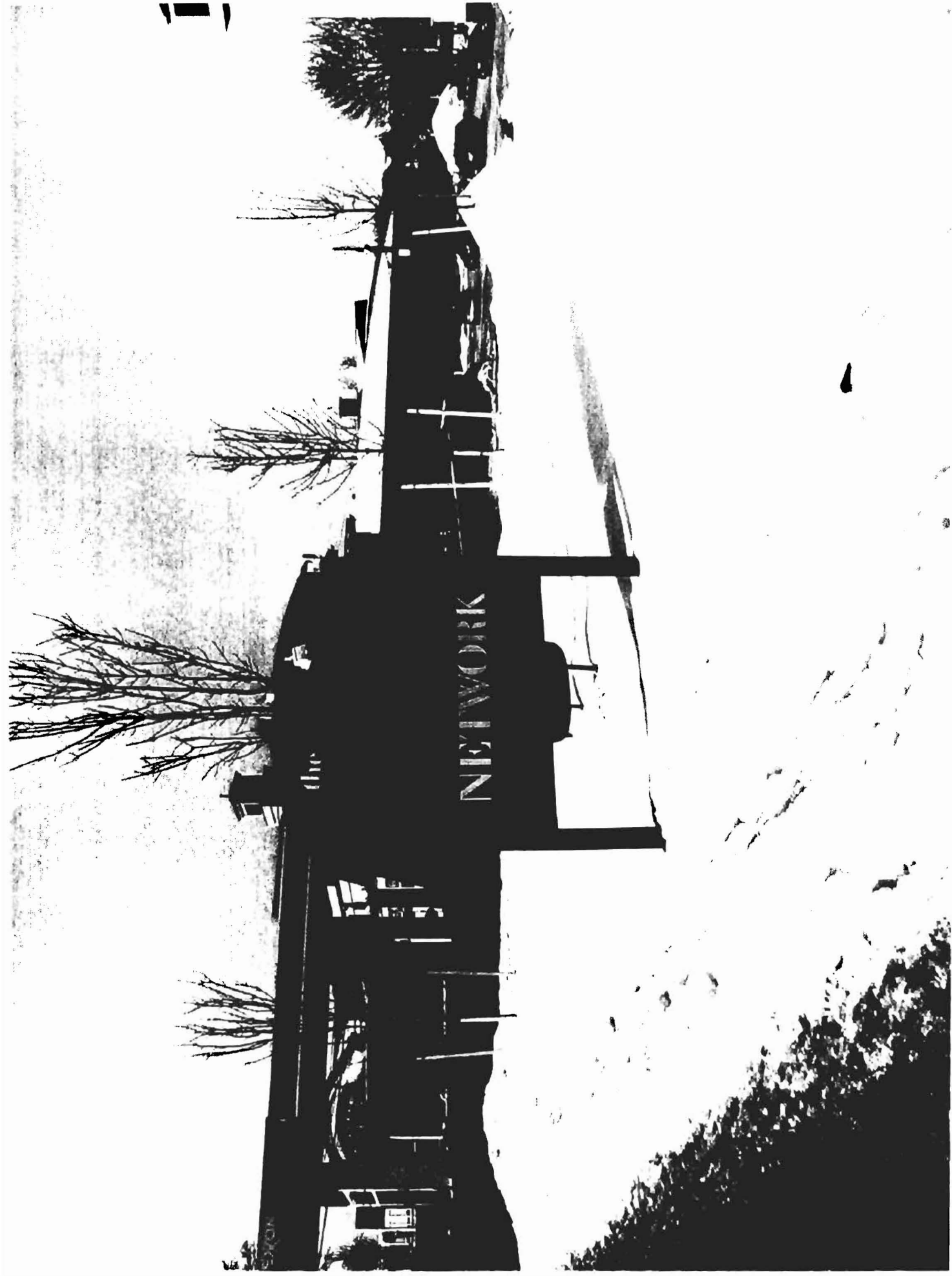

Current sign -



July 17, 2007

Bailey Sign

Dear Bruce:

The *Iris Park Apartment*, a project of The Iris Network, is nearing completion. The plans call for installing new signage on the property located 189 Park Avenue in the City of Portland. The Iris Network is a 100 year old not-for-profit agency serving people who are blind or visually impaired in the State of Maine.

I, Adam Zayan, president of the organization, grant Bailey Sign permission to install the proposed signage per the specifications agreed upon.

Sincerely,

Adam Zayan  
President

---

*A Statewide Focus on Maine's Visually Impaired Since 1905.*

189 Park Avenue, Portland, Maine 04102  
207.774.6273 • 800.715.0097 • fax 207.774.0679 • [www.theiris.org](http://www.theiris.org)

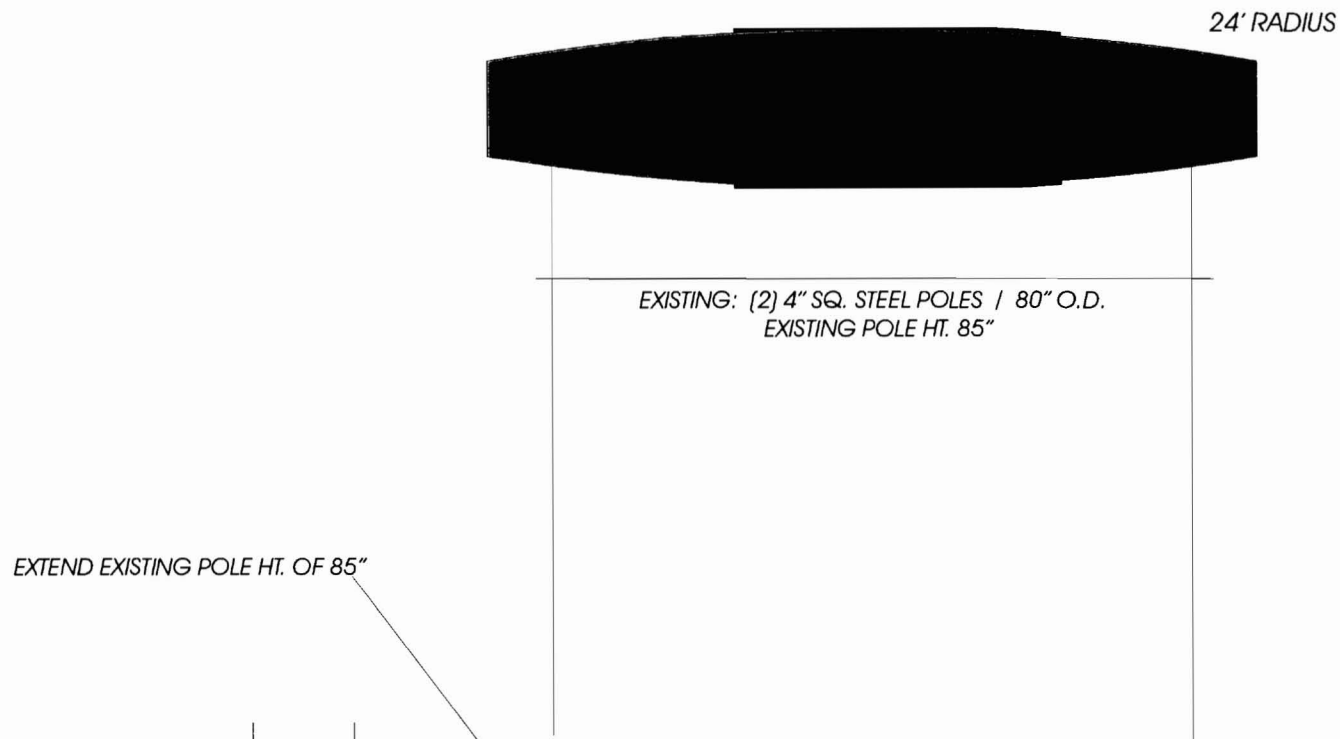

EXTEND EXISTING POLE HT. OF 85"

EXISTING: (2) 4" SQ. STEEL POLES / 80" O.D.  
EXISTING POLE HT. 85"

24' RADIUS

18' RADIUS

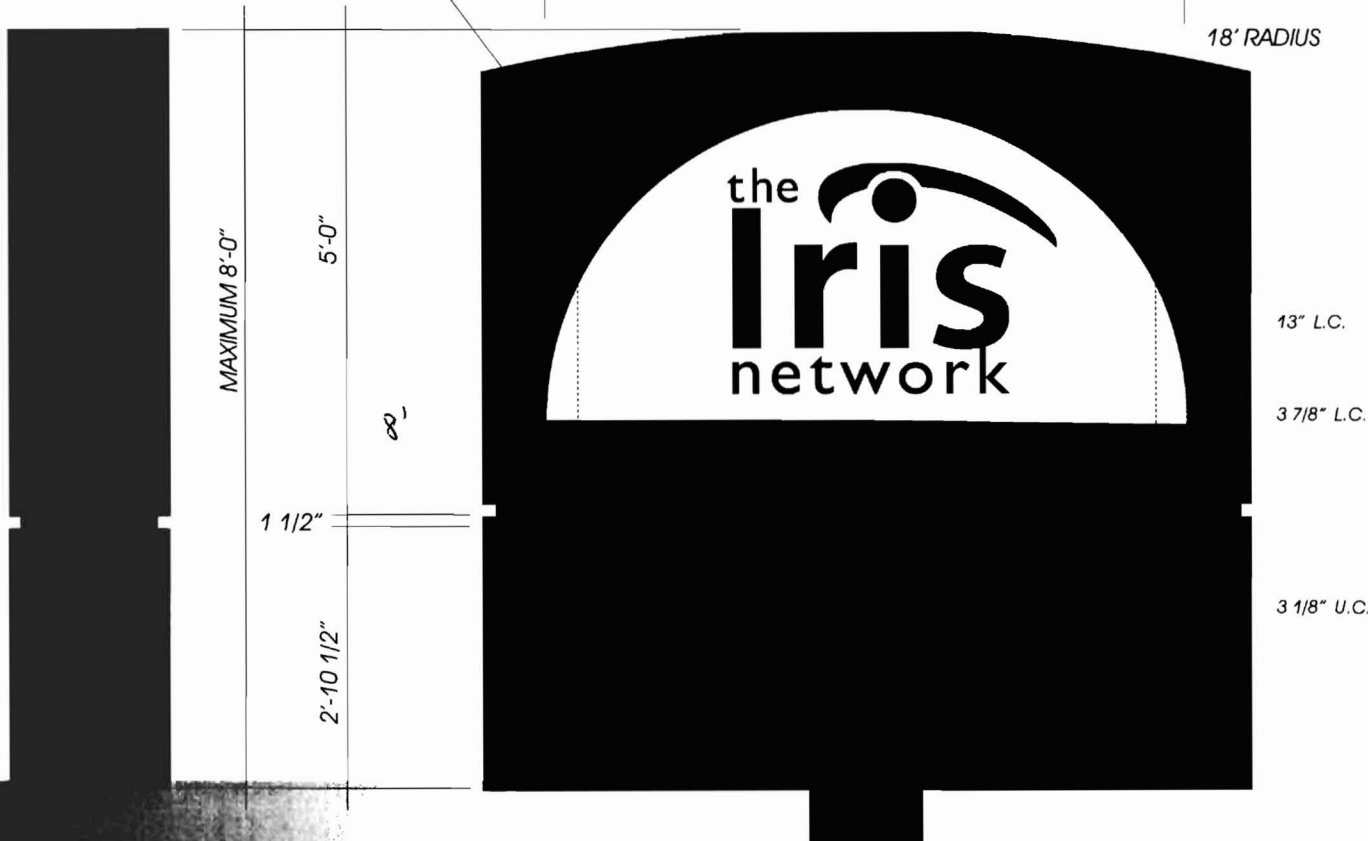

MAXIMUM 8'-0"

5'-0"

8'

1 1/2"

2'-10 1/2"

13" L.C.

3 7/8" L.C.

3 1/8" U.C.

PARKING

ENTRANC

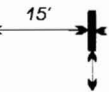

(1) D.F. 5'-0" X 8'-0' NON-ILL

SHAPED ALUMINUM RETAINERLESS CAL  
SEMI CIRCLE SHAPE: PAINTED WHITE  
COPY: 1/4" INDIVIDUAL SINTRA CUT OI  
PAINTED: BLACK, PMS #745!

SHAPED REVEAL: BLACK

(1) D.F. 2'-10 1/2" X 8'-0' SIG

SHAPED ALUMINUM SKIRT PMS #2945

BY OTHERS:  
(2) 400 WATTS EACH - ELECTRONIC ENERGY MIZER LIGHT FIXTURES  
& PHOTO CELL WITH TIME CLOCK