

**GENERAL NOTES**

1. CALL DE-SAFE (1-888-344-7233) PRIOR TO BEGINS WORK. THE LANDSCAPE CONTRACTOR IS ADVISED OF THE PRESENCE OF UTILITIES AND SHALL VERIFY THE LOCATION OF SAME BEFORE COMMENCING ANY DIGGING OPERATIONS. THE LANDSCAPE CONTRACTOR SHALL BE RESPONSIBLE FOR OBTAINING ALL NECESSARY PERMITS AND APPROVALS FROM THE CITY OF PORTLAND PRIOR TO BEGINS WORK.
2. CONTRACTOR SHALL THOROUGHLY EXAMINE ALL EXISTING PLANS AND SPECIFICATIONS FOR ANY DISCREPANCIES OR CONFLICTS. THE CONTRACTOR SHALL BE RESPONSIBLE FOR OBTAINING ALL NECESSARY PERMITS AND APPROVALS FROM THE CITY OF PORTLAND PRIOR TO BEGINS WORK.
3. DO NOT SCALE FROM DRAWINGS. ANY DIMENSIONS NOT SHOWN SHALL BE REPORTED IMMEDIATELY TO THE LANDSCAPE ARCHITECT. DIMENSIONS SHALL BE PRESENTLY REPORTED TO THE LANDSCAPE ARCHITECT BEFORE ANY ADDITIONAL WORK PROCEEDS.
4. PROVIDE SMOOTH TRANSITION WHERE NEW WORK MEETS EXISTING CONDITIONS.
5. CONTRACTOR SHALL CONFORM AND PLACE 12 INCHES OF LOAM UNDER ALL PLANTINGS. THE LANDSCAPE CONTRACTOR SHALL BE RESPONSIBLE FOR OBTAINING ALL NECESSARY PERMITS AND APPROVALS FROM THE CITY OF PORTLAND PRIOR TO BEGINS WORK.
6. ALL PLANT MATERIAL INSTALLED SHALL MEET THE SPECIFICATIONS OF THE AMERICAN ASSOCIATION OF NURSERYMEN (AAO) AND THE AMERICAN ASSOCIATION OF NURSERYMEN (AAO).
7. ALL PLANT MATERIAL SHALL BE FREE FROM INSECTS AND DISEASE.
8. ALL PLANTING SHALL BE DONE IN ACCORDANCE WITH ACCEPTABLE PRACTICES AND THE PLANTING SHALL BE DONE IN ACCORDANCE WITH THE MAINTENANCE UNIT ACCEPTANCE FROM THE OWNER.
9. ALL PLANTING SHALL BE DONE IN ACCORDANCE WITH THE MAINTENANCE UNIT ACCEPTANCE FROM THE OWNER.
10. THE GENERAL CONTRACTOR SHALL BE RESPONSIBLE FOR THE PROTECTION OF EXISTING AND NEWLY PLANTED TREES AND SHRUBS DURING THE CONSTRUCTION PERIOD. THE LANDSCAPE CONTRACTOR SHALL BE RESPONSIBLE FOR THE PROTECTION OF EXISTING AND NEWLY PLANTED TREES AND SHRUBS DURING THE CONSTRUCTION PERIOD. THE LANDSCAPE CONTRACTOR SHALL BE RESPONSIBLE FOR THE PROTECTION OF EXISTING AND NEWLY PLANTED TREES AND SHRUBS DURING THE CONSTRUCTION PERIOD.
11. NEW PLANTINGS SHALL BE INSTALLED PER PROJECT DRAWINGS AND SPECIFICATIONS THAT INCLUDE FERTILIZING AND MULCHING AS REQUIRED.
12. ALL SPREADS, ROPS, AND TREE PITS SHALL BE FILLED.
13. ANY NOTATION FROM THE LANDSCAPE PLAN INCLUDING PLANT LOCATION, SELECTION, SIZE, QUANTITY OR CONDITION SHALL BE REVIEWED AND APPROVED BY THE LANDSCAPE ARCHITECT PRIOR TO INSTALLATION ON SITE.
14. WHERE INDICATED ON PLAN, PLANTING SOIL MIXTURE FOR GROUND COVER AND TREES SHALL BE 50% TOPSOIL, 25% SAND, AND 25% COMPOST. WHERE INDICATED ON PLAN, PLANTING SOIL MIXTURE FOR GROUND COVER AND TREES SHALL BE 50% TOPSOIL, 25% SAND, AND 25% COMPOST.
15. THE GENERAL CONTRACTOR AND/OR LANDSCAPE SUBCONTRACTOR SHALL BE RESPONSIBLE FOR THE PROTECTION OF EXISTING AND NEWLY PLANTED TREES AND SHRUBS DURING THE CONSTRUCTION PERIOD. THE LANDSCAPE CONTRACTOR SHALL BE RESPONSIBLE FOR THE PROTECTION OF EXISTING AND NEWLY PLANTED TREES AND SHRUBS DURING THE CONSTRUCTION PERIOD.
16. THE GENERAL CONTRACTOR SHALL BE RESPONSIBLE FOR MAINTAINING ALL UTILITIES AND ALL UTILITIES HAVE BEEN STABILIZED AND ACCEPTED BY THE OWNER. THE LANDSCAPE CONTRACTOR SHALL BE RESPONSIBLE FOR MAINTAINING ALL UTILITIES AND ALL UTILITIES HAVE BEEN STABILIZED AND ACCEPTED BY THE OWNER.
17. THE GENERAL CONTRACTOR AND/OR LANDSCAPE SUBCONTRACTOR SHALL BE RESPONSIBLE FOR THE PROTECTION OF EXISTING AND NEWLY PLANTED TREES AND SHRUBS DURING THE CONSTRUCTION PERIOD. THE LANDSCAPE CONTRACTOR SHALL BE RESPONSIBLE FOR THE PROTECTION OF EXISTING AND NEWLY PLANTED TREES AND SHRUBS DURING THE CONSTRUCTION PERIOD.
18. THE GENERAL CONTRACTOR SHALL BE RESPONSIBLE FOR A MINIMUM OF TWO (2) WEEKS OF MAINTENANCE AFTER THE COMPLETION OF THE PROJECT. THE LANDSCAPE CONTRACTOR SHALL BE RESPONSIBLE FOR A MINIMUM OF TWO (2) WEEKS OF MAINTENANCE AFTER THE COMPLETION OF THE PROJECT.
19. DAMAGE TO EXISTING SITE IMPROVEMENTS DURING INSTALLATION OF LANDSCAPE CONTRACTOR.

**PLANT LIST**

KEY	QTY	BOTANICAL NAME	COMMON NAME	SIZE
-----	-----	----------------	-------------	------

A. GN	1	ACER GINNA	AMR MALE	3'-7" CAL
A. SA	1	ACER SACHALINENSE	SILVER MALE	3'-7" CAL
C. SHE	1	CATALPA SPECIOSA	NORTHERN CATALPA	3'-7" CAL
C. TS	1	CELEBRATA BRANCAANTHOS 'SUNBURST'	SUNBURST LOCUST	5'-6" HT.
M. LOU	4	MAONQUA X LOEBNERI LEONARD MESSER	LEONARD MESSER MAONQUA	17'-5"-2' CAL
M. LI	4	MALUS LOUISA	LOUISA CRABAPPLE	2'-7" CAL
M. PN	4	MALUS PINKSPRING	PINKSPRING CRABAPPLE	2'-7" CAL
M. SS	4	MALUS SPRING SNOW	SPRING SNOW CRABAPPLE	2'-7" CAL
M. ZC	4	MALUS ZIM CALOCARPA	ZIM CRABAPPLE	2'-7" CAL
F. CA	2	FALUS GALLERIANA ARBORESCENS	ARBORESCENT PEAR	5'-6" HT.
F. PN	1	FALUS PAVIA	COMMON PEAR	3'-4" HT.
Q. RUB	1	QUERCUS RUBRA	KID OAK	3'-4" HT.
T. CAN	12	TAXUS CANADENSIS	CANADIAN REDWOOD	4'-5" HT.
A. ARB	3	ARONA ARBUSTIFOLIA 'RELIANTISSIMA'	RED BERRY DOGWOOD	2'-3'-7" HT.
C. AK	3	CETIVERA ALBERTA 'COMPLATA'	COMPLAT CLIFTER	#3 CONT.
C. HIT	18	COTONEASTER HORIZONTALIS 'TOM THUMB'	TOM THUMB COTONEASTER	#3 CONT.
C. PER	3	COMPANION PERECINA	SWEETFRUIT	#3 CONT.
D. JAKR	3	DAPHNE X BARKWOOD 'SOPHISTE'	SOPHISTE DAPHNE	#3 CONT.
E. CAM	1	ENOSTYCHUS CAMPANULATUS	REDBELL EDWARDS	2'-2'-25" HT.
F. COU	10	FORSYTHIA CORNIFOLIA 'COLD TEE'	COLD TEE FORSYTHIA	#3 CONT.
F. COU	10	FORSYTHIA CORNIFOLIA 'COLD TEE'	COLD TEE FORSYTHIA	#3 CONT.
J. COG	22	JANEBUS COMMUNIS 'GREEN CARPET'	GREEN CARPET JANER	#3 CONT.
J. PRO	4	JANEBUS COMMUNIS 'GREEN CARPET'	GREEN CARPET JANER	#3 CONT.
K. LIT	11	KALYA LATIFOLIA 'TODOLYNNIS'	TODOLYNNIS KALYA	#3 CONT.
K. BRI	5	MACROBOTIA DECUSATA	BROOKSHAD MOUNTAIN LABEL	#3 CONT.
M. DEC	3	MICROBOTIA DECUSATA	BROOKSHAD MOUNTAIN LABEL	#3 CONT.
P. FLO	5	PERIS FLOREBANDA	FLOREBANDA ANDROMEDA	#2 CONT.
P. LB	6	PHILADELPHUS X 'JANET REDY'	JANET REDY HOCORANCE	#3 CONT.
R. M	6	RHOODODENDRON YAMAMOTO 'INDEPENDANCE'	INDEPENDANCE RHOODODENDRON	#3 CONT.
R. WN	6	RHOODODENDRON 'WINDFAN'	WINDFAN RHOODODENDRON	#3 CONT.
S. BAL	14	SYRINGA BALBELLE	INNERBELL ILIAC	#3 CONT.
S. BDV	4	SYRINGA BALBELLE	FARTY DUST ILIAC	#3 CONT.
V. CA	6	VIBURNUM CARLESII 'NAROKA'	NAROKA VIBURNUM	2'-3'-3" HT.
V. CO	4	VIBURNUM CARLESII 'NAROKA'	NAROKA VIBURNUM	2'-3'-3" HT.
A. ARE	16	ASTER 'JAGUNSA'	BROAD VILE	6" POT
G. HLE	20	CANTHUS LINDSAYI 'CHINA BLUE'	CHINA BLUE CANTHUS	6" POT
H. FLA	30	HEPEROCALUS TILIAE	LIDON LILY	6" POT
H. SDO	18	HEPEROCALUS 'STELLA D'ORO'	STELLA D'ORO DANIEL	6" POT
L. SPH	9	LAROP SPICATA	CREeping LAROP	6" POT
R. FIL	11	RUBROCALA FILICOLA	CONETLOWER	6" POT
H. SEM	18	HELCOTRICHON SEPPERSWENS	BLUE OAT GRASS	1 GAL POT
P. ANA	10	PANICUM ANAHEIM 'DEWEY BLUE'	DEWEY BLUE SWITCH GRASS	1 GAL POT
P. AH	10	PENNSYLVANIA ALPHELODIDES 'HARKLEY'	HARKLEY FOUNTAIN GRASS	1 GAL POT
P. MOU	14	PENNSYLVANIA ALPHELODIDES 'HARKLEY'	BLACK FOUNTAIN GRASS	1 GAL POT
A. GEN	75	ALUCA GENENSIS	BIUCE WEED	#3 CONT.
A. LUJ	19	ARCTOSTAPHYLOS UVA-URS	BEARBERRY	#3 CONT.
G. ODO	19	CALAM COOKRATUM	SWEET WOODRUFF	3" POT

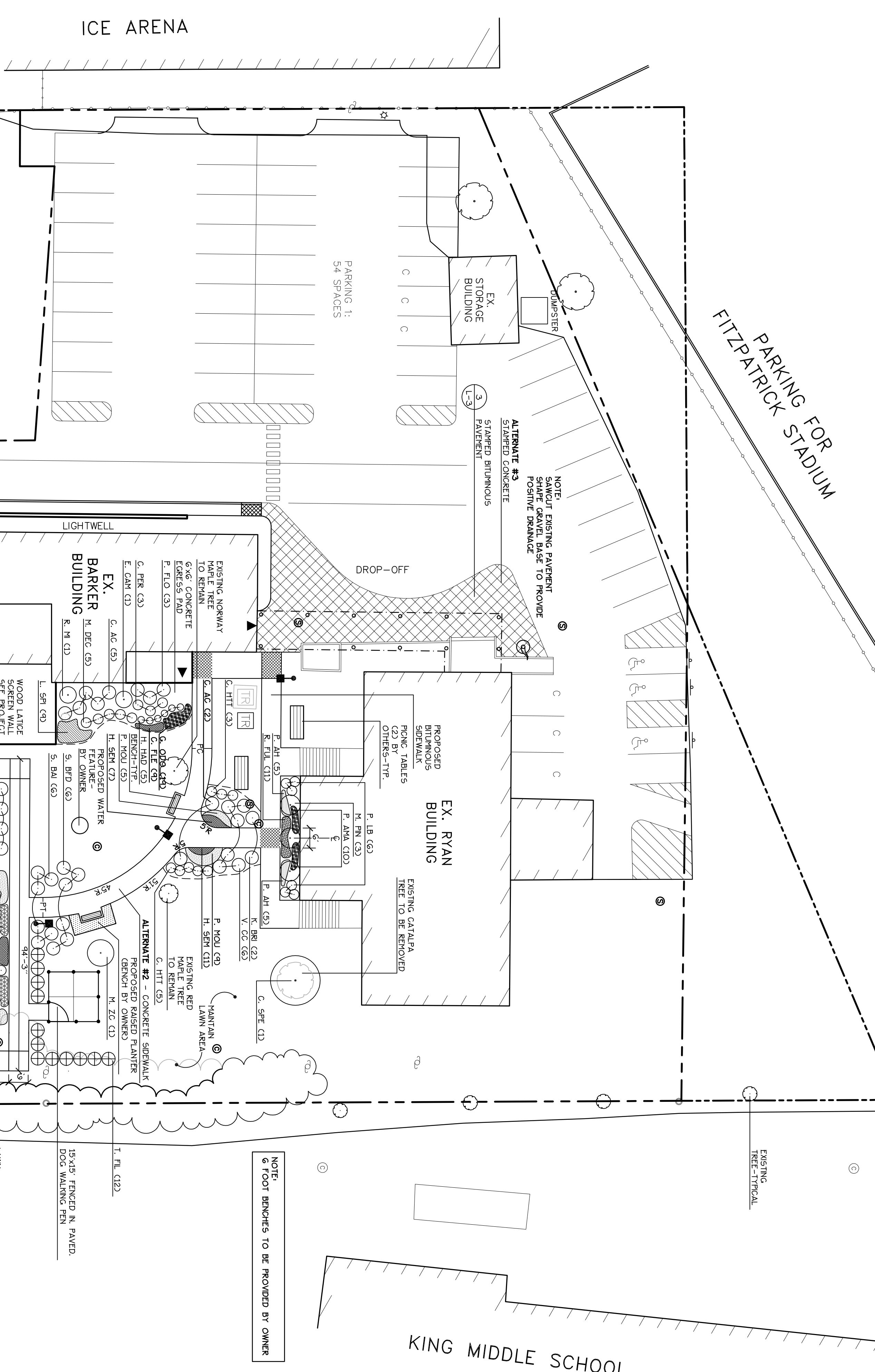

**MITCHELL & ASSOCIATES**  
LANDSCAPE ARCHITECTS

THE STAPLES SCHOOL  
70 CENTER STREET  
PORTLAND, MAINE 04101

TEL: (207) 774-4427  
FAX: (207) 874-2460

Scale: 1" = 20'

0 10 20 40 ft.

North

<p><b>PROJECT:</b> IRIS NETWORK RENOVATION &amp; ADDITIONS PORTLAND, ME 04101</p>	<p><b>OWNER:</b> IRIS NETWORK PORTLAND, ME 04101</p>	<p><b>ARCHITECT:</b> SEMPL &amp; DRANE ARCHITECTS 496 CONGRESS STREET PORTLAND, MAINE 04101 (207) 761-4231 asemple1@maine.rr.com</p>	<p><b>DRAWING:</b> PLANTING PLAN</p> <p><b>SCALE:</b> AS SHOWN</p> <p><b>DATE:</b> DECEMBER 17, 2004</p>	<p><b>REVISIONS:</b></p> <table border="1"> <tr> <td>1</td> <td>FEBRUARY 25, 2005</td> </tr> </table>	1	FEBRUARY 25, 2005
1	FEBRUARY 25, 2005					