

PLUMBING GENERAL NOTES:

- COORDINATE WORK WITH THE WORK OF ALL OTHER TRADES.
- PROVIDE FIXTURE STOPS ON WATER SUPPLY IMMEDIATELY ADJACENT TO PLUMBING FIXTURES.
- SANITARY WASTE PIPING SHALL BE INSTALLED WITH A PITCH OF 1/4" PER 1' - 0".
- ALL PIPING SHALL BE CONCEALED EXCEPT IN SPACES WHERE NO CEILINGS OCCUR.
- ALL VENT AND WATER SUPPLY SHALL PITCH TO DRAIN.
- HOT WATER & COLD WATER PIPING SHALL BE INSULATED WITH MINIMUM 1/2" INSULATION.
- THE TERM "PROVIDE" SHALL MEAN TO "FURNISH, INSTALL AND CONNECT COMPLETELY".
- OSHA RULES, REGULATIONS AND REQUIREMENTS, AND ANY STATE AND LOCAL REQUIREMENTS FOR SAFETY SHALL BE FOLLOWED BY THE CONTRACTOR.
- CONTRACTORS SHALL CONFIRM EXISTING CONDITIONS PRIOR TO THE INSTALLATION OF SYSTEMS WHICH ARE INTENDED TO TIE INTO OR RE-USE ANY PART OF OF EXISTING PIPING OR EQUIPMENT.
- ENTIRE PLUMBING INSTALLATION SHALL BE IN COMPLIANCE WITH ALL CURRENT, STATE, AND FEDERAL CODES AND STANDARDS.
- CONNECT 1/2" HW & CW, 1 1/2" VENT , 2" WASTE TO EXISTING BUILDING SYSTEMS. (COPPER - TYPE "L" @ HW & COLD WATER SUPPLY, PVC - SCHEDULE 40 @ DRAIN AND VENT - TYPICAL)

PLUMBING SPECIFICATIONS:

SINK:
 PROVIDE SINK EQUAL TO: ELKAY MODEL LRADQ2219-60-1-CR, STAINLESS STEEL, SINGLE BOWL, 6" DEEP, ONE FAUCET HOLE, CENTER REAR DRAIN, QUICK CLIP MOUNTING SYSTEM, ADA COMPLIANT.
 PROVIDE REMOVEABLE DRAIN CUP.

FAUCET:
 PROVIDE FAUCET EQUAL TO: KOHLER MODEL K-596-VS, PULL-DOWN KITCHEN SINK FAUCET, SELF CONTAINED CERAMIC DISC VALVE, SINGLE LEVER VOLUME AND TEMPERATURE CONTROL, SINGLE HOLE INSTALLATION, 1.8 gpm MAX. FLOW RATE, STAINLESS STEEL FINISH, ADA COMPLIANT.

Auburn, ME
 207.784.5100
 Portland, ME
 207.775.0053
 Manchester, NH
 603.626.1242

HARRIMAN

UNIVERSITY OF
 SOUTHERN MAINE
 55 EXETER ST. SBCD
 PROJECT 2015-011.1

PORTLAND, ME

HA Project No.	15317-01
----------------	----------

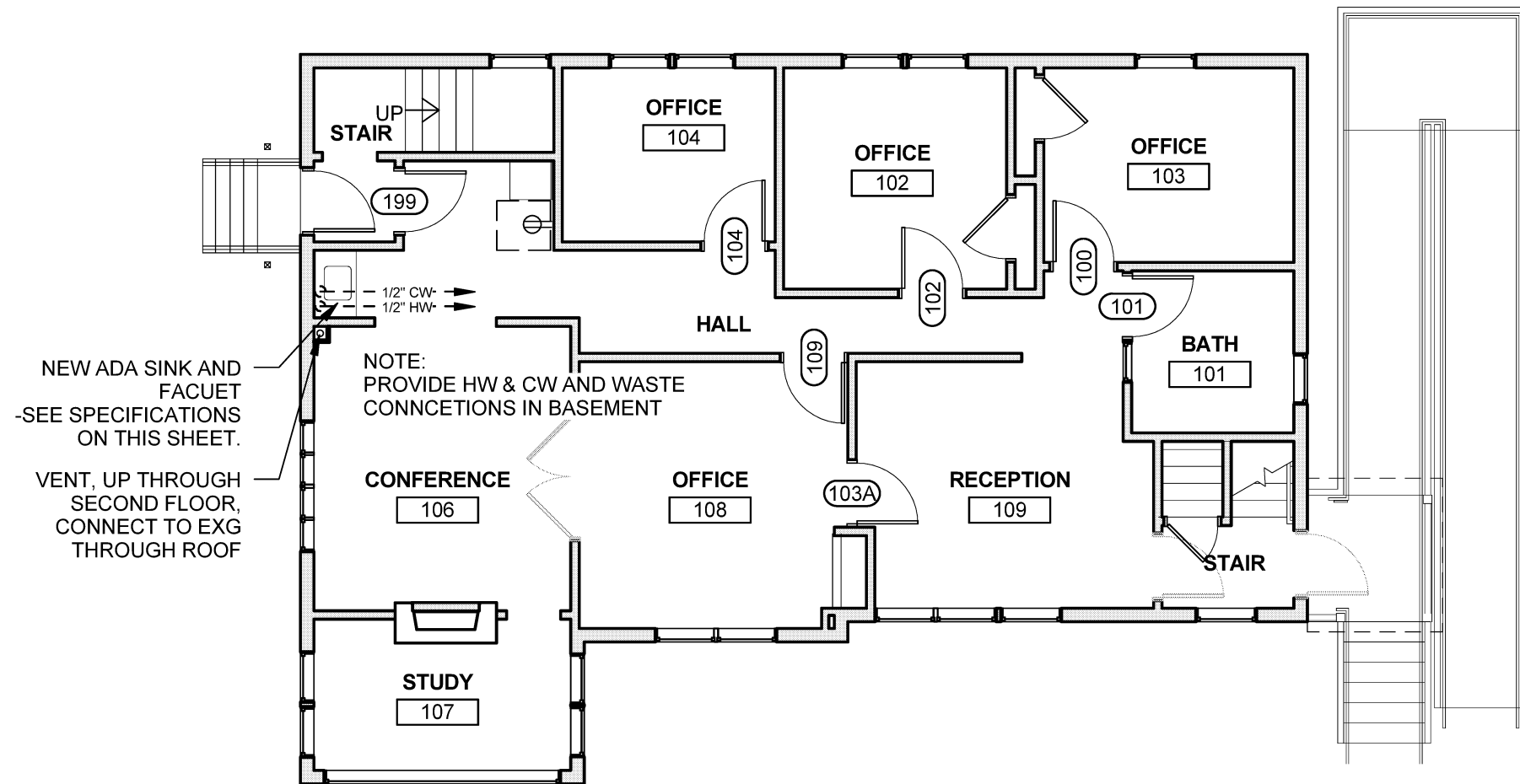
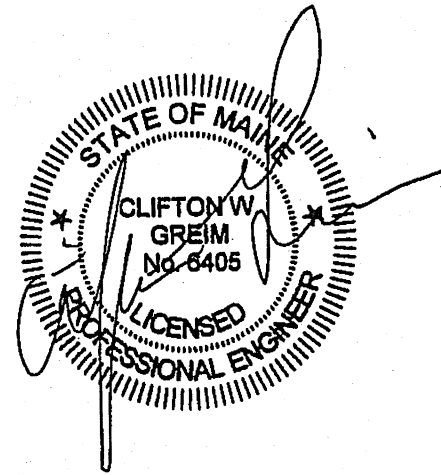

NEW ADA SINK AND FACUET -SEE SPECIFICATIONS ON THIS SHEET.
 VENT, UP THROUGH SECOND FLOOR, CONNECT TO EXG THROUGH ROOF

NOTE: PROVIDE HW & CW AND WASTE CONNCTIONS IN BASEMENT

A1 EXETER STREET - FIRST FLOOR PIPING PLAN
 SCALE: 1/8" = 1'-0"

Date	05-19-15
Scale	As indicated

05-19-15 - ISSUED FOR BID

© 2015 Harriman Associates

55 EXETER STREET -
 FIRST FLOOR PIPING
 PLAN

P10.1