

NOTE:
 REFER TO STRUCTURAL ANALYSIS REPORT & RECOMMENDATIONS BY: HUDSON DESIGN GROUP LLC. FOR THE ANALYSIS OF THE CAPACITY OF THE EXISTING STRUCTURES TO SUPPORT THE PROPOSED EQUIPMENT PRIOR TO COMMENCING CONSTRUCTION.

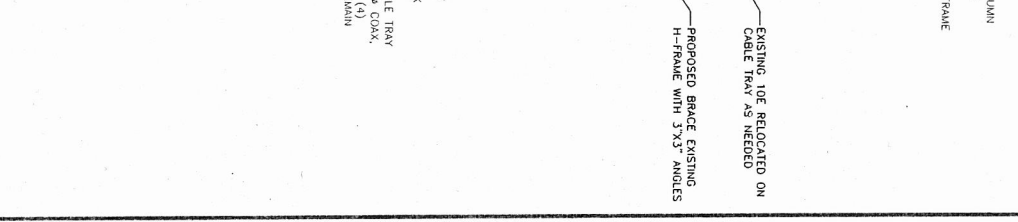
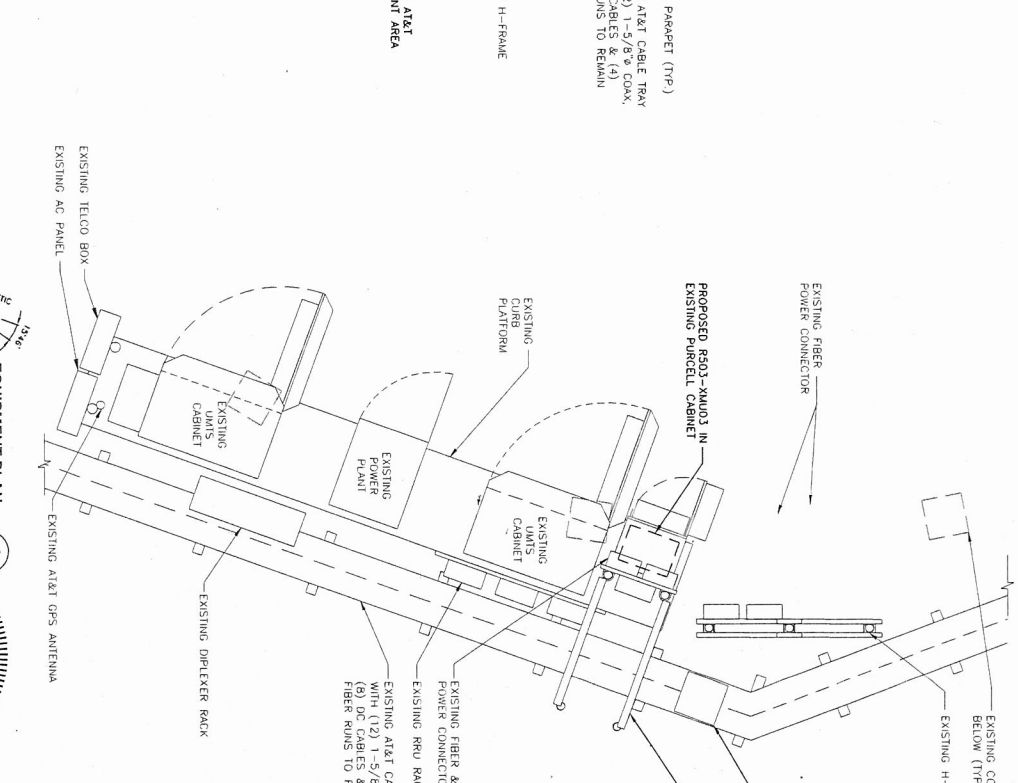
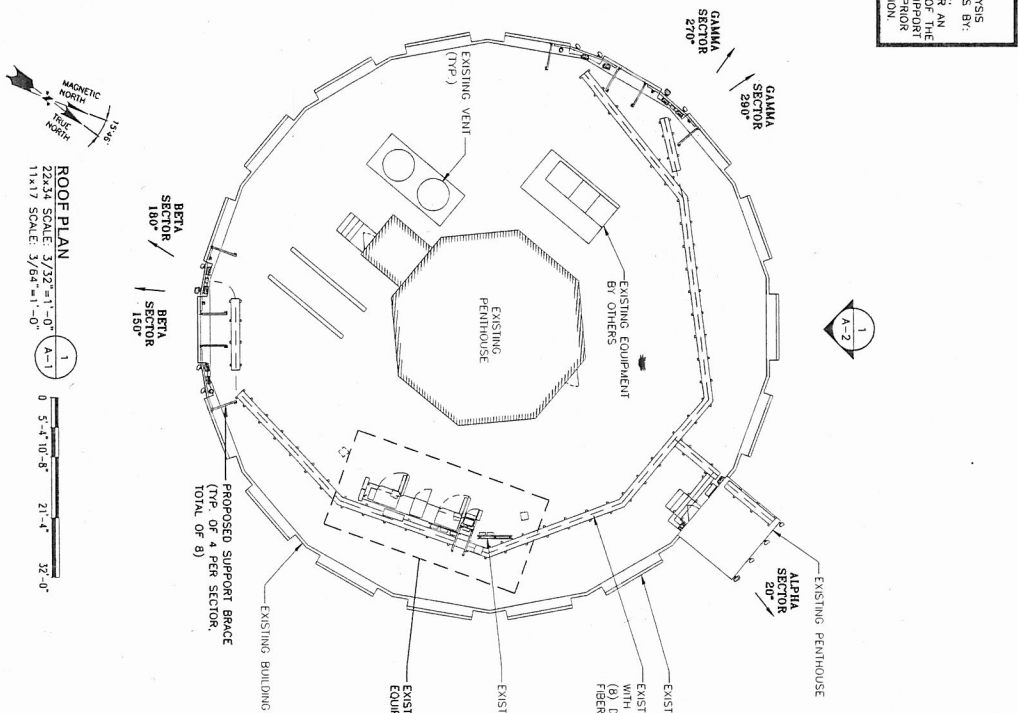

Hudson Design Group
 1400 GARDEN STREET
 HANOVER, MA 01927
 TEL: (978) 552-5333
 FAX: (978) 552-5335

EMPIRE telecom
 16 ESQUIRE ROAD
 BILLERICA, MA 01862
 TEL: (978) 608-8400

SITE NUMBER: MEO045
SITE NAME: PORTLAND USM
 206 UERING AVENUE
 PORTLAND, MA 01763
 CUMBERLAND COUNTY

at&t
 550 COCHUWATE ROAD
 FRAMINGHAM, MA 01701

NO.	DATE	ISSUED FOR	REVISIONS	DESIGNED BY	IN CHARGE	CHECKED BY	DATE
1	03/02/16	ISSUED FOR CONSTRUCTION					
2	01/20/16	ISSUED FOR REVIEW					

SCALE: AS SHOWN

PROJECT	ROOF & EQUIPMENT PLAN
DATE	(LITE AC 2016)
REVISION NUMBER	
REVISION NUMBER	
REV	