

37 DEANE STREET
NEW CONSTRUCTION | SINGLE-FAMILY HOUSE

OWNER
Juli Gazak
Passive Works, LLC
89 Willow Street
South Portland, ME 04106
E-MAIL: juli.gazak@gmail.com
PHONE: 972.262.0003



DEXTRIOUS CREATIVE

PORTLAND, ME 04102
TRACIE REED, ARCHITECT
N2AB, N/A, LEED AP BD+C
traciereed@dextrouscreative.com
207.493.0459 (cell)

PROJECT TEAM

CIVIL ENGINEERING
Ross A. Gaudin, P.E., M.E., M.H.V.T.
C.P.E.S.C., C.P.S.W.G., C.E.S.S.W.I.
Engineering Assistance & Design, Inc. (E.A.D.)
10 North Road
Yarmouth, Maine 04096
Phone: 207-946-0839
Mobile: 207-939-7603
r.gaudin@maineaz.com

STRUCTURAL ENGINEER
Larry Wichroski, P.E.
Engineering Design Professionals
P.O. Box 575
Frogport, Me 04032
T: 207-963-5000
LW@larryw.com

GEOTECHNICAL ENGINEER
Steve Marcotte, C.G., P.G., L.S.E.
Sevee & Maher Engineers, Inc.
4 Standard Rd
Cumberland Center, ME 04021
T: 207-929-5016
C: 207-929-9000
sm@sevee.com

LANDSCAPE ARCHITECT
Tony Cowles
Maine Licensed Landscape Architect
Cowles studio Landscape architecture
T: (207) 415-4332
tony@cowles-studio.com

GENERAL CONTRACTOR
Josh Wojcik
Upright Frameworks
School St, Wilton, ME 04294
T: (207) 749-3066
jwojck@uprightframeworks.com

No.	Description	Date

GARAGE LEVEL PLAN

Project number: 16-16_73 Cumberland

Date: 06.02.16

Drawn by: Author

Checked by: Checker

A-1.1

Scale: 1/4" = 1'-0"

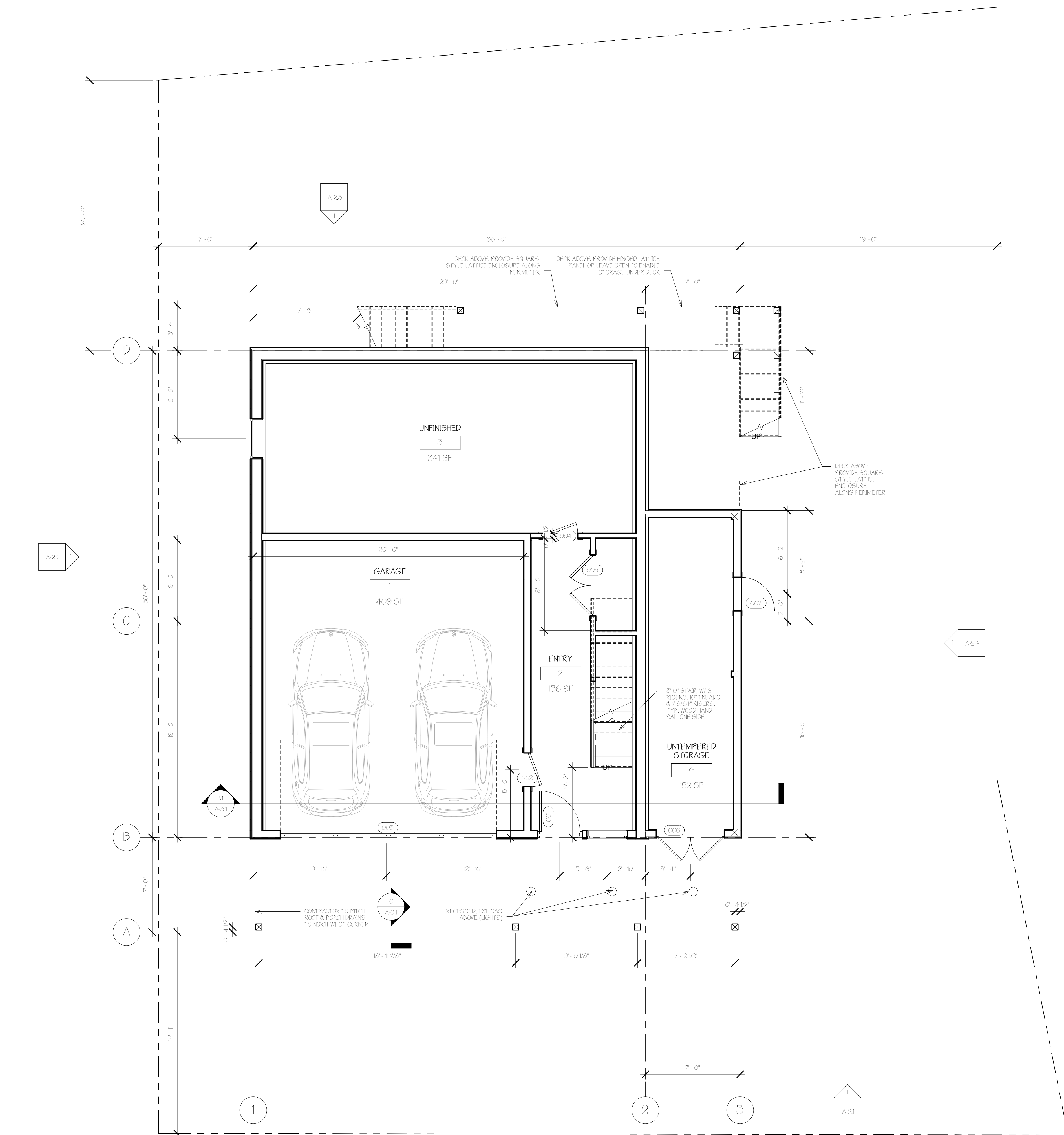

1 Garage Level
1/4" = 1'-0"

