

992/9

MONUMENTATION

- MF 1 BROKEN OFF 8"X8" GRANITE MONUMENT FOUND, ON 3' OFFSET, 1' UNDER DRIP BOX, NORTHWEST CORNER WASHBURN/ST. JOHN...

- MF 713 3/4" IRON PIPE FOUND, 20" LONG, BENT NORTHERLY & FLUSH TO GROUND, LOCATED 6" BELOW GROUND, BEHIND OLD FIRE STATION BUILDING...

GENERAL NOTES

- 1. THIS PLAN IS INTENDED TO CONFORM WITH THE CURRENT STATE LICENSING BOARD STANDARDS FOR A STANDARD BOUNDARY SURVEY...

- 16. THIS PROPERTY IS SUBJECT TO THE FOLLOWING EASEMENTS OF RECORD: TO CENTRAL MAINE POWER COMPANY, 0229 849/018...

LEGEND

- CAPPED 5/8" IRON REBAR SET
IRON PIPE/ROD FOUND
MONUMENT FOUND
"X" MONUMENT FOUND

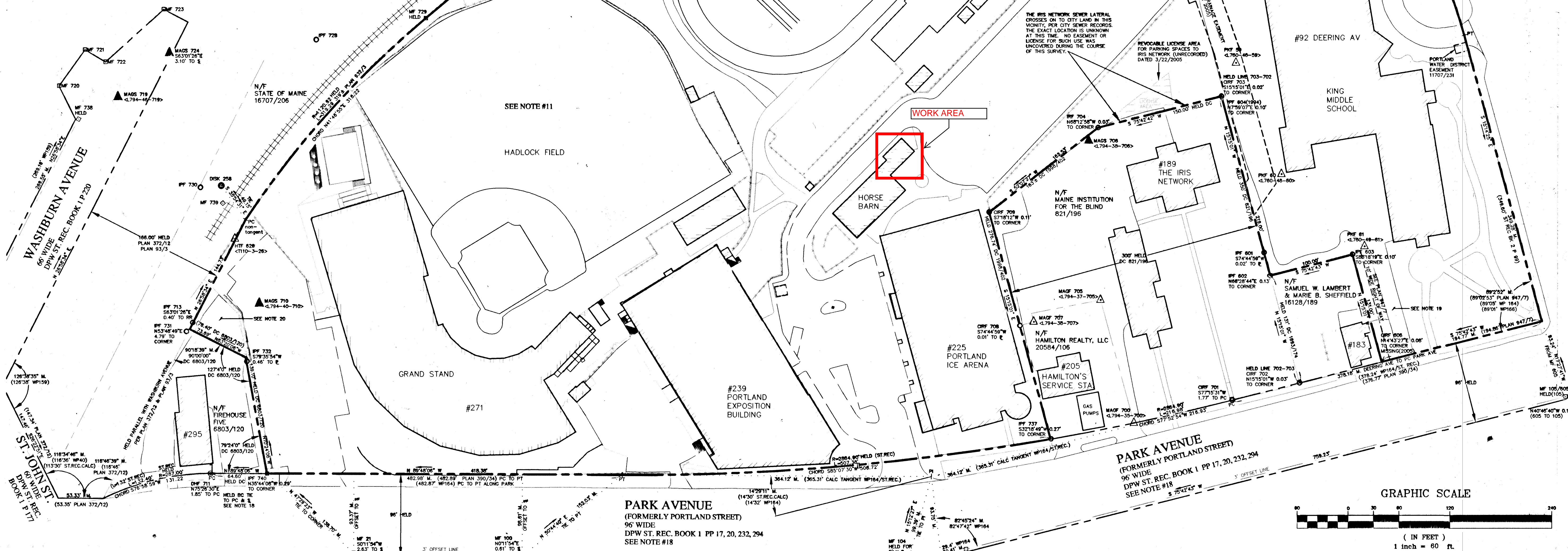

PLAN SHOWING A STANDARD BOUNDARY SURVEY MADE FOR THE IRIS NETWORK PARK AVENUE, BY THE IRIS NETWORK SURVEYING COMPANY, INC. DATED 06/03/04

BOUNDARY LINE RETRACEMENT PLAN FOR HADLOCK FIELD FITZPATRICK STADIUM PORTLAND ICE ARENA PORTLAND EXPOSITION BUILDING KING MIDDLE SCHOOL

CITY OF PORTLAND, MAINE PUBLIC WORKS DEPARTMENT ENGINEERING SECTION SHEET 1 OF 1

992/9