

**CITY OF PORTLAND, MAINE  
Portland Exposition Building Drainage Improvements  
Bid #5709**

**Current Date: March 11, 2009**

The attention of firms submitting proposals for the work named in the above Invitation is called to the following modifications to the documents as were issued.

The items set forth herein, whether of clarification, omission, addition and/or substitution, shall be included and form a part of the Contractor's submitted material and the corresponding Contract when executed. No claim for additional compensation, due to lack of knowledge of the contents of this Addendum will be considered.

\*\*\*\*\*

**ALL BIDDERS ARE ADVISED THAT RECEIPT OF THIS NOTICE MUST BE DULY ACKNOWLEDGED ON THE BID PROPOSAL FORM OR BY THE INSERTION OF THIS SHEET, SIGNED, AND SUBMITTED WITH YOUR PROPOSAL.**

\*\*\*\*\*

**MATTHEW F. FITZGERALD  
PURCHASING MANAGER**

---

**NOTE: The following is a response to questions recently received on this bid:**

1. *Does the contractor pay for materials testing? - Plan sheet S-01 note under general requirements reads (paid for by owner) while specifications book does not delegate such?*

City (Owner) will perform Construction Materials Testing/Quality Control Testing, including but not limited to Soil Compaction and Concrete at no cost to the CONTRACTOR. Any (re)testing of CONTRACTOR's work determined to be deficient by failed test results shall be paid for by CONTRACTOR at no additional cost to the City. CONTRACTOR shall be responsible for all necessary Quality Assurance with aim to assure that quality is built into work. CONTRACTOR shall evaluate implementation and effectiveness of processes used to complete work and make modifications as necessary at no additional cost to the City.

2. *What shall proposed width of cast-in-place concrete 4" thick ramp be? - 11' - 11 1/2" per plan sheet S-01 landing and ramp plan interpolation or 11' 4" wide per plan sheet S-03 ramp detail scaled interpolation?*

The proposed width of the 4" thick cast-in-place concrete ramp shall be 12'-0" as dimensioned on S-01.

3. *Is Stone Strong or Redi-Rock an approved alternate/equivalent to CastleBlock?*

Stone Strong is NOT an approved alternate/equivalent; hollow precast units are not acceptable. Redi-Rock IS an approved alternate/equivalent. Other solid precast concrete units should be submitted to City for review and consideration prior to bidding.

4. *Per Plan Sheet C-01 proposed site plan note "provide new area drain rim 28.8 (local low point) inv. El 20.4 (6" perf. PVC) – what type of structure is this - need construction detail if possible, or description?*

Response 4) Area drain shall be Nyloplast by ADS 12" Inline Drain with 12" Standard H-20 Rated Grate with Riser and Tee , or approved equal. Inline Drain shall be installed in H-20 compliant manner as recommended by ADS, on and backfilled with a minimum of 12" of 3/4" crushed stone.

5. *Does the City of Portland provide a list of potential landowners and or sites that can accept waste excavation produced from this project?*

DELETE Paragraph 18-Waste Material within Special Provisions General, and REPLACE with the following:

18. Waste Material: All demolition and construction waste material shall be removed from the site and the area left clean upon completion of work. Any equipment or structures damaged by the CONTRACTOR shall be repaired or replaced at no additional cost to the City. All demolition and construction waste material not reused or resold by the CONTRACTOR must be disposed of at the City of Portland's Riverside Recycling Facility. Transportation and disposal fees associated with the proper disposal of all waste materials generated by the project at Riverside are the responsibility of the CONTRACTOR. Location and contact information for Riverside Recycling Facility is as follows:

Riverside Recycling Facility  
910 Riverside Street  
Portland, ME 04103  
(207) 797-6200

6. *Is there an engineer's estimate / range of cost for this project?*

An engineer's estimate is not available for this project.

7. *Is there a requirement for how long the existing steel fire escape can be removed, and the proposed galvanized ramp system be installed? What special provisions shall be required to cordon off the area - doorways leading to the fire escape area?*

During construction, there are no limitations to the length of time the existing fire escape can be out of service. The City will secure and barricade all doorways opening into the construction area from the Exposition Building for the duration of construction. The area within the "Limit of Construction" depicted on Sheet C-01 shall be the responsibility of the CONTRACTOR, including the need to coordinate with the City. This responsibility and compliance with all applicable OSHA Rules, Regulations, and Guidelines are that of the CONTRACTOR and shall be performed at no additional cost to the City.

8. *Is it acceptable to use a portion of the existing parking area(s) adjacent to work site as a material (aggregate storage / lay down of precast - rebar. etc.)?*

CONTRACTOR may utilize the gravel area between the Horse Barn and the Exposition building for staging material. The area shall be available to the CONTRACTOR through Substantial Completion. At Substantial Completion, the area shall be restored to the pre-construction condition by the CONTRACTOR at no additional cost to the City. Any damage caused by the CONTRACTOR as result of their operations shall be restored at no additional cost to the City; the City's decision regarding need for restoration shall be final.

9. *Would you please provide us a pre-bid attendance list for the mandatory pre-bid meeting March 4, 2009 at 10:00 a.m. at the Portland Expo Building?*

List of pre-bid attendees attached for your reference.

10. *Shall existing 6" roof drain as depicted on plan sheet C-01 be incorporated into proposed 6" underdrain system?*

Response 10) Roof drains were previously re-routed by the City; the four (4) 6" roof drains as depicted on the plans are not in use, and were abandoned in place. In a manner acceptable to the City, CONTRACTOR shall coordinate with City and patch the Exposition building wall where pipes will be removed (by City).

11. *Will a detail for construction be provided for proposed "castleblock" segmented block retaining wall system?*

Design and Detail shall be provided by the Manufacturer, see Note 2 on Sheet C-01. Design shall be stamped and signed by a Maine Licensed Professional Engineer.

The following changes and additional information are hereby made a part of the Contract Documents:

Plans:

Sheet C-01: New Catch Basin shall be per attached Typical Catch Basin Detail, and in accordance with City of Portland Manhole and Catch Basin General Notes.

Sheet C-01: CONTRACTOR shall relocate the Oil Tank Fill, Oil Tank Vent, and Oil Tank Alarm in accordance with applicable codes and regulations, and as directed by City at no additional cost to the City.

**CITY OF PORTLAND, MAINE**  
**Portland Exposition Building Drainage Improvements**  
**Bid #5709**

Receipt of **Addendum No. 1** to the City of Portland's **Bid#5709: Portland Exposition Building Drainage Improvements** is hereby acknowledged.

COMPANY: \_\_\_\_\_

NAME: \_\_\_\_\_

SIGNED BY: \_\_\_\_\_ DATE: \_\_\_\_\_

PRINT NAME & TITLE: \_\_\_\_\_

ADDRESS: \_\_\_\_\_

\_\_\_\_\_

Zip Code

**CITY OF PORTLAND, MAINE**  
**Portland Exposition Building Drainage Improvements**  
**Bid #5709**

**Pre-bid Conference List of Attendees**

<b>Attendee</b>	<b>Company Name</b>	<b>Phone</b>
Kevin Aceto	Aceto Construction	(207) 324-5041
Mike McKinley	Gorham Sand & Gravel	(207) 839-2442
Steven Piela	Glidden Excavating & Paving	(207) 856-9990
Brian MacFawn	T. Buck Construction	(207) 783-6223
Gary Keniston	Rainmaker	(207) 878-7890
Rene Perron	D&C Construction	(207) 247-6023
Steve Stuart	R.N. Willey Excavating	(207) 655-7345
Keith Gray/Bill Bradshaw	R.A. Paradis & Son Inc.	(207) 368-5432
Joe Perryman	St. Laurent & Son	(207) 784-7944
Rob Storey	Storey Brothers, Inc.	(207) 829-4282
Stephen Reno	Reno's Excavation	(207) 442-0581
Maietta Construction	Craig Babbidge	(207) 883-9546
Brian Shaw	Shaw Earthworks, Inc.	(207) 894-5025
Rob Owens	Peters Construction, Inc.	(207) 653-9652

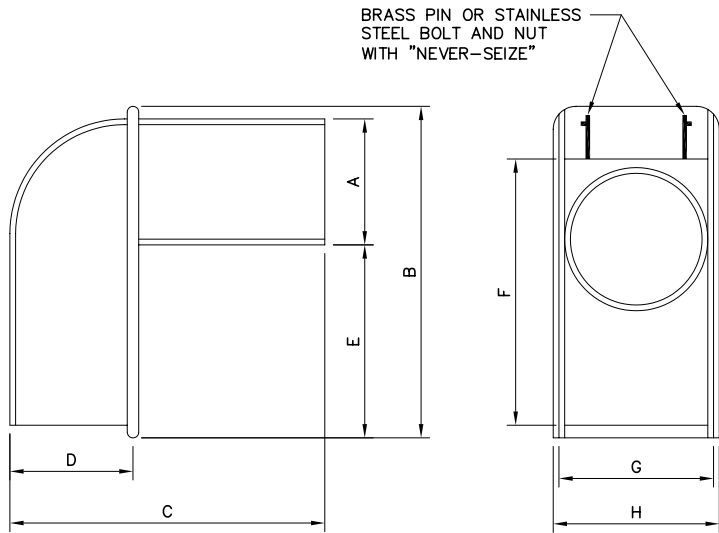

SIZE	A	B	C	D	E	F	G	H
12"	11 1/2"	17"	22"	8"	3 1/2"	17"	12 1/2"	13 3/8"

**NOTE:**

1. BOLT AND NUT REQUIRED WHERE HOOD WILL NOT OPEN COMPLETELY
2. 18" CATCH BASIN TRAP SHALL BE NEENAH FOUNDRY R-3701-18, OR EQUAL

**CASCO TRAP DETAIL**  
N.T.S.

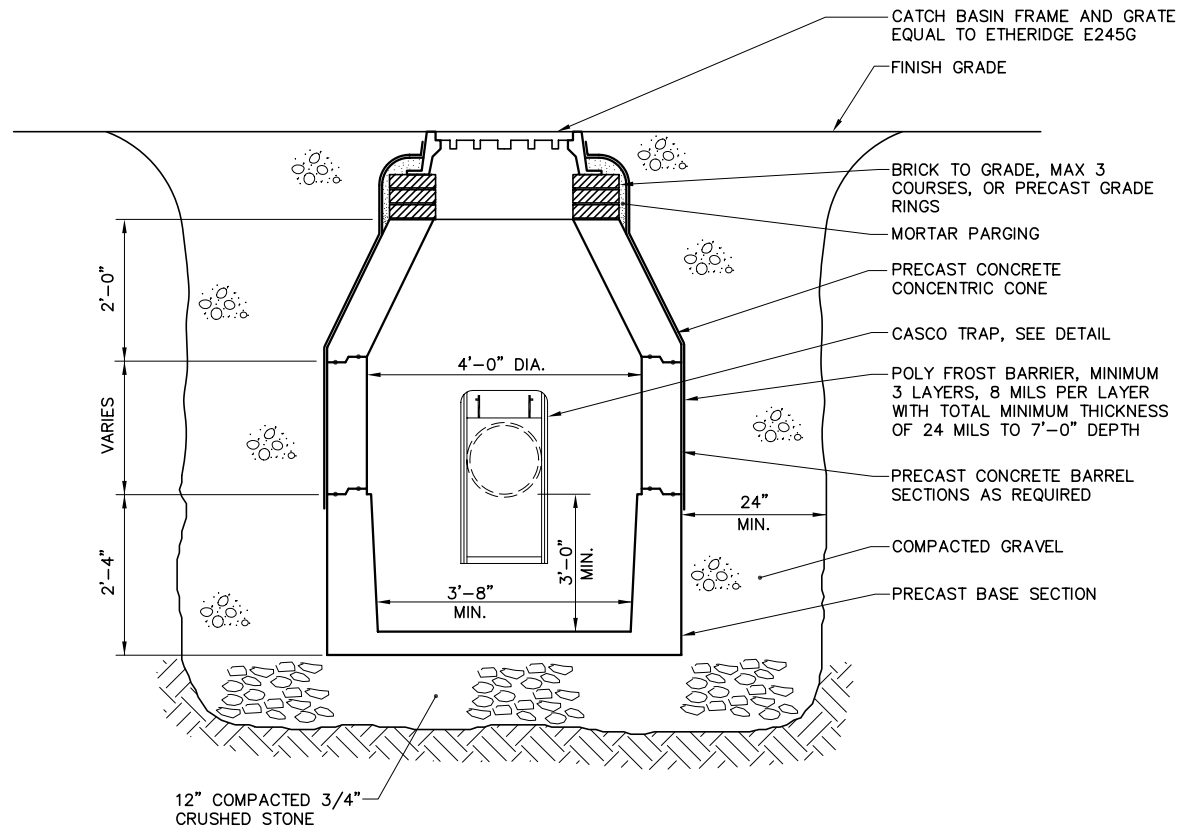

**TYPICAL CATCH BASIN**  
N.T.S.

## CITY OF PORTLAND MANHOLE AND CATCH BASIN GENERAL NOTES

1. ALL CONCRETE SHALL BE CLASS "A" AND HAVE A MINIMUM ULTIMATE STRENGTH OF 4,000 lbs. PER SQ. INCH AT THE END OF 28 DAYS, UNLESS OTHERWISE NOTED.
2. PRECAST REINFORCED CONE BARREL MANUFACTURE PER ASTM SPEC. C-478-67.
3. SEWER BRICK TO CONFORM TO ASTM SPECIFICATION DESIGNATION C-32-63, GRADE MA AND SA.
4. ALL MANHOLES SHALL HAVE A BITUMINOUS WATERPROOFING APPLIED TO THE EXTERIOR SURFACE. IF CONSTRUCTION OF BRICK MASONRY, THE SMOOTH MORTAR SURFACE SHALL BE PLASTERED WITH A SMOOTH MORTAR FINISH  $\frac{3}{8}$ " THICK. AFTER THE MORTAR HAS SET, THE SURFACE SHALL BE WATERPROOFED AS REQUIRED BY CITY OF PORTLAND DESIGN STANDARDS.
5. CASTINGS SHALL CONFORM TO ASTM DESIGNATION A48-CLASS 35. ALL PARTS OF CASTINGS, EXCEPT FINISHED SURFACE, SHALL RECEIVE A COAT OF COAL TAR PITCH VARNISH OR ASPHALTUM PAINT WHICH SHALL BE SMOOTH AND TOUGH BUT NOT BRITTLE.
6. MANHOLES MAY BE CONSTRUCTED OF BRICK MASONRY, PRECAST REINFORCED CONCRETE, OR CAST IN PLACE.
7. ALL PRECAST MANHOLES AND CATCH BASINS SHALL BE IDENTIFIED BY STATION AND OFFSET PAINTED ON THE SIDE OF THE THE STRUCTURE BY THE MANUFACTURER.
8. STORM AND SEWER MANHOLES SHALL HAVE SOLID COVERS WITH ONE DRILLED HOLE.
9. EXISTING MANHOLE AND CATCH BASIN FRAMES AND COVERS SHALL BE SALVAGED BY THE CONTRACTOR, AND REMAIN THE PROPERTY OF THE CITY OF PORTLAND.