

3 EDGE DETAIL AT OVERHANG 1/2" = 1'-0"

4 EDGE DETAIL AT RAKE 1/2" = 1'-0"

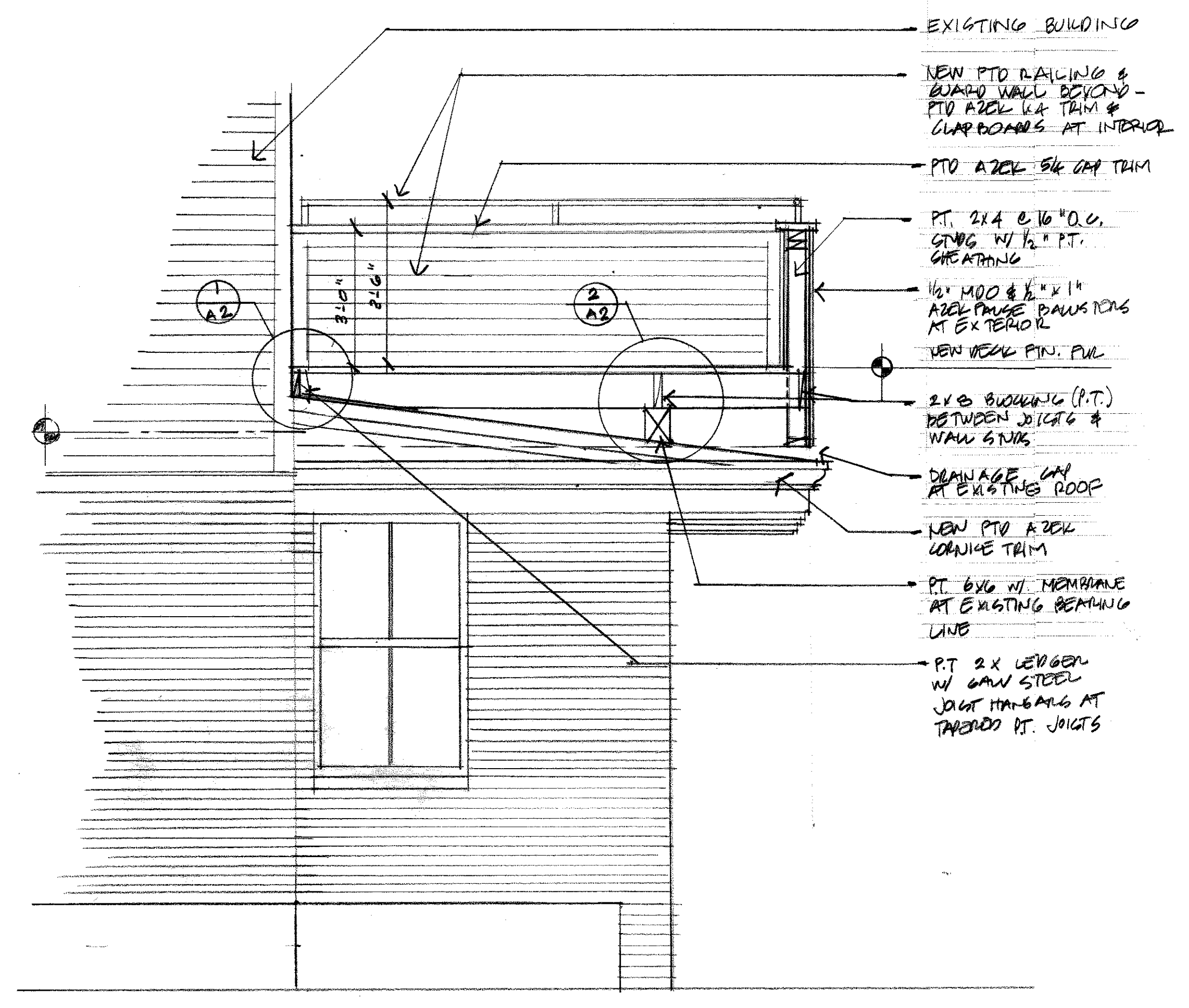

SECTION AT DECK FRAMING 1/2" = 1'-0"

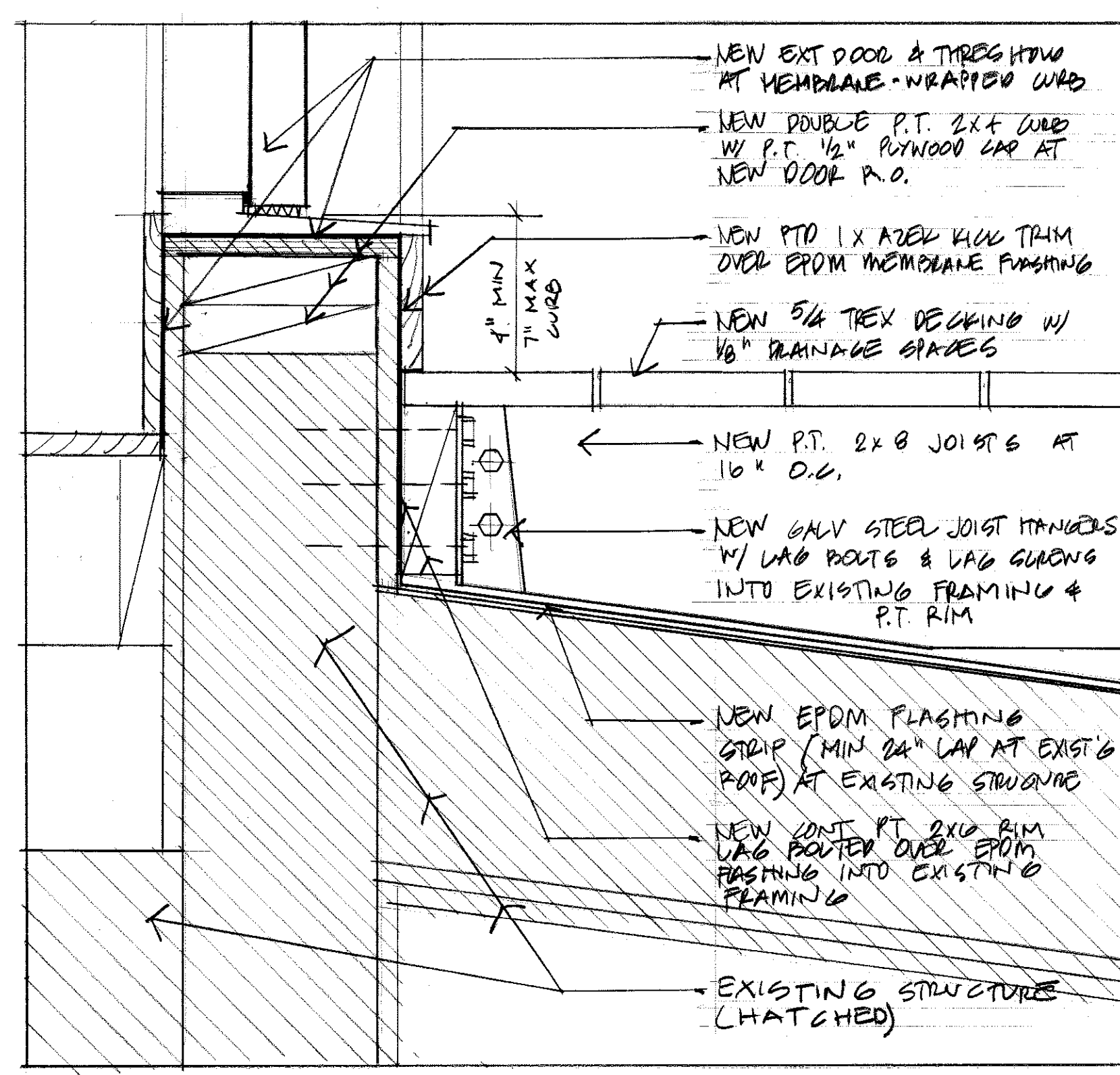

1 DECK DETAIL AT EXISTING WALL 3" = 1'-0"

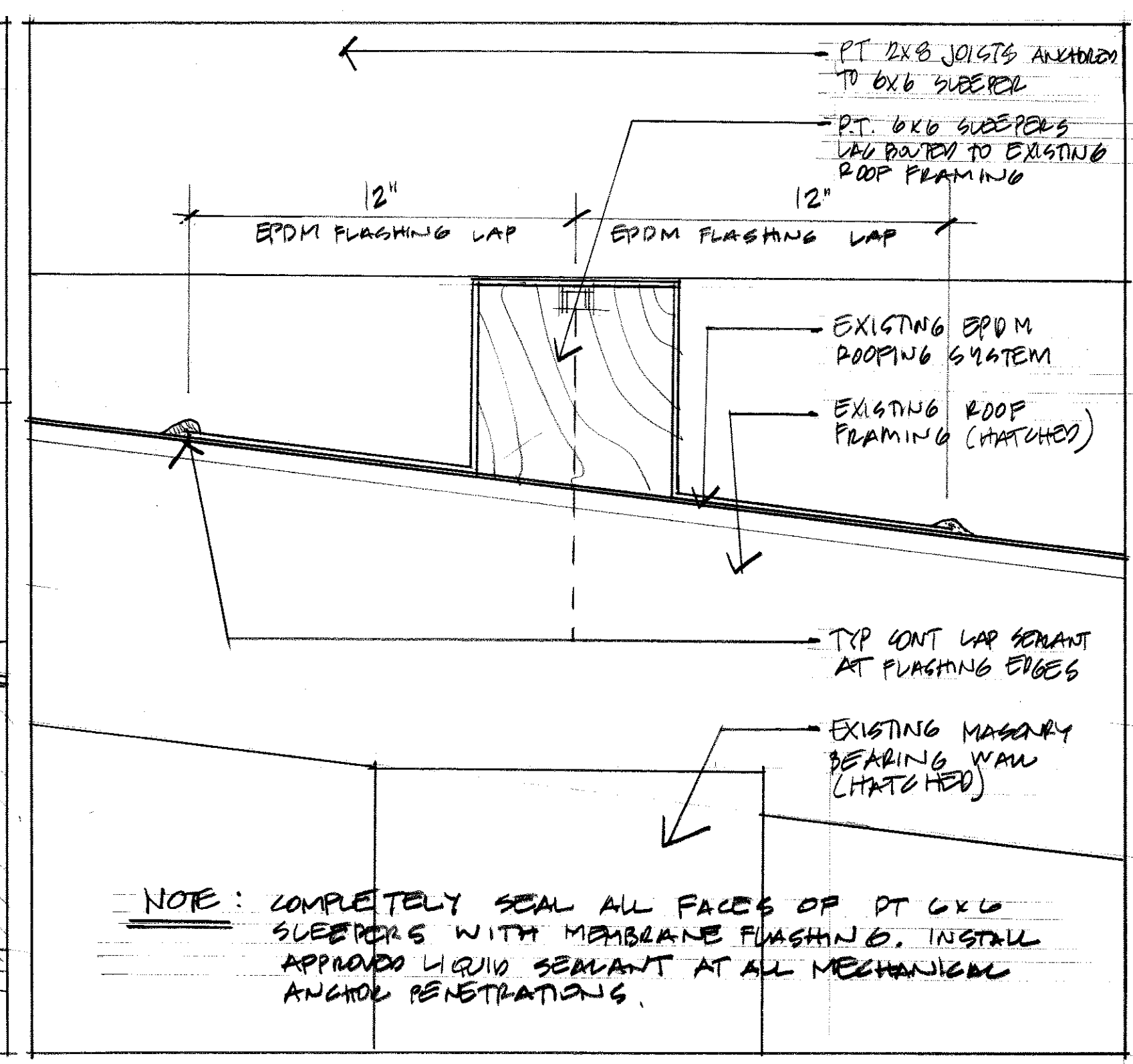

2 DECK BEARING WALL DETAIL 3" = 1'-0"

NOTE: COMPLETELY SEAL ALL FACES OF PT 6x6 SLEEPERS WITH MEMBRANE FLASHING. INSTALL APPROVED LIQUID SEAMANT AT ALL MECHANICAL ANCHOR PENETRATIONS.

GRANT HAYS ASSOCIATES
 ARCHITECTURE & INTERIOR DESIGN
 P.O. BOX 6179 FALMOUTH MAINE 04105
 207.871.5900 www.granthays.com

Michael F. Hays
 No. 1724
 STATE OF MAINE
 LICENSED ARCHITECT

REV/10/17

DRAWING NAME
 OWNER: JASON STANKIEWICZ
 NEW DECK AT
 521 CUMBERLAND AVE, UNIT 4
 PORTLAND, MAINE 04101

FRAMING PLAN & SECTION

DATE: 7 APRIL '15
 SCALE: AS NOTED
 DRAWN: MFI
 JOB NO.: 150407
 SHEET: A.2

COPYRIGHT REPRODUCTION OR USE OF THIS DOCUMENT WITHOUT WRITTEN PERMISSION FROM GRANT HAYS ASSOCIATES IS PROHIBITED.