

GENERAL NOTES

1. ALL WORK SHALL CONFORM TO LOCAL AND STATE CODES AND THE N.E.C.
2. MINIMUM WIRE SIZE SHALL BE #12AWG COPPER. ALL REFERENCE TO WIRE SIZE IS INTENDED AS COPPER. CIRCUIT BREAKER SIZE (AS PER PANEL SCHEDULE) SHALL DICTATE WIRE SIZE OF ALL CONDUCTORS.
3. THE ENTIRE ELECTRICAL SYSTEM SHALL BE GROUNDED BY MEANS OF A SEPARATE GROUND CONDUCTOR. CONDUIT SHALL NOT BE CONSIDERED A GROUND CONDUCTOR, BUT SHALL BE GROUNDED. (USE TABLE 250-95 IN N.E.C.)
4. OUTLETS BACK TO BACK WITHIN 24 INCHES OF EACH OTHER IN FIRE RATED WALLS, SHALL BE ENCASED WITH FIRE RATED BACKER.
5. THIS CONTRACTOR SHALL MAINTAIN THE INTEGRITY OF FIRE RATED WALLS BY SEALING ALL WIRING, CONDUIT, ETC., WHICH PASSES THROUGH SUCH WALLS WITH AN APPROVED FIRE RATED SEALANT.
6. DIAGRAMS DO NOT NECESSARILY SHOW ALL ITEMS INCLUDED IN THE SYSTEM. REFER TO FLOOR PLANS, ETC., FOR COMPLETE SYSTEM.
7. APARTMENT SMOKE DETECTORS SHALL BE CIRCUITED FROM RECEPTACLE CIRCUIT
8. DISCONNECT, REMOVE AND/OR RELOCATE ALL EXISTING ELECTRICAL EQUIPMENT, FEEDERS, AND BRANCH CIRCUITS WHICH AFFECT OR ARE AFFECTED BY THE NEW CONSTRUCTION.
9. ALL ELECTRICAL EQUIPMENT THAT IS NOT TO BE REUSED WITH THE NEW CONSTRUCTION IN AREAS THAT ARE BEING RENOVATED, SHALL BE REMOVED. THIS INCLUDES ALL EXISTING LIGHTING FIXTURES, DEVICES, WIRING, EXPOSED CONDUIT, ETC.
10. ALL EXPOSED WIRING IN FINISHED AREAS SHALL BE IN WIREMOLD (OR APPROVED EQUAL).
11. FIREALARM SYSTEM SHALL BE THE ADDRESSIBLE TYPE WITH BACK UP NICAD BATTERY.

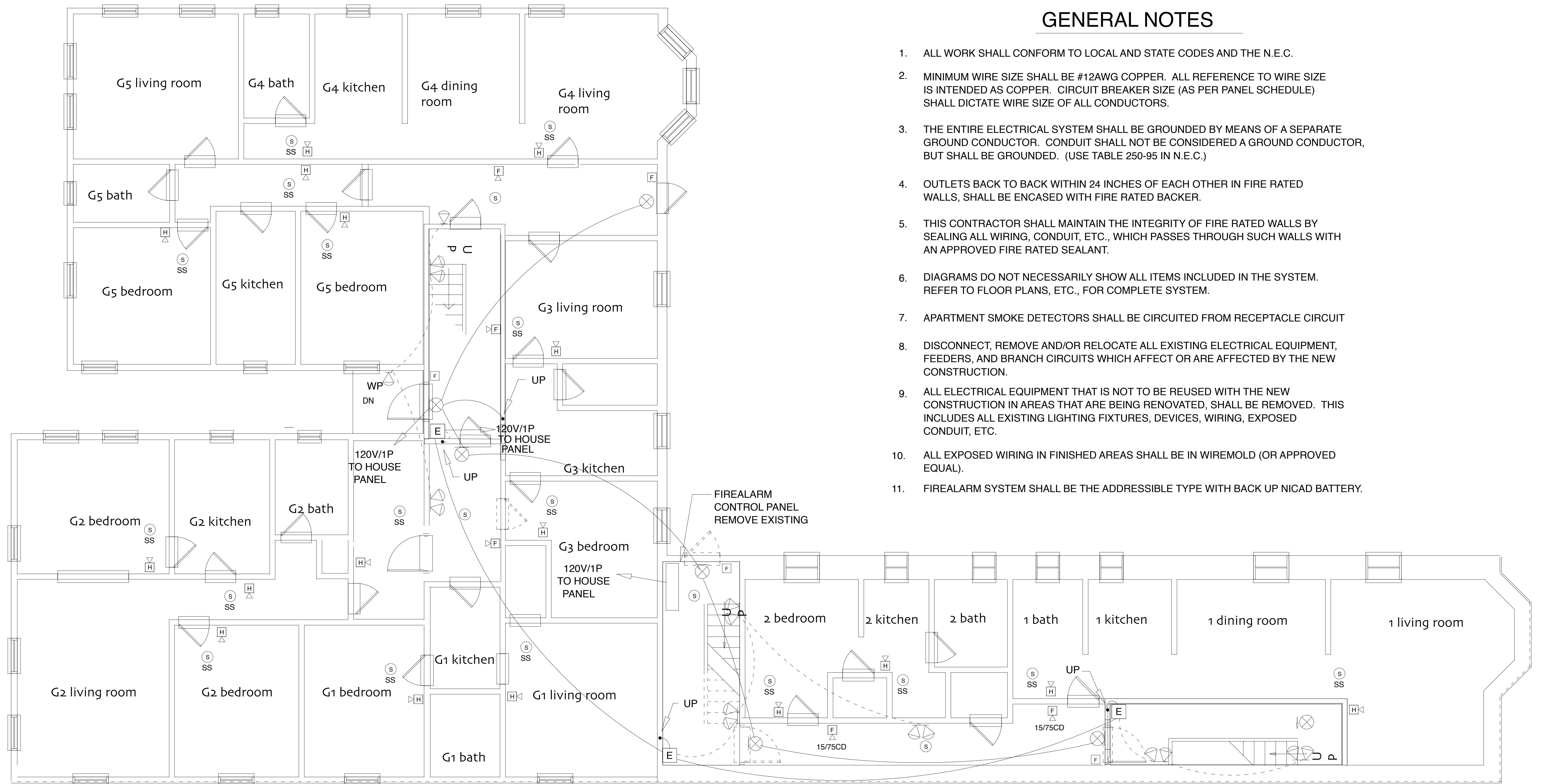

James Sterling
AIA
Architect
Studio
Mnemosyne
142 High Street
Portland, Maine

scale 1/4" = 1'-0"

551-553 CUMBERLAND AVENUE
GROUND FLOOR

E-0.1 8/27/09