

SECTION D  
S2-2 3/4"=1'-0

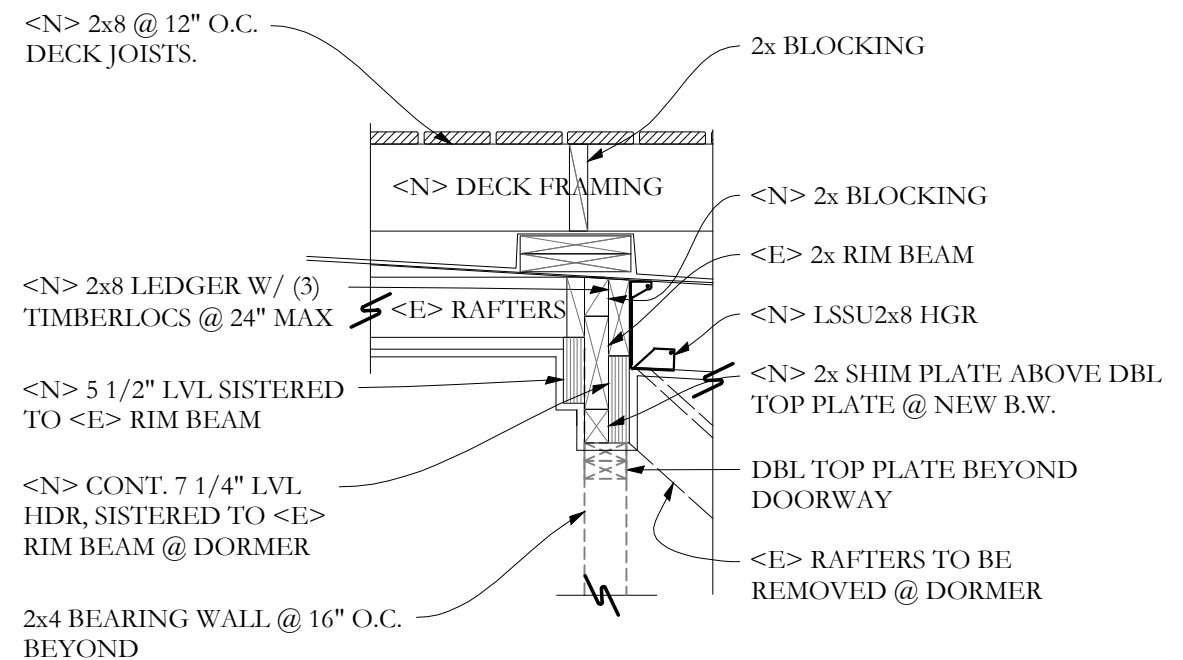

SECTION E  
S2-2 3/4"=1'-0

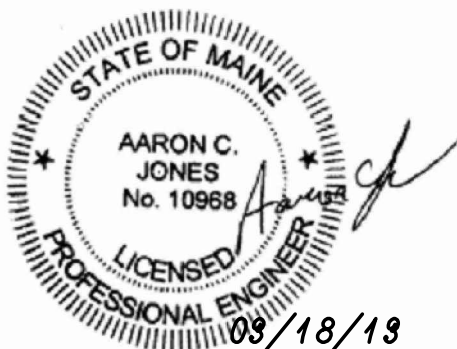

**Structural Integrity**  
Consulting Engineers, Inc.

77 Oak Street  
Portland, ME, 04101  
p. 207-774-4614  
f. 866-793-7835  
[www.structuralinteg.com](http://www.structuralinteg.com)

ARCHITECTURE, PRESERVATION + DESIGN

500 CONGRESS STREET  
PORTLAND, MAINE 04101  
TEL 207.772-2722

SI # 13-0027

BUILD WITH CONFIDENCE  
© 2012 Structural Integrity Consulting Engineers, Inc.

**BARBÄ+WHELOCK**

Project No: 2013XX  
Date: 03/18/2013

Title: SECTIONS  
Issued For/Revisions:  
1. 03/18/2013 PERMIT  
2. 03/29/2013

Drawing No:  
**S2-2**