

<N> (3) 7 1/4" LVL (FLUSH) BEAM BELOW THE POST ABOVE SHOWN.

ADD 2x BLOCKING BETWEEN JOISTS @ B.W. ABOVE -TYP

HATCH INDICATES B.W. BELOW -TYP.

HATCH INDICATES B.W. ABOVE -TYP.

HATCH INDICATES ADDITIONAL 5 1/2" LVL SISTERED TO EXISTING JOISTS THIS AREA ONLY.

FASTEN NEW SISTERS W/ (2) 10d @ 12" O.C. -TYP UNO.

(3) 6" TIMBERLOC SCREWS IN JOISTS @ ENDS WHERE NEW LVL HEADER CUTS.

MEND <E> POST WITH 2x6's AS NEEDED TO ACHIEVE TRIPLE STUD BEARING.

<N> (3) 7 1/4" LVL [FLUSH TOP] W/ TRIPLE STUD PACK EA END IF EXISTING BEARING WALL TO BE REMOVED.

<N> 2x6's SISTERED TO <E> 2x8 @ 2'-0" O.C. -TYP



### 3rd FLOOR STRUCTURAL REPAIR PLAN

**NOTES:**

SCALE 3/16"=1'-0"

- SEE SHEET S-1.0 FOR GENERAL NOTES AND FRAMING SYMBOLS KEY.
- CONTRACTOR TO SHORE FRAMING AS NEEDED TO MAKE REPAIRS.
- FLOOR SHEATHING SHALL BE GLUED AND SCREWED. TWO LAYERS RECOMMENDED.
- NOTIFY ENGINEER OF ANY DISCREPANCIES FOUND IN FIELD.

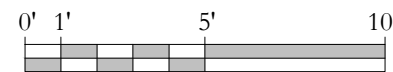

**NEW POST TO T.O. LVL W/ HUCQ410-SDS**

CUT TOP AS NEEDED TO FIT IN FLOOR.

(3) STUD PACK

HUCQ410-SDS HANGER

<N> (3) LVL BEAM

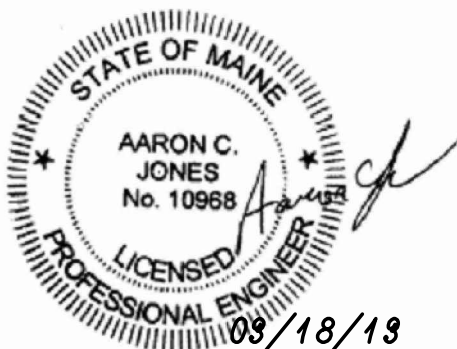
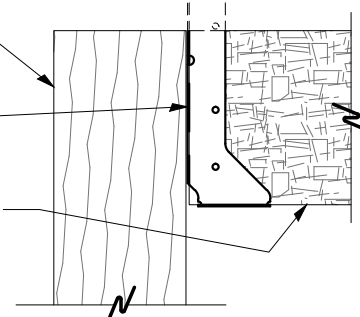

77 Oak Street  
Portland, ME, 04101  
p. 207-774-4614  
f. 866-793-7835  
www.structuralinteg.com  
BUILD WITH CONFIDENCE  
© 2012 Structural Integrity Consulting Engineers, Inc.

SI # 13-0027



ARCHITECTURE, PRESERVATION +DESIGN  
500 CONGRESS STREET  
PORTLAND, MAINE 04101  
TEL 207.772-2722

Project No: 2013XX  
Date: 03/18/2013

Title: 3rd Floor Framing

Issued For/Revisions:  
1. 03/18/2013 PERMIT  
2. 03/29/2013

Drawing No:

**S1-1**