



City of Portland, Maine
Planning and Development Department
Zoning Board of Appeals
Disability Variance Appeal Application

Applicant Information:

Name Stevan W. Morrow

Business Name Sterling Builders Inc.

Address P.O. Box 43

Westbrook, ME, 04098

Telephone 267-854-1289 Fax 888-601-2909

Applicant's Right, Title or Interest in Subject Property:

(e.g. owner, purchaser, etc.):

Current Zoning Designation: R6-residential

Existing Use of Property:

Multi unit Residential Structure

Subject Property Information:

Property Address 63 Grant St.

Assessor's Reference (Chart-Block-Lot) 048 B016-R-6

Property Owner (if different):

Name InTown Property Holdings LLC.

Address P.O. Box 641

Freeport, ME, 04032

Telephone _____ Fax _____

Variance from Section 14 - 1390(e)

1000 - 3 2009

NOTE: If site plan approval is required, attach preliminary or final site plan.

The undersigned hereby makes application for a variance as above described and certifies that all information herein supplied by his/her is true and correct to the best of his/her knowledge and belief.

Stevan W. Morrow
Signature of Applicant

2-19-09
Date

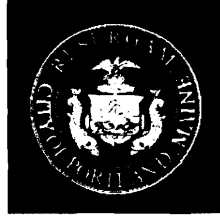

Strengthening a Remarkable City, Building a Community for Life • www.portlandmaine.gov

*Penny St. Louis Littell- Director of Planning and Urban Development
Marge Schmuckal, Zoning Administrator*

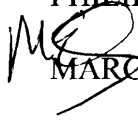
TO: PHILIP SAUCIER, CHAIR AND ZONING BOARD MEMBERS
FROM:  MARGE SCHMUCKAL, ZONING ADMINISTRATOR
SUBJECT: 61-67 GRANT STREET – 048-B-016 – R-6 ZONE
DATE: MARCH 12, 2009

This memo is given to the Zoning Board of Appeals for background information. As in most cases, handicap ramps are needed immediately. Based upon need, the Inspection Services office very often issues handicap ramp permits prior to the Zoning Board of Appeals final approval. The permit for 65 Grant Street was issued within one day of its receipt with a condition that the applicant applies for a variance within thirty days.

The ramp meets all setbacks. The one dimensional requirement being violated is the maximum lot coverage provision of 50% within the R-6 zone under section 14-139(1)(e). The handicap ramp is only adding another 35 square foot of coverage. Previously the property with all its required egresses added up to 51.35% lot coverage. The additional ramp square footage brings the total lot coverage to 51.7%.

Copies of the handicap ramp permit are attached to the applicant's submittal.

CITY OF PORTLAND, MAINE

ZONING BOARD OF APPEALS

APPEAL AGENDA

The Board of Appeals will hold a public hearing on Thursday, March 19, 2009 at 6:30 p.m. on the second floor in room 209 at the Portland City Hall, 389 Congress Street, Portland, Maine, to hear the following Appeals:

1. New Business:

A. Disability Variance Appeal:

61-67 Grant Street, Intown Property Holdings, LLC, owner, Tax Map 048, Block B, Lot 016, R-6 Residential Zone: The appellant is seeking a Disability Variance to install a handicap ramp. The appellant is requesting a lot coverage of 51.7% instead of the maximum allowable 50% as required under section 14-139(1)(e). Representing the appeal is Stevan Morrow, Sterling Builders, Inc.

2. Other Business:

3. Adjournment:



P.O. Box 43
Westbrook, Maine 04098
Off. 207-854-1289
Cell 207-831-9595
Fax 888-601-2909
E-mail smorrow@maine.rr.com
www.Sterlingbuildersinc.org

2/19/09

City of Portland Maine
Zoning Board of Appeals
389 Congress Street
Portland, Maine 04101

Re: Elizabeth Wheeler 65 Grant St. Handicap Access Ramp Variance request 35 additional sq. ft. coverage;

To whom it may concern,

Please find attached 11 copies of the disability variance appeals application for the above address.

Sterling Builders is working on behalf of Alpha 1 a nonprofit agency advocating for persons with disabilities. Temporary ramp structures installed by us for Alpha One are supported under grant funds allocated to Alpha One from various Grant programs including some generously provided by the City of Portland for use by some of their residents. This ramp for Mrs. Wheeler is not one of those ramps but is supported by other state funding. This being the case any opportunity to wave these application costs and ease the burden on these Grant Funds would be most appreciated.

Apparently this ramp has brought the allowable structure footprint for this lot to 35 sq. ft. over the allowable footprint factored for this number of dwellings on this lot size. We are therefore asking for a variance to accommodate this temporary structure.

Thank you for your consideration of this projects variance needs.

Respectfully Submitted on behalf of Alpha One and Elizabeth Wheeler,

Stevan W. Morrow
President

Cc. AK
HC
ZD

Disability Variance Application

MAR - 9 2009

WARNING

This application contains health care information and is CONFIDENTIAL, pursuant to 22 M.R.S.A., § 1711-C (Confidentiality of Health Care Information) and 1 M.R.S.A., § 402(3) (Freedom of Access Law).

THE MEDICAL INFORMATION CONTAINED HEREIN MAY NOT BE DISCLOSED TO ANY PERSON WITHOUT THE WRITTEN CONSENT OF THE PATIENT.

The Board of Appeals is authorized to grant disability variances by 30-A M.R.S.A., §4-A and Port Municipal Code §14-473 (c)(2).

1. What is the nature of the disability which supports the request for a variance?

Ms. Wheeler requires a wheelchair
for mobility. In order to enter & exit
her residence she requires a ramp.

2. Does the disability constitute a physical or mental handicap as defined by 5 M.R.S.A., §4553?

Yes No

Ms Wheeler's disability meets/constitutes a
physical disability as defined by 5M RSA §455.

Melisa DuWall 165/Alpha One
127 Main St
South Portland

3. Does the person with the disability reside in the dwelling?

Yes No

Ms Wheeler rents apartment # 1.

4. Is the variance which is requested restricted solely to the installation of equipment or the construction of structures* necessary for access to or egress from the dwelling by the person with the disability?

Yes X No _____

A ramp has been constructed at
the entrance. The ramp is not a
permanent structure and may be removed
should Ms Wheeler change residences.

Conditions

Richard Wall
115 Alpha Ave

The Board may impose conditions on the variance, including limiting the term of the variance to the duration of the disability or the time that the person with the disability lives in the dwelling.

* The phrase "structure necessary for access to or egress from the dwelling" includes railing, wall or roof systems necessary for the safety or effectiveness of the structure.



Powering Independent Living

Ann Machards
City of Portland
Inspections Division Services
Room 315
Portland, ME 04101

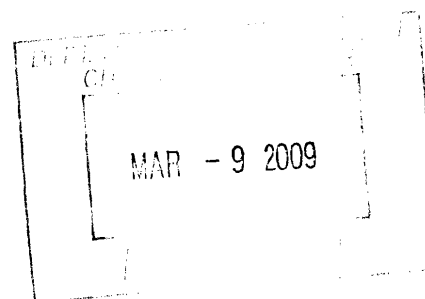

RE: Disability Variance 63 Grant Street

Ms. Wheeler's physical disability constitutes a physical disability as defined in 5 M.S.R.A. Sub-section 4553.

Ms. Wheeler uses a manual wheelchair for mobility.

Ms. Wheeler requires a ramp to enter and exit her residence at 63 Grant Street, Apt 1 in Portland. A ramp has been constructed at the entrance to 63 Grant Street to provide access for Ms. Wheeler to her apartment.

The ramp is not a permanent structure. It has not been attached to the building. It may be removed in the event that Ms. Wheeler chooses to move elsewhere.

Sincerely,

A handwritten signature in black ink, appearing to read "Zahira DuVall". The signature is written in a cursive style with a large loop at the end.

Zahira DuVall
Independent Living Specialist

02/10/08 12:32PM # 1/

Disability Variance Application

WARNING

This application contains health care information and is CONFIDENTIAL, pursuant to 22 M.R.S.A., § 1711-C (Confidentiality of Health Care Information) and 1 M.R.S.A., § 402(3) (Freedom of Access Law).

THE MEDICAL INFORMATION CONTAINED HEREIN MAY NOT BE DISCLOSED TO ANY PERSON WITHOUT THE WRITTEN CONSENT OF THE PATIENT.

The Board of Appeals is authorized to grant disability variances by 30-A M.R.S.A., §4-A and Port Municipal Code §14-473 (c)(2).

1. What is the nature of the disability which supports the request for a variance?

Ms. Wheeler has a left below the knee
amputation. She must use a manual
wheel chair for mobility Johnsonville

2. Does the disability constitute a physical or mental handicap as defined by 5 M.R.S.A., §4553?

Yes No

She must use a manual wheel chair

3. Does the person with the disability reside in the dwelling?

Yes No

She resides at this dwelling

4. Is the variance which is requested restricted solely to the installation of equipment or the construction of structures* necessary for access to or egress from the dwelling by the person with the disability?

Yes No

only a ramp was installed

Conditions

The Board may impose conditions on the variance, including limiting the term of the variance to the duration of the disability or the time that the person with the disability lives in the dwelling.

* The phrase "structure necessary for access to or egress from the dwelling" includes railing, wall or roof systems necessary for the safety or effectiveness of the structure.

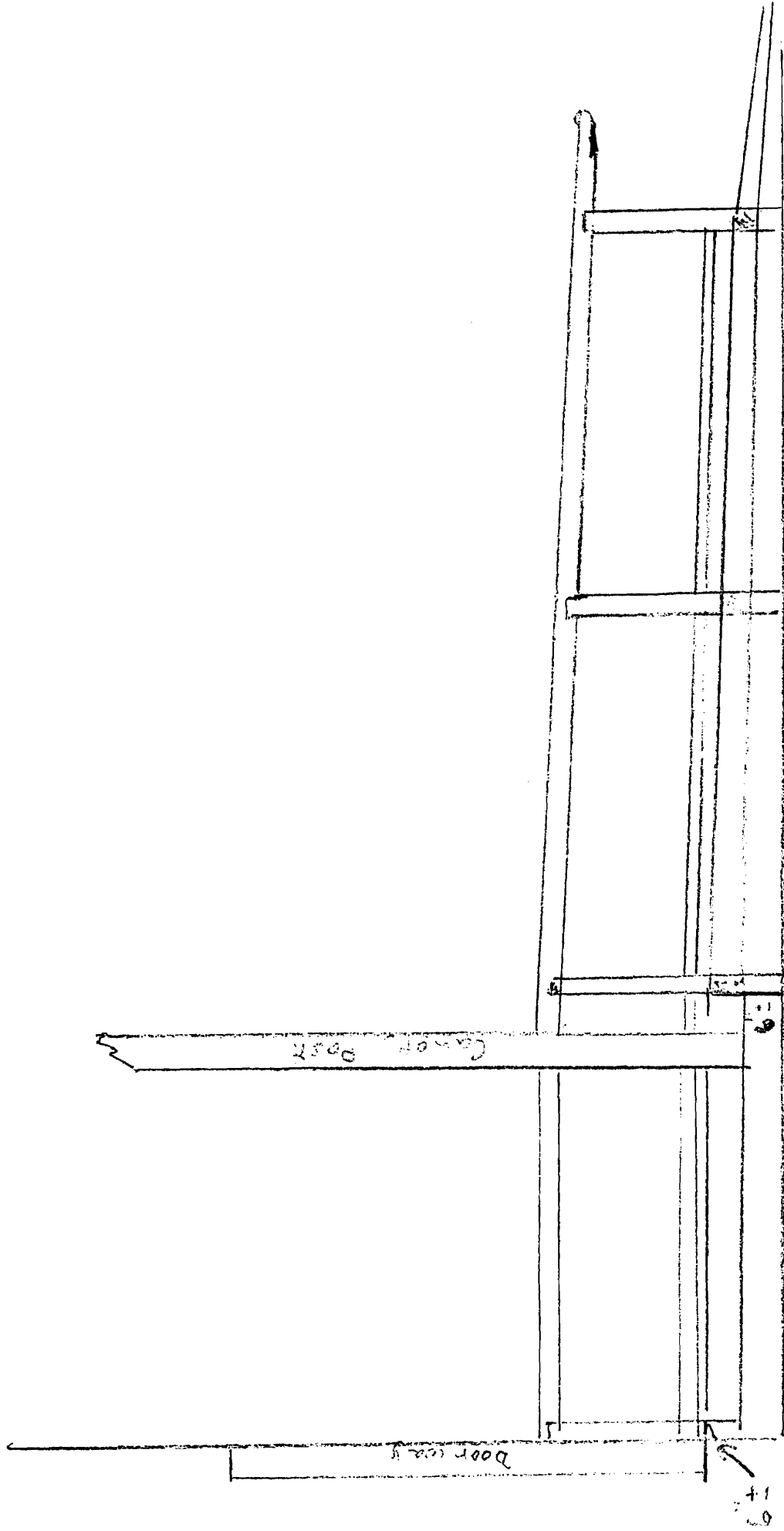

63 Grant St
Ramp Elevation - For Elizabeth Wheeler

LAWRENCE T. VOSE
LTV BUILDERS

15 Hearn Rd
Scarborough ME. 04074
207.883.2986

DAS INC PO BOX 6577 SCARBOROUGH

June 27, 2005

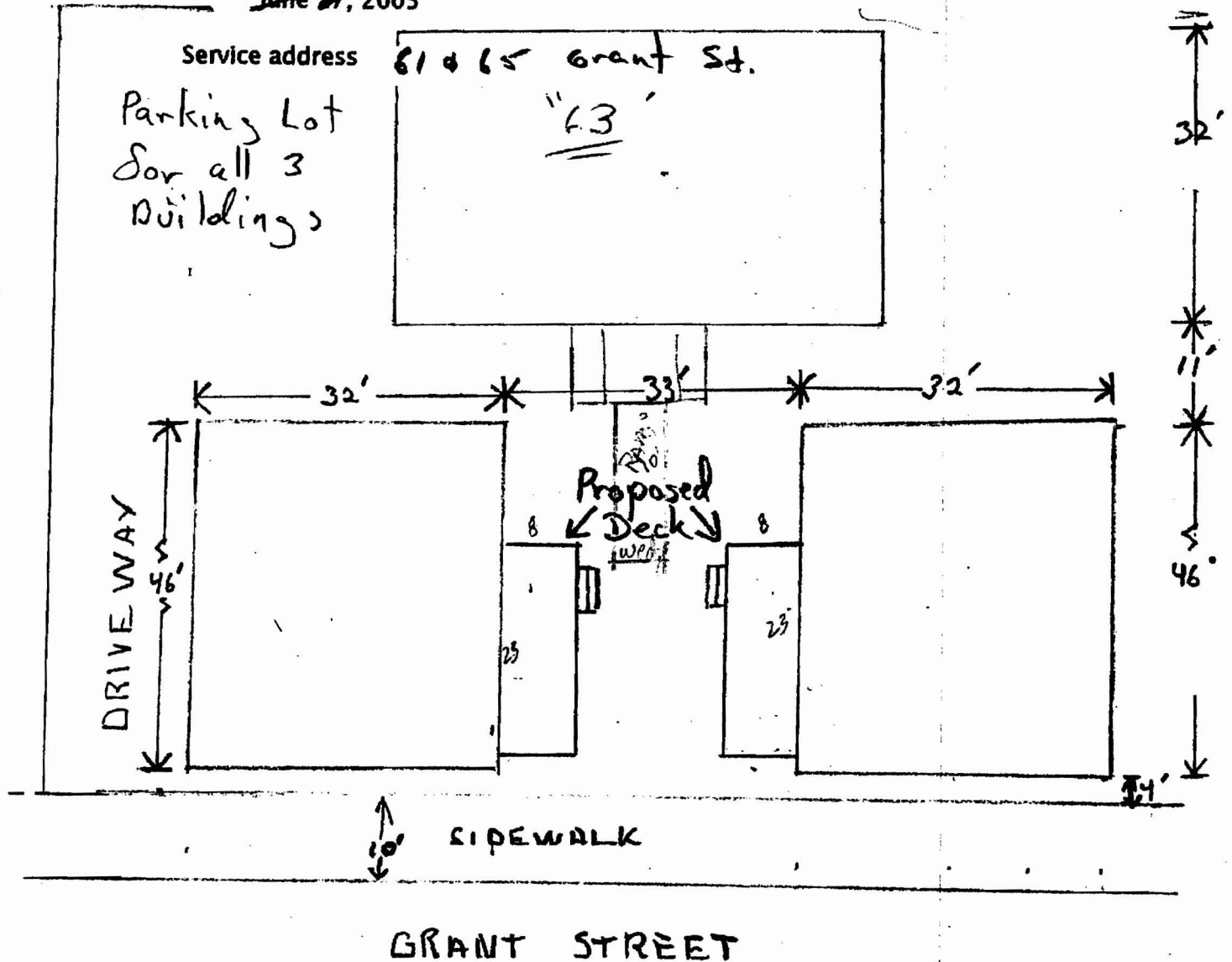

SCALE $\frac{1}{2}'' = 8'$

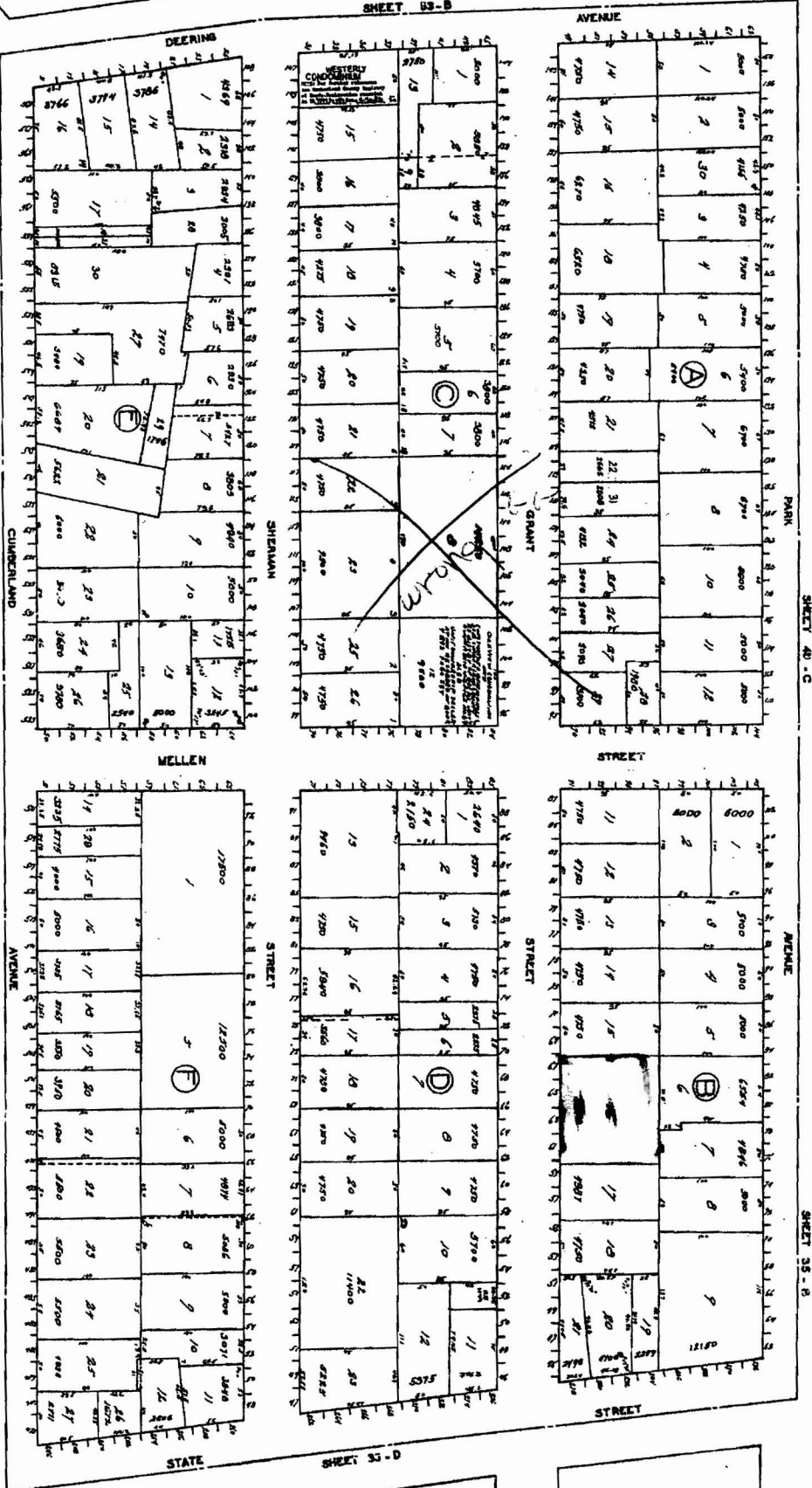

CITY OF PORTLAND
ASSESSORS PLAN
SCALE 1" = 80'
316.87



DISPLAY THIS CARD ON PRINCIPAL FRONTAGE OF WORK

CITY OF PORTLAND

BUILDING INSPECTION

PERMIT

Permit Number: 090035

Please Read
Application And
Notes, If Any,
Attached

This is to certify that INTOWN PROPERTY HOLDINGS LLC / Sterling Builders, Steve

has permission to install handi-cap ramp for unit 63

AT 65 GRANT ST CBL 048 B016001

provided that the person or persons, firm or corporation accepting this permit shall comply with all of the provisions of the Statutes of Maine and of the Ordinances of the City of Portland regulating the construction, maintenance and use of buildings and structures, and of the application on file in this department.

Apply to Public Works for street line and grade if nature of work requires such information.

Notification of inspection must be given and written permission procured before this building or part thereof is lathed or otherwise closed-in. 24 HOUR NOTICE IS REQUIRED.

A certificate of occupancy must be procured by owner before this building or part thereof is occupied.

OTHER REQUIRED APPROVALS

Fire Dept. Craig Cross Ramp only

Health Dept. _____

Appeal Board _____

Other _____

Department Name

Director - Building & Inspection Services

PENALTY FOR REMOVING THIS CARD

City of Portland, Maine - Building or Use Permit Application

389 Congress Street, 04101 Tel: (207) 874-8703, Fax: (207) 874-8716

Permit No: 09-0035	Issue Date:	CBL: 048 B016001
-----------------------	-------------	---------------------

Location of Construction: 65 GRANT ST	Owner Name: INTOWN PROPERTY HOLDING	Owner Address: PO BOX 641	Phone:
Business Name:	Contractor Name: Sterling Builders, Steve Morrow	Contractor Address: P O Box 43 Westbrook	Phone: 2078319595
Lessee/Buyer's Name	Phone:	Permit Type: Additions - Multi Family	Zone: R-6

Past Use: Residential - 18 dw. ^{dwelling} Units	Proposed Use: Residential - 18 dw. ^{dwelling} Units install handi-cap ramp for unit 63 ^{in #3} .	Permit Fee: \$40.00	Cost of Work: \$1,760.00	CEO District: 2
<p>1 legal use - 18 A.U. w/in 3 buildings.</p>		FIRE DEPT: <input checked="" type="checkbox"/> Approved <input type="checkbox"/> Denied	INSPECTION: Use Group: R-2 Type: 5 DOB-2003	
Proposed Project Description: install handi-cap ramp for unit ^{in #3} 63		Signature: <i>Greg Cass</i>	Signature: <i>AMB 1/14/09</i>	
PEDESTRIAN ACTIVITIES DISTRICT (P.A.D.)				
Action: <input type="checkbox"/> Approved <input type="checkbox"/> Approved w/Conditions <input type="checkbox"/> Denied				
Signature: _____ Date: _____				

Permit Taken By: ldobson	Date Applied For: 01/13/2009	Zoning Approval		
<p>1. This permit application does not preclude the Applicant(s) from meeting applicable State and Federal Rules.</p> <p>2. Building permits do not include plumbing, septic or electrical work.</p> <p>3. Building permits are void if work is not started within six (6) months of the date of issuance. False information may invalidate a building permit and stop all work..</p>		Special Zone or Reviews <input type="checkbox"/> Shoreland <input type="checkbox"/> Wetland <input type="checkbox"/> Flood Zone <input type="checkbox"/> Subdivision <input type="checkbox"/> Site Plan Maj <input type="checkbox"/> Minor <input type="checkbox"/> MM <input type="checkbox"/> Date: <i>1/13/09</i> <i>ABW</i>	Zoning Appeal <input type="checkbox"/> Variance <input type="checkbox"/> Miscellaneous <input type="checkbox"/> Conditional Use <input type="checkbox"/> Interpretation <input type="checkbox"/> Approved <input type="checkbox"/> Denied Date: _____	Historic Preservation <input checked="" type="checkbox"/> Not in District or Landmark <input type="checkbox"/> Does Not Require Review <input type="checkbox"/> Requires Review <input type="checkbox"/> Approved <input type="checkbox"/> Approved w/Conditions <input type="checkbox"/> Denied Date: <i>ABW</i>

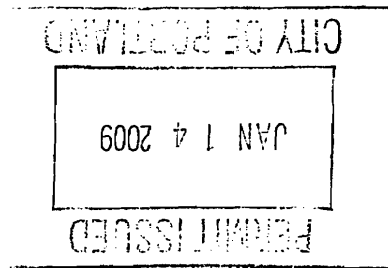

CERTIFICATION

hereby certify that I am the owner of record of the named property, or that the proposed work is authorized by the owner of record and that have been authorized by the owner to make this application as his authorized agent and I agree to conform to all applicable laws of this jurisdiction. In addition, if a permit for work described in the application is issued, I certify that the code official's authorized representative shall have the authority to enter all areas covered by such permit at any reasonable hour to enforce the provision of the code(s) applicable to such permit.

SIGNATURE OF APPLICANT	ADDRESS	DATE	PHONE
RESPONSIBLE PERSON IN CHARGE OF WORK, TITLE		DATE	PHONE

City of Portland, Maine - Building or Use Permit

389 Congress Street, 04101 Tel: (207) 874-8703, Fax: (207) 874-8716

Permit No: 09-0035	Date Applied For: 01/13/2009	CBL: 048 B016001
-----------------------	---------------------------------	---------------------

Location of Construction: 65 GRANT ST	Owner Name: INTOWN PROPERTY HOLDINGS	Owner Address: PO BOX 641	Phone:
Business Name:	Contractor Name: Sterling Builders, Steve Morrow	Contractor Address: P O Box 43 Westbrook	Phone (207) 831-9595
Lessee/Buyer's Name	Phone:	Permit Type: Additions - Multi Family	

Proposed Use: Residential - 18 dwelling units - install handi-cap ramp for unit in #63	Proposed Project Description: install handi-cap ramp for unit in #63
---	---

Dept: Zoning Status: Approved with Conditions Reviewer: Ann Machado Approval Date: 01/13/2009

Note:Ok to Issue:

- 1) This permit is being issued with the condition that the applicant will apply for a disability variance within thirty days of the permit being issued.
- 2) This property shall remain as eighteen dwelling units in three buildings. Any change of use shall require a separate permit application for review and approval.
- 3) This permit is being approved on the basis of plans submitted. Any deviations shall require a separate approval before starting that work.

Dept: Building Status: Approved with Conditions Reviewer: Jeanine Bourke Approval Date: 01/14/2009

Note:Ok to Issue:

- 1) Permit approved based on the plans submitted and reviewed w/owner/contractor, with additional information as agreed on and as noted on plans.

Dept: Fire Status: Approved with Conditions Reviewer: Capt Greg Cass Approval Date: 01/13/2009

Note:Ok to Issue:

- 1) All construction shall comply with NFPA 101

Comments:

1/13/2009-amachado: Spoke to Stevan Morrow from Sterling Builders, Inc. Told him that the existing structures were already over allowable lot coverage and the ramp is adding 35 sf of structure. I told him that somebody needed to apply for the disability variance. He said to send it to him and he would pass it on to Alpha One. Sent letter & disability variance application for the Zoning Board of Appeals.

1/14/2009-jmb: Spoke to Steve M. About total rise (12"), graspable handrails both sides and edge protection, ok to issue

BUILDING PERMIT INSPECTION PROCEDURES

Please call 874-8703 or 874-8693 (ONLY)

to schedule your inspections as agreed upon

Permits expire in 6 months, if the project is not started or ceases for 6 months.

The Owner or their designee is required to notify the inspections office for the following inspections and provide adequate notice. Notice must be called in 48-72 hours in advance in order to schedule an inspection:

By initializing at each inspection time, you are agreeing that you understand the inspection procedure and additional fees from a "Stop Work Order" and "Stop Work Order Release" will be incurred if the procedure is not followed as stated below.

A Pre-construction Meeting will take place upon receipt of your building permit.

 X Final inspection required at completion of work.

Certificate of Occupancy is not required for certain projects. Your inspector can advise you if your project requires a Certificate of Occupancy. All projects DO require a final inspection.

If any of the inspections do not occur, the project cannot go on to the next phase, REGARDLESS OF THE NOTICE OR CIRCUMSTANCES.

CERIFICATE OF OCCUPANICES MUST BE ISSUED AND PAID FOR, BEFORE THE SPACE MAY BE OCCUPIED.

Signature of Applicant/Designee

James Banta

Signature of Inspections Official

Date

1/14/09

Date

Powering Independent Living
**Independent Living Services Program
Landlord's Acknowledgement of
Property Modification**

Property Address: 63 Grant St
Portland Me 04104

Tenant Name (Consumer): Elizabeth Wheeler

Property Owner Name: Bill Simpson

As an accommodation for my tenant, I have agreed to the modifications to my property located at address listed above as described in the work description attached.

The landlord and tenant also agree to the following:

The tenant is responsible for ensuring that all modifications are done in accordance with manufacturer's instructions and recommendations as well as all applicable building, zoning and safety codes.

The tenant may remove access equipment or devices that are considered their personal property upon their departure. If the item has caused any damage to the property the tenant will be responsible for the cost to restore premises to original condition.

Landlord's Signature: _____

William P. Simpson

Date: _____

12/29/08

William Simpson V-874-0700

Title 7 B

PORTLAND HOUSING AUTHORITY
14 BAXTER BLVD
PORTLAND, ME 04101
TELEPHONE (207) 773-4753

DATE: MAY 15, 2008

ELIZABETH R WHEELER
63 GRANT ST. #1
PORTLAND, ME 04101

VOUCHER #: V301001001
OWNER #: 3993

DEAR ELIZABETH R WHEELER

This is to advise you that effective 07/01/08, your Housing Assistance Payment will be as follows:

CONTRACT RENT	:	\$	752.00
HOUSING ASSISTANCE PAYMENT	:	\$	614.00
TENANT PORTION OF RENT	:	\$	138.00
UTILITIES REIMBURSEMENT	:	\$	0.00

This notice is presented to you in accordance with the terms and conditions of your lease agreement; Therefore, this notice shall be attached to and be made a part of your lease. All other covenants, terms and conditions of the lease remain the same except as to the monthly rental which is adjusted herein stated.

You have the right to appeal this decision within (5) days from the date of this letter by calling me at 773-4753, or writing to the Portland Housing Authority, 14 Baxter Boulevard, Portland, ME 04101.

Sincerely,

Karrie Canavan

Section 8
Housing Officer

cc: file

INTOWN PROPERTY HOLDINGS LLC
WILLIAM SIMPSON
P O BOX 10250
PORTLAND, ME 04104

SECTION 8 HOUSING ASSISTANCE PAYMENTS PROGRAM
EXISTING HOUSING
CONTRACT AND LEASE AGREEMENT AMENDMENT
(For Adjustment of Payments or Continuation of Contract)

8 ACC NUMBER EXISTING HSNG ACC PART I # AND DATE CONTRACT NUMBER
Y

HOUSING ASSISTANCE PAYMENTS CONTRACT ('CONTRACT') entered into between the
r, INTOWN PROPERTY HOLDINGS LLC and the PHA dated 6/03/96 on
half of the LESSEE ('FAMILY') ELIZABETH R WHEELER who holds
OUCHER OF FAMILY PARTICIPATION NO. V301001001 for the following described
unit 63 GRANT ST. #1 is amended as follows:

REASON FOR AMENDMENT

- Change in family income or composition.
- Change in exceptional medical or unusual expenses.
- Change in allowance for utilities and other services.
From: \$ 48.00 To: \$ 48.00 (See schedule attached)
- Contract Renewal or Continuation.

ADJUSTMENT IN PAYMENTS

	FROM	TO
P.H.A. to Owner	\$557.00	\$614.00
Family to Owner	\$138.00	\$138.00
Ttl Contract Rent	\$695.00	\$752.00
P.H.A. to Lessee		

EFFECTIVE DATE

This amendment to the Housing Assistance Payments Contract and Lease Agreement
will be effective 07/01/2008

The next reexamination is due on 12/01/09.

- The adjustments as outlined above have been made in accordance with
the provisions of the Housing Assistance Payments Contract and do not
require signatures of the Owner or Family representative.

This NOTICE is presented to you in accordance with the terms and conditions of
the Housing Assistance Payments Contract and/or Lease Agreement; therefore, the
NOTICE shall be attached to and made a part of your Housing Assistance Payments
Contract and/or Lease Agreement. All other covenants, terms and conditions of
the original Housing Assistance Payments Contract and/or Lease Agreement remain
the same.

BY: Karrie Canavan

Section 8 Housing Officer
(official title)

DATE 5/15/08

PORTLAND HOUSING AUTHORITY
14 BAXTER BLVD
PORTLAND, ME 04101
TELEPHONE (207) 773-4753

DATE: MAY 15, 2008

ELIZABETH R WHEELER
63 GRANT ST. #1
PORTLAND, ME 04101

VOUCHER #: W301002001
OWNER #: 3993

DEAR ELIZABETH R WHEELER

This is to advise you that effective 07/01/08, your Housing Assistance Payment will be as follows:

CONTRACT RENT	:	\$	752.00
HOUSING ASSISTANCE PAYMENT	:	\$	614.00
TENANT PORTION OF RENT	:	\$	138.00
UTILITIES REIMBURSEMENT	:	\$	0.00

This notice is presented to you in accordance with the terms and conditions of your lease agreement; Therefore, this notice shall be attached to and be made a part of your lease. All other covenants, terms and conditions of the lease remain the same except as to the monthly rental which is adjusted herein stated.

You have the right to appeal this decision within (5) days from the date of this letter by calling me at 773-4753, or writing to the Portland Housing Authority, 14 Baxter Boulevard, Portland, ME 04101.

Sincerely,



Section 8
Housing Officer

cc: file

INTOWN PROPERTY HOLDINGS LLC
WILLIAM SIMPSON
P O BOX 10250
PORTLAND, ME 04104

SECTION 8 HOUSING ASSISTANCE PAYMENTS PROGRAM
EXISTING HOUSING
CONTRACT AND LEASE AGREEMENT AMENDMENT
(For Adjustment of Payments or Continuation of Contract)

8 ACC NUMBER EXISTING HSNB ACC PART I # AND DATE CONTRACT NUMBER
Y

HOUSING ASSISTANCE PAYMENTS CONTRACT ('CONTRACT') entered into between the
r, INTOWN PROPERTY HOLDINGS LLC and the PHA dated 6/03/96 on
half of the LESSEE ('FAMILY') ELIZABETH R WHEELER who holds
OUCHER OF FAMILY PARTICIPATION NO. V301001001 for the following described
unit 63 GRANT ST. #1 is amended as follows:

REASON FOR AMENDMENT

- Change in family income or composition.
- Change in exceptional medical or unusual expenses.
- Change in allowance for utilities and other services.
From: \$ 48.00 To: \$ 48.00 (See schedule attached)
- Contract Renewal or Continuation.

ADJUSTMENT IN PAYMENTS

	FROM	TO
P.H.A. to Owner	\$557.00	\$614.00
Family to Owner	\$138.00	\$138.00
Ttl Contract Rent	\$695.00	\$752.00
P.H.A. to Lessee	<u> </u>	<u> </u>

EFFECTIVE DATE

This amendment to the Housing Assistance Payments Contract and Lease Agreement will be effective 07/01/2008

The next reexamination is due on 12/01/09.

- The adjustments as outlined above have been made in accordance with the provisions of the Housing Assistance Payments Contract and do not require signatures of the Owner or Family representative.

This NOTICE is presented to you in accordance with the terms and conditions of the Housing Assistance Payments Contract and/or Lease Agreement; therefore, the NOTICE shall be attached to and made a part of your Housing Assistance Payments Contract and/or Lease Agreement. All other covenants, terms and conditions of the original Housing Assistance Payments Contract and/or Lease Agreement remain the same.

BY: Karrie Canavan

Section 8 Housing Officer
(official title)

DATE 5/15/08

3/9/09

ATTEN: Anne
VIA FAX 874-8716

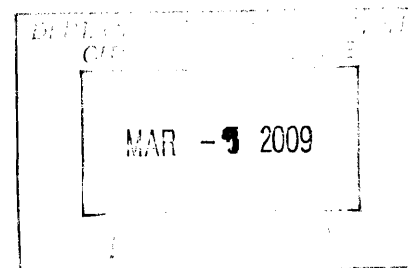

Dear Anne,

This letter is to acknowledge and authorize Steve Morrow of Sterling Builders to apply for disability variance for a ramp at 63 Grant Street in Portland.

If you have any questions please feel free to call me at my office, 874-0700. Thanks-

Sincerely,

William P. Simpson
Owner



Strengthening a Remarkable City, Building a Community for Life • www.portlandmaine.gov

*Penny St. Louis Littell - Director of Planning and Development
Aarge Schmuckal, Zoning Administrator*

January 14, 2009

Stevan Morrow
Sterling Builders, Inc.
P.O. Box 43
Westbrook, ME 04098

30 day period up Feb 11th

*also spoke to Steve Morrow He had
a couple of questions about the
variance. He is working on
completing the application*

Re: 65 Grant Street - 048 B016 - R-6 - Handicap ramp - permit #09-0035

Dear Mr. Morrow,

This letter is a follow up to the telephone conversation that we had yesterday. In reviewing your application to install a handicap ramp at 63 Grant Street, I found that the existing structures on the property already covered more than the maximum allowable lot coverage. The property is located in the R-6 residential zone. Section 14-139(1)(e) of the ordinance gives the maximum allowable lot coverage for a property with less than twenty dwelling units as fifty percent. The lot is 9,500 square feet, so the maximum allowable lot coverage is 4,750 square feet. With the fire escapes that were built in 2005 (#05-1768), the footprints of the buildings were over what is allowed, and this ramp is adding thirty-five more square feet of coverage. Since the handicap ramp has to be installed ASAP, we will move the permit forward, but you need to apply for a disability variance within thirty days of the permit being issued, since the ramp does not meet lot coverage.

I have enclosed the disability variance application and the information about the appeal process. Please feel free to contact me at 874-8709 if you have any questions.

Yours truly,

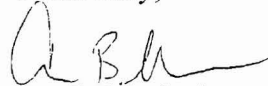
Ann B. Machado
Zoning Specialist
(207) 874-8709

CITY OF PORTLAND, MAINE

ZONING BOARD OF APPEALS

Peter Coyne
Philip Saucier-chair
Deborah Rutter
Jill E. Hunter
Gordan Smith-secretary
William Getz

March 23, 2009

Stevan W. Morrow
Sterling Builders LLC
PO Box 43
Westbrook, ME 04098

RE: 61-67 Grant Street
CBL: 048 B016
ZONE: R6

Dear Mr. Morrow:

As you know, at the March 19, 2009 meeting, the Board voted 5-0 to approve your Disability Variance Appeal to install the handicap ramp for permit # 090035.

I am enclosing your Certificate of Disability Variance Approval. **The original must be recorded in the Cumberland County Registry of Deeds within 90 days of March 19, 2009, from when it was signed.** Failure to record the Certificate will result in it being voided. This office shall be provided with a copy of the recorded Certificate of Disability Variance showing the book and page recorded.

Enclosed please find a copy of the board's decision.

Appeals from decisions of the Board may be filed in Superior Court, pursuant to 30-A M.R.S.A. section 2691 (2) (G).

Should you have any questions please feel free to contact me at 207-874-8701.

Sincerely,

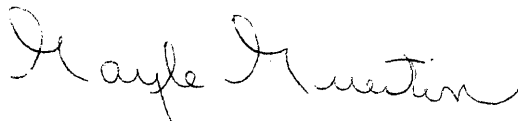

Gayle Guertin
Office Assistant

CC: Intown Property Holding, LLC, owner
file



CITY OF PORTLAND

CERTIFICATE OF DISABILITY VARIANCE APPROVAL

I, Philip Saucier, the duly appointed Chair of the Board of Appeals for the City of Portland, Cumberland County and State of Maine, hereby certify that on the 19th day of March, 2008, the following variance was granted pursuant to the provisions of 30-A M.R.S.A. Section 4353(5) and the City of Portland's Code of Ordinances.

1. **Current Property Owner: Intown Property Holdings, LLC**
2. **Property: 61-67 Grant Street, Portland, ME CBL: 048-B-016**
Cumberland County Registry of Deeds, Book 25517 Page 313
Last recorded deed in chain of Title: 10/03/2007
3. **Variance and Conditions of Variance:**
To grant relief from Section 14-139(1)(e) of the Land Use Zoning Ordinance in regards to the dimensional lot coverage allowing approximately 51.7 percent instead of the maximum allowed 50 percent for the construction of a handicap ramp.

IN WITNESS WHEREOF, I have hereto set my hand and seal this 19th day of March, 2009

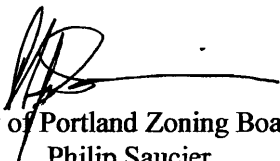
City of Portland Zoning Board,
Philip Saucier
, Chair of
(Printed or Typed Name)

STATE OF MAINE
Cumberland, ss.

Then personally appeared the above-named Philip Saucier and acknowledged the above certificate to be his free act and deed in his capacity as Chairman of the Portland Board of Appeals, with his signature witnessed on March 19, 2009.

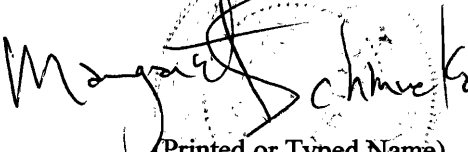
(Printed or Typed Name)
Notary Public
Margaret Schmuckal

My term expires June 28, 2012

PURSUANT TO 30-A M.R.S.A. SECTION 4353(5), THIS CERTIFICATE MUST BE RECORDED BY THE PROPERTY OWNER IN THE CUMBERLAND COUNTY REGISTRY OF DEEDS WITHIN 90 DAYS FROM FINAL WRITTEN APPROVAL FOR THE VARIANCE TO BE VALID. FURTHERMORE, THIS VARIANCE IS SUBJECT TO THE LIMITATIONS SET FORTH IN SECTION 14-474 OF THE CITY OF PORTLAND'S CODE OF ORDINANCES.

CITY OF PORTLAND, MAINE
ZONING BOARD OF APPEALS

Disability Variance Appeal

DECISION

Date of public hearing: March 19, 2009

Name and address of applicant: Intown Property Holdings, LLC
PO Box 641
Portland, Maine

Location of property under appeal: 63 Grant Street

For the Record:

Names and addresses of witnesses (proponents, opponents and others):

ARNIE Klepinger, 47 Glen Road, Yarmouth

Exhibits admitted (e.g. renderings, reports, etc.):

Findings of Fact and Conclusions of Law:

Applicant is seeking a variance for a handicap ramp. Maximum allowable lot coverage in the R-6 zone is 50%. The applicant is seeking a variance for the ramp because it would result in lot coverage of 51.7%.

Disability Variance standard pursuant to Portland City Code §14-473(c)(2):

1. The variance is for the purpose of making the property accessible to a person with a disability who is living on the property. "Disability" has the same meaning as a physical or mental handicap under 5 M.R.S.A. Section 4553, which is "any disability, infirmity, malformation, disfigurement, congenital defect or mental condition caused by bodily injury, accident, disease, birth defect, environmental conditions or illness, and includes the physical or mental condition of a person that constitutes a substantial disability as determined by a physician or, in the case of mental disability, by a psychiatrist or psychologist, as well as any other health or sensory impairment that requires special education, vocational rehabilitation or related services."

Satisfied Not Satisfied

Reason and supporting facts:

- Application states that Resident requires wheelchair due to ~~handic~~ physical handicap as defined by statute.

2. Any variance granted under this subsection shall be solely for the installation of equipment or the construction of structures necessary for access to or egress from the property by the person with the disability.

Satisfied Not Satisfied

Reason and supporting facts:

Applicant states that entire variance will be for installation of wheelchair Ramp.

Conclusion: (check one)

Option 1: The Board finds that the standards described above have been satisfied and therefore GRANTS the application.

3. Option 2: The Board finds that while the standard described above has been satisfied, certain additional conditions must be imposed to minimize adverse effects on other property in the neighborhood, and therefore GRANTS the application SUBJECT TO THE FOLLOWING CONDITIONS: (Note that the board may limit the variance to the duration of the disability or to the time that the person with the disability lives on the property).

Option 3: The Board finds that the standard described has NOT been satisfied and therefore DENIES the application.

Dated: 3.19.09

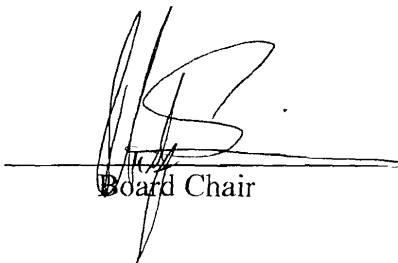
Board Chair

CITY OF PORTLAND
DEPARTMENT OF PLANNING & URBAN DEVELOPMENT

389 Congress Street
Portland, Maine 04101

INVOICE FOR FEES

Application No: 0000-1494	Applicant: Intown Property Holdings Llc
Project Name: 65 Grant St	Location: 65 GRANT ST
CBL: 048 B016001	Application Type:
Invoice Date: 03/06/2009	

Previous Balance	-	Payment Received	+	Current Fees	-	Current Payment	=	Total Due	Payment Due Date
\$0.00		\$0.00		\$232.50		\$232.50		\$0.00	On Receipt

Previous Balance

\$0.00

Fee Description	Qty	Fee/Deposit Charge
Legal Advertisements	1	\$26.00
Notices	142	\$106.50
Appeal Fee	1	\$100.00
		\$232.50
Total Current Fees:		+ \$232.50
Total Current Payments:		- \$232.50
Amount Due Now:		\$0.00

Bill to: Intown Property Holdings Llc
Po Box 641
Freeport , ME 04032

CBL 048 B016001
Application No: 0000-1494
Invoice Date: 03/06/2009
Invoice No: 33908
Total Amt Due: \$0.00
Payment Amount: \$232.50

Make checks payable to the *City of Portland*, ATTN: Inspections, 3rd Floor, 389 Congress Street, Portland, ME 04101.

members present: Philip Sauer, chair, Gordon Smith, Sec., Deborah
Ruffin, Jill Huntin, William Getz;

CITY OF PORTLAND, MAINE

ZONING BOARD OF APPEALS

members Absents: Peter Coyne -

APPEAL AGENDA

The Board of Appeals will hold a public hearing on Thursday, March 19, 2009 at 6:30 p.m. on the second floor in room 209 at the Portland City Hall, 389 Congress Street, Portland, Maine, to hear the following Appeals:

Called to order at 6:35 pm

GRANTED

S-Ø

1. New Business:

A. Disability Variance Appeal:

61-67 Grant Street, Intown Property Holdings, LLC. owner, Tax Map 048, Block B, Lot 016, R-6 Residential Zone: The appellant is seeking a Disability Variance to install a handicap ramp. The appellant is requesting a lot coverage of 51.7% instead of the maximum allowable 50% as required under section 14-139(1)(e). Representing the appeal is Stevan Morrow, Sterling Builders, Inc.

2. Other Business:

3. Adjournment:

6:50 pm

CBL	OWNER	OWNER MAILING ADDRESS	PROPERTY LOCATION	UNITS
036 D001001	PARK ON STATE LLC	291 STATE ST PORTLAND, ME 04101	291 STATE ST	1
036 D001002	LAVOIE CHRISTOPHER E	291 STATE ST # 2 PORTLAND, ME 04102	291 STATE ST	1
036 D001003	PHILBROOK CHRISTOPHER L	291 STATE ST # 3 PORTLAND, ME 04101	291 STATE ST	1
036 D002001	BALDWIN MICHAEL R	100 WINN RD FALMOUTH, ME 04105	287 STATE ST	6
036 D003001	RUTTER JASON T	48 PARK AVE PORTLAND, ME 04101	48 PARK AVE	3
036 D004001	SIEGFRIED DAVID	44 PARK AVE PORTLAND, ME 04101	44 PARK AVE	1
036 D005001	ENGLISH NANCY	40 PARK AVE PORTLAND, ME 04101	40 PARK AVE	1
036 D010001	MANSFIELD LINDA R HEIRS	2471 KIRKWOOD RD SALVISA, KY 40372	279 STATE ST	5
036 D011001	BAILEY LLOYD H JR & JULIANNE MAE BAILEY JTS	429 SLIGO RD YARMOUTH, ME 04096	33 GRANT ST	3
036 D012001	HOME STATE PROPERTIES LLC	150 GLENWOOD AVE PORTLAND, ME 04103	27 GRANT ST	6
036 D013001	HOME STATE PROPERTIES LLC	150 GLENWOOD AVE PORTLAND, ME 04103	25 GRANT ST	7
036 D014001	DUPLISSIE JAMES M	70 WINNOCKS NECK RD SCARBOROUGH, ME 04074	21 GRANT ST	6
036 E001001	INGRAHAM VOLUNTEERS INC	PO BOX 1868 PORTLAND, ME 04104	275 STATE ST	9
036 E003001	DOZET BARBARA I	28 GRANT ST PORTLAND, ME 04101	28 GRANT ST	3
036 E004001	24 GRANT STREET LLC	34 RICHARDSON ST PORTLAND, ME 04103	24 GRANT ST	6
036 E012001	SMITH CATHERINE MACDONALD ANTONY MACDONALD SMITH JTS	3316 GALLWAY RD BALLSTON SPA, NY 12020	265 STATE ST	1
036 E013001	GRAY JOSEPH E JR & MARIE L	263 STATE ST PORTLAND, ME 04101	263 STATE ST	1
036 E014001	GRAY JOSEPH E JR & MARIE L	263 STATE ST PORTLAND, ME 04101	31 SHERMAN ST	6
036 E015001	DEANGELIS MICHAEL	27 SHERMAN ST PORTLAND, ME 04101	27 SHERMAN ST	6
036 E022001	QUINT MICHAEL W	32 GRANT ST PORTLAND, ME 04101	32 GRANT ST	1
036 F001001	MID-TOWN PROPERTIES LLC	PO BOX 641 FREEPORT, ME 04032	261 STATE ST	7
036 F002001	ELDRIDGE NATHAN W & EVA R ELDRIDGE JTS	257 STATE ST # 3 PORTLAND, ME 04101	257 STATE ST	3
036 F003001	LYNCH MARY G	32 SHERMAN ST PORTLAND, ME 04101	32 SHERMAN ST	1
048 A008001	122-124 PARK AVENUE LLC	PO BOX 7225 PORTLAND, ME 04112	122 PARK AVE	20
048 A010001	120 PARK AVENUE LLC	PO BOX 7225 PORTLAND, ME 04112	120 PARK AVE	21
048 A011001	114 PARK AVENUE LLC	42 CHAMBERLAIN AVE PORTLAND, ME 04101	112 PARK AVE	3
048 A012001	TABACHNICK ROBERT J	110 PARK AVE PORTLAND, ME 04101	110 PARK AVE	2
048 A024001	GRAY TIMOTHY S & ANGELA MILLER-GRAY JTS	107 GRANT ST PORTLAND, ME 04102	107 GRANT ST	3
048 A025001	CUMMINGS JAMES E	105 GRANT ST PORTLAND, ME 04101	105 GRANT ST	3

CBL	OWNER	OWNER MAILING ADDRESS	PROPERTY LOCATION	UNITS
048 A026001	MCNEIL JOHN & SARAH ANDREWS JTS	103 GRANT ST PORTLAND, ME 04101	103 GRANT ST	2
048 A027001	THERIAULT GERALDINE M	16 RUDMAN RD PORTLAND, ME 04102	97 GRANT ST	3
048 A028001	SCARECROW AND THE FATMAN	9 DRUMLIN RD IPSWICH, MA 01938	94 MELLEEN ST	3
048 A029001	SIDELINGER GARY A & MAUREEN L JTS	PO BOX 1003 PORTLAND, ME 04104	90 MELLEEN ST	6
048 B001001	BURNHAM HAROLD P II	PO BOX 2087 SCARBOROUGH, ME 04070	96 PARK AVE	1
048 B002001	BURNHAM HAROLD P II	PO BOX 2087 SCARBOROUGH, ME 04070	99 MELLEEN ST	1
048 B003001	BURNHAM HAROLD P II	PO BOX 2087 SCARBOROUGH, ME 04074	94 PARK AVE	16
048 B004001	BURNHAM HAROLD P II	PO BOX 2087 SCARBOROUGH, ME 04070	88 PARK AVE	6
048 B005001	TRUSSELL PROPERTIES LLC	26 ATLANTIC DR SCARBOROUGH, ME 04074	84 PARK AVE	6
048 B006001	PARKSIDE APARTMENTS LLC	757 CONGRESS ST PORTLAND, ME 04102	82 PARK AVE	6
048 B007001	PARKSIDE APARTMENTS LLC	757 CONGRESS ST PORTLAND, ME 04102	76 PARK AVE	6
048 B008001	SPAR INC	104 GRANT ST PORTLAND, ME 04101	72 PARK AVE	12
048 B009001	SPRING STREET WEST CORP	104 GRANT ST PORTLAND, ME 04101	286 STATE ST	26
048 B011001	PENINSULA COMMUNITY LP 2	707 SABLE OAKS DR SOUTH PORTLAND, ME 04106	85 GRANT ST	16
048 B011002	PEOPLE'S REGIONAL PROGRAM	510 CUMBERLAND AVE PORTLAND, ME 04101	85 GRANT ST	1
048 B015001	INTOWN PROPERTY HOLDINGS	PO BOX 641 FREEPORT, ME 04032	69 GRANT ST	6
048 B016001	INTOWN PROPERTY HOLDINGS	PO BOX 641 FREEPORT, ME 04032	65 GRANT ST	6
048 B017001	WOITASEK STEVEN W	57 GRANT ST PORTLAND, ME 04101	57 GRANT ST	3
048 B018001	DAJ INC	PO BOX 641 FREEPORT, ME 04032	55 GRANT ST	6
048 B019001	SPRING STREET WEST CORP	104 GRANT ST PORTLAND, ME 04101	284 STATE ST	1
048 B020001	NELSON ANDREW D	280 STATE ST PORTLAND, ME 04101	280 STATE ST	4
048 B021001	PETTENGILL ERIC & HEATHER	13 PRINCE ST CUMBERLAND, ME 04021	278 STATE ST	3
048 C008001	104 GRANT STREET LLC	104 GRANT ST PORTLAND, ME 04101	104 GRANT ST	1
048 C012G01	EMMANOUEL MARKOS D & DOMINGUE TOOLE JTS	98 GRANT ST # G01 PORTLAND, ME 04101	98 GRANT ST	1
048 C012G02	CAPRON JENNIFER	98 GRANT ST # G02 PORTLAND, ME 04101	98 GRANT ST	1
048 C012G03	NICKETAKIS KATHERINE	98 GRANT ST # 3 PORTLAND, ME 04101	98 GRANT ST	1
048 C012G04	MACDOWELL MARILYN A	98 GRANT ST #4 PORTLAND, ME 04101	98 GRANT ST	1
048 C012G05	LANARO VERA-ELLEN	98 GRANT ST #G-5 PORTLAND, ME 04101	98 GRANT ST	1
048 C012G06	YABLON ARIEL S	98 GRANT ST # G6 PORTLAND, ME 04101	98 GRANT ST	1

CBL	OWNER	OWNER MAILING ADDRESS	PROPERTY LOCATION	UNITS
048 C012G07	STRUVE GREG	98 GRANT ST # 7 PORTLAND, ME 04101	98 GRANT ST	1
048 C012G08	GALLANT RUSSELL M	98 GRANT ST # 8 PORTLAND, ME 04102	98 GRANT ST	1
048 C012M01	VELGOS MARY W TRUSTEE & JUSTIN S VELGOS JTS	78 MELLEN ST # 1 PORTLAND, ME 04101	78 MELLEN ST	1
048 C012M02	TIERNEY HARRY W III & MARY K TIERNEY JTS	78 MELLEN ST # 2 PORTLAND, ME 04102	78 MELLEN ST	1
048 C012M03	DRURY MARY C & PETER L DRURY TRUSTEES	10 HIGH ST BAR HARBOR, ME 04609	78 MELLEN ST	1
048 C012M04	LEAHEY MICHAEL J & SARA C JTS	78 MELLEN ST # 4 PORTLAND, ME 04101	78 MELLEN ST	1
048 C012M05	DAIGLE JENNIFER & ANDREW SUSEN JTS	33 SOUTH ST YARMOUTH, ME 04096	78 MELLEN ST	1
048 C012M06	FLAGG MICHELE L	78 MELLEN ST # 6 PORTLAND, ME 04101	78 MELLEN ST	1
048 C012M07	HOLDER EMMA L	78 MELLEN ST # 7 PORTLAND, ME 04101	78 MELLEN ST	1
048 C012M08	AMMENTORP SIRI & HOLLY AMMENTORP &	31 CLEARWATER DR DOVER, NH 03820	78 MELLEN ST	1
048 C023001	C K T INC	PO BOX 4271 PORTLAND, ME 04104	111 SHERMAN ST	25
048 C025001	SANDOR LLC	1289 FOREST AVE PORTLAND, ME 04103	105 SHERMAN ST	6
048 C026001	FERRIS SCOTT D & PERRY A FERRIS JTS	99 SHERMAN ST PORTLAND, ME 04101	99 SHERMAN ST	3
048 D001001	SIDELINGER GARY A & MAUREEN L JTS	PO BOX 1003 PORTLAND, ME 04104	83 MELLEN ST	6
048 D002001	HAMMOND RENTALS LLC	86 BURWELL AVE SOUTH PORTLAND, ME 04106	84 GRANT ST	6
048 D003001	BAYVIEW PROPERTIES LLC	211 MARGINAL WAY STE 171 PORTLAND, ME 04101	80 GRANT ST	12
048 D004001	LITTLEFIELD ANDREA L	74 GRANT ST PORTLAND, ME 04101	74 GRANT ST	2
048 D005001	70 GRANT STREET LLC	34 RICHARDSON ST PORTLAND, ME 04103	72 GRANT ST	6
048 D007001	BOUCHER ERIK	66 GRANT ST APT 4 PORTLAND, ME 04101	66 GRANT ST	4
048 D008001	GOSS MARJORIE A & PAUL A GOSS JTS	62 GRANT ST PORTLAND, ME 04101	62 GRANT ST	4
048 D009001	RICE GEOFFREY I	658 CONGRESS ST 1 ST FLOOR PORTLAND, ME 04101	60 GRANT ST	7
048 D010001	AHLQUIST OREN B	266 BEECHRIDGE RD SCARBOROUGH, ME 04074	54 GRANT ST	4
048 D011001	KOUFMAN ELAINE G & JILL M KOUFMAN JTS	276 STATE ST # 1 PORTLAND, ME 04101	276 STATE ST	1
048 D011002	LAROCHELLE PETER M	276 STATE ST # 2 PORTLAND, ME 04101	276 STATE ST	1
048 D011003	SHICKLER CHRISTOPHER R	276 STATE ST # 3 PORTLAND, ME 04101	276 STATE ST	1
048 D013001	MAHAN CATHLEEN	83 SHERMAN ST # 1 PORTLAND, ME 04101	83 SHERMAN ST	1
048 D013002	ITCHKAWICH DAVID	83 SHERMAN ST # 2 PORTLAND, ME 04101	83 SHERMAN ST	1
048 D013003	BRODEUR JAN C	83 SHERMAN ST # 3 PORTLAND, ME 04101	83 SHERMAN ST	1
048 D013004	BOUCHER JOANNE FELICE	83 SHERMAN ST # 4 PORTLAND, ME 04101	83 SHERMAN ST	1

CBL	OWNER	OWNER MAILING ADDRESS	PROPERTY LOCATION	UNITS
048 D013005	LABRIE JOHN R	83 SHERMAN ST # 5 PORTLAND, ME 04101	83 SHERMAN ST	1
048 D013006	RANDAZZO MICHAEL J & CYNTHIA F CHIANG JTS	83 SHERMAN ST # 6 PORTLAND, ME 04101	83 SHERMAN ST	1
048 D013007	KINDRED WENDY	83 SHERMAN ST # 7 PORTLAND, ME 04101	83 SHERMAN ST	1
048 D013008	NEWKIRK JANE & LOUIS SLINGERLAND JTS	83 SHERMAN ST # 8 PORTLAND, ME 04101	83 SHERMAN ST	1
048 D016001	TRUE NORTH PROPERTIES LLC	PO BOX 1021 PORTLAND, ME 04104	77 SHERMAN ST	12
048 D017001	HABIBI AMIR	865 BROADWAY SOUTH PORTLAND, ME 04106	75 SHERMAN ST	9
048 D018001	SIDELINGER GARY A & MAUREEN L JTS	PO BOX 1003 PORTLAND, ME 04104	69 SHERMAN ST	12
048 D019001	STEPHENSON SUSAN E & MICHAEL A STEPHENSON JTS	65 SHERMAN ST # 1 PORTLAND, ME 04101	65 SHERMAN ST	1
048 D019002	WEIMER CHERYL L	65 SHERMAN ST # 2 PORTLAND, ME 04101	65 SHERMAN ST	1
048 D019003	CLARK MICHAEL S	65 SHERMAN ST # 3 PORTLAND, ME 04101	65 SHERMAN ST	1
048 D019004	FULLER WILLIAM E	65 SHERMAN ST # 4 PORTLAND, ME 04101	65 SHERMAN ST	1
048 D019005	BECKSVOORT KAI & JAMIE TURCOTTE JTS	65 SHERMAN ST # 5 PORTLAND, ME 04101	65 SHERMAN ST	1
048 D019006	US BANK NATIONAL	60 LIVINGSTON AVE ST PAUL, MN 55107	65 SHERMAN ST	1
048 D019007	BERGERON CATHERINE M	65 SHERMAN ST # 7 PORTLAND, ME 04101	65 SHERMAN ST	1
048 D019008	BERGERON CATHERINE M	65 SHERMAN ST # 8 PORTLAND, ME 04101	65 SHERMAN ST	1
048 D019009	WEISS LESLIE D & DENNIS P DEMUTH JTS	65 SHERMAN ST # 9 PORTLAND, ME 04101	65 SHERMAN ST	1
048 D019010	CAHILL ANDREA L	65 SHERMAN ST # 10 PORTLAND, ME 04101	65 SHERMAN ST	1
048 D019011	ROPER BENJAMIN G	117 FLORIDA AVE PORTLAND, ME 04103	65 SHERMAN ST	1
048 D019012	DEVINE MARK B	200 STEVENS AVE PORTLAND, ME 04102	65 SHERMAN ST	1
048 D019013	CATALDO BRIAN C	65 SHERMAN ST # 13 PORTLAND, ME 04101	65 SHERMAN ST	1
048 D019014	SCHARDT THOMAS P	519 E 78TH # 5C NEW YORK, NY 10075	65 SHERMAN ST	1
048 D019015	COUGHLAN DOUGLAS	63 BRADLEY HILL RD PEMAQUID, ME 04558	65 SHERMAN ST	1
048 D019016	SMITH FRANCIS & CATHLEEN SMITH JTS	65 SHERMAN ST # 16 PORTLAND, ME 04101	65 SHERMAN ST	1
048 D019017	FOWLER JEFFREY E & SARAH J E FOWLER JTS	65 SHERMAN ST # 17 PORTLAND, ME 04101	65 SHERMAN ST	1
048 D020001	VELIGOR VINCENT D JR & SUSAN J JTS	61 SHERMAN ST PORTLAND, ME 04101	61 SHERMAN ST	2
048 D022001	GRASSHOPPER APARTMENTS	55 SHERMAN ST PORTLAND, ME 04101	55 SHERMAN ST	7
048 D023001	S S & M LLC	88 ANNAFRAN ST ROSLINDALE, MA 02131	264 STATE ST	12
048 D024001	NAPPI JOSEPH A	79 MELLEEN ST PORTLAND, ME 04102	79 MELLEEN ST	1
048 D025001	CONLEY PAUL E & CORINNE J JTS	PO BOX 8419 PORTLAND, ME 04104	52 GRANT ST	1

CBL	OWNER	OWNER MAILING ADDRESS	PROPERTY LOCATION	UNITS
048 E011001	BETH CHRISTOPHER A & LORI J ESCHHOLZ JTS	106 SHERMAN ST PORTLAND, ME 04101	106 SHERMAN ST	2
048 E012001	MELLEN-SHERMAN CORP	189 ST JOHN ST PORTLAND, ME 04102	62 MELLEN ST	12
048 E013001	DOOLEY KATHLEEN M & JAMES F DOOLEY JTS	60 MELLEN ST # 1 PORTLAND, ME 04101	60 MELLEN ST	5
048 F001001	ROMAN CATHOLIC BISHOP OF PORTLAND	PO BOX 11559 PORTLAND, ME 04104	82 SHERMAN ST	1
048 F005001	ROMAN CATHOLIC BISHOP OF PORTLAND	PO BOX 11559 PORTLAND, ME 04104	80 SHERMAN ST	1
048 F006001	SIDELINGER GARY A & MAUREEN L JTS	PO BOX 1003 PORTLAND, ME 04104	66 SHERMAN ST	7
048 F007001	SALVAN MARTA HERNANDEZ	62 SHERMAN ST PORTLAND, ME 04101	62 SHERMAN ST	2
048 F008001	FOSTER DOLORES	90 CARROLL ST PORTLAND, ME 04102	60 SHERMAN ST	6
048 F009001	FOSTER DOLORES	90 CARROLL ST PORTLAND, ME 04102	56 SHERMAN ST	7
048 F010001	RICE GEOFFREY I	658 CONGRESS ST 1 ST FLOOR PORTLAND, ME 04101	52 SHERMAN ST	6
048 F011001	NEWSOME JOSEPH W & ANTOINETTE N NEWSOME JTS	256 STATE ST PORTLAND, ME 04101	258 STATE ST	1
048 F012001	NEWSOME JOSEPH W & ANTOINETTE M NEWSOME JTS	256 STATE ST PORTLAND, ME 04101	256 STATE ST	1
048 F014001	LY TIM Q & AARON ADDITON &	521 CUMBERLAND AVE PORTLAND, ME 04101	521 CUMBERLAND AVE	4
048 F015001	FESENKO ESTATE LLC	88 WOODLAND DR WEST GARDINER, ME 04345	515 CUMBERLAND AVE	6
048 F016001	LEAVITT BETHANY M	133 ENDICOTT ST # 1 BOSTON, MA 02113	511 CUMBERLAND AVE	3
048 F017001	TRUSSELL PROPERTIES LLC	26 ATLANTIC DR SCARBOROUGH, ME 04074	509 CUMBERLAND AVE	5
048 F018001	TRUSSELL PROPERTIES LLC	26 ATLANTIC DR SCARBOROUGH, ME 04074	507 CUMBERLAND AVE	5
048 F019001	EAST END CORP	PO BOX 10291 PORTLAND, ME 04104	503 CUMBERLAND AVE	9
048 F020001	501 PARTNERS LLC	PO BOX 226 YORK HARBOR, ME 03911	501 CUMBERLAND AVE	3
048 F021001	TROUT GROUP INVESTMENTS LIMITED LIABILITY COMPANY	PO BOX 7051 PORTLAND, ME 04112	497 CUMBERLAND AVE	12
048 F022001	TROUT GROUP INVESTMENTS LIMITED LIABILITY COMPANY	PO BOX 7051 PORTLAND, ME 04112	493 CUMBERLAND AVE	6
048 F023001	FULLER DENNY A & DENNIS W KIERNAN	PO BOX 7341 PORTLAND, ME 04112	489 CUMBERLAND AVE	4
048 F024001	485 CUMBERLAND AVENUE LLC	34 RICHARDSON ST PORTLAND, ME 04103	485 CUMBERLAND AVE	25
048 F025001	SCHOENFELD FRAYLA A & HARRIS SCHOENFELD JTS	481 CUMBERLAND AVE PORTLAND, ME 04101	481 CUMBERLAND AVE	4
048 F026001	RIDGWAY JAMES R III & STACY K LANG JTS	4657 BAY SUMMIT PL SAN DIEGO, CA 92117	252 STATE ST	1
048 F027001	JAMES FREDERICK O JR & CAROLE A JAMES	299 TUTTLE RD CUMBERLAND, ME 04021	477 CUMBERLAND AVE	10

CBL	OWNER	OWNER MAILING ADDRESS	PROPERTY LOCATION	UNITS
Total Listed	142	UNITS	611	

CBL	OWNER	OWNER MAILING ADDRESS	PROPERTY LOCATION	UNITS
036 D001001	PARK ON STATE LLC	291 STATE ST PORTLAND, ME 04101	291 STATE ST	1
036 D001002	LAVOIE CHRISTOPHER E	291 STATE ST # 2 PORTLAND, ME 04102	291 STATE ST	1
036 D001003	PHILBROOK CHRISTOPHER L	291 STATE ST # 3 PORTLAND, ME 04101	291 STATE ST	1
036 D002001	BALDWIN MICHAEL R	100 WINN RD FALMOUTH, ME 04105	287 STATE ST	6
036 D003001	RUTTER JASON T	48 PARK AVE PORTLAND, ME 04101	48 PARK AVE	3
036 D004001	SIEGFRIED DAVID	44 PARK AVE PORTLAND, ME 04101	44 PARK AVE	1
036 D005001	ENGLISH NANCY	40 PARK AVE PORTLAND, ME 04101	40 PARK AVE	1
036 D010001	MANSFIELD LINDA R HEIRS	2471 KIRKWOOD RD SALVISA, KY 40372	279 STATE ST	5
036 D011001	BAILEY LLOYD H JR & JULIANNE MAE BAILEY JTS	429 SLIGO RD YARMOUTH, ME 04096	33 GRANT ST	3
036 D012001	HOME STATE PROPERTIES LLC	150 GLENWOOD AVE PORTLAND, ME 04103	27 GRANT ST	6
036 D013001	HOME STATE PROPERTIES LLC	150 GLENWOOD AVE PORTLAND, ME 04103	25 GRANT ST	7
036 D014001	DUPLISSIE JAMES M	70 WINNOCKS NECK RD SCARBOROUGH, ME 04074	21 GRANT ST	6
036 E001001	INGRAHAM VOLUNTEERS INC	PO BOX 1868 PORTLAND, ME 04104	275 STATE ST	9
036 E003001	DOZET BARBARA I	28 GRANT ST PORTLAND, ME 04101	28 GRANT ST	3
036 E004001	24 GRANT STREET LLC	34 RICHARDSON ST PORTLAND, ME 04103	24 GRANT ST	6
036 E012001	SMITH CATHERINE MACDONALD ANTONY MACDONALD SMITH JTS	3316 GALLWAY RD BALLSTON SPA, NY 12020	265 STATE ST	1
036 E013001	GRAY JOSEPH E JR & MARIE L	263 STATE ST PORTLAND, ME 04101	263 STATE ST	1
036 E014001	GRAY JOSEPH E JR & MARIE L	263 STATE ST PORTLAND, ME 04101	31 SHERMAN ST	6
036 E015001	DEANGELIS MICHAEL	27 SHERMAN ST PORTLAND, ME 04101	27 SHERMAN ST	6
036 E022001	QUINT MICHAEL W	32 GRANT ST PORTLAND, ME 04101	32 GRANT ST	1
036 F001001	MID-TOWN PROPERTIES LLC	PO BOX 641 FREEPORT, ME 04032	261 STATE ST	7
036 F002001	ELDRIDGE NATHAN W & EVA R ELDRIDGE JTS	257 STATE ST # 3 PORTLAND, ME 04101	257 STATE ST	3
036 F003001	LYNCH MARY G	32 SHERMAN ST PORTLAND, ME 04101	32 SHERMAN ST	1
048 A008001	122-124 PARK AVENUE LLC	PO BOX 7225 PORTLAND, ME 04112	122 PARK AVE	20
048 A010001	120 PARK AVENUE LLC	PO BOX 7225 PORTLAND, ME 04112	120 PARK AVE	21
048 A011001	114 PARK AVENUE LLC	42 CHAMBERLAIN AVE PORTLAND, ME 04101	112 PARK AVE	3
048 A012001	TABACHNICK ROBERT J	110 PARK AVE PORTLAND, ME 04101	110 PARK AVE	2
048 A024001	GRAY TIMOTHY S & ANGELA MILLER-GRAY JTS	107 GRANT ST PORTLAND, ME 04102	107 GRANT ST	3
048 A025001	CUMMINGS JAMES E	105 GRANT ST PORTLAND, ME 04101	105 GRANT ST	3

CBL	OWNER	OWNER MAILING ADDRESS	PROPERTY LOCATION	UNITS
048 A026001	MCNEIL JOHN & SARAH ANDREWS JTS	103 GRANT ST PORTLAND, ME 04101	103 GRANT ST	2
048 A027001	THERIAULT GERALDINE M	16 RUDMAN RD PORTLAND, ME 04102	97 GRANT ST	3
048 A028001	SCARECROW AND THE FATMAN	9 DRUMLIN RD IPSWICH, MA 01938	94 MELLEEN ST	3
048 A029001	SIDELINGER GARY A & MAUREEN L JTS	PO BOX 1003 PORTLAND, ME 04104	90 MELLEEN ST	6
048 B001001	BURNHAM HAROLD P II	PO BOX 2087 SCARBOROUGH, ME 04070	96 PARK AVE	1
048 B002001	BURNHAM HAROLD P II	PO BOX 2087 SCARBOROUGH, ME 04070	99 MELLEEN ST	1
048 B003001	BURNHAM HAROLD P II	PO BOX 2087 SCARBOROUGH, ME 04074	94 PARK AVE	16
048 B004001	BURNHAM HAROLD P II	PO BOX 2087 SCARBOROUGH, ME 04070	88 PARK AVE	6
048 B005001	TRUSSELL PROPERTIES LLC	26 ATLANTIC DR SCARBOROUGH, ME 04074	84 PARK AVE	6
048 B006001	PARKSIDE APARTMENTS LLC	757 CONGRESS ST PORTLAND, ME 04102	82 PARK AVE	6
048 B007001	PARKSIDE APARTMENTS LLC	757 CONGRESS ST PORTLAND, ME 04102	76 PARK AVE	6
048 B008001	SPAR INC	104 GRANT ST PORTLAND, ME 04101	72 PARK AVE	12
048 B009001	SPRING STREET WEST CORP	104 GRANT ST PORTLAND, ME 04101	286 STATE ST	26
048 B011001	PENINSULA COMMUNITY LP 2	707 SABLE OAKS DR SOUTH PORTLAND, ME 04106	85 GRANT ST	16
048 B011002	PEOPLE'S REGIONAL PROGRAM	510 CUMBERLAND AVE PORTLAND, ME 04101	85 GRANT ST	1
048 B015001	INTOWN PROPERTY HOLDINGS	PO BOX 641 FREEPORT, ME 04032	69 GRANT ST	6
048 B016001	INTOWN PROPERTY HOLDINGS	PO BOX 641 FREEPORT, ME 04032	65 GRANT ST	6
048 B017001	WOITASEK STEVEN W	57 GRANT ST PORTLAND, ME 04101	57 GRANT ST	3
048 B018001	DAJ INC	PO BOX 641 FREEPORT, ME 04032	55 GRANT ST	6
048 B019001	SPRING STREET WEST CORP	104 GRANT ST PORTLAND, ME 04101	284 STATE ST	1
048 B020001	NELSON ANDREW D	280 STATE ST PORTLAND, ME 04101	280 STATE ST	4
048 B021001	PETTENGILL ERIC & HEATHER	13 PRINCE ST CUMBERLAND, ME 04021	278 STATE ST	3
048 C008001	104 GRANT STREET LLC	104 GRANT ST PORTLAND, ME 04101	104 GRANT ST	1
048 C012G01	EMMANOUEL MARKOS D & DOMINGUE TOOLE JTS	98 GRANT ST # G01 PORTLAND, ME 04101	98 GRANT ST	1
048 C012G02	CAPRON JENNIFER	98 GRANT ST # G02 PORTLAND, ME 04101	98 GRANT ST	1
048 C012G03	NICKETAKIS KATHERINE	98 GRANT ST # 3 PORTLAND, ME 04101	98 GRANT ST	1
048 C012G04	MACDOWELL MARILYN A	98 GRANT ST #4 PORTLAND, ME 04101	98 GRANT ST	1
048 C012G05	LANARO VERA-ELLEN	98 GRANT ST #G-5 PORTLAND, ME 04101	98 GRANT ST	1
048 C012G06	YABLON ARIEL S	98 GRANT ST # G6 PORTLAND, ME 04101	98 GRANT ST	1

CBL	OWNER	OWNER MAILING ADDRESS	PROPERTY LOCATION	UNITS
048 C012G07	STRUVE GREG	98 GRANT ST # 7 PORTLAND, ME 04101	98 GRANT ST	1
048 C012G08	GALLANT RUSSELL M	98 GRANT ST # 8 PORTLAND, ME 04102	98 GRANT ST	1
048 C012M01	VELGOS MARY W TRUSTEE & JUSTIN S VELGOS JTS	78 MELLEN ST # 1 PORTLAND, ME 04101	78 MELLEN ST	1
048 C012M02	TIERNEY HARRY W III & MARY K TIERNEY JTS	78 MELLEN ST # 2 PORTLAND, ME 04102	78 MELLEN ST	1
048 C012M03	DRURY MARY C & PETER L DRURY TRUSTEES	10 HIGH ST BAR HARBOR, ME 04609	78 MELLEN ST	1
048 C012M04	LEAHEY MICHAEL J & SARA C JTS	78 MELLEN ST # 4 PORTLAND, ME 04101	78 MELLEN ST	1
048 C012M05	DAIGLE JENNIFER & ANDREW SUSEN JTS	33 SOUTH ST YARMOUTH, ME 04096	78 MELLEN ST	1
048 C012M06	FLAGG MICHELE L	78 MELLEN ST # 6 PORTLAND, ME 04101	78 MELLEN ST	1
048 C012M07	HOLDER EMMA L	78 MELLEN ST # 7 PORTLAND, ME 04101	78 MELLEN ST	1
048 C012M08	AMMENTORP SIRI & HOLLY AMMENTORP &	31 CLEARWATER DR DOVER, NH 03820	78 MELLEN ST	1
048 C023001	C K T INC	PO BOX 4271 PORTLAND, ME 04104	111 SHERMAN ST	25
048 C025001	SANDOR LLC	1289 FOREST AVE PORTLAND, ME 04103	105 SHERMAN ST	6
048 C026001	FERRIS SCOTT D & PERRY A FERRIS JTS	99 SHERMAN ST PORTLAND, ME 04101	99 SHERMAN ST	3
048 D001001	SIDELINGER GARY A & MAUREEN L JTS	PO BOX 1003 PORTLAND, ME 04104	83 MELLEN ST	6
048 D002001	HAMMOND RENTALS LLC	86 BURWELL AVE SOUTH PORTLAND, ME 04106	84 GRANT ST	6
048 D003001	BAYVIEW PROPERTIES LLC	211 MARGINAL WAY STE 171 PORTLAND, ME 04101	80 GRANT ST	12
048 D004001	LITTLEFIELD ANDREA L	74 GRANT ST PORTLAND, ME 04101	74 GRANT ST	2
048 D005001	70 GRANT STREET LLC	34 RICHARDSON ST PORTLAND, ME 04103	72 GRANT ST	6
048 D007001	BOUCHER ERIK	66 GRANT ST APT 4 PORTLAND, ME 04101	66 GRANT ST	4
048 D008001	GOSS MARJORIE A & PAUL A GOSS JTS	62 GRANT ST PORTLAND, ME 04101	62 GRANT ST	4
048 D009001	RICE GEOFFREY I	658 CONGRESS ST 1 ST FLOOR PORTLAND, ME 04101	60 GRANT ST	7
048 D010001	AHLQUIST OREN B	266 BEECHRIDGE RD SCARBOROUGH, ME 04074	54 GRANT ST	4
048 D011001	KOUFMAN ELAINE G & JILL M KOUFMAN JTS	276 STATE ST # 1 PORTLAND, ME 04101	276 STATE ST	1
048 D011002	LAROCHELLE PETER M	276 STATE ST # 2 PORTLAND, ME 04101	276 STATE ST	1
048 D011003	SHICKLER CHRISTOPHER R	276 STATE ST # 3 PORTLAND, ME 04101	276 STATE ST	1
048 D013001	MAHAN CATHLEEN	83 SHERMAN ST # 1 PORTLAND, ME 04101	83 SHERMAN ST	1
048 D013002	ITCHKAWICH DAVID	83 SHERMAN ST # 2 PORTLAND, ME 04101	83 SHERMAN ST	1
048 D013003	BRODEUR JAN C	83 SHERMAN ST # 3 PORTLAND, ME 04101	83 SHERMAN ST	1
048 D013004	BOUCHER JOANNE FELICE	83 SHERMAN ST # 4 PORTLAND, ME 04101	83 SHERMAN ST	1

CBL	OWNER	OWNER MAILING ADDRESS	PROPERTY LOCATION	UNITS
048 D013005	LABRIE JOHN R	83 SHERMAN ST # 5 PORTLAND, ME 04101	83 SHERMAN ST	1
048 D013006	RANDAZZO MICHAEL J & CYNTHIA F CHIANG JTS	83 SHERMAN ST # 6 PORTLAND, ME 04101	83 SHERMAN ST	1
048 D013007	KINDRED WENDY	83 SHERMAN ST # 7 PORTLAND, ME 04101	83 SHERMAN ST	1
048 D013008	NEWKIRK JANE & LOUIS SLINGERLAND JTS	83 SHERMAN ST # 8 PORTLAND, ME 04101	83 SHERMAN ST	1
048 D016001	TRUE NORTH PROPERTIES LLC	PO BOX 1021 PORTLAND, ME 04104	77 SHERMAN ST	12
048 D017001	HABIBI AMIR	865 BROADWAY SOUTH PORTLAND, ME 04106	75 SHERMAN ST	9
048 D018001	SIDELINGER GARY A & MAUREEN L JTS	PO BOX 1003 PORTLAND, ME 04104	69 SHERMAN ST	12
048 D019001	STEPHENSON SUSAN E & MICHAEL A STEPHENSON JTS	65 SHERMAN ST # 1 PORTLAND, ME 04101	65 SHERMAN ST	1
048 D019002	WEIMER CHERYL L	65 SHERMAN ST # 2 PORTLAND, ME 04101	65 SHERMAN ST	1
048 D019003	CLARK MICHAEL S	65 SHERMAN ST # 3 PORTLAND, ME 04101	65 SHERMAN ST	1
048 D019004	FULLER WILLIAM E	65 SHERMAN ST # 4 PORTLAND, ME 04101	65 SHERMAN ST	1
048 D019005	BECKSVOORT KAI & JAMIE TURCOTTE JTS	65 SHERMAN ST # 5 PORTLAND, ME 04101	65 SHERMAN ST	1
048 D019006	US BANK NATIONAL	60 LIVINGSTON AVE ST PAUL, MN 55107	65 SHERMAN ST	1
048 D019007	BERGERON CATHERINE M	65 SHERMAN ST # 7 PORTLAND, ME 04101	65 SHERMAN ST	1
048 D019008	BERGERON CATHERINE M	65 SHERMAN ST # 8 PORTLAND, ME 04101	65 SHERMAN ST	1
048 D019009	WEISS LESLIE D & DENNIS P DEMUTH JTS	65 SHERMAN ST # 9 PORTLAND, ME 04101	65 SHERMAN ST	1
048 D019010	CAHILL ANDREA L	65 SHERMAN ST # 10 PORTLAND, ME 04101	65 SHERMAN ST	1
048 D019011	ROPER BENJAMIN G	117 FLORIDA AVE PORTLAND, ME 04103	65 SHERMAN ST	1
048 D019012	DEVINE MARK B	200 STEVENS AVE PORTLAND, ME 04102	65 SHERMAN ST	1
048 D019013	CATALDO BRIAN C	65 SHERMAN ST # 13 PORTLAND, ME 04101	65 SHERMAN ST	1
048 D019014	SCHARDT THOMAS P	519 E 78TH # 5C NEW YORK, NY 10075	65 SHERMAN ST	1
048 D019015	COUGHLAN DOUGLAS	63 BRADLEY HILL RD PEMAQUID, ME 04558	65 SHERMAN ST	1
048 D019016	SMITH FRANCIS & CATHLEEN SMITH JTS	65 SHERMAN ST # 16 PORTLAND, ME 04101	65 SHERMAN ST	1
048 D019017	FOWLER JEFFREY E & SARAH J E FOWLER JTS	65 SHERMAN ST # 17 PORTLAND, ME 04101	65 SHERMAN ST	1
048 D020001	VELIGOR VINCENT D JR & SUSAN J JTS	61 SHERMAN ST PORTLAND, ME 04101	61 SHERMAN ST	2
048 D022001	GRASSHOPPER APARTMENTS	55 SHERMAN ST PORTLAND, ME 04101	55 SHERMAN ST	7
048 D023001	S S & M LLC	88 ANNAFRAN ST ROSLINDALE, MA 02131	264 STATE ST	12
048 D024001	NAPPI JOSEPH A	79 MELLEN ST PORTLAND, ME 04102	79 MELLEN ST	1
048 D025001	CONLEY PAUL E & CORINNE J JTS	PO BOX 8419 PORTLAND, ME 04104	52 GRANT ST	1

CBL	OWNER	OWNER MAILING ADDRESS	PROPERTY LOCATION	UNITS
048 E011001	BETH CHRISTOPHER A & LORI J ESCHHOLZ JTS	106 SHERMAN ST PORTLAND, ME 04101	106 SHERMAN ST	2
048 E012001	MELLEN-SHERMAN CORP	189 ST JOHN ST PORTLAND, ME 04102	62 MELLEN ST	12
048 E013001	DOOLEY KATHLEEN M & JAMES F DOOLEY JTS	60 MELLEN ST # 1 PORTLAND, ME 04101	60 MELLEN ST	5
048 F001001	ROMAN CATHOLIC BISHOP OF PORTLAND	PO BOX 11559 PORTLAND, ME 04104	82 SHERMAN ST	1
048 F005001	ROMAN CATHOLIC BISHOP OF PORTLAND	PO BOX 11559 PORTLAND, ME 04104	80 SHERMAN ST	1
048 F006001	SIDELINGER GARY A & MAUREEN L JTS	PO BOX 1003 PORTLAND, ME 04104	66 SHERMAN ST	7
048 F007001	SALVAN MARTA HERNANDEZ	62 SHERMAN ST PORTLAND, ME 04101	62 SHERMAN ST	2
048 F008001	FOSTER DOLORES	90 CARROLL ST PORTLAND, ME 04102	60 SHERMAN ST	6
048 F009001	FOSTER DOLORES	90 CARROLL ST PORTLAND, ME 04102	56 SHERMAN ST	7
048 F010001	RICE GEOFFREY I	658 CONGRESS ST 1 ST FLOOR PORTLAND, ME 04101	52 SHERMAN ST	6
048 F011001	NEWSOME JOSEPH W & ANTOINETTE N NEWSOME JTS	256 STATE ST PORTLAND, ME 04101	258 STATE ST	1
048 F012001	NEWSOME JOSEPH W & ANTOINETTE M NEWSOME JTS	256 STATE ST PORTLAND, ME 04101	256 STATE ST	1
048 F014001	LY TIM Q & AARON ADDITON &	521 CUMBERLAND AVE PORTLAND, ME 04101	521 CUMBERLAND AVE	4
048 F015001	FESENKO ESTATE LLC	88 WOODLAND DR WEST GARDINER, ME 04345	515 CUMBERLAND AVE	6
048 F016001	LEAVITT BETHANY M	133 ENDICOTT ST # 1 BOSTON, MA 02113	511 CUMBERLAND AVE	3
048 F017001	TRUSSELL PROPERTIES LLC	26 ATLANTIC DR SCARBOROUGH, ME 04074	509 CUMBERLAND AVE	5
048 F018001	TRUSSELL PROPERTIES LLC	26 ATLANTIC DR SCARBOROUGH, ME 04074	507 CUMBERLAND AVE	5
048 F019001	EAST END CORP	PO BOX 10291 PORTLAND, ME 04104	503 CUMBERLAND AVE	9
048 F020001	501 PARTNERS LLC	PO BOX 226 YORK HARBOR, ME 03911	501 CUMBERLAND AVE	3
048 F021001	TROUT GROUP INVESTMENTS LIMITED LIABILITY COMPANY	PO BOX 7051 PORTLAND, ME 04112	497 CUMBERLAND AVE	12
048 F022001	TROUT GROUP INVESTMENTS LIMITED LIABILITY COMPANY	PO BOX 7051 PORTLAND, ME 04112	493 CUMBERLAND AVE	6
048 F023001	FULLER DENNY A & DENNIS W KIERNAN	PO BOX 7341 PORTLAND, ME 04112	489 CUMBERLAND AVE	4
048 F024001	485 CUMBERLAND AVENUE LLC	34 RICHARDSON ST PORTLAND, ME 04103	485 CUMBERLAND AVE	25
048 F025001	SCHOENFELD FRAYLA A & HARRIS SCHOENFELD JTS	481 CUMBERLAND AVE PORTLAND, ME 04101	481 CUMBERLAND AVE	4
048 F026001	RIDGWAY JAMES R III & STACY K LANG JTS	4657 BAY SUMMIT PL SAN DIEGO, CA 92117	252 STATE ST	1
048 F027001	JAMES FREDERICK O JR & CAROLE A JAMES	299 TUTTLE RD CUMBERLAND, ME 04021	477 CUMBERLAND AVE	10

CBL	OWNER	OWNER MAILING ADDRESS	PROPERTY LOCATION	UNITS
Total Listed	142 UNITS	611		

This page contains a detailed description of the Parcel ID you selected. Press the **New Search** button at the bottom of the screen to submit a new query.

Current Owner Information

Card Number	1 of 1
Parcel ID	048 B016001
Location	65 GRANT ST
Land Use	ELEVEN TO TWENTY FAMILY
Owner Address	INTOWN PROPERTY HOLDINGS LLC PO BOX 641 FREEPORT ME 04032
Book/Page	25517/313
Legal	48-B-16 GRANT ST 61-67 9500 SF

Current Assessed Valuation

Land	Building	Total
\$71,800	\$896,200	\$968,000

Building Information

Bldg #	Year Built	# Units	Bldg Sq. Ft.	Identical Units
1	1900	6	0	3

Total Acres	Total Buildings	Sq. Ft.	Structure Type	Building Name
0.218	0		APARTMENT - GARDEN	

Exterior/Interior Information

Section	Levels	Size	Use
1	B1/B1	1490	SUPPORT AREA
1	01/01	1490	APARTMENT
1	02/02	1490	APARTMENT
1	03/03	1472	APARTMENT
1	A1/A1	1472	SUPPORT AREA

Height	Walls	Heating	A/C
6		NONE	NONE
10	FRAME	HW/STEAM	NONE
10	FRAME	HW/STEAM	NONE
10	FRAME	HW/STEAM	NONE
4	FRAME	NONE	NONE
		NONE	NONE
		NONE	NONE
		NONE	NONE

Building Other Features

Line	Structure Type	Identical Units
2	PORCH - COVERED	1

Yard Improvements

Year Built	Structure Type	Length or Sq. Ft.	# Units
------------	----------------	-------------------	---------