

T:\00\_TFH\Projects\PC0114\_Melan\Drawings\Revised\SD0210\_Bldg\ACAD\004\BUILDING\AS1.dwg, Model: 2/27/2004 11:31:38 AM

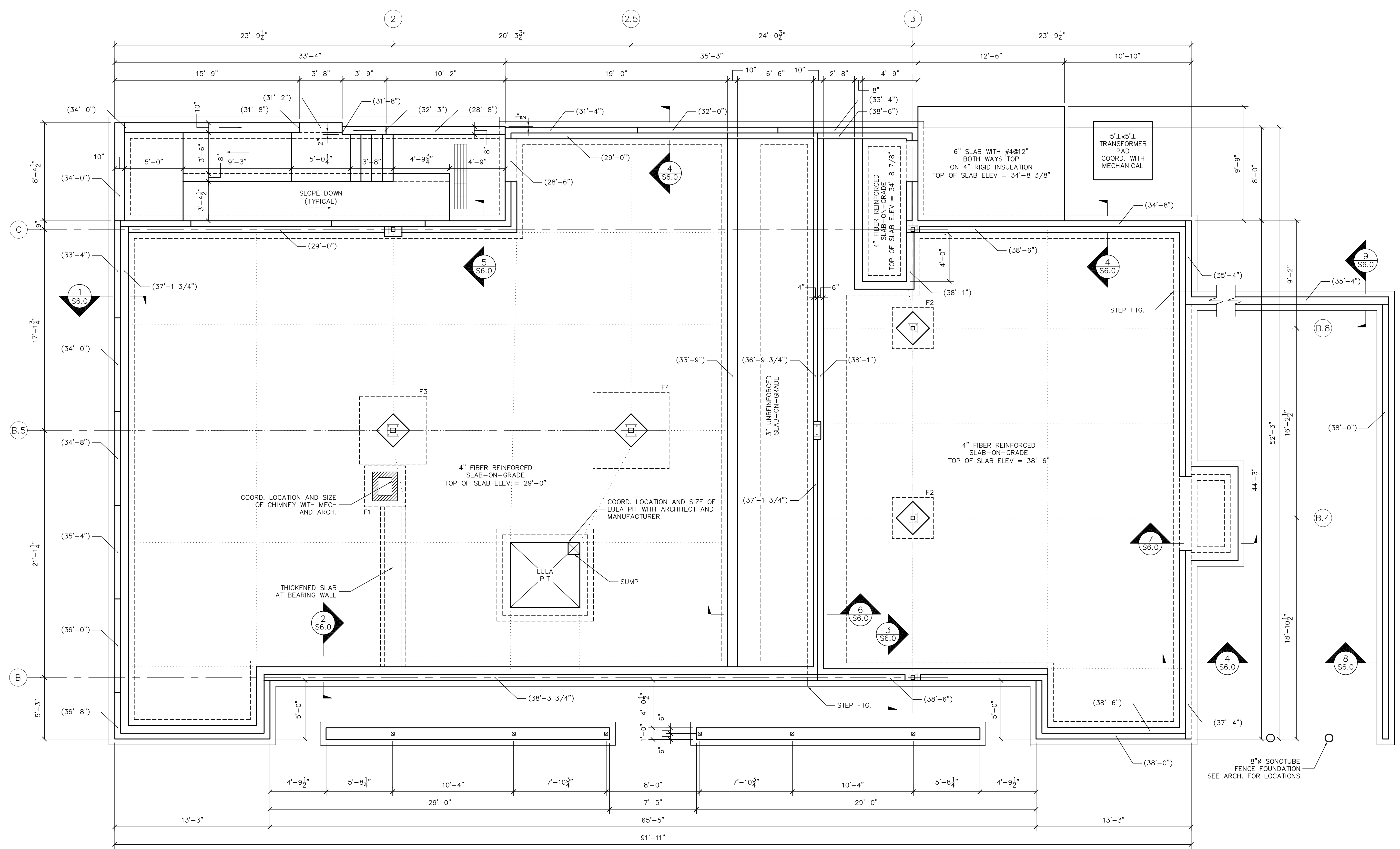

**FOUNDATION PLAN**  
 1/4"=1'-0"  
 TOP OF CONCRETE WALL ELEVATION NOTED (XX'-X").

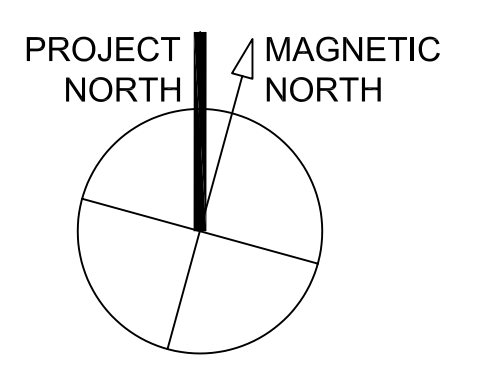

© TFH ARCHITECTS

**GRANT & MELLEEN SREET**  
**PARKSIDE NEIGHBORHOOD CENTER & AFFORDABLE HOUSING**  
**PEOPLE'S REGIONAL OPPORTUNITY PROGRAM**  
**PORTLAND, MAINE**

**TFH ARCHITECTS**  
 100 COMMERCIAL STREET  
 PORTLAND MAINE 04101  
 TELEPHONE 207 775 6141  
 ARCHITECTURE PLANNING

**CONSULTANTS:**  
**CIVIL:**  
 Plaksham & Greer  
 170 US Route One  
 Falmouth, ME 04105  
 207-781-0242  
**STRUCTURAL:**  
 Structural Design Consulting  
 Five Baskin Lane  
 Falmouth, ME 04105-2448  
 207-781-8030  
**MECHANICAL:**  
 Whitney Engineering  
 10 Danforth Place  
 Portland, ME 04102  
 207-833-2921  
**ELECTRICAL:**  
 Bennett Engineering  
 7 Bennett Road  
 Freeport, ME 04032  
 207-865-0475

**REVISIONS:**

**DATE:** 01/29/04  
**PROJECT No.:** 0114  
**DRAWN BY:** DJT  
**CHECKED BY:** DJT  
**SCALE:** 1/4"=1'-0"

**SHEET TITLE:**  
**FOUNDATION PLAN**

**BUILDING A**

**S1.0**