

TFH ARCHITECTS

GRANT & MELLEEN SREET  
PARKSIDE NEIGHBORHOOD CENTER & AFFORDABLE HOUSING  
PEOPLE'S REGIONAL OPPORTUNITY PROGRAM  
PORTLAND, MAINE

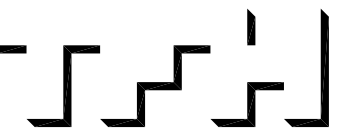

TFH ARCHITECTS  
100 COMMERCIAL STREET  
PORTLAND MAINE 04101  
TELEPHONE 207 775 6141  
ARCHITECTURE PLANNING

CONSULTANTS:  
CIVIL:  
Prakash & Greer  
175 US Route One  
Farmport, ME 04105  
207-785-6242  
STRUCTURAL:  
Structural Design Consulting  
Five Baskin Lane  
Farmport, ME 04105-2448  
207-878-8030  
MECHANICAL:  
Whitney Engineering  
10 Danforth Place  
Portland, ME 04102  
207-433-2921  
ELECTRICAL:  
Bennett Engineering  
7 Bennett Road  
Freeport, ME 04032  
207-865-9475

REVISIONS:

DATE: 01/29/04  
PROJECT No. 0114  
DRAWN BY: RPW  
CHECKED BY: AWH  
SCALE: AS NOTED

SHEET TITLE:  
3RD FLOOR PLAN

BUILDING B  
P1.3

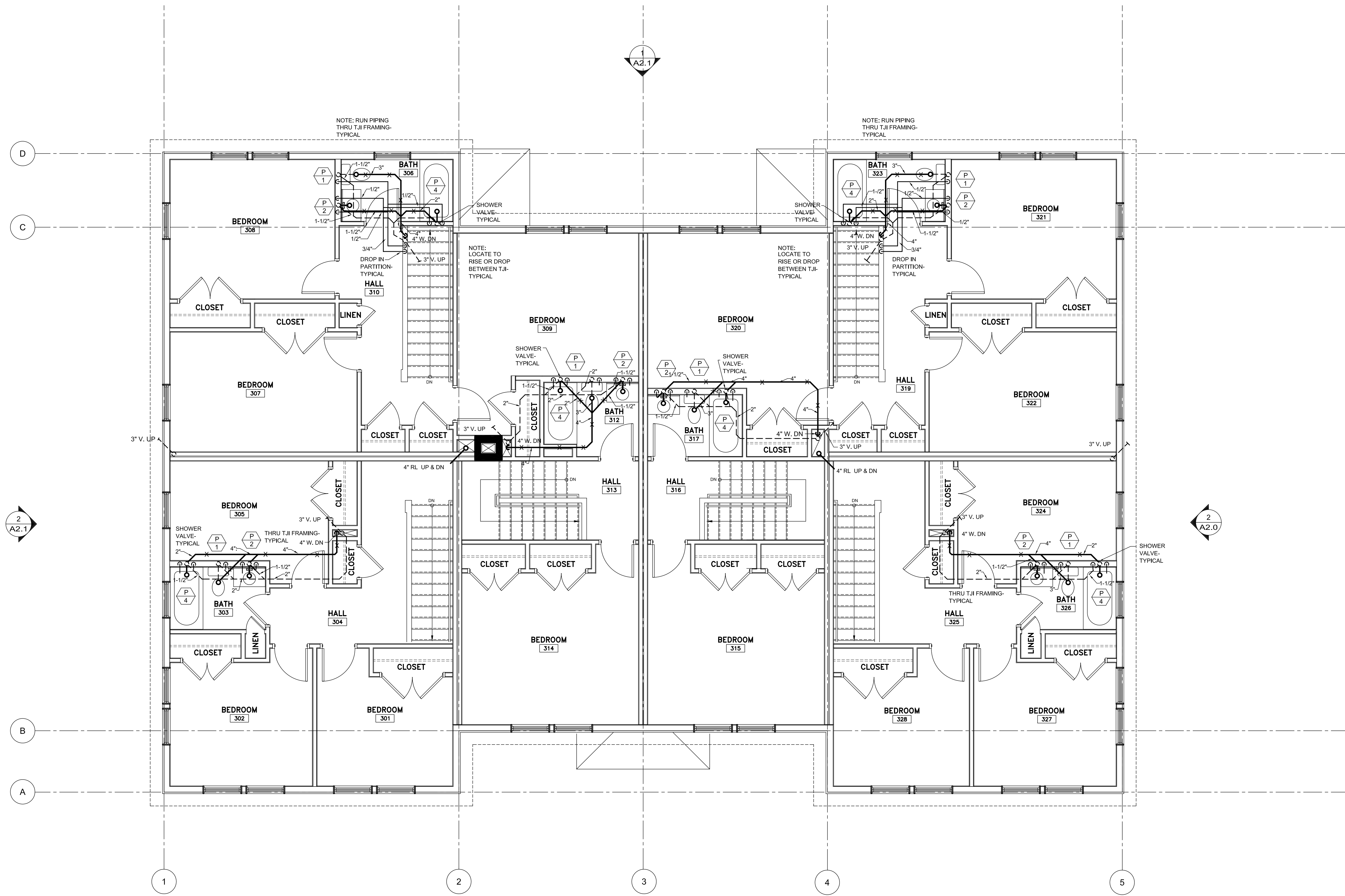

1 3RD FLOOR PLAN BUILDING B - PLUMBING  
1/4" = 1'-0"

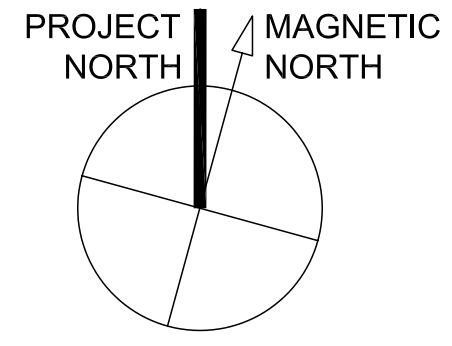
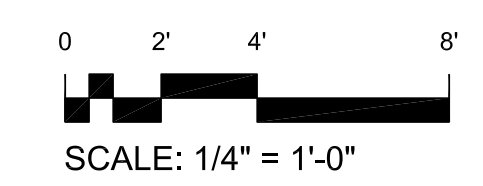

T:\02\_TFH Projects\PROJ\01014\_Melleen Grant\BancReview\Review\Whitney\021004.bld docx100788kg B P1.3.DWG, 2408 FLOOR PLAN, 2/27/2004, 3:43:30 PM